

15-163-20018-00-00

Form CP-4

STATE OF KANSAS  
STATE CORPORATION COMMISSION

Give All Information Completely  
Make Required Affidavit  
Mail or Deliver Report to:  
Conservation Division  
State Corporation Commission  
212 No. Market  
Wichita, Kansas

WELL PLUGGING RECORD

ROOKS County. Sec. 24 Twp. 10s Rge. 19 (X) (W)  
Location as "NE/CNW/SW" or footage from lines APP. SE NW SW  
Lease Owner PETROLEUM, INC.,  
Lease Name STEEPLES 'D' Well No. 1  
Office Address R.R. #2, GREAT BEND, KANSAS  
Character of Well (completed as Oil, Gas or Dry Hole) DRY HOLE  
Date well completed APRIL 25 19 67  
Application for plugging filed APRIL 25 19 67  
Application for plugging approved APRIL 25 19 67  
Plugging commenced APRIL 25 1967  
Plugging completed APRIL 25 19 67  
Reason for abandonment of well or producing formation NO PRODUCIBLE ZONE

NORTH

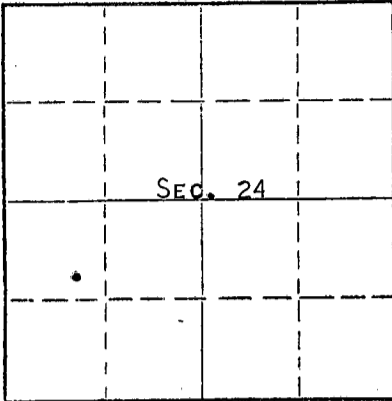

Locate well correctly on above  
Section Plat

If a producing well is abandoned, date of last production NONE 19  
Was permission obtained from the Conservation Division or its agents before plugging was commenced? YES

Name of Conservation Agent who supervised plugging of this well LEO F. MASSEY  
Producing formation \_\_\_\_\_ Depth to top \_\_\_\_\_ Bottom \_\_\_\_\_ Total Depth of Well 3621 Feet  
Show depth and thickness of all water, oil and gas formations.

OIL, GAS OR WATER RECORDS

CASING RECORD

FORMATION	CONTENT	FROM	TO	SIZE	PUT IN	PULLED OUT
				8-5/8"	217'	NONE

Describe in detail the manner in which the well was plugged, indicating where the mud fluid was placed and the method or methods used in introducing it into the hole. If cement or other plugs were used, state the character of same and depth placed, from \_\_\_\_\_ feet to \_\_\_\_\_ feet for each plug set.

MUD TO 540', FOLLOWED BY WOODEN PLUG, PLACED 25 SACKS CEMENT ON TOP OF PLUG.  
MUD TO 210', FOLLOWED BY WOODEN PLUG, PLACED 1/4 SACK HULLS, 2 SACKS DRY CEMENT ON TOP OF PLUG. MUD TO 40', FOLLOWED BY WOODEN PLUG, 1/2 SACK HULLS, BRIDGE TO HOLD KELLY, 8 SACKS CEMENT ON TOP OF PLUG TO BASE OF WELL CELLAR.

RECEIVED  
STATE CORPORATION COMMISSION

MAY 4 1967  
05-04-1967  
CONSERVATION DIVISION  
Wichita, Kansas

(If additional description is necessary, use BACK of this sheet)

Name of Plugging Contractor GARVEY DRILLING COMPANY  
Address R.R. #2, GREAT BEND, KANSAS

STATE OF KANSAS, COUNTY OF BARTON, ss.  
MONTE CHADD (employee of owner) or (owner or operator) of the above-described well, being first duly sworn on oath, says: That I have knowledge of the facts, statements, and matters herein contained and the log of the above-described well as filed and that the same are true and correct. So help me God. MONTE CHADD, DIST. PROD. SUPT.

(Signature) \_\_\_\_\_  
R.R. #2, GREAT BEND, KANSAS  
(Address)

SUBSCRIBED AND SWORN to before me this 3 day of MAY, 19 67

My commission expires MAY 28, 1969

Richard H. Dumbler  
Notary Public.

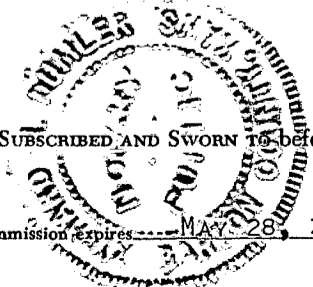

15-163-20018-00-00  
WELL LOG

COMPANY Petroleum, Inc.

SEC. 24 T. 10S R. 19W

FARM Steeples

NO. D-1

LOC. SE NW SW

TOTAL DEPTH 3621'

COUNTY Rooks

COMM. 4-17-67

COMP. 4-25-67

CONTRACTOR Garvey Drilling Company

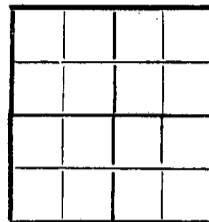

CASING 8 5/8" @ 217' w/175 sx

ELEVATION 2094' KB

PRODUCTION D & A

FIGURES INDICATE BOTTOM OF FORMATIONS

- 80' Post Rock
- 217' Shale and Shells
- 600' Shale and Sand
- 928' Shale
- 1226' Sand
- 1335' Shale
- 1940' Shale, Anhydrite and Shells
- 2225' Shale with Lime
- 2660' Lime and Shale
- 2920' Shale with Lime
- 3320' Lime and Shale
- 3621' Lime
- 3621' RTD.

RECEIVED  
STATE CORPORATION COMMISSION  
MAY 4 1967  
05-04-1967  
CONSERVATION DIVISION  
Wichita, Kansas

State of Kansas }  
County of Barton } ss

I, Sam N. Stephens of Garvey Drilling Company

upon oath state the above and foregoing is a true and correct copy of the log of the Steeples D-1 well.

Sam N. Stephens

Subscribed and sworn to before me this 2nd day of May 19 67

My Commission Expires: November 5th, 1969

Richard Doy  
NOTARY PUBLIC

