

For KCC Use:
 Effective Date: 10-7-08
 District #: 4
 SGA? Yes No

KANSAS CORPORATION COMMISSION
 OIL & GAS CONSERVATION DIVISION

Form C-1
 October 2007
 Form must be Typed
 Form must be Signed
 All blanks must be Filled

NOTICE OF INTENT TO DRILL
 Must be approved by KCC five (5) days prior to commencing well

Expected Spud Date: 11-1-08
month day year

OPERATOR: License# 31171
 Name: Continental Operating Co.
 Address 1: 1 Houston Center 1221 McKinney Ste 3700
 Address 2:
 City: Houston State: Tx Zip: 77010
 Contact Person: Gregory A. Mitschke
 Phone: 713-209-1110

CONTRACTOR: License# 33493
 Name: American Eagle Drilling, LLC

Well Drilled For: Oil Gas
 Enh Rec Storage Disposal
 Seismic Other: _____
 # of Holes: _____

Well Class: Infield Pool Ext. Wildcat Other

Type Equipment: Mud Rotary Air Rotary Cable

If OWWO: old well information as follows:
 Operator: _____
 Well Name: _____
 Original Completion Date: _____ Original Total Depth: _____

Directional, Deviated or Horizontal wellbore? Yes No
 If Yes, true vertical depth: _____
 Bottom Hole Location: _____
 KCC DKT #: _____

Spot Description:
 NE NE SW Sec. 11 Twp. 10 S. R. 19 E W
 2,170 feet from N / S Line of Section
 2,260 feet from E / W Line of Section
 Is SECTION: Regular Irregular?

(Note: Locate well on the Section Plat on reverse side)
 County: Rooks
 Lease Name: Husted B Well #: 5
 Field Name: Vohs
 Is this a Prorated / Spaced Field? Yes No
 Target Formation(s): Arbuckle
 Nearest Lease or unit boundary line (in footage): 2310'
 Ground Surface Elevation: 2100' feet MSL
 Water well within one-quarter mile: Yes No
 Public water supply well within one mile: Yes No
 Depth to bottom of fresh water: 120'
 Depth to bottom of usable water: 800'
 Surface Pipe by Alternate: I II
 Length of Surface Pipe Planned to be set: 200'
 Length of Conductor Pipe (if any): None
 Projected Total Depth: 3500'
 Formation at Total Depth: Arbuckle
 Water Source for Drilling Operations:
 Well Farm Pond Other: Truck
 DWR Permit #: _____
 (Note: Apply for Permit with DWR)
 Will Cores be taken? Yes No
 If Yes, proposed zone: _____

AFFIDAVIT

The undersigned hereby affirms that the drilling, completion and eventual plugging of this well will comply with K.S.A. 55 et. seq.
 It is agreed that the following minimum requirements will be met:

1. Notify the appropriate district office **prior** to spudding of well;
2. A copy of the approved notice of intent to drill **shall be** posted on each drilling rig;
3. The minimum amount of surface pipe as specified below **shall be set** by circulating cement to the top; in all cases surface pipe **shall be set** through all unconsolidated materials plus a minimum of 20 feet into the underlying formation.
4. If the well is dry hole, an agreement between the operator and the district office on plug length and placement is necessary **prior to plugging**;
5. The appropriate district office will be notified before well is either plugged or production casing is cemented in;
6. If an ALTERNATE II COMPLETION, production pipe shall be cemented from below any usable water to surface within **120 DAYS** of spud date.
 Or pursuant to Appendix "B" - Eastern Kansas surface casing order #133,891-C, which applies to the KCC District 3 area, alternate II cementing must be completed within 30 days of the spud date or the well shall be plugged. **In all cases, NOTIFY district office** prior to any cementing.

I hereby certify that the statements made herein are true and correct to the best of my knowledge and belief.

Date: 9/30/08 Signature of Operator or Agent: _____ Title: _____

Gregory A. Mitschke
 Senior Vice President
 Continental Operating Co.

For KCC Use ONLY
 API # 15 - 103-23774-0000
 Conductor pipe required None feet
 Minimum surface pipe required 200 feet per ALT: I II
 Approved by: [Signature] 10-2-08
 This authorization expires: 10-2-09
 (This authorization void if drilling not started within 12 months of approval date.)
 Spud date: _____ Agent: _____

Remember to:
 - File Drill Pit Application (form CDP-1) with Intent to Drill;
 - File Completion Form ACO-1 within 120 days of spud date;
 - File acreage attribution plat according to field proration orders;
 - Notify appropriate district office 48 hours prior to workover or re-entry;
 - Submit plugging report (CP-4) after plugging is completed (within 60 days);
 - Obtain written approval before disposing or injecting salt water.
 - If this permit has expired (See: authorized expiration date) please check the box below and return to the address below.
 Well Not Drilled - Permit Expired Date: _____
 Signature of Operator or Agent: _____

Mail to: KCC - Conservation Division, 130 S. Market - Room 2078, Wichita, Kansas 67202

RECEIVED
 KANSAS CORPORATION COMMISSION

OCT 02 2008

CONSERVATION DIVISION
 WICHITA, KS

IN ALL CASES PLOT THE INTENDED WELL ON THE PLAT BELOW

Plat of acreage attributable to a well in a prorated or spaced field

If the intended well is in a prorated or spaced field, please fully complete this side of the form. If the intended well is in a prorated or spaced field complete the plat below showing that the well will be properly located in relationship to other wells producing from the common source of supply. Please show all the wells and within 1 mile of the boundaries of the proposed acreage attribution unit for gas wells and within 1/2 mile of the boundaries of the proposed acreage attribution unit for oil wells.

API No. 15 - 163-23774-0000
Operator: Continental Operating Co.
Lease: Husted B
Well Number: 5
Field: Vohs

Location of Well: County: Rooks
2,170 feet from N / S Line of Section
2,260 feet from E / W Line of Section
Sec. 11 Twp. 10 S. R. 19 E W

Number of Acres attributable to well: _____
QTR/QTR/QTR/QTR of acreage: _____ - NE - NE - SW

Is Section: Regular or Irregular

If Section is Irregular, locate well from nearest corner boundary.
Section corner used: NE NW SE SW

PLAT

*(Show location of the well and shade attributable acreage for prorated or spaced wells.)
(Show footage to the nearest lease or unit boundary line.)*

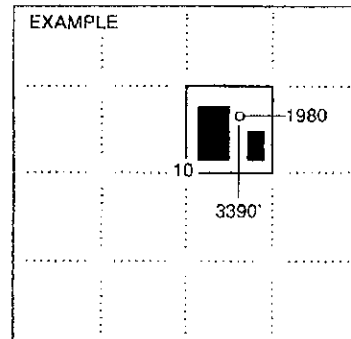
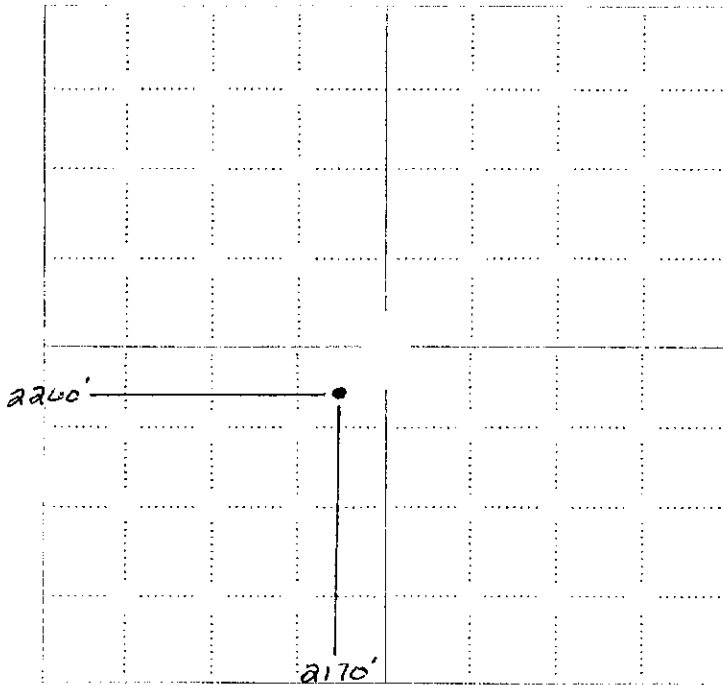

NOTE: In all cases locate the spot of the proposed drilling location.

In plotting the proposed location of the well, you must show:

1. The manner in which you are using the depicted plat by identifying section lines, i.e. 1 section, 1 section with 8 surrounding sections, 4 sections, etc.
2. The distance of the proposed drilling location from the south / north and east / west outside section lines.
3. The distance to the nearest lease or unit boundary line (in footage).
4. If proposed location is located within a prorated or spaced field a certificate of acreage attribution plat must be attached: (CO-7 for oil wells; CG-8 for gas wells).

RECEIVED
KANSAS CORPORATION COMMISSION

OCT 2 2008

CONSERVATION DIVISION,
WICHITA, KS

CONTINENTAL OPERATING COMPANY
HUSTED LEASE
SW.1/4. SECTION 11. T10S. R19W
ROOKS COUNTY, KANSAS

15703-23774-0000

Notes:

1. Set iron rod at location site.
2. All flagging Red & Yellow.
3. Overhead power available at S. & E. lines, Sec. 11.
4. Kansas One Call System Inc. should be notified before excavation (1-800-344-7233).
5. CAUTION: Various pipelines in Sec. 11.
6. Contact landowner for best access.
7. Location fell on the slope of a creek, set alternate per representative.

Ingress and egress to location as shown on this plat is for usage only and may not be legally opened for public use. Contact landowner, tenant and county road department for access.

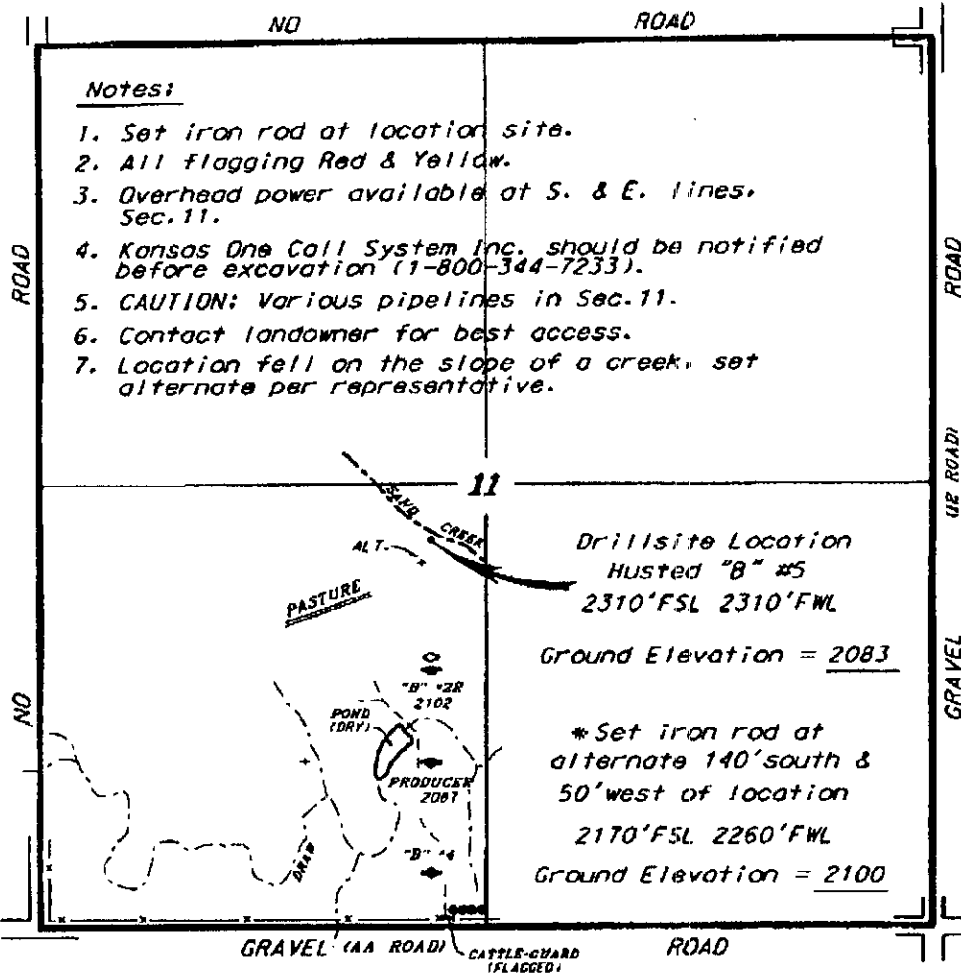

Drillsite Location
Husted "B" #5
2310'FSL 2310'FWL
Ground Elevation = 2083

*Set iron rod at
alternate 140' south &
50' west of location
2170'FSL 2260'FWL
Ground Elevation = 2100

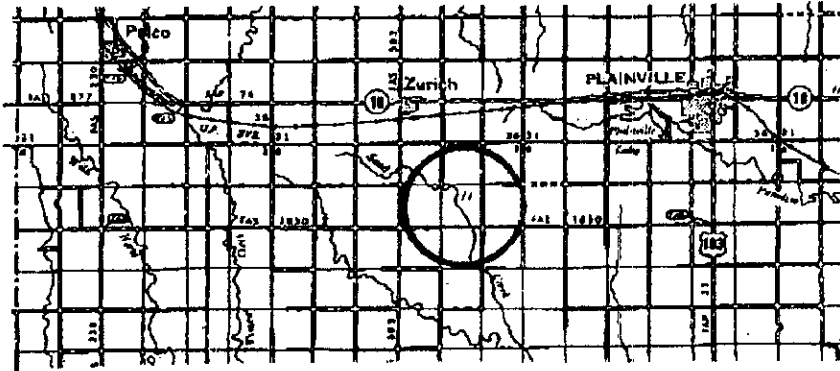

Controlling data is based upon the best maps and photographs available to us and upon a regular section of land containing 640 acres.
Approximate section lines were determined using the normal standard of care of oilfield surveyors practicing in the state of Kansas. The section corners, which establish the precise section lines, were not necessarily located, and the exact location of the drillsite location in the section is not guaranteed. Therefore, the operator bearing this notice and accepting this plat and all other services relating hereon agree to hold CENTRAL KANSAS OILFIELD SERVICES, INC., its officers and employees harmless from all claims, suits and expenses and any and all litigation released from any liability from the content or consequential damages.
Elevations derived from National Geodetic Vertical Datum.

Date September 18, 2008

CENTRAL KANSAS OILFIELD SERVICES, INC. (620)792-1977

RECEIVED
KANSAS CORPORATION COMMISSION

OCT 02 2008

CONSERVATION DIVISION
WICHITA, KS

**KANSAS CORPORATION COMMISSION
OIL & GAS CONSERVATION DIVISION
APPLICATION FOR SURFACE PIT**

Form GDP-1
April 2004
Form must be Typed

Submit in Duplicate

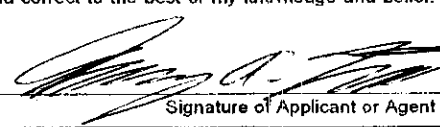
Operator Name: Continental Operating Co.		License Number: 31171	
Operator Address: 1 Houston Center 1221 McKinney Ste 3700		Houston Tx 77010	
Contact Person: Gregory A. Mitschke		Phone Number: 713 - 209 - 1110	
Lease Name & Well No.: Husted B 5		Pit Location (QQQQ): NE NE SW	
Type of Pit: <input type="checkbox"/> Emergency Pit <input type="checkbox"/> Burn Pit <input type="checkbox"/> Settling Pit <input checked="" type="checkbox"/> Drilling Pit <input type="checkbox"/> Workover Pit <input type="checkbox"/> Haul-Off Pit <i>(If WP Supply API No or Year Drilled)</i>		Pit is: <input checked="" type="checkbox"/> Proposed <input type="checkbox"/> Existing If Existing, date constructed: _____ Pit capacity: _____ (bbls)	
Is the pit located in a Sensitive Ground Water Area? <input type="checkbox"/> Yes <input checked="" type="checkbox"/> No		Sec. 11 Twp. 10 R. 19 <input type="checkbox"/> East <input checked="" type="checkbox"/> West 2,170 Feet from <input type="checkbox"/> North / <input checked="" type="checkbox"/> South Line of Section 2,260 Feet from <input checked="" type="checkbox"/> East / <input type="checkbox"/> West Line of Section Rocks _____ County _____	
Is the bottom below ground level? <input checked="" type="checkbox"/> Yes <input type="checkbox"/> No		Artificial Liner? <input type="checkbox"/> Yes <input checked="" type="checkbox"/> No How is the pit lined if a plastic liner is not used? Natural gumbo seal	
Pit dimensions (all but working pits): 40 Length (feet) 20 Width (feet) <input type="checkbox"/> N/A: Steel Pits Depth from ground level to deepest point: 8 (feet) <input type="checkbox"/> No Pit			
If the pit is lined give a brief description of the liner material, thickness and installation procedure.		Describe procedures for periodic maintenance and determining liner integrity, including any special monitoring. Daily inspection while drilling periodic inspection after drilling operations	
Distance to nearest water well within one-mile of pit 4092 4500' feet Depth of water well 52 feet		Depth to shallowest fresh water 37 feet. Source of information: <input type="checkbox"/> measured <input type="checkbox"/> well owner <input type="checkbox"/> electric log <input type="checkbox"/> KDWR	
Emergency, Settling and Burn Pits ONLY: Producing Formation: _____ Number of producing wells on lease: _____ Barrels of fluid produced daily: _____ Does the slope from the tank battery allow all spilled fluids to flow into the pit? <input type="checkbox"/> Yes <input type="checkbox"/> No		Drilling, Workover and Haul-Off Pits ONLY: Type of material utilized in drilling/workover: Drilling mud & water Number of working pits to be utilized: 2 Abandonment procedure: Remove water and free fluids let dry and backfill Drill pits must be closed within 365 days of spud date.	
I hereby certify that the above statements are true and correct to the best of my knowledge and belief.		Gregory A. Mitschke Senior Vice President Continental Operating Co.	
Date 9/30/08		Signature of Applicant or Agent 	
KCC OFFICE USE ONLY			
Date Received: 10/2/08 Permit Number: _____ Permit Date: 10/2/08 Lease Inspection: <input type="checkbox"/> Yes <input checked="" type="checkbox"/> No		Steel Pit <input type="checkbox"/> RFAC <input checked="" type="checkbox"/> RFAS <input type="checkbox"/>	

15-163-23774-0000

Mail to: KCC - Conservation Division, 130 S. Market - Room 2078, Wichita, Kansas 67202

RECEIVED
KANSAS CORPORATION COMMISSION

OCT 02 2008

CONSERVATION DIVISION
WICHITA, KS