



For KCC Use:  
 Effective Date: 10/18/2008  
 District # 1  
 SGA?  Yes  No

KANSAS CORPORATION COMMISSION 1023125  
 OIL & GAS CONSERVATION DIVISION  
**NOTICE OF INTENT TO DRILL**

Form C-1  
 October 2007  
 Form must be Typed  
 Form must be Signed  
 All blanks must be Filled

Must be approved by KCC five (5) days prior to commencing well

Expected Spud Date: 10/14/2008  
 month day year

OPERATOR: License# 6039  
 Name: L.D. Drilling, Inc.  
 Address 1: 7 SW 26TH AVE  
 Address 2:  
 City: GREAT BEND State: KS Zip: 67530 + 6525  
 Contact Person: L. D. DAVIS  
 Phone: 620-793-3051  
 CONTRACTOR: License# 33323  
 Name: Petromark Drilling, LLC

Spot Description:  
 S2 - NW - SE - SW Sec. 24 Twp. 22 S. R. 12  E  W  
 980 feet from  N /  S Line of Section  
 1,650 feet from  E /  W Line of Section

Is SECTION:  Regular  Irregular?  
 (Note: Locate well on the Section Plat on reverse side)

County: Stafford  
 Lease Name: HEYEN Well #: 4  
 Field Name: HEYEN

Is this a Prorated / Spaced Field?  Yes  No  
 Target Formation(s): ARBUCKLE

Nearest Lease or unit boundary line (in footage): 980  
 Ground Surface Elevation: 1861 Estimated feet MSL

Water well within one-quarter mile:  Yes  No  
 Public water supply well within one mile:  Yes  No

Depth to bottom of fresh water: 180  
 Depth to bottom of usable water: 180

Surface Pipe by Alternate:  I  II  
 Length of Surface Pipe Planned to be set: 250

Length of Conductor Pipe (if any):  
 Projected Total Depth: 3650  
 Formation at Total Depth: ARBUCKLE

Water Source for Drilling Operations:  
 Well  Farm Pond  Other:

DWR Permit #: (Note: Apply for Permit with DWR )

Will Cores be taken?  Yes  No  
 If Yes, proposed zone:

Well Drilled For:  Oil  Gas  Seismic; # of Holes  Other:  
 Well Class:  Enh Rec  Storage  Disposal  Other:  
 Type Equipment:  Mud Rotary  Air Rotary  Cable  
 Pool Ext.  Wildcat  Other:  
 If OWWO: old well information as follows:

Operator:  
 Well Name:  
 Original Completion Date: Original Total Depth:

Directional, Deviated or Horizontal wellbore?  Yes  No  
 If Yes, true vertical depth:  
 Bottom Hole Location:  
 KCC DKT #:

**AFFIDAVIT**

The undersigned hereby affirms that the drilling, completion and eventual plugging of this well will comply with K.S.A. 55 et. seq.  
 It is agreed that the following minimum requirements will be met:

1. Notify the appropriate district office **prior** to spudding of well;
2. A copy of the approved notice of intent to drill **shall be** posted on each drilling rig;
3. The minimum amount of surface pipe as specified below **shall be set** by circulating cement to the top; in all cases surface pipe **shall be set** through all unconsolidated materials plus a minimum of 20 feet into the underlying formation.
4. If the well is dry hole, an agreement between the operator and the district office on plug length and placement is necessary **prior to plugging**;
5. The appropriate district office will be notified before well is either plugged or production casing is cemented in;
6. If an ALTERNATE II COMPLETION, production pipe shall be cemented from below any usable water to surface within **120 DAYS** of spud date.  
 Or pursuant to Appendix "B" - Eastern Kansas surface casing order #133,891-C, which applies to the KCC District 3 area, alternate II cementing must be completed within 30 days of the spud date or the well shall be plugged. **In all cases, NOTIFY district office** prior to any cementing.

**Submitted Electronically**

**For KCC Use ONLY**  
 API # 15 - 15-185-23555-00-00  
 Conductor pipe required 0 feet  
 Minimum surface pipe required 200 feet per ALT.  I  II  
 Approved by: Rick Hestermann 10/13/2008  
 This authorization expires: 10/13/2009  
 (This authorization void if drilling not started within 12 months of approval date.)  
 Spud date: Agent:

**Remember to:**

- File Drill Pit Application (form CDP-1) with Intent to Drill;
- File Completion Form ACO-1 within 120 days of spud date;
- File acreage attribution plat according to field proration orders;
- Notify appropriate district office 48 hours prior to workover or re-entry;
- Submit plugging report (CP-4) after plugging is completed (within 60 days);
- Obtain written approval before disposing or injecting salt water.
- If this permit has expired (See: authorized expiration date) please check the box below and return to the address below.

Well Not Drilled - Permit Expired Date: Signature of Operator or Agent:

24 22 12  E  W



1023125

**IN ALL CASES PLOT THE INTENDED WELL ON THE PLAT BELOW**

*Plat of acreage attributable to a well in a prorated or spaced field*

**If the intended well is in a prorated or spaced field, please fully complete this side of the form.** If the intended well is in a prorated or spaced field complete the plat below showing that the well will be properly located in relationship to other wells producing from the common source of supply. Please show all the wells and within 1 mile of the boundaries of the proposed acreage attribution unit for gas wells and within 1/2 mile of the boundaries of the proposed acreage attribution unit for oil wells.

API No. 15 - 15-185-23555-00-00

Operator: L.D. Drilling, Inc.

Lease: HEYEN

Well Number: 4

Field: HEYEN

Number of Acres attributable to well:

QTR/QTR/QTR/QTR of acreage: S2 - NW - SE - SW

Location of Well: County: Stafford

980 feet from  N /  S Line of Section

1,650 feet from  E /  W Line of Section

Sec. 24 Twp. 22 S. R. 12  E  W

Is Section:  Regular or  Irregular

**If Section is Irregular, locate well from nearest corner boundary.**

Section corner used:  NE  NW  SE  SW

**PLAT**

*(Show location of the well and shade attributable acreage for prorated or spaced wells.)*

*(Show footage to the nearest lease or unit boundary line.)*

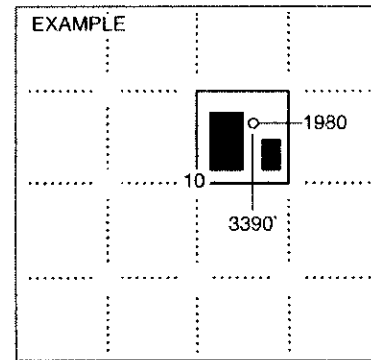
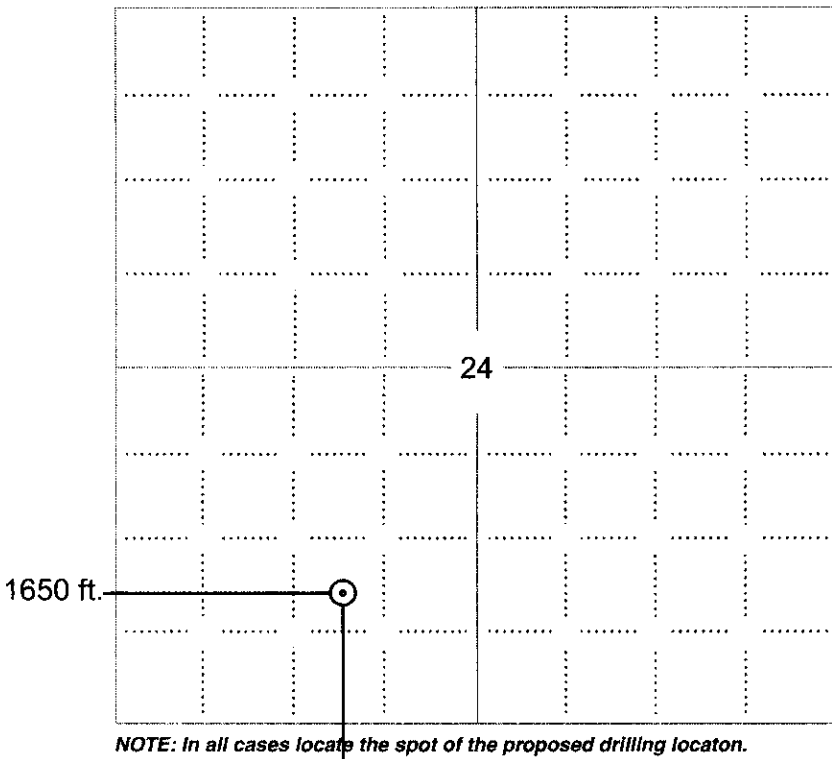

**NOTE: In all cases locate the spot of the proposed drilling locaton.**

980 ft.

**In plotting the proposed location of the well, you must show:**

1. The manner in which you are using the depicted plat by identifying section lines, i.e. 1 section, 1 section with 8 surrounding sections, 4 sections, etc.
2. The distance of the proposed drilling location from the south / north and east / west outside section lines.
3. The distance to the nearest lease or unit boundary line (in footage).
4. If proposed location is located within a prorated or spaced field a certificate of acreage attribution plat must be attached: (C0-7 for oil wells; CG-8 for gas wells).



KANSAS CORPORATION COMMISSION 1023125  
OIL & GAS CONSERVATION DIVISION

Form CDP-1  
April 2004  
Form must be Typed

**APPLICATION FOR SURFACE PIT**

Submit in Duplicate

Operator Name: L.D. Drilling, Inc.		License Number: 6039
Operator Address: 7 SW 26TH AVE		GREAT BEND KS 67530
Contact Person: L. D. DAVIS		Phone Number: 620-793-3051
Lease Name & Well No.: HEYEN 4		Pit Location (QQQQ): S2 NW SE SW
Type of Pit: <input type="checkbox"/> Emergency Pit <input type="checkbox"/> Burn Pit <input type="checkbox"/> Settling Pit <input checked="" type="checkbox"/> Drilling Pit <input type="checkbox"/> Workover Pit <input type="checkbox"/> Haul-Off Pit <i>(If WP Supply API No. or Year Drilled)</i>	Pit is: <input checked="" type="checkbox"/> Proposed <input type="checkbox"/> Existing If Existing, date constructed: _____ Pit capacity: 3,490 (bbls)	Sec. 24 Twp. 22 R. 12 <input type="checkbox"/> East <input checked="" type="checkbox"/> West 980 Feet from <input type="checkbox"/> North / <input checked="" type="checkbox"/> South Line of Section 1,650 Feet from <input type="checkbox"/> East / <input checked="" type="checkbox"/> West Line of Section Stafford County
Is the pit located in a Sensitive Ground Water Area? <input checked="" type="checkbox"/> Yes <input type="checkbox"/> No		Chloride concentration: _____ mg/l <i>(For Emergency Pits and Settling Pits only)</i>
Is the bottom below ground level? <input checked="" type="checkbox"/> Yes <input type="checkbox"/> No	Artificial Liner? <input type="checkbox"/> Yes <input checked="" type="checkbox"/> No	How is the pit lined if a plastic liner is not used? BENTONITE & SOLIDS FROM DRILLING OPERATION
Pit dimensions (all but working pits): 70 Length (feet) 70 Width (feet) <input type="checkbox"/> N/A: Steel Pits Depth from ground level to deepest point: 4 (feet) <input type="checkbox"/> No Pit		
If the pit is lined give a brief description of the liner material, thickness and installation procedure.		Describe procedures for periodic maintenance and determining liner integrity, including any special monitoring.
Distance to nearest water well within one-mile of pit 1296 feet Depth of water well 95 feet	Depth to shallowest fresh water 26 feet. Source of information: <input type="checkbox"/> measured <input type="checkbox"/> well owner <input type="checkbox"/> electric log <input checked="" type="checkbox"/> KDWR	
<b>Emergency, Settling and Burn Pits ONLY:</b> Producing Formation: _____ Number of producing wells on lease: _____ Barrels of fluid produced daily: _____ Does the slope from the tank battery allow all spilled fluids to flow into the pit? <input type="checkbox"/> Yes <input type="checkbox"/> No	<b>Drilling, Workover and Haul-Off Pits ONLY:</b> Type of material utilized in drilling/workover: DRILLING FLUID CUTTINGS Number of working pits to be utilized: 3 Abandonment procedure: PITS ALLOWED TO EVAPORATE UNTIL DRY THEN BACKFILL WHEN CONDITIONS ALLOW Drill pits must be closed within 365 days of spud date.	
Submitted Electronically		

<b>KCC OFFICE USE ONLY</b>		Steel Pit <input type="checkbox"/>	RFAC <input checked="" type="checkbox"/>	RFAS <input checked="" type="checkbox"/>
Date Received: 10/09/2008	Permit Number: 15-185-23555-00-00	Permit Date: 10/13/2008	Lease Inspection: <input checked="" type="checkbox"/> Yes <input type="checkbox"/> No	

Mail to: KCC - Conservation Division, 130 S. Market - Room 2078, Wichita, Kansas 67202



*Kathleen Sebelius, Governor  
Thomas E. Wright, Chairman  
Michael C. Moffet, Commissioner  
Joseph F. Harkins, Commissioner*

October 13, 2008

L. D. DAVIS  
L.D. Drilling, Inc.  
7 SW 26TH AVE  
GREAT BEND, KS67530-6525

Re: Drilling Pit Application  
HEYEN Lease Well No. 4  
SW/4 Sec.24-22S-12W  
Stafford County, Kansas

Dear L. D. DAVIS:

District staff has inspected the above referenced location and has determined that the reserve pit shall be constructed **without slots**, the bottom shall be flat and reasonably level and the free fluids must be removed. The fluids are to be removed from the reserve pit as soon as the Hutchinson Salt section has been drilled through and displacement of the fluids into the reserve pit has occurred. The fluids should be removed again within 96 hours after drilling operations have ceased.

**If production casing is set all completion fluids shall be removed from the working pits daily. NO completion fluids or non-exempt wastes shall be placed in the reserve pit.**

The fluids should be taken to an authorized disposal well. Please call the District Office at (620) 225-8888 when the fluids have been removed. Form CDP-5 (August 2004), Exploration and Production Waste Transfer, must be filed within 30 days of fluid removal. Conservation division forms are available through our office and on the KCC web site: [kcc.ks.gov/conservation/forms/](http://kcc.ks.gov/conservation/forms/)

**A copy of this letter should be posted in the doghouse along with the approved Intent to Drill.** If you have any questions or concerns please feel free to contact the District Office at (620) 225-8888.