



For KCC Use:
 Effective Date: 10/18/2008
 District # 1
 SGA? Yes No

KANSAS CORPORATION COMMISSION 1023214
 OIL & GAS CONSERVATION DIVISION

Form C-1
 October 2007
 Form must be Typed
 Form must be Signed
 All blanks must be Filled

NOTICE OF INTENT TO DRILL

Must be approved by KCC five (5) days prior to commencing well

Expected Spud Date: 10/21/2008
month day year

OPERATOR: License# 30606
 Name: Murfin Drilling Co., Inc.
 Address 1: 250 N WATER STE 300
 Address 2:
 City: WICHITA State: KS Zip: 67202 + 1216
 Contact Person: Shauna Gunzelman
 Phone: 316-267-3241

CONTRACTOR: License# 30606
 Name: Murfin Drilling Co., Inc.

Well Drilled For:	Well Class:	Type Equipment:
<input checked="" type="checkbox"/> Oil	<input type="checkbox"/> Enh Rec	<input checked="" type="checkbox"/> Infield
<input type="checkbox"/> Gas	<input type="checkbox"/> Storage	<input type="checkbox"/> Mud Rotary
	<input type="checkbox"/> Disposal	<input type="checkbox"/> Air Rotary
<input type="checkbox"/> Seismic ; # of Holes	<input type="checkbox"/> Wildcat	<input type="checkbox"/> Cable
<input type="checkbox"/> Other:	<input type="checkbox"/> Other	

If OWWO: old well information as follows:

Operator:
 Well Name:
 Original Completion Date: Original Total Depth:

Directional, Deviated or Horizontal wellbore? Yes No
 If Yes, true vertical depth:
 Bottom Hole Location:
 KCC DKT #:

Spot Description:
 W2 - W2 - SW Sec. 6 Twp. 22 S. R. 12 E W
 (Q-Q-Q-Q) 1,320 feet from N / S Line of Section
 330 feet from E / W Line of Section

Is SECTION: Regular Irregular?
 (Note: Locate well on the Section Plat on reverse side)

County: Stafford
 Lease Name: Sizzler Well #: 1-6
 Field Name: Drach

Is this a Prorated / Spaced Field? Yes No
 Target Formation(s): LKC, Arbuckle

Nearest Lease or unit boundary line (in footage): 330
 Ground Surface Elevation: 1875 Surveyed feet MSL
 Water well within one-quarter mile: Yes No
 Public water supply well within one mile: Yes No
 Depth to bottom of fresh water: 220
 Depth to bottom of usable water: 220
 Surface Pipe by Alternate: I II
 Length of Surface Pipe Planned to be set: 700

Length of Conductor Pipe (if any):
 Projected Total Depth: 3850
 Formation at Total Depth: Arbuckle

Water Source for Drilling Operations:
 Well Farm Pond Other: Haul
 DWR Permit #:

(Note: Apply for Permit with DWR)
 Will Cores be taken? Yes No
 If Yes, proposed zone:

AFFIDAVIT

The undersigned hereby affirms that the drilling, completion and eventual plugging of this well will comply with K.S.A. 55 et. seq.

It is agreed that the following minimum requirements will be met:

1. Notify the appropriate district office **prior** to spudding of well;
2. A copy of the approved notice of intent to drill **shall be posted** on each drilling rig;
3. The minimum amount of surface pipe as specified below **shall be set** by circulating cement to the top; in all cases surface pipe **shall be set** through all unconsolidated materials plus a minimum of 20 feet into the underlying formation.
4. If the well is dry hole, an agreement between the operator and the district office on **plug length** and **placement** is necessary **prior to plugging**;
5. The appropriate district office will be notified before well is either plugged or production casing is cemented in;
6. If an ALTERNATE II COMPLETION, production pipe shall be cemented from below any usable water to surface within **120 DAYS** of spud date. Or pursuant to Appendix "B" - Eastern Kansas surface casing order #133,891-C, which applies to the KCC District 3 area, alternate II cementing must be completed within 30 days of the spud date or the well shall be plugged. **In all cases, NOTIFY district office** prior to any cementing.

Submitted Electronically

For KCC Use ONLY
 API # 15 - 15-185-23556-00-00
 Conductor pipe required 0 feet
 Minimum surface pipe required 240 feet per ALT. I II
 Approved by: Rick Hestermann 10/13/2008
 This authorization expires: 10/13/2009
 (This authorization void if drilling not started within 12 months of approval date.)
 Spud date: Agent:

Remember to:

- File Drill Pit Application (form CDP-1) with Intent to Drill;
- File Completion Form ACO-1 within 120 days of spud date;
- File acreage attribution plat according to field proration orders;
- Notify appropriate district office 48 hours prior to workover or re-entry;
- Submit plugging report (CP-4) after plugging is completed (within 60 days);
- Obtain written approval before disposing or injecting salt water.
- If this permit has expired (See: authorized expiration date) please check the box below and return to the address below.

Well Not Drilled - Permit Expired Date: Signature of Operator or Agent:

6
22
12
 E
 W



1023214

IN ALL CASES PLOT THE INTENDED WELL ON THE PLAT BELOW

Plat of acreage attributable to a well in a prorated or spaced field

If the intended well is in a prorated or spaced field, please fully complete this side of the form. If the intended well is in a prorated or spaced field complete the plat below showing that the well will be properly located in relationship to other wells producing from the common source of supply. Please show all the wells and within 1 mile of the boundaries of the proposed acreage attribution unit for gas wells and within 1/2 mile of the boundaries of the proposed acreage attribution unit for oil wells.

API No. 15 - 15-185-23556-00-00

Operator: Murfin Drilling Co., Inc.

Lease: Sizzler

Well Number: 1-6

Field: Drach

Location of Well: County: Stafford

1,320 feet from N / S Line of Section

330 feet from E / W Line of Section

Sec. 6 Twp. 22 S. R. 12 E W

Number of Acres attributable to well: _____

QTR/QTR/QTR/QTR of acreage: _____ - W2 - W2 - SW

Is Section: Regular or Irregular

If Section is Irregular, locate well from nearest corner boundary.

Section corner used: NE NW SE SW

PLAT

(Show location of the well and shade attributable acreage for prorated or spaced wells.)

(Show footage to the nearest lease or unit boundary line.)

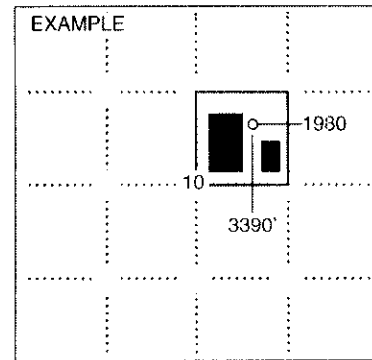
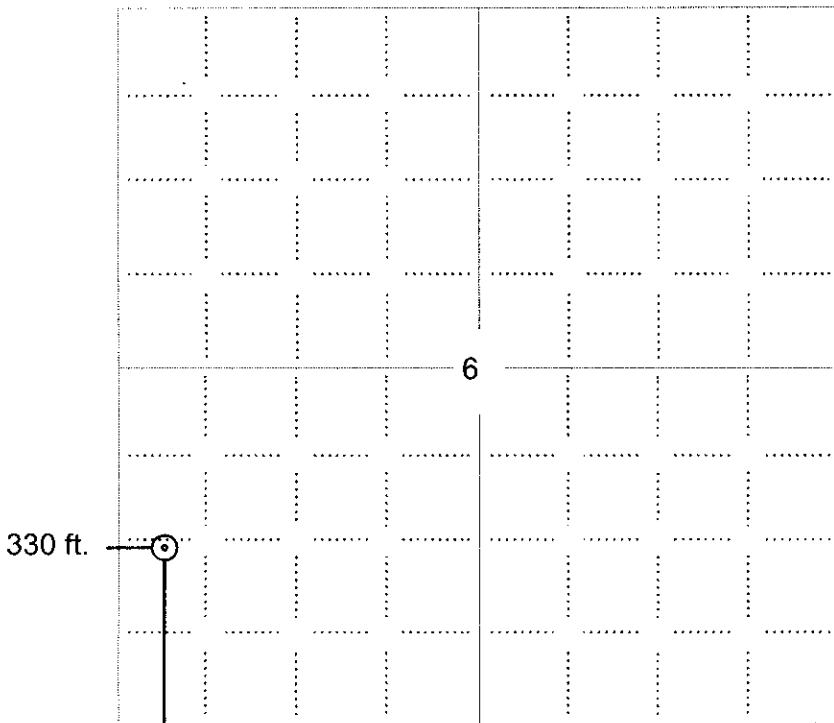

SEWARD CO.

NOTE: In all cases locate the spot of the proposed drilling locaton.

1320 ft.

In plotting the proposed location of the well, you must show:

1. The manner in which you are using the depicted plat by identifying section lines, i.e. 1 section, 1 section with 8 surrounding sections, 4 sections, etc.
2. The distance of the proposed drilling location from the south / north and east / west outside section lines.
3. The distance to the nearest lease or unit boundary line (in footage).
4. If proposed location is located within a prorated or spaced field a certificate of acreage attribution plat must be attached: (CO-7 for oil wells; CG-8 for gas wells).



KANSAS CORPORATION COMMISSION 1023214
OIL & GAS CONSERVATION DIVISION

Form CDP-1
April 2004
Form must be Typed

APPLICATION FOR SURFACE PIT

Submit in Duplicate

Operator Name: Murfin Drilling Co., Inc.		License Number: 30606
Operator Address: 250 N WATER STE 300		WICHITA KS 67202
Contact Person: Shauna Gunzelman		Phone Number: 316-267-3241
Lease Name & Well No.: Sizzler 1-6		Pit Location (QQQQ): W2 W2 SW
Type of Pit: <input type="checkbox"/> Emergency Pit <input type="checkbox"/> Burn Pit <input type="checkbox"/> Settling Pit <input checked="" type="checkbox"/> Drilling Pit <input type="checkbox"/> Workover Pit <input type="checkbox"/> Haul-Off Pit <i>(If WP Supply API No. or Year Drilled)</i>	Pit is: <input checked="" type="checkbox"/> Proposed <input type="checkbox"/> Existing If Existing, date constructed: _____ Pit capacity: 600 (bbls)	Sec. 6 Twp. 22 R. 12 <input type="checkbox"/> East <input checked="" type="checkbox"/> West 1,320 Feet from <input type="checkbox"/> North / <input checked="" type="checkbox"/> South Line of Section 330 Feet from <input type="checkbox"/> East / <input checked="" type="checkbox"/> West Line of Section Stafford County
Is the pit located in a Sensitive Ground Water Area? <input checked="" type="checkbox"/> Yes <input type="checkbox"/> No		Chloride concentration: _____ mg/l <i>(For Emergency Pits and Settling Pits only)</i>
Is the bottom below ground level? <input checked="" type="checkbox"/> Yes <input type="checkbox"/> No	Artificial Liner? <input type="checkbox"/> Yes <input checked="" type="checkbox"/> No	How is the pit lined if a plastic liner is not used? Bentonite and solids from drilling operation self seal pits
Pit dimensions (all but working pits): 100 Length (feet) 100 Width (feet) <input type="checkbox"/> N/A: Steel Pits Depth from ground level to deepest point: 4 (feet) <input type="checkbox"/> No Pit		
If the pit is lined give a brief description of the liner material, thickness and installation procedure.		Describe procedures for periodic maintenance and determining liner integrity, including any special monitoring.
Distance to nearest water well within one-mile of pit 308 feet Depth of water well 110 feet		Depth to shallowest fresh water 16 feet. Source of information: <input type="checkbox"/> measured <input type="checkbox"/> well owner <input type="checkbox"/> electric log <input checked="" type="checkbox"/> KDWR
Emergency, Settling and Burn Pits ONLY: Producing Formation: _____ Number of producing wells on lease: _____ Barrels of fluid produced daily: _____ Does the slope from the tank battery allow all spilled fluids to flow into the pit? <input type="checkbox"/> Yes <input type="checkbox"/> No		Drilling, Workover and Haul-Off Pits ONLY: Type of material utilized in drilling/workover: Bentonite Number of working pits to be utilized: 4 Abandonment procedure: Allow pits to evaporate until dry then backfill with conditions allow. Drill pits must be closed within 365 days of spud date.
Submitted Electronically		

KCC OFFICE USE ONLY		Steel Pit <input type="checkbox"/>	RFAC <input checked="" type="checkbox"/>	RFAS <input checked="" type="checkbox"/>
Date Received: 10/13/2008	Permit Number: 15-185-23556-00-00	Permit Date: 10/13/2008	Lease Inspection: <input checked="" type="checkbox"/> Yes <input type="checkbox"/> No	

Mail to: KCC - Conservation Division, 130 S. Market - Room 2078, Wichita, Kansas 67202

ADVANTAGE ELEVATIONS

OIL FIELD SURVEYORS

BOX 8604 - PRATT, KS 67124
(620) 672-6491

926083

INVOICE NO.

MURFIN DRILLING COMPANY INC
OPERATOR

1-6
NO.

Sizzler

FARM

Stafford
COUNTY

6 22s 12w
S T R

1320' FSL & 330' EWL
LOCATION

ELEVATION: 1875' GR



MURFIN DRILLING COMPANY INC
250 N Water St Ste 300
Wichita KS 67202

From Hudson on FAS 635
Go North on FAS 980 4 miles
West on FAS 1484 1 mile.

AUTHORIZED BY: Shauna

SCALE: 1" = 1000'

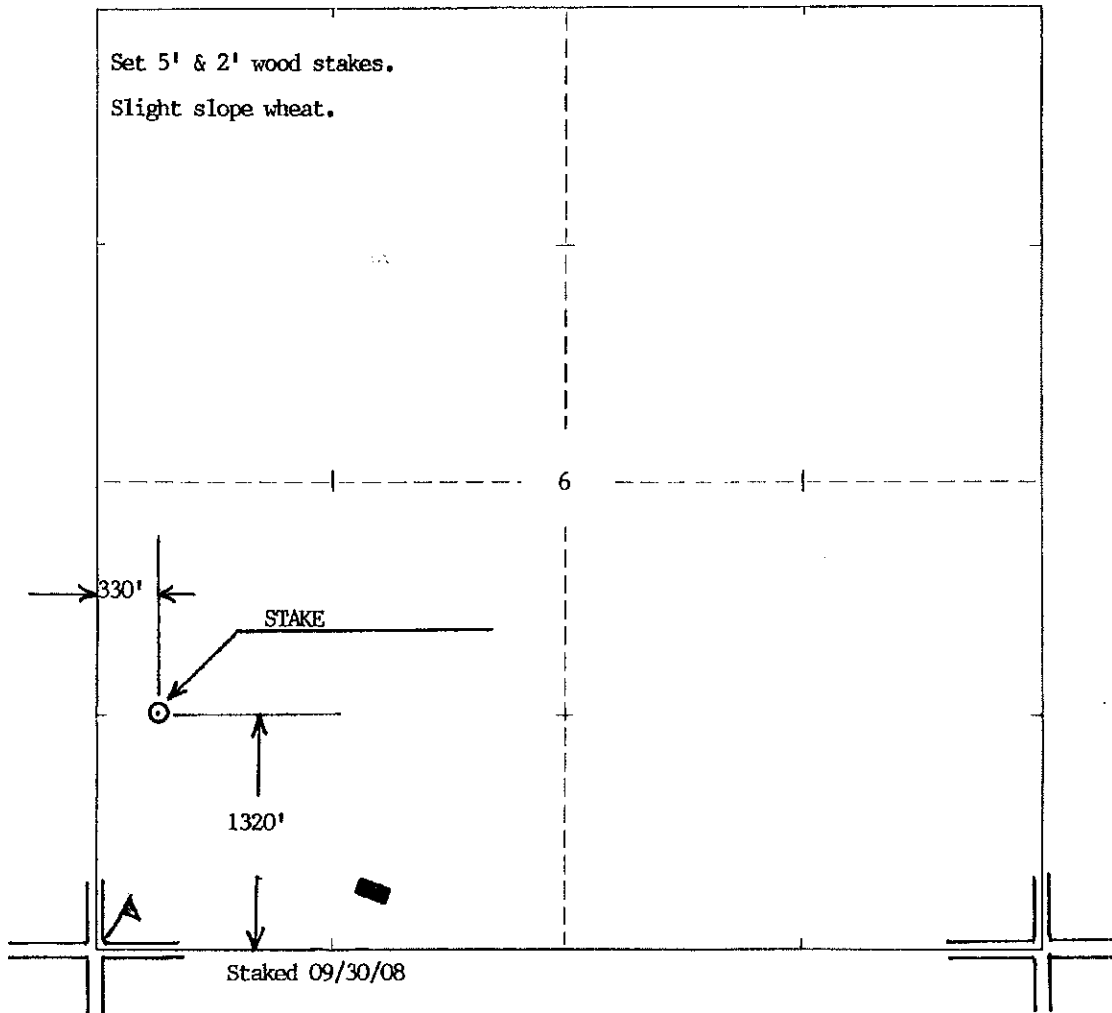

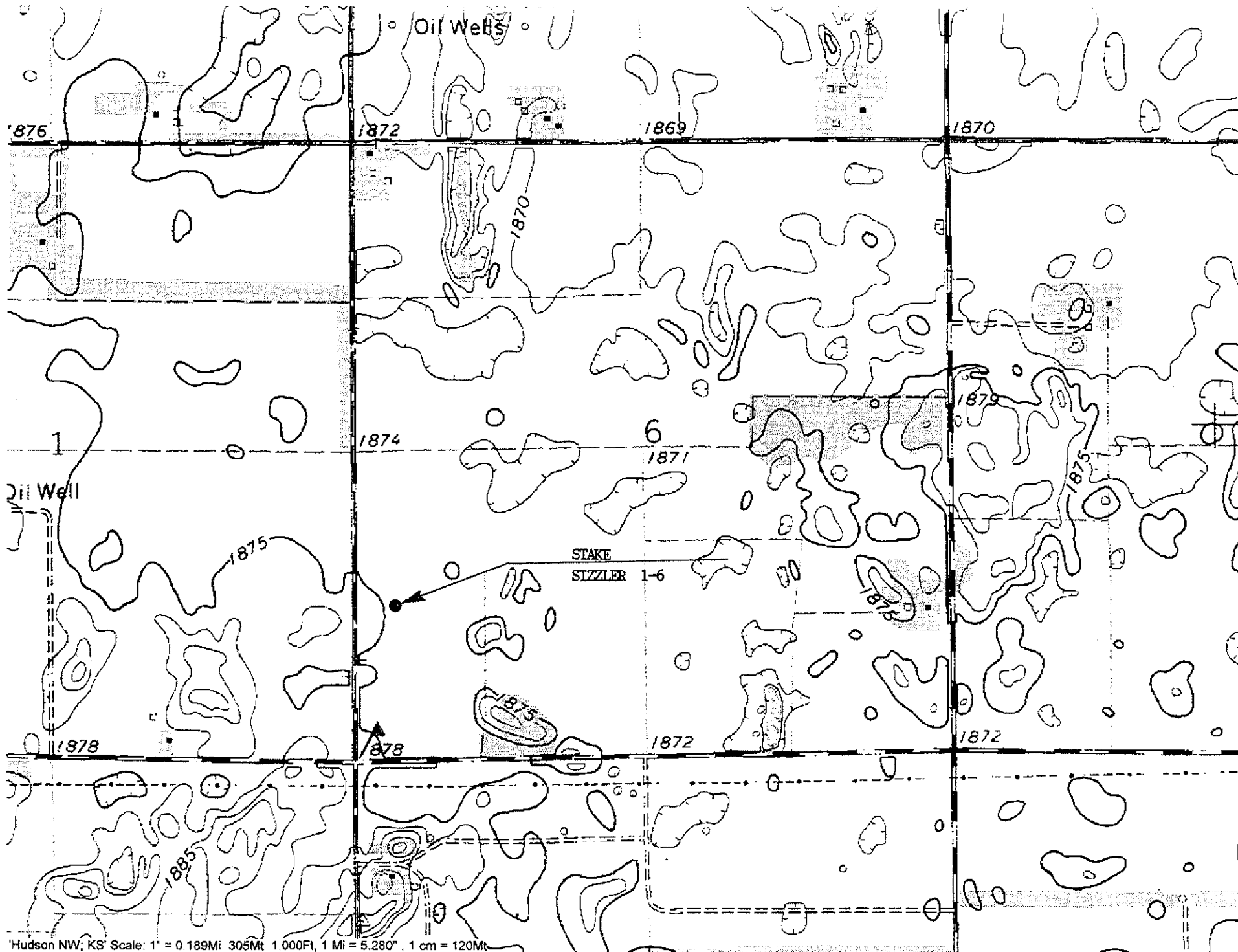

'Hudson NW, KS' Scale: 1" = 0.189Mi 305Mt 1,000Ft, 1 Mi = 5,280', 1 cm = 120Mt



*Kathleen Sebelius, Governor
Thomas E. Wright, Chairman
Michael C. Moffet, Commissioner
Joseph F. Harkins, Commissioner*

October 13, 2008

Shauna Gunzelman
Murfin Drilling Co., Inc.
250 N WATER STE 300
WICHITA, KS67202-1216

Re: Drilling Pit Application
Sizzler Lease Well No. 1-6
SW/4 Sec.06-22S-12W
Stafford County, Kansas

Dear Shauna Gunzelman:

District staff has inspected the above referenced location and has determined that the reserve pit shall be constructed **without slots**, the bottom shall be flat and reasonably level and the free fluids must be removed. The fluids are to be removed from the reserve pit as soon as the Hutchinson Salt section has been drilled through and displacement of the fluids into the reserve pit has occurred. The fluids should be removed again within 96 hours after drilling operations have ceased.

If production casing is set all completion fluids shall be removed from the working pits daily. NO completion fluids or non-exempt wastes shall be placed in the reserve pit.

The fluids should be taken to an authorized disposal well. Please call the District Office at (620) 225-8888 when the fluids have been removed. Form CDP-5 (August 2004), Exploration and Production Waste Transfer, must be filed within 30 days of fluid removal. Conservation division forms are available through our office and on the KCC web site: kcc.ks.gov/conservation/forms/

A copy of this letter should be posted in the doghouse along with the approved Intent to Drill. If you have any questions or concerns please feel free to contact the District Office at (620) 225-8888.