

For KCC Use:

Effective Date: 10-20-08

District # 4

SGA? Yes No

KANSAS CORPORATION COMMISSION OIL & GAS CONSERVATION DIVISION

NOTICE OF INTENT TO DRILL

Must be approved by KCC five (5) days prior to commencing well

Form C-1

October 2007

Form must be Typed

Form must be Signed

All blanks must be Filled

Expected Spud Date: October 14, 2008
month day year

OPERATOR: License# 34015
Name: Zenith Petroleum Corporation
Address 1: 5766 S. Ivy Street
Address 2:
City: Greenwood Village State: CO Zip: 80111
Contact Person: Jack Johnston
Phone: Office (303) 779-1900 Cell: (303) 601-1001
CONTRACTOR: License# 33724
Name: Warren Drilling, LLC

Spot Description: NE SE SW NE Sec. 8 Twp. 14 S. R. 29 E W
(0000) 2,175 feet from N / S Line of Section
1,385 feet from E / W Line of Section

Is SECTION: Regular Irregular?

(Note: Locate well on the Section Plat on reverse side)

County: Gove
Lease Name: Harris Well #: 8-1
Field Name: Coberly West Field
Is this a Prorated / Spaced Field? Yes No
Target Formation(s): Mississippian

Well Drilled For: Oil Gas Enh Rec Storage Disposal Seismic Other
Well Class: Infield Pool Ext. Wildcat Other
Type Equipment: Mud Rotary Air Rotary Cable

Operator: _____
Well Name: _____
Original Completion Date: _____ Original Total Depth: _____

Directional, Deviated or Horizontal wellbore? Yes No
If Yes, true vertical depth: _____
Bottom Hole Location: _____
KCC DKT #: _____

Nearest Lease or unit boundary line (in footage): 465 per operator feet MSL
Ground Surface Elevation: 2687.5 feet MSL
Water well within one-quarter mile: Yes No
Public water supply well within one mile: Yes No
Depth to bottom of fresh water: 150'
Depth to bottom of usable water: 1100'
Surface Pipe by Alternate: I II
Length of Surface Pipe Planned to be set: 200'
Length of Conductor Pipe (if any): None
Projected Total Depth: 4500'
Formation at Total Depth: Mississippian
Water Source for Drilling Operations: Well Farm Pond Other: _____
DWR Permit #: _____

(Note: Apply for Permit with DWR)
Will Cores be taken? Yes No
If Yes, proposed zone: _____

AFFIDAVIT

The undersigned hereby affirms that the drilling, completion and eventual plugging of this well will comply with K.S.A. 55 et. seq.
It is agreed that the following minimum requirements will be met:

1. Notify the appropriate district office **prior** to spudding of well;
2. A copy of the approved notice of intent to drill **shall be** posted on each drilling rig;
3. The minimum amount of surface pipe as specified below **shall be set** by circulating cement to the top; in all cases surface pipe **shall be** through all unconsolidated materials plus a minimum of 20 feet into the underlying formation.
4. If the well is dry hole, an agreement between the operator and the district office on plug length and placement is necessary **prior to plugging**;
5. The appropriate district office will be notified before well is either plugged or production casing is cemented in;
6. If an ALTERNATE II COMPLETION, production pipe shall be cemented from below any usable water to surface within **120 DAYS** of spud date.
Or pursuant to Appendix "B" - Eastern Kansas surface casing order #133,891-C, which applies to the KCC District 3 area, alternate II cementing must be completed within 30 days of the spud date or the well shall be plugged. **In all cases, NOTIFY district office** prior to any cementing.

I hereby certify that the statements made herein are true and correct to the best of my knowledge and belief.

Date: 10/9/08 Signature of Operator or Agent: _____ Title: Operator

RECEIVED
KANSAS CORPORATION COMMISSION
OCT 14 2008
CONSERVATION DIVISION
WICHITA, KS

For KCC Use ONLY
API # 15 - 063-21751-0000
Conductor pipe required None feet
Minimum surface pipe required 200 feet per ALT. I II
Approved by: [Signature]
This authorization expires: 10/15/09
(This authorization void if drilling not started within 12 months of approval date.)
Spud date: _____ Agent: _____

Remember to:

- File Drill Pit Application (form CDP-1) with Intent to Drill;
- File Completion Form ACO-1 within 120 days of spud date;
- File acreage attribution plat according to field proration orders;
- Notify appropriate district office 48 hours prior to workover or re-entry;
- Submit plugging report (CP-4) after plugging is completed (within 60 days);
- Obtain written approval before disposing or injecting salt water.
- If this permit has expired (See: authorized expiration date) please check the box below and return to the address below.

Well Not Drilled - Permit Expired Date: _____
Signature of Operator or Agent: _____

8
14
29
 E
 W

IN ALL CASES PLOT THE INTENDED WELL ON THE PLAT BELOW

Plat of acreage attributable to a well in a prorated or spaced field

If the intended well is in a prorated or spaced field, please fully complete this side of the form. If the intended well is in a prorated or spaced field complete the plat below showing that the well will be properly located in relationship to other wells producing from the common source of supply. Please show all the wells and within 1 mile of the boundaries of the proposed acreage attribution unit for gas wells and within 1/2 mile of the boundaries of the proposed acreage attribution unit for oil wells.

API No. 15 - 063-21751-0000
 Operator: Zenith Petroleum Corporation
 Lease: Harris
 Well Number: 8-1
 Field: Coberly West Field

Location of Well: County: Gove
2,175 feet from N / S Line of Section
1,385 feet from E / W Line of Section
 Sec. 8 Twp. 14 S. R. 29 E W

Number of Acres attributable to well:
 QTR/QTR/QTR/QTR of acreage: SE - SE - SW-NE - NE

Is Section: Regular or Irregular

If Section is Irregular, locate well from nearest corner boundary.
 Section corner used: NE NW SE SW

PLAT

*(Show location of the well and shade attributable acreage for prorated or spaced wells.)
 (Show footage to the nearest lease or unit boundary line.)*

RECEIVED
 KANSAS CORPORATION COMMISSION

OCT 14 2008

CONSERVATION DIVISION
 WICHITA, KS

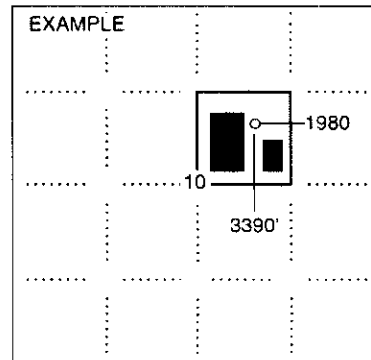

NOTE: In all cases locate the spot of the proposed drilling location.

In plotting the proposed location of the well, you must show:

1. The manner in which you are using the depicted plat by identifying section lines, i.e. 1 section, 1 section with 8 surrounding sections, 4 sections, etc.
2. The distance of the proposed drilling location from the south / north and east / west outside section lines.
3. The distance to the nearest lease or unit boundary line (in footage).
4. If proposed location is located within a prorated or spaced field a certificate of acreage attribution plat must be attached: (CO-7 for oil wells; CG-8 for gas wells).

15-003-21751-0000

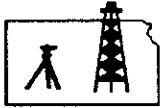

ROBINSON SERVICES

Oil Field & Construction Staking CONSERVATION DIVISION
P.O. Box 2324 WICHITA, KS

Garden City, Kansas 67846

Office/Fax: (620) 276-6159

Cell: (620) 272-1499



v081408-e
PLAT NO.

7284
INVOICE NO.

Zenith Petroleum Corporation

OPERATOR

Gove County, KS

COUNTY

Harris #8-1 (2nd restake)

LEASE NAME

2175' FNL - 1385' FEL

LOCATION SPOT

8 14s 29w
Sec. Twp. Rng.

GR. ELEVATION: 2687.5'

SCALE: 1" = 1000'
DATE STAKED: August 13th, 2008
MEASURED BY: Tom W.
DRAWN BY: Gabe Q.
AUTHORIZED BY: Jim B.



Directions: From the center of Gove, Ks at the intersection of Hwy 23 & CR 451 - Now go 7.2 miles South on Hwy 23 - Now go 3 miles West on unknown road to the NE corner of section 8-14s-29w - Now go 0.5 mile South on unknown road to ingress West stake into - Now go 1385' West through milo - Now go approx. 450' North through CRP into staked location

Final ingress must be verified with land owner or Zenith Petroleum Corporation

This drawing does not constitute a monumented survey or a land survey plat
This drawing is for construction purposes only

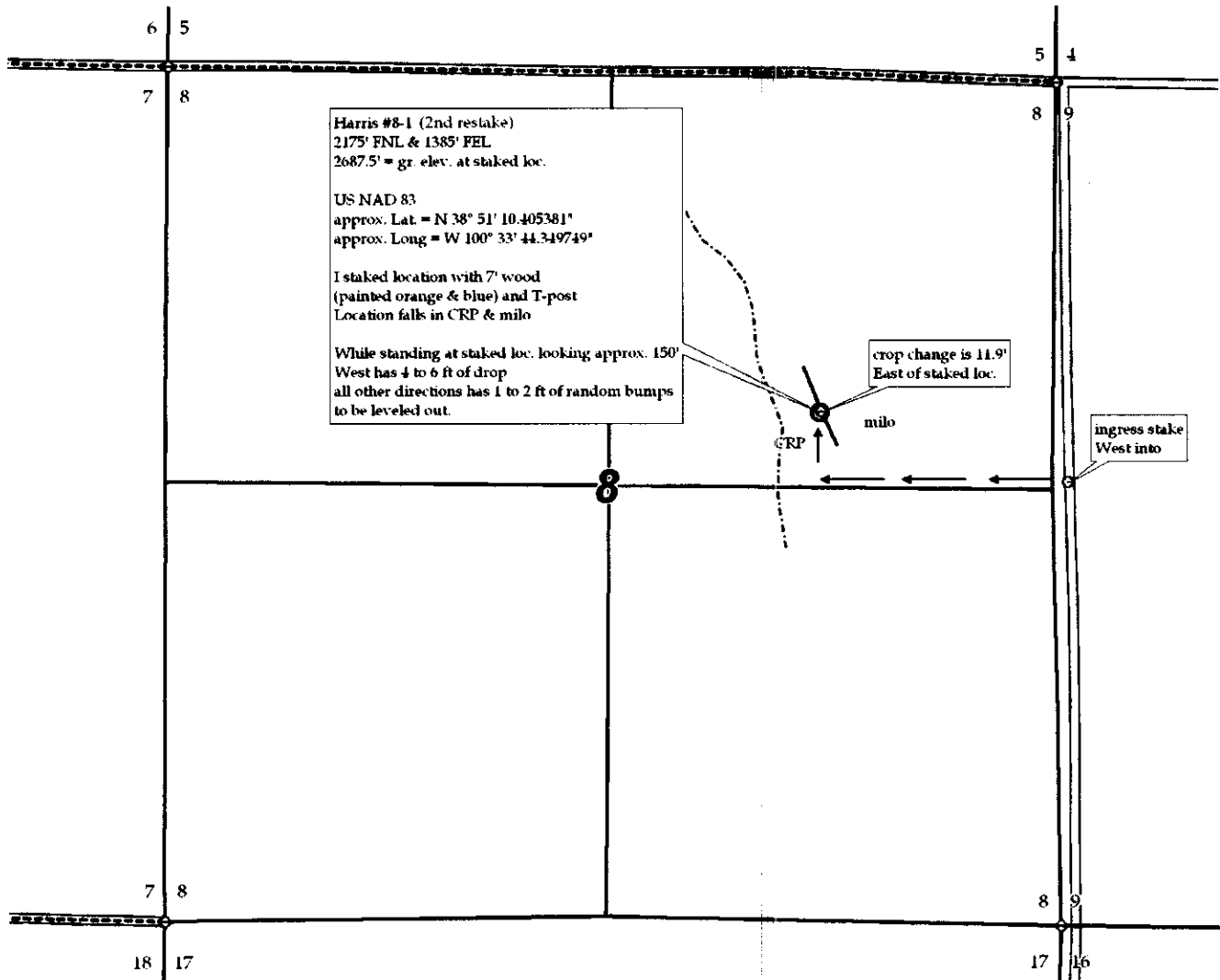

**KANSAS CORPORATION COMMISSION
OIL & GAS CONSERVATION DIVISION
APPLICATION FOR SURFACE PIT**

Form CDP-1
April 2004
Form must be Typed

Submit in Duplicate

Operator Name: Zenith Petroleum Corporation		License Number: 34015	
Operator Address: 5766 S. Ivy Street		Greenwood Village CO 80111	
Contact Person: Jack Johnston		Phone Number: Office (303) 779-1900 Cell: (303) 601-1001	
Lease Name & Well No.: Harris 8-1		Pit Location (QQQQ): SE^{NE} SE SW NE	
Type of Pit: <input type="checkbox"/> Emergency Pit <input type="checkbox"/> Burn Pit <input type="checkbox"/> Settling Pit <input checked="" type="checkbox"/> Drilling Pit <input type="checkbox"/> Workover Pit <input type="checkbox"/> Haul-Off Pit <i>(If WP Supply API No. or Year Drilled)</i>		Pit is: <input checked="" type="checkbox"/> Proposed <input type="checkbox"/> Existing If Existing, date constructed: _____ Pit capacity: _____ (bbls)	
Is the pit located in a Sensitive Ground Water Area? <input type="checkbox"/> Yes <input checked="" type="checkbox"/> No		Chloride concentration: _____ mg/l <i>(For Emergency Pits and Settling Pits only)</i>	
Is the bottom below ground level? <input checked="" type="checkbox"/> Yes <input type="checkbox"/> No		Artificial Liner? <input type="checkbox"/> Yes <input checked="" type="checkbox"/> No	
How is the pit lined if a plastic liner is not used? Dr Bentonite			
Pit dimensions (all but working pits): <u>90</u> Length (feet) <u>70</u> Width (feet) <input type="checkbox"/> N/A: Steel Pits Depth from ground level to deepest point: <u>5</u> (feet) <input type="checkbox"/> No Pit			
If the pit is lined give a brief description of the liner material, thickness and installation procedure.		Describe procedures for periodic maintenance and determining liner integrity, including any special monitoring.	
Distance to nearest water well within one-mile of pit <u>N/A</u> feet Depth of water well _____ feet		Depth to shallowest fresh water _____ feet. Source of information: <input type="checkbox"/> measured <input type="checkbox"/> well owner <input type="checkbox"/> electric log <input checked="" type="checkbox"/> KDWR	
Emergency, Settling and Burn Pits ONLY: Producing Formation: _____ Number of producing wells on lease: _____ Barrels of fluid produced daily: _____ Does the slope from the tank battery allow all spilled fluids to flow into the pit? <input type="checkbox"/> Yes <input type="checkbox"/> No		Drilling, Workover and Haul-Off Pits ONLY: Type of material utilized in drilling/workover: <u>Drilling Mud- Chemical</u> Number of working pits to be utilized: <u>3</u> Abandonment procedure: <u>Air Dry - Back Fill</u> Drill pits must be closed within 365 days of spud date.	
I hereby certify that the above statements are true and correct to the best of my knowledge and belief.		RECEIVED KANSAS CORPORATION COMMISSION	
Date: <u>10/9/08</u>		OCT 14 2008 CONSERVATION DIVISION WICHITA KS	
Signature of Applicant or Agent: _____			
KCC OFFICE USE ONLY			
Date Received: <u>10/14/08</u> Permit Number: _____		Steel Pit <input type="checkbox"/> RFAC <input type="checkbox"/> RFAS <input type="checkbox"/>	
Permit Date: <u>10/14/08</u>		Lease Inspection: <input type="checkbox"/> Yes <input checked="" type="checkbox"/> No	

15-063-2175-000