

For KCC Use:
Effective Date: 11-1-08
District #: 3
SGA7: Yes No

KANSAS CORPORATION COMMISSION
OIL & GAS CONSERVATION DIVISION

Form C-1
October 2007
Form must be Typed
Form must be Signed
All blanks must be Filled

NOTICE OF INTENT TO DRILL

Must be approved by KCC five (5) days prior to commencing well

Expected Spud Date: 11 10 2008
month day year

OPERATOR: License# 33465
Name: Trimble/McClaskey Oil, LLC
Address 1: P.O. Box 171
Address 2:
City: Gridley State: KS Zip: 66852
Contact Person: Randy Trimble
Phone: (620) 836-2000

CONTRACTOR: License# 30567
Name: Rig 6 Drilling Co., Inc.

Well Drilled For: Oil Gas Enh Rec Storage Disposal Selenic: # of Holes Other:
Well Class: Infield Pool Ext. Wildcat Other
Type Equipment: Mud Rotary Air Rotary Cable

If CWWO: old well information as follows:

Operator:
Well Name:
Original Completion Date: Original Total Depth:

Directional, Deviated or Horizontal wellbore? Yes No
If Yes, true vertical depth:
Bottom Hole Location:
KCC DKT #:

Spot Description:
C N/2 NW NE Sec. 36 Twp. 24 S. R. 12 E W
(4000) 330 feet from N / S Line of Section
1980 feet from E / W Line of Section

Is SECTION: Regular Irregular?
(Note: Locate well on the Section Plat on reverse side)

County: Greenwood
Lease Name: McConaughy Well #: 1-36
Field Name: Quincy

Is this a Prorated / Spaced Field? Yes No
Target Formation(s): Bartlesville / Mississippi

Nearest Lease or unit boundary line (in footage): 330'
Ground Surface Elevation: 1087 (Est. from USGS Topo) feet MSL

Water well within one-quarter mile: Yes No
Public water supply well within one mile: Yes No

Depth to bottom of fresh water: 100' (KCC)
Depth to bottom of usable water: 225' (KCC)

Surface Pipe by Alternate: 40' (KCC)
Length of Surface Pipe Planned to be set:

Length of Conductor Pipe (if any): None
Projected Total Depth: 1750'
Formation at Total Depth: Mississippian

Water Source for Drilling Operations:
 Well Farm Pond Other:

DWR Permit #: (Note: Apply for Permit with DWR)

Will Cores be taken? Yes No
If Yes, proposed core: _____

AFFIDAVIT

The undersigned hereby affirms that the drilling, completion and eventual plugging of this well will comply with K.S.A. 55 et. seq.

It is agreed that the following minimum requirements will be met:

1. Notify the appropriate district office prior to spudding of well;
2. A copy of the approved notice of intent to drill shall be posted on each drilling rig;
3. The minimum amount of surface pipe as specified below shall be set by circulating cement to the top; in all cases surface pipe shall be set through all unconsolidated materials plus a minimum of 20 feet into the underlying formation.
4. If the well is dry hole, an agreement between the operator and the district office on plug length and placement is necessary prior to plugging;
5. The appropriate district office will be notified before well is either plugged or production casing is cemented in;
6. If an ALTERNATE II COMPLETION, production pipe shall be cemented from below any usable water to surface within 120 DAYS of spud date. Or pursuant to Appendix "B" - Eastern Kansas surface casing order #133,881-C, which applies to the KCC District 3 area, alternate II cementing must be completed within 30 days of the spud date or the well shall be plugged. In all cases, NOTIFY district office prior to any cementing.

I hereby certify that the statements made herein are true and correct to the best of my knowledge and belief.

Date: 10/22/08 Signature of Operator or Agent: Randy Trimble Title: _____

For KCC Use ONLY
API # 15 - 073-24103-0000
Conductor pipe required None feet
Minimum surface pipe required 40 feet per ALT.
Approved by: Randy Trimble
This authorization expires: 10-27-09
(This authorization void if drilling not started within 12 months of approval date.)
Spud date: _____ Agent: _____

- Remember to:
- File Drill Pit Application (form GDP-1) with Intent to Drill;
 - File Completion Form ACO-1 within 120 days of spud date;
 - File acreage attribution plat according to field prorated orders;
 - Notify appropriate district office 48 hours prior to workover or re-entry;
 - Submit plugging report (CP-4) after plugging is completed (within 60 days);
 - Obtain written approval before disposing or injecting salt water.
- If this permit has expired (See: authorized expiration date) please check the box below and return to the address below.
 Well Not Drilled - Permit Expired Date: _____
Signature of Operator or Agent: _____

36 24 12 7 PM

Mail to: KCC - Conservation Division, 130 S. Market - Room 207B, Wichita, Kansas 67202

RECEIVED
KANSAS CORPORATION COMMISSION

OCT 24 2008

CONSERVATION DIVISION
WICHITA, KS

IN ALL CASES PLOT THE INTENDED WELL ON THE PLAT BELOW

Plat of acreage attributable to a well in a prorated or spaced field

If the intended well is in a prorated or spaced field, please fully complete this side of the form. If the intended well is in a prorated or spaced field complete the plat below showing that the well will be properly located in relationship to other wells producing from the common source of supply. Please show all the wells and within 1 mile of the boundaries of the proposed acreage attribution unit for gas wells and within 1/2 mile of the boundaries of the proposed acreage attribution unit for oil wells.

API No. 15 - 073-24103-0000
 Operator: Trimble Maclaskey Oil, LLC
 Lease: McConnaughey
 Well Number: 1-36
 Field: Quincy
 Number of Acres attributable to well: _____
 QTR/QTR/QTR/QTR of acreage: _____

Location of Well: County: C N/2 NW NE
330 feet from N / S Line of Section
1980 feet from E / W Line of Section
 Sec. 36 Twp. 24 S. R. 12 E W

Is Section: Regular or Irregular

If Section is irregular, locate well from nearest corner boundary.

Section corner used: NE NW SE SW

PLAT

(Show location of the well and shade attributable acreage for prorated or spaced wells.)

(Show footage to the nearest lease or unit boundary line.)

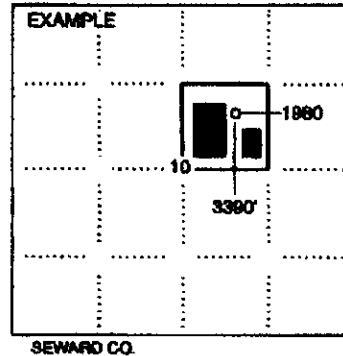
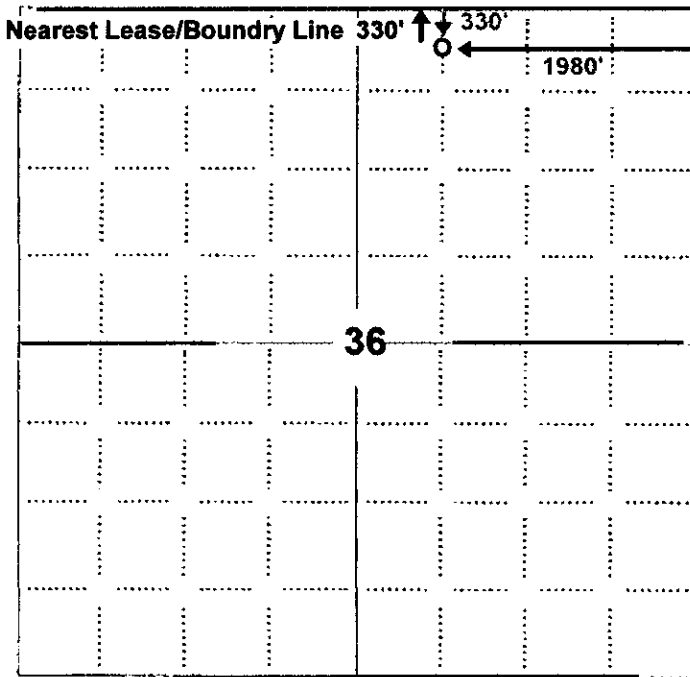

NOTE: In all cases locate the spot of the proposed drilling location.

In plotting the proposed location of the well, you must show:

1. The manner in which you are using the depicted plat by identifying section lines, i.e. 1 section, 1 section with 8 surrounding sections, 4 sections, etc.
2. The distance of the proposed drilling location from the south / north and east / west outside section lines.
3. The distance to the nearest lease or unit boundary line (in footage).
4. If proposed location is located within a prorated or spaced field a certificate of acreage attribution plat must be attached: (CO-7 for oil wells; CG-8 for gas wells).

RECEIVED
 KANSAS CORPORATION COMMISSION

OCT 24 2008

CONSERVATION DIVISION
 WICHITA, KS

**KANSAS CORPORATION COMMISSION
OIL & GAS CONSERVATION DIVISION
APPLICATION FOR SURFACE PIT**

Form CDP-1
April 2004
Form must be Typed

Submit in Duplicate

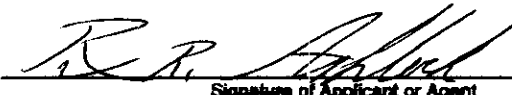
Operator Name: Trimble Maclaskey Oil, LLC		License Number: 33465
Operator Address: P.O. Box 171, Gridley, KS 66852		
Contact Person: Randy Trimble		Phone Number: (620) 836-2000
Lease Name & Well No.: McConnaughey #1-36		Pit Location (QQQQ): C N/2 NW NE
Type of Pit: <input type="checkbox"/> Emergency Pit <input type="checkbox"/> Burn Pit <input type="checkbox"/> Settling Pit <input checked="" type="checkbox"/> Drilling Pit <input type="checkbox"/> Workover Pit <input type="checkbox"/> Haul-Off Pit <small>(If WOP Supply API No. or Year Drilled)</small>	Pit is: <input checked="" type="checkbox"/> Proposed <input type="checkbox"/> Existing If Existing, date constructed: _____ Pit capacity: 200+/- (bbls)	Sec. 36 Twp. 24 R. 12 <input checked="" type="checkbox"/> East <input type="checkbox"/> West 330 Feet from <input checked="" type="checkbox"/> North / <input type="checkbox"/> South Line of Section 1980 Feet from <input checked="" type="checkbox"/> East / <input type="checkbox"/> West Line of Section Greenwood County
Is the pit located in a Sensitive Ground Water Area? <input type="checkbox"/> Yes <input checked="" type="checkbox"/> No		Chloride concentration: NA mg/l <small>(For Emergency Pits and Settling Pits only)</small>
Is the bottom below ground level? <input checked="" type="checkbox"/> Yes <input type="checkbox"/> No	Artificial Liner? <input type="checkbox"/> Yes <input checked="" type="checkbox"/> No	How is the pit lined if a plastic liner is not used? Native clay(s) in soil
Pit dimensions (all but working pits): 35 Length (feet) 8 Width (feet) <input type="checkbox"/> N/A: Steel Pits Depth from ground level to deepest point: 5 (feet) <input type="checkbox"/> No Pit		
If the pit is lined give a brief description of the liner material, thickness and installation procedure.		Describe procedures for periodic maintenance and determining liner integrity, including any special monitoring. Contant on-site monitoring and maintance while drilling and completion
Distance to nearest water well within one-mile of pit None feet Depth of water well _____ feet		Depth to shallowest fresh water _____ feet. <input type="checkbox"/> KCC Source of information: <input type="checkbox"/> measured <input type="checkbox"/> well owner <input type="checkbox"/> electric log <input type="checkbox"/> KDWR
Emergency, Settling and Burn Pits ONLY: Producing Formation: _____ Number of producing wells on lease: _____ Barrels of fluid produced daily: _____ Does the slope from the tank battery allow all spilled fluids to flow into the pit? <input type="checkbox"/> Yes <input type="checkbox"/> No		Drilling, Workover and Haul-Off Pits ONLY: Type of material utilized in drilling/workover: Fresh water & bentonite Number of working pits to be utilized: 2 Abandonment procedure: Let water evaporate, back fill with soil Drill pits must be closed within 365 days of spud date.
I hereby certify that the above statements are true and correct to the best of my knowledge and belief.		
<u>10/22/08</u> Date	 Signature of Applicant or Agent	<i>15-073-24103-0000</i>
KCC OFFICE USE ONLY		
Date Received: <u>10/24/08</u>	Permit Number: _____	Permit Date: <u>10/24/08</u> Lease Inspection: <input type="checkbox"/> Yes <input checked="" type="checkbox"/> No
Steel Pit <input type="checkbox"/> RFAC <input type="checkbox"/> RFAS <input type="checkbox"/>		

Mail to: KCC - Conservation Division, 130 S. Market - Room 2078, Wichita, Kansas 67202

RECEIVED
KANSAS CORPORATION COMMISSION

OCT 24 2008

CONSERVATION DIVISION
WICHITA, KS