

WELL PLUGGING RECORD

Give All Information Completely
Make Required Affidavit
Mail or Deliver Report to:
Conservation Division
State Corporation Commission
211 No. Broadway
Wichita, Kansas

NORTH

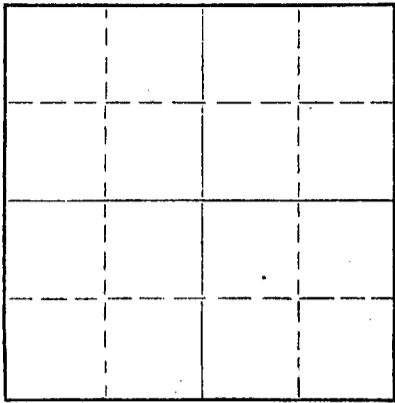

Locate well correctly on above
Section Plat

Sheridan County, Sec. 17 Twp. 9 Rge. (E) 28 (W)
Location as "NE/CNW%SW%" or footage from lines SE SE SE
Lease Owner Jones, Shelburne & Farmer, Inc.
Lease Name KRANNAWITTER Well No. 1
Office Address Russell, Kansas
Character of Well (completed as Oil, Gas or Dry Hole) X Dry hole
Date well completed 3/14 19 57
Application for plugging filed 3/14 19 57
Application for plugging approved 3/14 19 57
Plugging commenced 3/14 19 57
Plugging completed 3/14 19 57
Reason for abandonment of well or producing formation DRY

If a producing well is abandoned, date of last production 19
Was permission obtained from the Conservation Division or its agents before plugging was commenced? yes

Name of Conservation Agent who supervised plugging of this well Eldon Petty
Producing formation Depth to top Bottom Total Depth of Well 4575 Feet
Show depth and thickness of all water, oil and gas formations.

OIL, GAS OR WATER RECORDS

CASING RECORD

FORMATION	CONTENT	FROM	TO	SIZE	PUT IN	PULLED OUT
				8-5/8	235	None

Describe in detail the manner in which the well was plugged, indicating where the mud fluid was placed and the method or methods used in introducing it into the hole. If cement or other plugs were used, state the character of same and depth placed, from feet to feet for each plug set.

1. Filled hole with heavy mud
2. Pushed plug to 230 feet
3. Dumped 1/2 sack hulls on top of plug
4. Mixed 15 sacks cement and dumped on top of hulls
5. Filled hole to top
6. Pushed plug to 40 feet
7. Dumped in 1/2 sack hulls
8. Mixed 10 sacks cement and filled hole to top with same.

RECEIVED
CORPORATION COMMISSION
APR 1 1957
04-01-1957
CONSERVATION DIVISION
KANSAS

(If additional description is necessary, use BACK of this sheet)
Name of Plugging Contractor Jones, Shelburne & Farmer, Inc.
Address Russell, Kansas

STATE OF Kansas, COUNTY OF Russell, ss.
JOHN O. FARMER (owner or operator) of the above-described well, being first duly sworn on oath, says: That I have knowledge of the facts, statements, and matters herein contained and the log of the above-described well as filed and that the same are true and correct. So help me God.

(Signature) John O. Farmer
Russell, Kansas
(Address)



SUBSCRIBED AND SWORN to before me this 20th day of March, 19 57
Lucille Kennedy
Notary Public.

PLUGGING
FILE SEC 17 T 9 R 28W
BOOK PAGE 149 LI E 30

OPERATOR JONES, SHELburne & Farmer, INC.

15-179-00189-00-00
FORMATION RECORD

ADDRESS RUSSELL, KANSAS

Give detailed description and thickness of all formations drilled through, contents of sand, whether dry, water, oil or gas.

FARM NAME KRANNAWITTER WELL NO. 1 COUNTY Sheridan SEC. 17 TWP. 9 RGE. 28

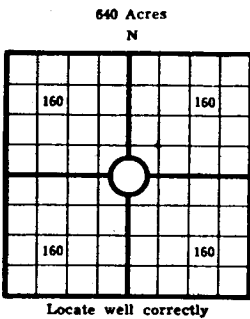

COUNTY Sheridan SEC. 17 TWP. 9 RGE. 28
 COMPANY OPERATING Jones, Shelburne & Farmer, Inc.
 OFFICE ADDRESS Russell, Kansas
 FARM NAME KRANNAWITTER WELL NO. 1
 DRILLING STARTED 3/1, 1957 DRILLING FINISHED 3/14, 1957
 DATE OF FIRST PRODUCTION _____ COMPLETED _____
 WELL LOCATED SE 1/4 SE 1/4 SE 1/4 North of South
 Line and _____ ft. East of West Line of Quarter Section
 Elevation (Relative to sea level) DERRICK FLOOR 2826 GROUND 2823
 CHARACTER OF WELL (Oil, gas or dryhole) Dry

Formation	Top	Bottom	Formation	Top	Bottom
Sand & shale	0	235			
Shale	235	1270			
Sand	1270	1385			
Sand & shale	1385	1800			
Shale & shells	1800	2447			
Anhydrite	2447	2489			
Shale & shells	2489	2800			
Lime & shale	2800	2955			
Shale & lime	2955	3075			
Lime & shale	3075	3340			
Shale & lime	3340	3415			
Lime & shale	3415	3550			
Shale & lime	3550	3670			
Lime & shale	3670	3860			
Shale & lime	3860	3940			
Lime & shale	3940	4334			
Shale & lime	4334	4420			
Lime & shale	4420	4565			
Lime	4565	4575			
T.D.	4575				

ELECTRIC LOG TOPS:

Elevation: RB 2828
 Anhydrite 2445
 Topeka 3744
 Heebner 3944
 Toronto 3966
 Lansing 3980
 B/KC 4214
 Cherokee 4417
 Mississippi 4527
 T.D. 4574
 D & A

PLUGGING
FILE SEC 17 T 9 R 28
BOOK PAGE 1491 E 30

OIL OR GAS SANDS OR ZONES

Name	From	To	Name	From	To
1			4		
2			5		
3			6		

Operating Record If Any

Formation	From	To	No. of Shots	Formation	From	To	Size of Shot

CASING RECORD

Amount Set				Amount Pulled		Packer Record			
Size	Wt.	Throat	Make	Ft.	In.	Size	Length	Depth Set	Make
8-5/8				235					

Liner Record: Amount _____ Kind _____ Top _____ Bottom _____

CEMENTING AND MUDDING

Size	Amount Set		Sacks Cement	Chemical		Method of Cementing	Amount	Mudding Method	Results (See Note)
	Ft.	In.		Gal.	Make				
8-5/8	235		150						

Note: What method was used to protect sands if outer strings were pulled? _____

NOTE: Were bottom hole plugs used? _____ If so, state kind, depth set and results obtained _____

TOOLS USED
 Rotary Tools were used from _____ feet to _____ Cable tools were used from _____ feet to _____
 _____ feet, and from _____ feet to _____ feet, and from _____ feet to _____

INITIAL PRODUCTION TEST

Describe initial test: whether by flow through tubing or casing or by pumping _____
 Amount of Oil Production _____ bbls. Size of choke, if any _____ Length of test _____ Water
 Production _____ bbls. Gravity of oil _____ Type of Pump if pump is used, describe _____

Subscribed and sworn to before me this _____ 20th day of _____ March _____ 19 _____ 57
 My Commission expires 10/11/58 _____

 Notary Public

John D. Farmer Vice-Pres.
 Name and title of representative of company