

STATE OF KANSAS
STATE CORPORATION COMMISSION

Give All Information Completely
Make Required Affidavit
Mail or Deliver Report to:
Conservation Division
State Corporation Commission
211 No. Broadway
Wichita, Kansas

15-179-30180-00-00
WELL PLUGGING RECORD

NORTH

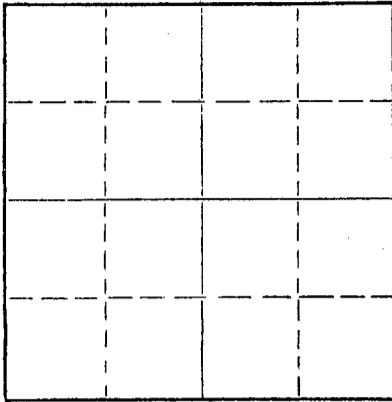

Locate well correctly on above
Section Plat

Sheridan County. Sec. 1 Twp. 9S Rge. (E) 29 (W)

Location as "NE/CNW%SW%" or footage from lines SW NE
Lease Owner JOHN O. FARMER, INC.
Lease Name PRATT "B" Well No. 3
Office Address Russell, Kansas
Character of Well (completed as Oil, Gas or Dry Hole) Dry
Date well completed 11/30 1958
Application for plugging filed 11/30 1958
Application for plugging approved 11/30 1958
Plugging commenced 11/30 1958
Plugging completed 11/30 1958
Reason for abandonment of well or producing formation Dry

If a producing well is abandoned, date of last production 19
Was permission obtained from the Conservation Division or its agents before plugging was commenced? yes

Name of Conservation Agent who supervised plugging of this well A. D. Fabricius, Hill City, Kansas
Producing formation Depth to top Bottom Total Depth of Well 4120 Feet
Show depth and thickness of all water, oil and gas formations.

OIL, GAS OR WATER RECORDS

CASING RECORD

FORMATION	CONTENT	FROM	TO	SIZE	PUT IN	PULLED OUT
				8-5/8"	214'	None

Describe in detail the manner in which the well was plugged, indicating where the mud fluid was placed and the method or methods used in introducing it into the hole. If cement or other plugs were used, state the character of same and depth placed, from feet to feet for each plug set.

First plug set at 600 feet with 20 sacks cement
Second plug set at 214 feet with 20 sacks cement
Third plug set at 40 feet with 10 sacks cement

(If additional description is necessary, use BACK of this sheet)
Name of Plugging Contractor JOHN O. FARMER, INC.
Address Russell, Kansas

STATE OF KANSAS, COUNTY OF RUSSELL, ss.
JOHN O. FARMER (owner or operator) of the above-described well, being first duly sworn on oath, says: That I have knowledge of the facts, statements, and matters herein contained and the log of the above-described well as filed and that the same are true and correct. So help me God.

(Signature) John O. Farmer
Russell, Kansas (Address)

SUBSCRIBED AND SWORN to before me this 2nd day of December
My commission expires October 11, 1962

Lucille Kennedy
STATE CORPORATION COMMISSION
Wichita, Kansas
DEC 5 - 1958
12-05-1958
CONSERVATION DIVISION
Wichita, Kansas



PLUGGING
FILE SEC 1 T 9 R 29W
BOOK PAGE 1 LINE 33

ADDRESS Russell, Kansas

Give detailed description and thickness of all formations drilled through, contents of sand, whether water, oil or gas.

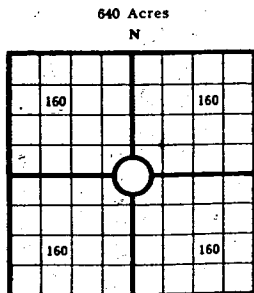

Locate well correctly

COUNTY Sheridan SEC 1 TWP 9S RGE 29W
COMPANY OPERATING John O. Farmer, Inc.
OFFICE ADDRESS Russell, Kansas
FARM NAME PRATT "B" WELL NO 3
DRILLING STARTED 11/21 19 58 DRILLING FINISHED 11/30 19 58
DATE OF FIRST PRODUCTION COMPLETED
WELL LOCATED 1/4 SW 1/4 NE 1/4 North of South
Line and ft. East of West Line of Quarter Section
Elevation (Relative to sea level) DERRICK FLOOR 2272 GROUND 2269
CHARACTER OF WELL (Oil, gas or dryhole) Dry

OIL OR GAS SANDS OR ZONES

Name	From	To	Name	From	To
1			4		
2			5		
3			6		

Perforating Record If Any

Shot Record

Formation	From	To	No. of Shots	Formation	From	To	Size of Shot

CASING RECORD

Amount Set								Amount Pulled		Packer Record	
Size	Wt.	Thds.	Make	Ft.	In.	Ft.	In.	Size	Length	Depth Set	Make
8-5/8				214							

Liner Record: Amount Kind Top Bottom

CEMENTING AND MUDDING

Size	Amount Set		Sacks Cement	Chemical		Method of Cementing	Amount	Mudding Method	Results (See Note)
	Ft.	In.		Gal.	Make				
8-5/8	214		140						

Note: What method was used to protect sands if outer strings were pulled?

NOTE: Were bottom hole plugs used? If so, state kind, depth set and results obtained

TOOLS USED

Rotary Tools were used from feet to Cable tools were used from feet to

feet, and from feet to feet, and from feet to

Type Rig

INITIAL PRODUCTION TEST

Describe initial test: whether by flow through tubing or casing or by pumping

Amount of Oil Production bbls. Size of choke, if any Length of test Water

Production bbls. Gravity of oil Type of Pump if pump is used, describe

Formation	Top	Bottom	Formation	Top	Bottom
Clay & sand	0	185			
Shale	185	1580			
Shale & shells	1580	2220			
Shale & redbed	2220	2387			
Anhydrite	2387	2422			
Shale & shells	2422	2900			
Shale & lime	2900	3760			
Lime & shale	3760	4120			
R.T.D.		4120			

Elevation: RB 2274

ELECTRIC LOG TOPS:

Howard	3539
Topeka	3641
Heebner	3838
Toronto	3862
Lansing	3876
B/KC	4118
T.D.	4121
R.T.D.	4120

D & A

PLUGGING
FILE SEC 1 T 9 R 29W
BOOK PAGE 1 LINE 33

I, the undersigned, being first duly sworn upon oath, state that this well record is true, correct and complete according to the records of this office and to the best of my knowledge and belief.

John O. Farmer President
Name and title of representative of company

Subscribed and sworn to before me this 2nd day of December 19 58

My Commission expires 10/11/62 Lucille Kennedy Notary Public

FARM NAME PRATT "B" WELL NO 3 COUNTY Sheridan SEC 1 TWP 9S RGE 29W