

EFFECTIVE DATE: 7-18-90

OWWO

FORM MUST BE TYPED  
FORM C-1 4/90

State of Kansas

FORM MUST BE SIGNED  
ALL BLANKS MUST BE FILLED

NOTICE OF INTENTION TO DRILL

Must be approved by the K.C.C. five (5) days prior to commencing well

Expected Spud Date July 19, 1990  
month day year

NE NW NE Sec 35 Twp 9 S, Rg 21 East  
XX West

OPERATOR: License # 4952  
Name: Starr F. Schlobohm  
Address: P. O. Box 291  
City/State/Zip: Russell, KS 67665-0291  
Contact Person: John L. Driscoll  
Phone: (913) 483-5255 - mobile  
(913) 483-6116 - home

4,950 feet from South line of Section  
1,650 feet from East line of Section  
(Note: Locate well on Section Plat on Reverse Side)

CONTRACTOR: License #: 9431  
Name: VonFeldt Drilling

County: Graham  
Lease Name: DeYoung Well #: 3  
Field Name: Morel

Well Drilled For: Well Class: Type Equipment:  
 Oil ... Inj  Infield  Mud Rotary  
 Gas ... Storage ... Pool Ext. ... Air Rotary  
 OWWO ... Disposal ... Wildcat ... Cable  
... Seismic; ... # of Holes

Is this a Prorated Field? ... yes  no   
Target Formation(s): Arbuckle  
Nearest lease or unit boundary: 330'  
Ground Surface Elevation: 2,301' feet MSL

If OWWO: old well information as follows:  
Operator: C-G Drilling  
Well Name: DeYoung "B" #1  
Comp. Date: 3-4-55 Old Total Depth 3,915'  
-1,609'

Domestic well within 330 feet: ... yes  no   
Municipal well within one mile: ... yes  no   
Depth to bottom of fresh water: 100'  
Depth to bottom of usable water: 950'

Directional, Deviated or Horizontal wellbore? ... yes  no   
If yes, total depth location: .....

Surface Pipe by Alternate: ... 1 184' 8 5/8"  
Length of Surface Pipe set: 184' 8 5/8"  
Length of Conductor pipe required: NONE  
Projected Total Depth: 4,050'

Formation at Total Depth: Arbuckle  
Water Source for Drilling Operations:  
... well  farm pond ... other

AFFIDAVIT

The undersigned hereby affirms that the drilling, completion and eventual plugging of this well will comply with K.S.A. 55-101, et. seq.

- It is agreed that the following minimum requirements will be met:
1. The appropriate district office shall be notified before setting surface pipe;
  2. The minimum amount of surface pipe as specified above shall be set by circulating cement to the top; in all cases surface pipe shall be set through all unconsolidated materials plus a minimum of 20 feet into the underlying formation;
  3. If the well is dry, a plugging proposal shall be submitted to the district office. An agreement between the operator and the district office on plug length and placement is necessary prior to plugging;
  4. The appropriate district office will be notified before well is either plugged or production casing is cemented in;
  5. If an Alternate II completion, production pipe shall be cemented from below any usable water to surface within 120 days of spud date. In all cases, notify district office prior to any cementing.

I hereby certify that the statements made herein are true and to the best of my knowledge and belief.  
Date: July 12, 1990 Signature of Operator or Agent: Starr F. Schlobohm Title: Owner/Operator

FOR KCC USE:  
API # 15-065-01,025-00-01 KCC 7-2508  
Conductor pipe required NONE feet  
Minimum surface pipe required 184 feet per Alt. ● ②  
Approved by: mpw 7-13-90  
EFFECTIVE DATE: 7-18-90  
This authorization expires: 1-13-91  
(This authorization void if drilling not started within 6 months of effective date.)  
Spud date: \_\_\_\_\_ Agent: \_\_\_\_\_

35  
9  
210

REMEMBER TO:

- File Drill Pit Application (form CDP-1) with Intent to Drill;
- File Completion Form ACO-1 within 120 days of spud date;
- File acreage attribution plat according to field proration orders;
- Notify appropriate district office 48 hours prior to workover or re-entry;
- Submit plugging report (CP-4) after plugging is completed;
- Obtain written approval before disposing or injecting salt water.

**PLAT OF ACREAGE ATTRIBUTABLE TO A WELL**

State Corporation Commission, Conservation Division  
200 Colorado Derby Bldg. Wichita, Kansas 67202

OPERATOR Starr F. Schlobohm LOCATION OF WELL:  
 LEASE DeYoung 4,950 feet north of SE corner  
 WELL NUMBER 3 1,650 feet west of SE corner  
 FIELD Morel NE NW NE Sec. 35 T 9S R 21 ~~XX~~/W  
 COUNTY Graham  
 NO. OF ACRES ATTRIBUTABLE TO WELL 10 IS SECTION XX REGULAR IRREGULAR?  
 Lease 160 acres, cultivated and pasture IF IRREGULAR, LOCATE WELL FROM NEAREST  
 DESCRIPTION OF ACREAGE CORNER BOUNDARY.

NOTE: If plat depicted is insufficient for your circumstances, you may attach your own scaled or surveyed plat.

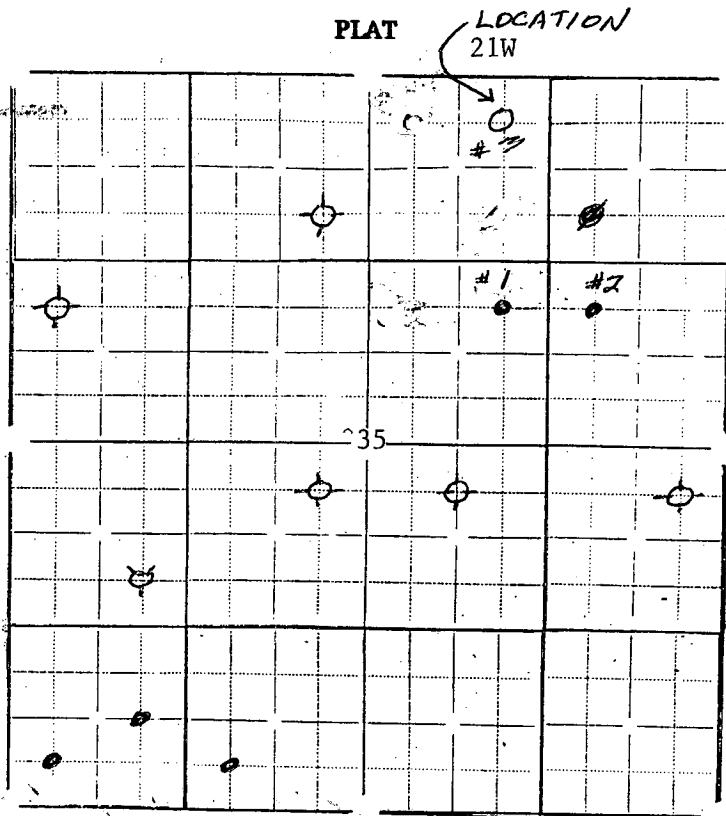

In plotting the proposed location of the well, you must show:

- 1) The manner in which you are using the depicted plat by identifying section lines, i.e. 1 section, 1 section with 8 surrounding partial sections, 4 sections, 16 sections, etc.;
- 2) the well's location relative to the location of other wells producing from the same common source of supply in adjoining drilling units, pursuant to K.A.R. 82-3-108, 82-3-207, 82-3-312, or special orders of the Commission;
- 3) the distance of the proposed drilling location from the section's east and south lines; and
- 4) the distance to the nearest lease or unit boundary line.

I hereby certify that the statements made herein are true and to the best of my knowledge and belief.

Signature of Operator or Agent Starr F. Schlobohm

Date July 12, 1990 Title Owner/Operator