

KANSAS DRILLERS LOG

S. 28 T. 8S R. 24W ^E/_W

Loc. C NE NE NW

County Graham

API No. 15 — 065 — 21,097-00-00
County Number

Operator
Abercrombie Drilling, Inc.

Address
801 Union Center, Wichita, Kansas 67202

Well No. 1 Lease Name Schierkolk

Footage Location
feet from (N) (S) line feet from (E) (W) line

Principal Contractor Abercrombie Drilling, Inc Geologist Vic Reiserer

Spud Date January 11, 1979 Total Depth 3900' P.B.T.D.

Date Completed January 19, 1979 Oil Purchaser

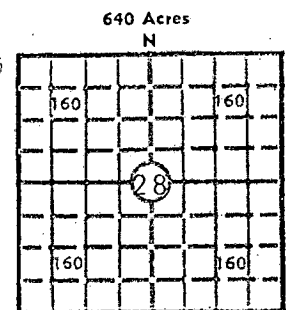

Locate well correctly
 Elev.: Gr. 2313'

DF 2315 1/2' KB 2318'

CASING RECORD

Report of all strings set — surface, intermediate, production, etc.

Purpose of string	Size hole drilled	Size casing set (in O.D.)	Weight lbs/ft.	Setting depth	Type cement	Sacks	Type and percent additives
Surface	12 1/4"	8-5/8"	28#	251'	Common	190	3% Ca.Cl. 2% Gel.

LINER RECORD

PERFORATION RECORD

Top, ft.	Bottom, ft.	Sacks cement	Shots per ft.	Size & type	Depth interval

TUBING RECORD

Size	Setting depth	Packer set at

ACID, FRACTURE, SHOT, CEMENT SQUEEZE RECORD

Amount and kind of material used	Depth interval treated

RECEIVED
 STATE CORPORATION COMMISSION
 JAN 26 1979
 1-26-1979
 CONSERVATION DIVISION
 Wichita, Kansas

INITIAL PRODUCTION

Date of first production	Producing method (flowing, pumping, gas lift, etc.)
RATE OF PRODUCTION PER 24 HOURS	Oil bbls. Gas MCF Water bbls. Gas-oil ratio CFPB
Disposition of gas (vented, used on lease or sold)	Producing interval(s)

INSTRUCTIONS: As provided in KCC Rule 82-2-125, within 90 days after completion of a well, one completed copy of this Drillers Log shall be transmitted to the State Geological Survey of Kansas, 4150 Monroe Street, Wichita, Kansas 67209. Copies of this form are available from the Conservation Division, State Corporation Commission, 3830 So. Meridian (P.O. Box 17027), Wichita, Kansas 66217. Phone AC 316-522-2206. If confidential custody is desired, please note Rule 82-2-125. Drillers logs will be on open file in the Oil and Gas Division, State Geological Survey of Kansas, Lawrence, Kansas 66044.

Operator
Abancrombie Drilling, Inc.

DESIGNATE TYPE OF COMP.: OIL, GAS,
DRY HOLE, SWDW, ETC.:
Dry Hole

Well No. 1 Lesse Name
Schierfolk

S 28 T 8 S R 24 W E

WELL LOG

Show all important zones of porosity and contents thereof; cored intervals, and all drill-stem tests, including depth interval tested, cushion used, time tool open, flowing and shut-in pressures, and recoveries.

SHOW GEOLOGICAL MARKERS, LOGS RUN, OR OTHER DESCRIPTIVE INFORMATION.

FORMATION DESCRIPTION, CONTENTS, ETC.	TOP	BOTTOM	NAME	DEPTH
Shale and sand	0	45	SAMPLE TOPS:	
Sand and shale	45	680		
Shale and sand	680	1241	Anhydrite	2007' (+ 311)
Sand and shale	1241	2006	B/Anhydrite	2042' (+ 276)
Anhydrite	2006	2042	Heebner	3641' (-1323)
Sand and shale	2042	2180	Toronto	3664' (-1346)
Shale	2180	2670	Lansing	3679' (-1361)
Lime and shale	2670	2780		
Shale and lime	2780	3133		
Lime and shale	3133	3780		
Lime	3780	3875		
Lime and shale	3875	3900		
Rotary Total Depth		3900		
No drill stem tests				

USE ADDITIONAL SHEETS, IF NECESSARY, TO COMPLETE WELL RECORD.

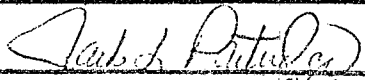
Date Received	 Signature
	Jack L. Partridge, Asst. Sec.-Treas. Title
	January 25, 1979 Date