

EFFECTIVE DATE: 2-8-94

State of Kansas

DISTRICT # 2

NOTICE OF INTENTION TO DRILL

SGA7... Yes. No

Must be approved by the K.C.C. five (5) days prior to commencing well

Expected Spud Date March 1 1994
month day year

Spot NW NE SE Sec 6 Twp 26 S, Rg 3 East

OPERATOR: License # 3447
Name: Ranken Energy Corporation
Address: 601 N. Kelly, Ste. 103
City/State/Zip: Edmond, OK 73003-4855
Contact Person: Tom Larson
Phone: 316/653-7368

2300 feet from South/ North line of Section
800 feet from East/ West line of Section

IS SECTION X REGULAR IRREGULAR?
(NOTE: Locate well on the Section Plat on Reverse Side)

CONTRACTOR: License #: Unknown
Name:

County: Butler
Lease Name: Fisher Well #: 2-6
Field Name: Wildcat

Well Drilled For: Well Class: Type Equipment:
X Oil ... Enh Rec ... Infield X Mud Rotary
Gas ... Storage ... Pool Ext. ... Air Rotary
OWWO ... Disposal X Wildcat ... Cable
Seismic: # of Holes Other

Is this a Prorated/Spaced Field? yes X no
Target Formation(s): Hunton

If OWWO: old well information as follows:
Operator:
Well Name:
Comp. Date: Old Total Depth

Nearest lease or unit boundary: 330'
Ground Surface Elevation: 1328' feet MSL

Directional, Deviated or Horizontal wellbore? yes X no
If yes, true vertical depth:
Bottom Hole Location:

Water well within one-quarter mile: yes X no
Public water supply well within one mile: yes X no

Depth to bottom of fresh water: 100'
Depth to bottom of usable water: 180'

Surface Pipe by Alternate: X1 2
Length of Surface Pipe Planned to be set: 200'

Length of Conductor pipe required: N/A
Projected Total Depth: 3150'

Formation at Total Depth: Hunton
Water Source for Drilling Operations:

... well ... farm pond X other
DWR Permit #:

Will Cores Be Taken? yes X no
If yes, proposed zone:

AFFIDAVIT

The undersigned hereby affirms that the drilling, completion and eventual plugging of this well will comply with K.S.A. 55-101, et. seq.

It is agreed that the following minimum requirements will be met:

- 1. Notify the appropriate district office prior to spudding of well;
2. A copy of the approved notice of intent to drill shall be posted on each drilling rig;
3. The minimum amount of surface pipe as specified below shall be set by circulating cement to the top; in all cases surface pipe shall be set through all unconsolidated materials plus a minimum of 20 feet into the underlying formation;
4. If the well is dry hole, an agreement between the operator and the district office on plug length and placement is necessary prior to plugging;
5. The appropriate district office will be notified before well is either plugged or production casing is cemented in;
6. IF AN ALTERNATE II COMPLETION, PRODUCTION PIPE SHALL BE CEMENTED FROM BELOW ANY USABLE WATER TO SURFACE WITHIN 120 DAYS OF SPUD DATE. IN ALL CASES, NOTIFY DISTRICT OFFICE PRIOR TO ANY CEMENTING.

I hereby certify that the statements made herein are true and to the best of my knowledge and belief.

Date: 2/01/94 Signature of Operator or Agent: Title: President

FOR KCC USE:
API # 15- 015-23391-00-00
Conductor pipe required NONE feet
Minimum surface pipe required 200 feet per Alt. OX
Approved by: CB 2-3-94
This authorization expires: 8-3-94
(This authorization void if drilling not started within 6 months of effective date.)
Spud date: Agent:

RECEIVED
STATE CORPORATION COMMISSION
FEB - 3 1994
CONSERVATION DIVISION
Wichita, Kansas

REMEMBER TO:

- File Drill Pit Application (form CDP-1) with Intent to Drill;
- File Completion Form ACO-1 within 120 days of spud date;
- File acreage attribution plat according to field proration orders;
- Notify appropriate district office 48 hours prior to workover or re-entry;
- Submit plugging report (CP-4) after plugging is completed;
- Obtain written approval before disposing or injecting salt water.

Mail to: Conservation Division, 200 Colorado Derby Building, 202 W. First St., Wichita, Kansas 67202-1286.

IN ALL CASES PLOT THE INTENDED WELL ON THE PLAT BELOW

PLAT OF ACREAGE ATTRIBUTABLE TO A WELL IN A PRORATED OR SPACED FIELD

If the intended well is in a prorated or spaced field, please fully complete this side of the form. If the intended well is in a prorated or spaced field complete the plat below showing that the well will be properly located in relationship to other wells producing from the common source of supply. Please show all the wells within 1 mile of the boundaries of the proposed acreage attribution unit for gas wells and within 1/2 mile of the boundaries of the proposed acreage attribution unit for oil wells.

API NO. 15- _____
 OPERATOR _____ LOCATION OF WELL: COUNTY _____
 LEASE _____ feet from south/north line of section
 WELL NUMBER _____ feet from east/west line of section
 FIELD _____ SECTION _____ TWP _____ RG _____

NUMBER OF ACRES ATTRIBUTABLE TO WELL _____ IS SECTION _____ REGULAR or _____ IRREGULAR
 QTR/QTR/QTR OF ACREAGE _____ IF SECTION IS IRREGULAR, LOCATE WELL FROM NEAREST
 CORNER BOUNDARY.
 Section corner used: _____ NE _____ NW _____ SE _____ SW _____

PLAT

(Show location of the well and shade attributable acreage for prorated or spaced wells.)
 (Show footage to the nearest lease or unit boundary line.)

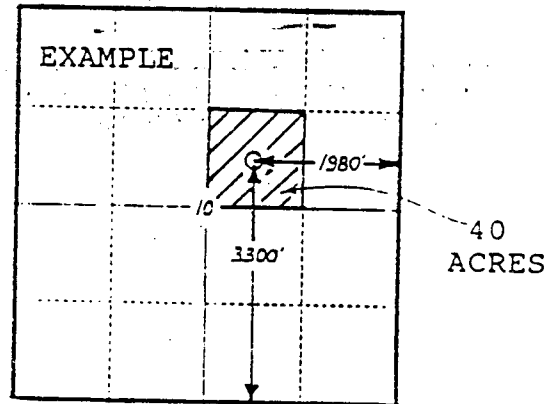
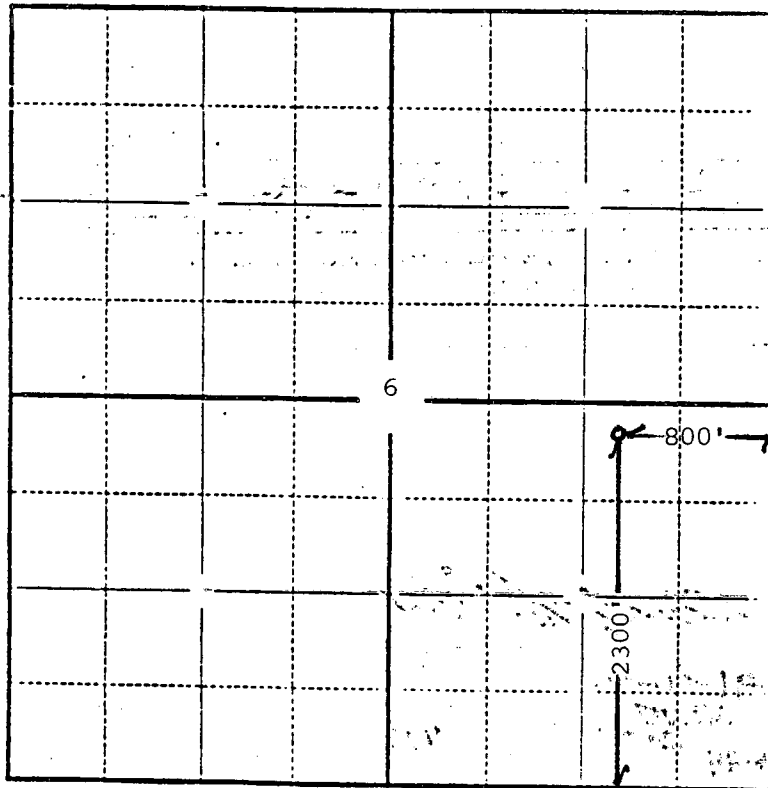

SEWARD CO.

26S-3E
 Butler County, KS

In plotting the proposed location of the well, you must show:

- 1) The manner in which you are using the depicted plat by identifying section lines, i.e. 1 section, 1 section with 8 surrounding sections, 4 sections, etc.;
- 2) the distance of the proposed drilling location from the section's south/north and east/west lines; and
- 3) the distance to the nearest lease or unit boundary line.

FOR KCC USE:

EFFECTIVE DATE: 2-8-94

DISTRICT # 2

SEA? Yes No

State of Kansas

NOTICE OF INTENTION TO DRILL

Must be approved by the K.C.C. five (5) days prior to commencing well

FORM 7291
FOR DRILL MASTERS
FOR DRILL MASTERS
ALL SEAL MARKS NUMBERED

Spud. 3-2-94
Plugged 3-11-94

Expected Spud Date March 1 1994
month day year

Spot NW NE SE Sec 6 Twp 26 S 32 3 1st 2nd 3rd 4th 5th 6th 7th 8th 9th 10th 11th 12th

OPERATOR: License # 3447
Name: Ranken Energy Corporation
Address: 601 N. Kelly, Ste. 103
City/State/Zip: Edmond, OK 73003-4855
Contact Person: Tom Larson
Phone: 316/653-7368

2300 feet from South / North
800 feet from East / West

IS SECTION X REGULAR IRREGULAR
(NOTE: Locate well on the Section Plat. on the Reverse)

CONTRACTOR: License #: Unknown
Name:

County: Butler
Lease Name: Fisher Well #: 2
Field Name: Wildcat

Well Drilled For: Well Class: Type Equipment:
X Oil ... Enh Rec ... Infield X Mud Rotary
... Gas ... Storage ... Pool Ext. ... Air Rotary
... OWWO ... Disposal X Wildcat ... Cable
... Seismic; ... # of Holes ... Other
... Other

Is this a Prorated/Spaced Field? yes X
Target Formation(s): Hunton

If OWWO: old well information as follows:
Operator:
Well Name:
Comp. Date: Old Total Depth

Nearest lease or unit boundary: 330'
Ground Surface Elevation: 1328'

Directional, Deviated or Horizontal wellbore? yes X no
If yes, true vertical depth:
Bottom Hole Location:

Water well within one-quarter mile: I no
Public water supply well within one mile: I no

Depth to bottom of fresh water: 100'
Depth to bottom of usable water: 180'

Surface Pipe by Alternate: X
Length of Surface Pipe Planned to be set: 20'

Length of Conductor pipe required: N/A
Projected Total Depth: 3150'

Formation at Total Depth: Hunton
Water Source for Drilling Operations:

... well ... Farm pond

DWR Permit #: ...
Will Cores Be Taken? yes X
If yes, proposed zone:

AFFIDAVIT

The undersigned hereby affirms that the drilling, completion and eventual plugging of this well will comply with 101, et. seq.
It is agreed that the following minimum requirements will be met:

1. Notify the appropriate district office prior to spudding of well;
2. A copy of the approved notice of intent to drill shall be posted on each drilling rig;
3. The minimum amount of surface pipe as specified below shall be set by circulating cement to the top; surface pipe shall be set through all unconsolidated materials plus a minimum of 20 feet into the underlying formation; necessary prior to plugging;
4. If the well is dry hole, an agreement between the operator and the district office on plug length and placement is necessary prior to plugging;
5. The appropriate district office will be notified before well is either plugged or production casing is cemented;
6. IF AN ALTERNATE IS COMPLETED, PRODUCTION PIPE SHALL BE CEMENTED FROM BELOW ANY USABLE WATER TO SURFACE WITHIN 5 DAYS OF SPUD DATE. IN ALL CASES, NOTIFY DISTRICT OFFICE PRIOR TO ANY CEMENTING.

I hereby certify that the statements made herein are true and to the best of my knowledge and belief.

Date: 2/01/94 Signature of Operator or Agent: [Signature] Title: President

will set 200' (+)
of 85/8"

FOR KCC USE:
API # 15- 015-23391
Conductor pipe required NONE feet
Minimum surface pipe required 200' feet per Alt. O X
Approved by: CB 2-3-94
This authorization expires: 8-3-94
(This authorization void if drilling not started within 6 months of effective date.)
Spud date: 3-2-94 Agent: M.L.K.

REMEMBER TO:

- File Drill Pit Application (form CDP-1) with Intent to Drill;
- File Completion Form ACD-1 within 120 days of spud date;
- File acreage attribution plat according to field proration orders;
- Notify appropriate district office 48 hours prior to workover or re-entry;
- Submit plugging report (CP-4) after plugging is completed;
- Obtain written approval before disposing or injecting salt water.

Mail to: Conservation Division, 200 Colorado Derby Building, 202 W. First St., Wichita, Kansas 67202-1286.

FEB 7 1994