

FOR KCC USE:

15-065-22697-00-00

Call Jack Attridge  
262-1841

FORM C-1 7/5

FORM MUST BE TYPE

FORM MUST BE SIGN

ALL BLANKS MUST BE FILL

EFFECTIVE DATE: 10-19-92

DISTRICT # 4

SGA7... Yes  No

State of Kansas

NOTICE OF INTENTION TO DRILL

Must be approved by the K.C.C. five (5) days prior to commencing well

Expected Spud Date 10 14 92  
month day year

OPERATOR: License # 31008  
Name: Paul Bowman Oil Co.  
Address: 99 Peterson  
City/State/Zip: Codel, KS 67630  
Contact Person: Michael Devignon  
Phone: (913) 625-8108

CONTRACTOR: License #: 30684  
Name: Abercrombie RTD, Inc.

Well Drilled For:	Well Class:	Type Equipment:
<input checked="" type="checkbox"/> Oil ... Enh Rec	... Infield	<input checked="" type="checkbox"/> Mud Rotary
... Gas ... Storage	... Pool Ext.	... Air Rotary
... OWD	... Disposal	... Wildcat
... Seismic; ... # of Holes	... Other	... Cable
... Other		

If OWD: old well information as follows:  
Operator: N/A  
Well Name:  
Comp. Date: Old Total Depth

Directional, Deviated or Horizontal wellbore? ... yes  no  
If yes, true vertical depth:  
Bottom Hole Location: N/A

Spot NW - NW - NE Sec 16 Twp 10S S, Rg 24 X

4950' feet from South / North line of Section  
2310' feet from East / West line of Section  
IS SECTION X REGULAR IRREGULAR?

(NOTE: Locate well on the Section Plat on Reverse Side  
County: Graham

Lease Name: KSU Well #: 1  
Field Name: Unknown

Is this a Prorated/Spaced Field? ... yes  no  
Target Formation(s): BKC

Nearest lease or unit boundary: 330'  
Ground Surface Elevation: unknown 2479 feet MS

Water well within one-quarter mile: ... yes  no  
Public water supply well within one mile: ... yes  no

Depth to bottom of fresh water: 120'  
Depth to bottom of usable water: 1150'

Surface Pipe by Alternate: 1  2  
Length of Surface Pipe Planned to be set: 230'

Length of Conductor pipe required: None  
Projected Total Depth: 4015'

Formation at Total Depth: BKC  
Water Source for Drilling Operations:

... well  farm pond ... other  
DWR Permit #: will file

Will Cores Be Taken? ... yes  no  
If yes, proposed zone: N/A

AFFIDAVIT

The undersigned hereby affirms that the drilling, completion and eventual plugging of this well will comply with K.S.A. 55-101, et. seq.

It is agreed that the following minimum requirements will be met:

1. Notify the appropriate district office prior to spudding of well;
2. A copy of the approved notice of intent to drill shall be posted on each drilling rig;
3. The minimum amount of surface pipe as specified below shall be set by circulating cement to the top; in all cases surface pipe shall be set through all unconsolidated materials plus a minimum of 20 feet into the underlying formation;
4. If the well is dry hole, an agreement between the operator and the district office on plug length and placement is necessary prior to plugging;
5. The appropriate district office will be notified before well is either plugged or production casing is cemented in;
6. IF AN ALTERNATE II COMPLETION, PRODUCTION PIPE SHALL BE CEMENTED FROM BELOW ANY USABLE WATER TO SURFACE WITHIN 120 DAYS OF SPUD DATE. IN ALL CASES, NOTIFY DISTRICT OFFICE PRIOR TO ANY CEMENTING.

I hereby certify that the statements made herein are true and to the best of my knowledge and belief.

Date: 10-13-92 Signature of Operator or Agent: Paul L. Peterson Title: Exec. Vice President

FOR KCC USE:  
 API # 15- 065-22697-00-00  
 Conductor pipe required None feet  
 Minimum surface pipe required 230 feet per Alt. X(2)  
 Approved by: CB 10-14-92  
 This authorization expires: 4-14-93  
 (This authorization void if drilling not started within 6 months of effective date.)  
 Spud date: Agent:

RECEIVED  
KANSAS CORPORATION COMMISSION

OCT 13 1992

CONSERVATION DIVISION  
WICHITA, KS

REMEMBER TO:

- File Drill Pit Application (form CDP-1) with Intent to Drill;
- File Completion Form ACO-1 within 120 days of spud date;
- File acreage attribution plat according to field proration orders;
- Notify appropriate district office 48 hours prior to workover or re-entry;
- Submit plugging report (CP-4) after plugging is completed;
- Obtain written approval before disposing or injecting salt water.

Mail to: Conservation Division, 200 Colorado Derby Building, 202 W. First St., Wichita, Kansas 67202-1286.

16  
10  
24

IN ALL CASES PLOT THE INTENDED WELL ON THE PLAT BELOW

PLAT OF ACREAGE ATTRIBUTABLE TO A WELL IN A PRORATED OR SPACED FIELD

If the intended well is in a prorated or spaced field, please fully complete this side of the form. If the intended well is in a prorated or spaced field complete the plat below showing that the well will be properly located in relationship to other wells producing from the common source of supply. Please show all the wells within 1 mile of the boundaries of the proposed acreage attribution unit for gas wells and within 1/2 mile of the boundaries of the proposed acreage attribution unit for oil wells.

API NO. 15- \_\_\_\_\_  
 OPERATOR Paul Bowman Oil Co.  
 LEASE KSU #1  
 WELL NUMBER 1  
 FIELD Culp

LOCATION OF WELL: COUNTY Graham  
4950' feet from south/north line of section  
2310' feet from east/west line of section  
 SECTION 16 TWP 10S RG 24W

NUMBER OF ACRES ATTRIBUTABLE TO WELL \_\_\_\_\_  
 QTR/QTR/QTR OF ACREAGE NW - NW - NE

IS SECTION X REGULAR or \_\_\_\_\_ IRREGULAR  
 IF SECTION IS IRREGULAR, LOCATE WELL FROM NEAREST  
CORNER BOUNDARY.

Section corner used: \_\_\_\_\_ NE \_\_\_\_\_ NW \_\_\_\_\_ SE \_\_\_\_\_ SW  
PLAT

(Show location of the well and shade attributable acreage for prorated or spaced wells.)  
 (Show footage to the nearest lease or unit boundary line.)

R 24 W

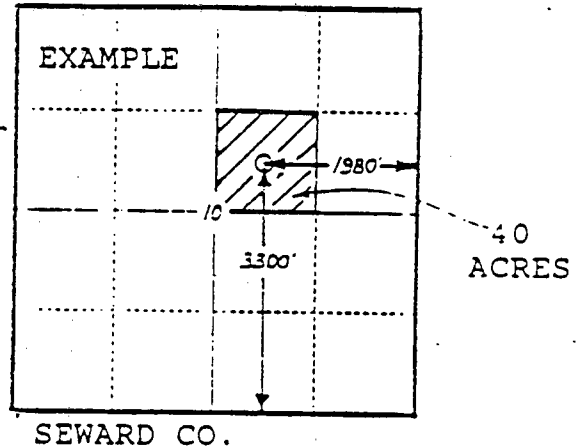
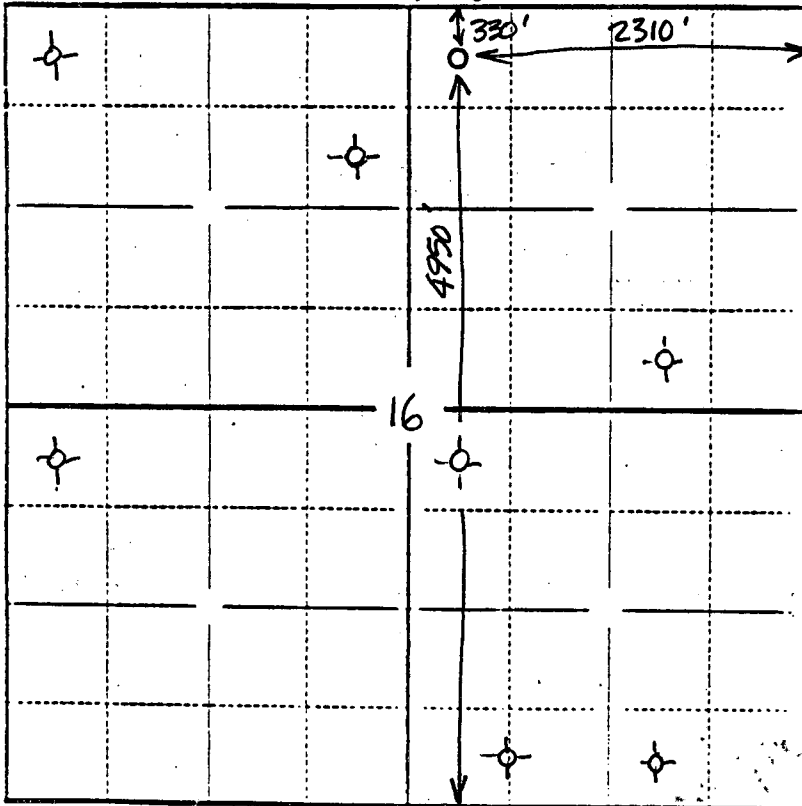

In plotting the proposed location of the well, you must show:

- 1) The manner in which you are using the depicted plat by identifying section lines, i.e. 1 section, 1 section with 8 surrounding sections, 4 sections, etc.;
- 2) the distance of the proposed drilling location from the section's south/north and east/west lines; and
- 3) the distance to the nearest lease or unit boundary line.