

STATE CORPORATION COMMISSION OF KANSAS
OIL & GAS CONSERVATION DIVISION
WELL COMPLETION OR RECOMPLETION FORM
ACO-1 WELL HISTORY
DESCRIPTION OF WELL AND LEASE

API NO. 15-193-20,408-00-00
County THOMAS
SW NE NE Sec. 15 Twp. 9 Rge. 33 East
West

Operator: License # 5923
Name AMERICAN PETROLEUM COMPANY, INC.
Address 400 N. WOODLAWN, SUITE 111
City/State/Zip WICHITA, KANSAS 67208

4290 Ft North from Southeast Corner of Section
990 Ft West from Southeast Corner of Section
(Note: Locate well in section plat below)

Purchaser NOT APPLICABLE

Lease Name FRIESEN Well # 2-15

Operator Contact Person JAMES T. BARVAIS
Phone (316) 684-5273

Field Name NONE

Contractor: License # 9187
Name WESTERN WELL DRILLING, INC.
HENDERSON, COLORADO

Producing Formation NOT APPLICABLE

Wellsite Geologist JAMES T. BARVAIS
Phone (316) 684-5273

Elevation: Ground 3117 KB 3122

Designate Type of Completion
 New Well Re-Entry Workover

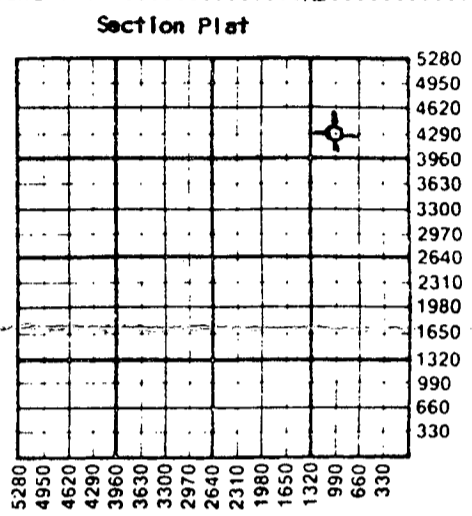

Oil SWD Temp Abd
Gas Inj Delayed Comp.
 Dry Other (Core, Water Supply etc.)

WATER SUPPLY INFORMATION

If OWNO: old well info as follows:
Operator
Well Name
Comp. Date Old Total Depth

Disposition of Produced Water: Disposal
Docket # Repressuring

WELL HISTORY

Drilling Method:
 Mud Rotary Air Rotary Cable

Questions on this portion of the ACO-1 call:
Water Resources Board (913) 296-3717
Source of Water:
Division of Water Resources Permit #
Groundwater.....Ft North from Southeast Corner (Well)Ft West from Southeast Corner of Sec Twp Rge East West
Surface Water.....Ft North from Southeast Corner (Stream, pond etc).....Ft West from Southeast Corner Sec Twp Rge East West
 Other (explain) MINGO (GROUND WATER MGNT. DIST. #1)
(purchased from city, R.W.D. #)

5-27-86 5-30-86 5-30-86
Spud Date Date Reached TD Completion Date

1357'
Total Depth PBTD

Amount of Surface Pipe Set and Cemented at 354 feet
Multiple Stage Cementing Collar Used? Yes No
If yes, show depth set.....feet
If alternate 2 completion, cement circulated from 1357 feet depth to SURFACE w/ 200 SX cmt
Cement Company Name READY-MIX
Invoice #

INSTRUCTIONS: This form shall be completed in triplicate and filed with the Kansas Corporation Commission, 200 Colorado Derby Building, Wichita, Kansas 67202, within 120 days of the spud date of any well. Rule 82-3-130, 82-3-107 and 82-3-106 apply.
Information on side two of this form will be held confidential for a period of 12 months if requested in writing and submitted with the form. See rule 82-3-107 for confidentiality in excess of 12 months.
One copy of all wireline logs and drillers time log shall be attached with this form. Submit CP-4 form with all plugged wells. Submit CP-111 form with all temporarily abandoned wells.

All requirements of the statutes, rules and regulations promulgated to regulate the oil and gas industry have been fully complied with and the statements herein are complete and correct to the best of my knowledge.

Signature JAMES T. BARVAIS
Title PRESIDENT Date 11-10-86

K.C.C. OFFICE USE ONLY
F Letter of Confidentiality Attached
C Wireline Log Received
C Drillers Timelog Received
Distribution
 KCC SWD/Rep NGPA
 KGS Plug Other
(Specify)
MAR 27 1987

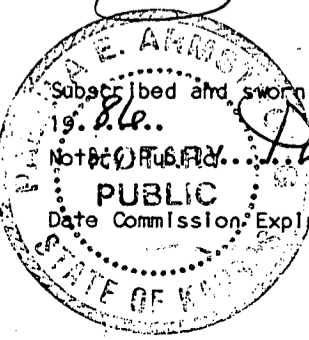

Subscribed and sworn to before me this 10th day of November 1986.
Notary Public Pamela E. Amstrong
Date Commission Expires 9-16-90

03-27-1987

Sec 15 Twp 9 Rge 33 W



Mike Hayden Governor
Keith R. Henley Chairman
Rich Kowalewski Commissioner
Margalee Wright Commissioner
Judith A. McConnell Executive Director

State Corporation Commission

CONSERVATION DIVISION

(Oil, Gas and Water)
200 Colorado Derby Building
202 West 1st Street
WICHITA, KANSAS 67202-1286

March 23, 1987

RE: ACO-1
Friesen Lease Well No. 2-15
SW NE NE 15-9-33W
Thomas County, Ks.
API No. 15-193-20-408

American Petroleum Company, Inc.
400 N. Woodlawn, Suite 111
Wichita, Ks. 67208

Dear Operator:

Please file an amended ACO-1 and fill in the water supply information circled on the return ACO-1 within 14 days. Groundwater Management District #5 has requested this information from the Conservation Division.

Your cooperation in supplying this information will be greatly appreciated.

If you have any questions feel free to contact Rex Krieg at (316) 263-3238.

Sincerely

Rex Krieg
Compliance Officer

cc: District #6

SEE AMENDED FORM ATTACHED HERETO

MAR 27 1987

STATE CORPORATION COMMISSION OF KANSAS
OIL & GAS CONSERVATION DIVISION
WELL COMPLETION OR RECOMPLETION FORM
ACO-1 WELL HISTORY
DESCRIPTION OF WELL AND LEASE

API NO. 15-193-20,408-00-00

County... THOMAS
SW NE NE Sec. 15 Twp. 9 Rge. 33 X West

Operator: License # 5923
Name AMERICAN PETROLEUM COMPANY, INC.
Address 400 N. WOODLAWN, SUITE 111
City/State/Zip WICHITA, KANSAS 67208

4290 Ft North from Southeast Corner of Section
990 Ft West from Southeast Corner of Section
(Note: Locate well in section plat below)

Purchaser NOT APPLICABLE

Lease Name... FRIESEN Well #... 2-15

Field Name... NONE

Operator Contact Person JAMES T. BARVAIS
Phone (316) 684-5273

Producing Formation... NOT APPLICABLE

Elevation: Ground 3117 KB 3122

Contractor: License # 9187
Name WESTERN WELL DRILLING, INC.
HENDERSON, COLORADO
Wellsite Geologist JAMES T. BARVAIS
Phone (316) 684-5273

Designate Type of Completion
X New Well Re-Entry Workover
Oil SWD Temp Abd
Gas Inj Delayed Comp.
X Dry Other (Core, Water Supply etc.)

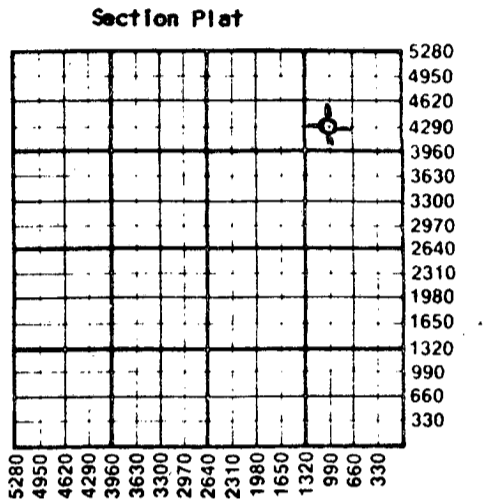

If OWWO: old well info as follows:
Operator
Well Name
Comp. Date Old Total Depth

WATER SUPPLY INFORMATION

Disposition of Produced Water: Disposal
Docket # Repressuring

WELL HISTORY

Drilling Method: X Mud Rotary Air Rotary Cable
5-27-86 5-30-86 5-30-86
Spud Date Date Reached TD Completion Date
1357' PBT
Amount of Surface Pipe Set and Cemented at 354 feet
Multiple Stage Cementing Collar Used? Yes X No
If yes, show depth set... feet
If alternate 2 completion, cement circulated from 1357 feet depth to SURFACE w/. 200 SX cmt
Cement Company Name READY-MIX
Invoice #

Questions on this portion of the ACO-1 call:
Water Resources Board (913) 296-3717
Source of Water:
Division of Water Resources Permit #
Groundwater... Ft North from Southeast Corner (Well) ... Ft West from Southeast Corner of Sec Twp Rge East West
Surface Water... Ft North from Southeast Corner (Stream, pond etc)... Ft West from Southeast Corner Sec Twp Rge East West
X Other (explain) MINGG (purchased from city, R.W.D. #)

INSTRUCTIONS: This form shall be completed in triplicate and filed with the Kansas Corporation Commission, 200 Colorado Derby Building, Wichita, Kansas 67202, within 120 days of the spud date of any well. Rule 82-3-130, 82-3-107 and 82-3-106 apply. Information on side two of this form will be held confidential for a period of 12 months if requested in writing and submitted with the form. See rule 82-3-107 for confidentiality in excess of 12 months. One copy of all wireline logs and drillers time log shall be attached with this form. Submit CP-4 form with all plugged wells. Submit CP-111 form with all temporarily abandoned wells.

All requirements of the statutes, rules and regulations promulgated to regulate the oil and gas industry have been fully complied with and the statements herein are complete and correct to the best of my knowledge.

Signature JAMES T. BARVAIS
Title PRESIDENT Date 11-10-86

K.C.C. OFFICE USE ONLY
F Letter of Confidentiality Attached
C Wireline Log Received
C Drillers Timelog Received
Distribution
KCC SWD/Rep NGPA
KGS Plug Other (Specify)

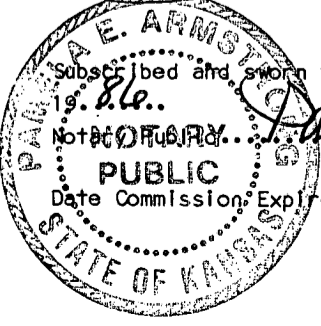

Subscribed and sworn to before me this 10th day of November 1986
Notary Public Pamela E. Armstrong
Date Commission Expires 9-16-90

11-12-1986
NOV 12 1986

Sec 15 Twp 9 Rge 33

Operator Name **AMERICAN PETROLEUM CO., INC.** Lease Name **FRIESEN** Well # **2-15**

Sec. **15** Twp. **9** Rge. **33** East West County **THOMAS**

WELL LOG

INSTRUCTIONS: Show important tops and base of formations penetrated. Detail all cores. Report all drill stem tests giving interval tested, time tool open and closed, flowing and shut-in pressures, whether shut-in pressure reached static level, hydrostatic pressures, bottom hole temperature, fluid recovery, and flow rates if gas to surface during test. Attach extra sheet if more space is needed. Attach copy of log.

Drill Stem Tests Taken Yes No
 Samples Sent to Geological Survey Yes No
 Cores Taken Yes No

Formation Description
 Log Sample

Name	Top	Bottom
SMOKY HILL (NIOBRARA)	627'	
FORT HAYS	1182'	
RTD	1357'	

CASING RECORD <input checked="" type="checkbox"/> New <input type="checkbox"/> Used							
Report all strings set-conductor, surface, intermediate, production, etc.							
Purpose of String	Size Hole Drilled	Size Casing Set (in O.D.)	Weight Lbs/Ft.	Setting Depth	Type of Cement	#Sacks Used	Type and Percent Additives
SURFACE	9 7/8THS	7"	24#	354'	COMMON	97	3% CC
PRODUCTION	6 1/4	4 1/2"	9.5#	1346'	COMMON	200	3% CC
PERFORATION RECORD				Acid, Fracture, Shot, Cement Squeeze Record (Amount and Kind of Material Used)			
Shots Per Foot	Specify Footage of Each Interval Perforated			Depth			
2	1186-1210 (51 HOLES)			FRAC. (SEE ATTACHED)			
TUBING RECORD				Liner Run <input type="checkbox"/> Yes <input type="checkbox"/> No			
Date of First Production	Producing Method <input type="checkbox"/> Flowing <input type="checkbox"/> Pumping <input type="checkbox"/> Gas Lift <input type="checkbox"/> Other (explain)						
Estimated Production Per 24 Hours	Oil Bbls	Gas MCF	Water Bbls	Gas-Oil Ratio	Gravity CFPB		

METHOD OF COMPLETION

Production Interval

Disposition of gas: Vented Sold Used on Lease Open Hole Other (Specify) Perforation Dually Completed Commingled

FRACTURING SERVICE TREATING REPORT

15-193-20408-00-00

MERCURY, INC.

Mercury District Morgan
Mercury Division

Attach To Ticket No. 5265
Stage No. -2-
Page No. -0-

Field 1 Sec. 15 Twp. 9 Rng. 3304 County Thomas State KANSAS

THE FOLLOWING INFORMATION WAS FURNISHED BY THE WELL OWNER OR HIS AGENT:

Date Completed <u>6-17-76</u> Formation <u>MT Hays</u> Casing: OD <u>4 1/2</u> WI. <u>14.5</u> Depth <u>1300'</u> Liner: OD _____ From _____ To _____ Perf.: From <u>1104'</u> To <u>1208'</u> Shots/Ft. <u>96</u> Perf.: From _____ To _____ Shots/Ft. _____ Perf.: From _____ To _____ Shots/Ft. _____ Open Hole: Size _____ From _____ To _____	Prev. Treat: Date _____ Type _____ Fluid: Gal. _____ Sand: Lb. _____ Pres. Treat: Interval: From _____ To _____ Tubing: Size _____ Depth _____ Packer: Type _____ Set at _____ Max. Allowable Pres.: PSI: Tubing _____ Casing <u>2500*</u> Treat Thru: Tubing <input type="checkbox"/> Annulus <input type="checkbox"/> Casing <input checked="" type="checkbox"/> Tubing/Annulus <input type="checkbox"/>
--	--

<p style="text-align: center;">MATERIALS USED</p> Type Job <u>HST-E 60/40 CO₂ Frac</u> Fluid <u>2 1/2" gelled 2-1/2% CCl₄</u> Fluid Source <u>Contract Mercury</u> API Gravity _____ Viscosity _____ CPS @ _____ °F Sand: Grade <u>10/20</u> Lb. <u>14,000</u> Sack <input type="checkbox"/> Bulk <input checked="" type="checkbox"/> Sand: Grade _____ Lb. _____ Sack <input type="checkbox"/> Bulk <input type="checkbox"/> Surfactant: Type <u>CS-3</u> Gal. <u>21</u> in Bbl. Gal. _____ Acid: Type <u>55-1</u> Gal. <u>21</u> % Fluid Loss Add.: Type <u>15-2</u> Gal. Lb. <u>43</u> Perf. Balls: Type <u>Bea-1</u> No. <u>290's</u> Blocking Agent: Type <u>KCL</u> Gal. Lb. <u>2600</u> Gelling Agent: Type <u>A-6</u> Gal. Lb. <u>550</u> Breaker: Type <u>GR-1 CCl₄-1</u> Gal. Lb. <u>16-16</u> <u>CL-1 41/2 gal</u>	<p style="text-align: center;">TREATMENT SUMMARY</p> Trucks (No. and Type) <u>7 units</u> Hyd. HP Available <u>612 Total Used min</u> Pumps On Tubing <u>0</u> Casing <u>3</u> AVERAGE RATES—BPM Treating <u>15-10</u> Displ. <u>15-10</u> Overall <u>25</u> PRESSURES—PSI Breakdown <u>900 → 700</u> Maximum <u>2500</u> Minimum <u>700</u> Displacement <u>1100 → 2500</u> Instant Shut-In <u>1420</u> 5 Min. <u>850</u> VOLUMES: <u>Fluid 100%</u> Load: Bbl. Gal. <u>17</u> Breakdown: Bbl. Gal. <u>10</u> Treatment: Bbl. Gal. <u>232</u> Displ.: Bbl. Gal. <u>20</u> Total: Bbl. Gal. <u>359 = 477 gal</u>
--	---

TREATING LOG

TIME	Operation or Amt. and Type Fluid Pumped	RATE	PUMPS	PRESSURE—PSI		REMARKS
				TUBING	CASING	
8:00	On loc. rig up					
10:20	Prime & Press. Test					
10:25	Safety meeting					
10:34	START PAD	15-10	3	900 → 700		Fluid Bbls CO ₂ 107 13.1
10:41	START 1" 10/20 SAND				810	43 5.2
10:41	1" on formation				840	
10:51	START 2" "				970	43 5.2
10:57	2" on 1" "				970	
10:57	START 3" "				970	86 10.5
11:08	3" on foam				1040	
11:13	START 4" "	15-10			980	60 10.4 7.8
11:23	1" on foam	15-10			780	
11:26	C. I. Sand	Total 25			980 → 1100	
11:27	Run spacer	15-10	3		1100 → 2500	20 3.2
11:27	Shutdown pressure too high	25			2500	Total 359 Bbls 477 gal
11:36	wait 15 mins watch pressure				2500 → 660	
11:36	Try pumping again would not go				660 → 2170	
11:32	wait 15 mins "				2170 → 660	
11:33	Try again would not go				660 → 2150	
11:34	Shutdown complete job! I.S.I.P				1420	
11:39					850	
11:44					660	
11:49					660	

THANKS!

NOV. 16 1976

Mercury Operator JD

Company Representative Walt Smith

Fracturing Company High Tech LTD. Lease FAESER Well No. 2-15 Date 6-17-76