

15-193-20059-00-00

FORM CP-4

STATE OF KANSAS
STATE CORPORATION COMMISSION
CONSERVATION DIVISION
P. O. BOX 17027
WICHITA, KANSAS 67217

WELL PLUGGING RECORD

Thomas County, Sec. 25 Twp. 9S Rge. (X) 34 (W)

Location as "NE/CNW/SW" or footage from lines SW SE

Lease Owner Abercrombie Drilling, Inc.

Lease Name GOELLERT Well No. #1

Office Address 801 Union Center, Wichita, Ks 67202

Character of Well (completed as Oil, Gas or Dry Hole) Dry Hole

Date well completed April 21 1975

Application for plugging filed (verbal) April 21 1975

Application for plugging approved (verbal) April 21 1975

Plugging commenced April 21 1975

Plugging completed April 21 1975

Reason for abandonment of well or producing formation No commercial quantities of oil or gas encountered.

If a producing well is abandoned, date of last production 19

Was permission obtained from the Conservation Division or its agents before plugging was commenced? Yes

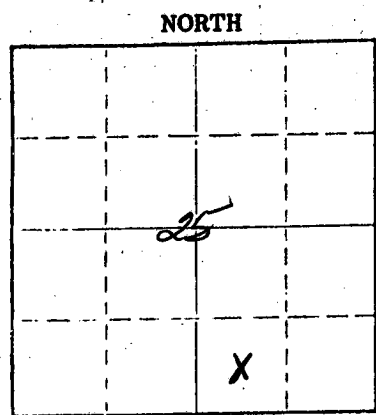

Locate well correctly on above Section Plat

Name of Conservation Agent who supervised plugging of this well Gilbert Balthazor

Producing formation _____ Depth to top _____ Bottom _____ Total Depth of Well 4825'

Show depth and thickness of all water, oil and gas formations.

OIL, GAS OR WATER RECORDS

CASING RECORD

FORMATION	CONTENT	FROM	TO	SIZE	PUT IN	PULLED OUT
				8-5/8"	311'	None

Describe in detail the manner in which the well was plugged, indicating where the mud fluid was placed and the method or methods used in introducing it into the hole. If cement or other plugs were used, state the character of same and depth placed, from _____ feet to _____ feet for each plug set.

1st Plug Set @ 1700' with 70 sx. cement

2nd Plug Set @ 300' with 20 sx. cement

3rd Plug Set @ 40' with 10 sx. cement

RECEIVED
STATE CORPORATION COMMISSION

APR 28 1975

04-28-1975

CONSERVATION DIVISION

Wichita, Kansas

(If additional description is necessary, use BACK of this sheet)

Name of Plugging Contractor Abercrombie Drilling, Inc.

Address 801 Union Center, Wichita, Ks. 67202

STATE OF KANSAS COUNTY OF SEDGWICK ss.

Jerry A. Langrehr, Exec. V.P. (employee of owner) or (owner or operator) of the above-described well, being first duly sworn on oath, says: That I have knowledge of the facts, statements, and matters herein contained and the log of the above-described well as filed and that the same are true and correct. So help me God.

(Signature) Jerry A. Langrehr

801 Union Center, Wichita, Ks.

(Address)

SUBSCRIBED AND SWORN TO before me this 25th day of April 1975

April 8, 1978

Nancy E. Haner
Nancy E. Haner
Notary Public.

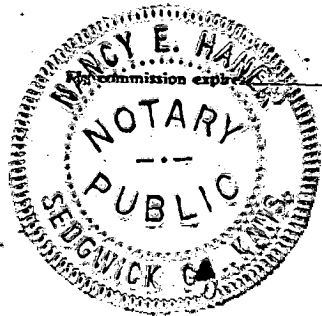

KANSAS DRILLERS LOG

IMPORTANT
Kans. Geo. Survey request
samples on this well.

S. 25 T. 9 R. 34 ^N/_W

Loc. SW SE

County Thomas

API No. 15 — 193 County — 20,059-00-00 Number

Operator
Abercrombie Drilling, Inc.

Address
801 Union Center Wichita, Kansas 67202

Well No. #1 Lease Name Goellert

Footage Location
660 feet from (N) (S) line 1980 feet from (E) (W) line

Principal Contractor Abercrombie Drilling, Inc. Geologist Orlin R. Phelps

Spud Date April 9, 1975 Total Depth 4825' P.B.T.D.

Date Completed April 21, 1975 Oil Purchaser

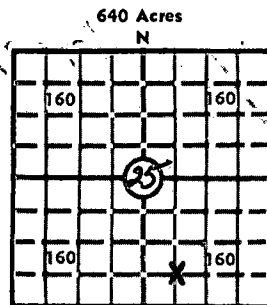

Locate well correctly
Elev.: Gr. 3221
DF 3224' KB 3226'

CASING RECORD

Report of all strings set — surface, intermediate, production, etc.

Purpose of string	Size hole drilled	Size casing set (in O.D.)	Weight lbs/ft.	Setting depth	Type cement	Sacks	Type and percent additives
Surface	12-1/4"	8-5/8"		311'	Sunset	175	

LINER RECORD

PERFORATION RECORD

Top, ft.	Bottom, ft.	Sacks cement	Shots per ft.	Size & type	Depth interval

TUBING RECORD

Size	Setting depth	Packer set at

ACID, FRACTURE, SHOT, CEMENT SQUEEZE RECORD

Amount and kind of material used	Depth interval treated

RECEIVED
STATE CORPORATION COMMISSION
APR 28 1975
Conservation Division
Wichita, Kansas
04-28-1975

INITIAL PRODUCTION

Date of first production		Producing method (flowing, pumping, gas lift, etc.)			
RATE OF PRODUCTION PER 24 HOURS	Oil	Gas	Water	Gas-oil ratio	
	bbis.	MCF	bbis.	CFPB	
Disposition of gas (vented, used on lease or sold)			Producing interval(s)		

INSTRUCTIONS: As provided in KCC Rule 82-2-125, within 90 days after completion of a well, one completed copy of this Drillers Log shall be transmitted to the State Geological Survey of Kansas, 4150 Monroe Street, Wichita, Kansas 67209. Copies of this form are available from the Conservation Division, State Corporation Commission, 3830 So. Meridian (P.O. Box 17027), Wichita, Kansas 66217. Phone AC 316-522-2206. If confidential custody is desired, please note Rule 82-2-125. Drillers Logs will be on open file in the Oil and Gas Division, State Geological Survey of Kansas, Lawrence, Kansas 66044.

Operator **Abercrombie Drilling, Inc.** DESIGNATE TYPE OF COMP.: OIL, GAS, DRY HOLE, SWDW, ETC.:

Well No. #1 Lease Name **GOELLERT** DRY HOLE

S 25 T 9 R 34 K W

WELL LOG
 Show all important zones of porosity and contents thereof; cored intervals, and all drill-stem tests, including depth interval tested, cushion used, time tool open, flowing and shut-in pressures, and recoveries. SHOW GEOLOGICAL MARKERS, LOGS RUN, OR OTHER DESCRIPTIVE INFORMATION.

FORMATION DESCRIPTION, CONTENTS, ETC.	TOP	BOTTOM	NAME	DEPTH
Surface, Sand & Shale	0	317	ELECTRIC LOG TOPS:	
Shale	317	2675		
Anhydrite	2675	2716	Anhydrite	2779
Shale	2716	2805	Heebner	4134
Shale & Lime	2805	3140	Toronto	4158
Shale	3140	3618	Lansing	4176
Lime & Shale	3618	3646	B/Kansas City	4461
Shale & Lime	3646	3775	Ft. Scott	4646
Lime & Shale	3775	3860	Mississippi	4789
Lime	3860	3950	ELTD	4826
Lime & Shale	3950	4043		
Lime	4043	4825		
Rotary Total Depth		4825		
DST #1 (4138-4180) 30", 45", 90", 60" Recovered 268' Muddy Water FFP's 95#-201#; IBHP 1259#; FBHP 1227#				
DST #2 (4259-4275) 30", 45", 90", 60" Recovered 496' SW FFP's 31#-287#; IBHP 1254#; FBHP 1219#. BHT 128°.				
DST #3 (4691-4737) 30", 30", 30", 30" Recovered 15' Mud w/free oil in tool. IFP 52#; IBHP 72#; FFP 52#; FBHP 72# BHT 128°.				
Plugged and Abandoned.				

USE ADDITIONAL SHEETS, IF NECESSARY, TO COMPLETE WELL RECORD.

Date Received _____

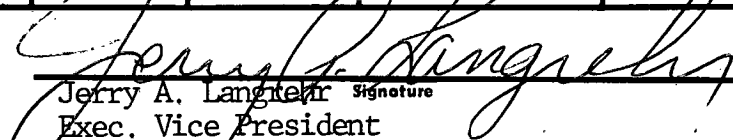
 Jerry A. Langstaff Signature
 Exec. Vice President
 Title
 April 25, 1975
 Date