

For KCC Use:  
 Effective Date: 11-11-08  
 District # 1  
 SGA?  Yes  No

KANSAS CORPORATION COMMISSION  
 OIL & GAS CONSERVATION DIVISION

Form C-1  
 October 2007  
 Form must be Typed  
 Form must be Signed  
 All blanks must be Filled

**NOTICE OF INTENT TO DRILL**

Must be approved by KCC five (5) days prior to commencing well

Expected Spud Date: 11/16/2008  
 month day year

OPERATOR: License# 5447  
 Name: OXY USA, Inc.  
 Address 1: P O Box 2528  
 Address 2:  
 City: Liberal State: KS Zip: 67880  
 Contact Person: Jarod Powell  
 Phone: 620-629-4227

CONTRACTOR: License# 33784  
 Name: Trinidad Drilling Limited Partnership

Well Drilled For:  
 Oil  Gas  
 Enh Rec  Storage  Disposal  
 Seismic: # of Holes  
 Other:  
 If OWWO: old well information as follows:

Well Class:  
 Infield  
 Pool Ext.  
 Wildcat  
 Other

Type Equipment:  
 Mud Rotary  
 Air Rotary  
 Cable

Operator:  
 Well Name:  
 Original Completion Date: Original Total Depth:

Directional, Deviated or Horizontal wellbore?  Yes  No  
 If Yes, true vertical depth:  
 Bottom Hole Location:  
 KCC DKT #:

Spot Description:  
 SW NE NE Sec. 26 Twp. 33 S. R. 43  E  W  
 (Q/Q/Q) 1,250 feet from  N /  S Line of Section  
1,250 feet from  E /  W Line of Section

Is SECTION:  Regular  Irregular?

(Note: Locate well on the Section Plat on reverse side)  
 County: Morton  
 Lease Name: SANTA FE "A" Well #: 2  
 Field Name: Greenwood

Is this a Prorated / Spaced Field?  Yes  No  
 Target Formation(s): Marmaton

Nearest Lease or unit boundary line (in footage): 1250

Ground Surface Elevation: 3601 feet MSL

Water well within one-quarter mile:  Yes  No

Public water supply well within one mile:  Yes  No

Depth to bottom of fresh water: 180

Depth to bottom of usable water: 300

Surface Pipe by Alternate:  I  II

Length of Surface Pipe Planned to be set: 1750'

Length of Conductor Pipe (if any):

Projected Total Depth: 4150

Formation at Total Depth: Marmaton

Water Source for Drilling Operations:  
 Well  Farm Pond  Other:

DWR Permit #: (Note: Apply for Permit with DWR)

Will Cores be taken?  Yes  No

If Yes, proposed zone:

PRORATED & SPACED: HUBOTON & GREENWOOD.

**AFFIDAVIT**

The undersigned hereby affirms that the drilling, completion and eventual plugging of this well will comply with K.S.A. 55 et. seq.  
 It is agreed that the following minimum requirements will be met:

RECEIVED  
 KANSAS CORPORATION COMMISSION

NOV 05 2008

CONSERVATION DIVISION  
 WICHITA, KS

1. Notify the appropriate district office **prior** to spudding of well;
2. A copy of the approved notice of intent to drill **shall be** posted on each drilling rig;
3. The minimum amount of surface pipe as specified below **shall be set** by circulating cement to the top; in all cases surface pipe **shall be set** through all unconsolidated materials plus a minimum of 20 feet into the underlying formation.
4. If the well is dry hole, an agreement between the operator and the district office on plug length and placement is necessary **prior to plugging**;
5. The appropriate district office will be notified before well is either plugged or production casing is cemented in;
6. If an ALTERNATE II COMPLETION, production pipe shall be cemented from below any usable water to surface within **120 DAYS** of spud date. Or pursuant to Appendix "B" - Eastern Kansas surface casing order #133,891-C, which applies to the KCC District 3 area, alternate II cementing must be completed within 30 days of the spud date or the well shall be plugged. **In all cases, NOTIFY district office** prior to any cementing.

I hereby certify that the statements made herein are true and correct to the best of my knowledge and belief.

Date: 11/04/2008 Signature of Operator or Agent: Jarod Powell

Title: Capital Assets

**For KCC Use ONLY**  
 API # 15 - 129-21858-0000  
 Conductor pipe required None feet  
 Minimum surface pipe required 320 feet per ALT.  I  II  
 Approved by: Kent 11-0-08  
 This authorization expires: 11-6-09  
 (This authorization void if drilling not started within 12 months of approval date.)  
 Spud date: Agent:

**Remember to:**

- File Drill Pit Application (form CDP-1) with Intent to Drill;
- File Completion Form ACO-1 within 120 days of spud date;
- File acreage attribution plat according to field proration orders;
- Notify appropriate district office 48 hours prior to workover or re-entry;
- Submit plugging report (CP-4) after plugging is completed (within 60 days);
- Obtain written approval before disposing or injecting salt water.
- If this permit has expired (See: authorized expiration date) please check the box below and return to the address below.

Well Not Drilled - Permit Expired Date: Signature of Operator or Agent:

26  
33  
43  
 E  
 W

**IN ALL CASES PLOT THE INTENDED WELL ON THE PLAT BELOW**

*Plat of acreage attributable to a well in a prorated or spaced field*

**If the intended well is in a prorated or spaced field, please fully complete this side of the form.** If the intended well is in a prorated or spaced field complete the plat below showing that the well will be properly located in relationship to other wells producing from the common source of supply. Please show all the wells and within 1 mile of the boundaries of the proposed acreage attribution unit for gas wells and within 1/2 mile of the boundaries of the proposed acreage attribution unit for oil wells.

API No. 15 - 129-21858-0000  
Operator: OXY USA, Inc.  
Lease: SANTA FE "A"  
Well Number: 2  
Field: Greenwood

Location of Well: County: Morton  
1,250 feet from  N /  S Line of Section  
1,250 feet from  E /  W Line of Section  
Sec. 26 Twp. 33 S. R. 43  E  W

Number of Acres attributable to well: 640  
QTR/QTR/QTR/QTR of acreage: SW NE NE

Is Section:  Regular or  Irregular

**If Section is Irregular, locate well from nearest corner boundary.**

Section corner used:  NE  NW  SE  SW

**PLAT**

*(Show location of the well and shade attributable acreage for prorated or spaced wells.)*

*(Show footage to the nearest lease or unit boundary line.)*

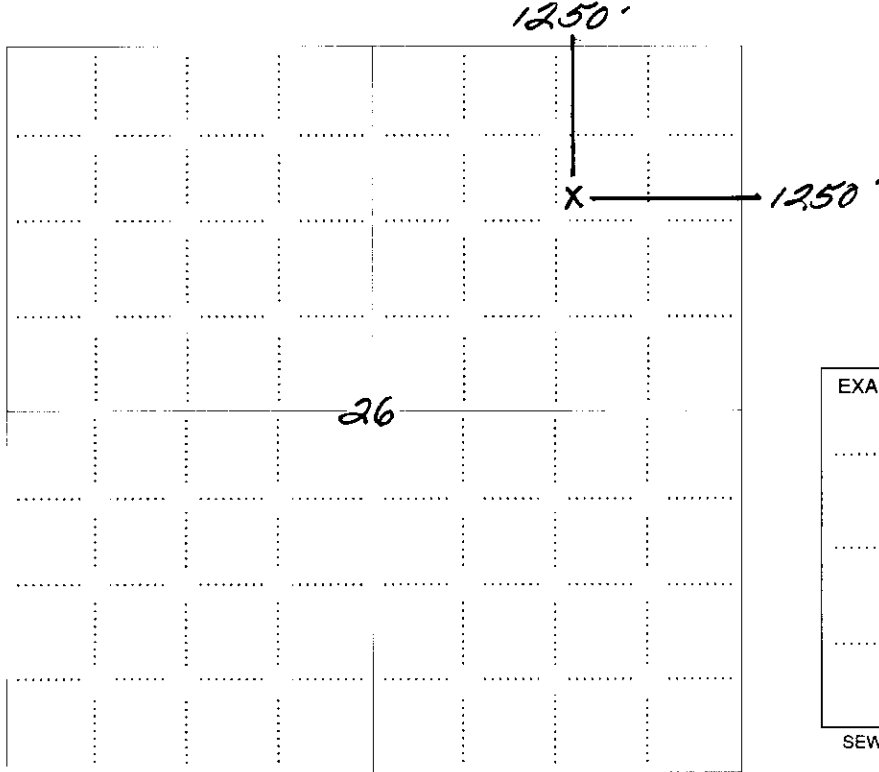

RECEIVED  
KANSAS CORPORATION COMMISSION  
NOV 05 2008  
CONSERVATION DIVISION  
WICHITA, KS

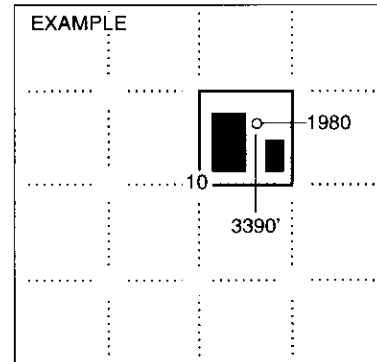

SEWARD CO.

**NOTE: In all cases locate the spot of the proposed drilling location.**

**In plotting the proposed location of the well, you must show:**

1. The manner in which you are using the depicted plat by identifying section lines, i.e. 1 section, 1 section with 8 surrounding sections, 4 sections, etc.
2. The distance of the proposed drilling location from the south / north and east / west outside section lines.
3. The distance to the nearest lease or unit boundary line (in footage).
4. If proposed location is located within a prorated or spaced field a certificate of acreage attribution plat must be attached: (CO-7 for oil wells; CG-8 for gas wells).

**PLAT AND CERTIFICATION OF ACREAGE ATTRIBUTABLE TO A GAS WELL**

Kansas Corporation Commission, Conservation Division  
 Finney State Office Building, 130 South Market, Room 2078  
 Wichita, Kansas 67202

API NUMBER 15-129-21858-0000  
 OPERATOR OXY USA Inc.  
 LEASE Santa Fe "A"  
 WELL NUMBER 2  
 FIELD Greenwood  
 NUMBER OF ACRES ATTRIBUTABLE TO WELL 640  
 QTR/QTR/QTR OF ACREAGE SW — NE — NE

LOCATION OF WELL: COUNTY Morton  
1250 Feet from south / north line of section  
1250 Feet from east / west line of section  
 SECTION 26 TWP 33 (S) RG 43 E / W  
 IS SECTION X REGULAR or IRREGULAR  
 IF SECTION IS IRREGULAR, LOCATE WELL FROM  
 NEAREST CORNER BOUNDARY, (check line below)  
 Section corner used: NE NW SE SW

(Show the location of the well and shade attributable acreage for prorated or spaced wells). (Show the footage to the nearest lease or unit boundary line; and show footage to the nearest common source supply well).

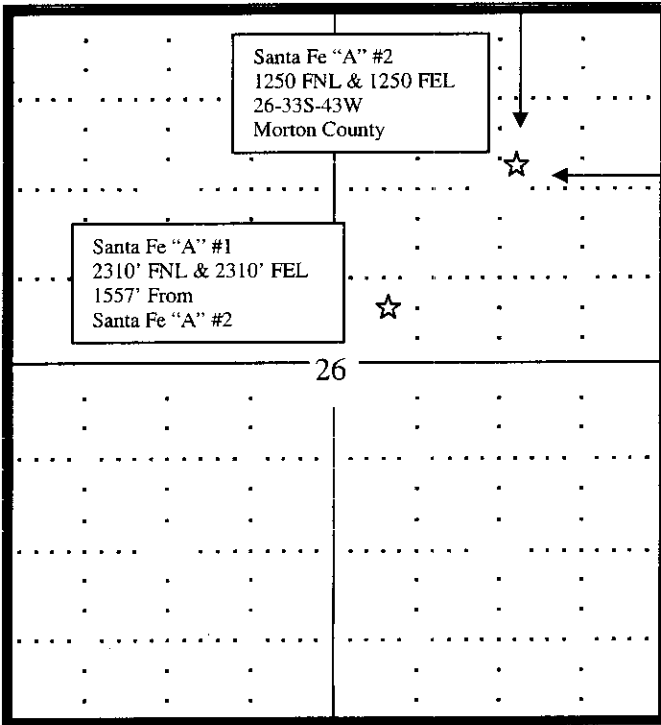

RECEIVED  
 KANSAS CORPORATION COMMISSION

NOV 05 2008

CONSERVATION DIVISION  
 WICHITA, KS

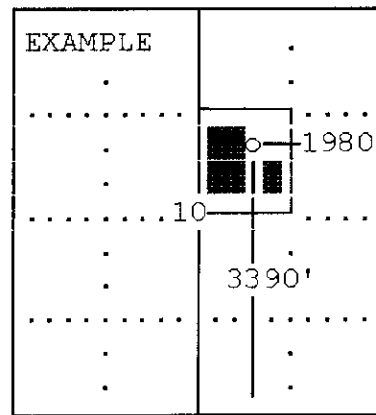

The undersigned hereby certifies as \_\_\_\_\_ Capital Assets \_\_\_\_\_ (title) for

\_\_\_\_\_ OXY USA Inc. \_\_\_\_\_ (Co.), a duly authorized agent, that all information shown hereon is true and correct to the best of my knowledge and belief, that all acreage claimed attributable to the well named herein is held by production from that well and hereby make application for an allowable to be assigned to the well upon the filing of this form and the State test, whichever is later.

Subscribed and sworn to before me on this 4<sup>th</sup> day of Nov, 2008

Signature [Signature]  
 \_\_\_\_\_  
Anita Peterson  
 Notary Public

My Commission expires Oct. 1, 2009

FORM CG-8 (12/94)

**ANITA PETERSON**  
 Notary Public - State of Kansas  
 My Appt. Expires October 1, 2009

af

**KANSAS CORPORATION COMMISSION  
OIL & GAS CONSERVATION DIVISION  
APPLICATION FOR SURFACE PIT**

Form CDP-1  
April 2004  
Form must be Typed

*Submit in Duplicate*

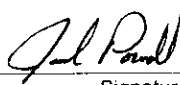
Operator Name: <b>OXY USA Inc.</b>		License Number: <b>5447</b>
Operator Address: <b>P. O. Box 2528, Liberal, KS 67901</b>		
Contact Person: <b>Terry Yoder</b>		Phone Number: ( <b>620</b> ) <b>697 - 2500</b>
Lease Name & Well No.: <b>Santa Fe A-2</b>		Pit Location (QQQQ): <b>SW NE NE</b>
Type of Pit: <input type="checkbox"/> Emergency Pit <input type="checkbox"/> Burn Pit <input type="checkbox"/> Settling Pit <input checked="" type="checkbox"/> Drilling Pit <input type="checkbox"/> Workover Pit <input type="checkbox"/> Haul-Off Pit <small>(If WP Supply API No. or Year Drilled)</small>	Pit is: <input checked="" type="checkbox"/> Proposed <input type="checkbox"/> Existing If Existing, date constructed: _____ Pit capacity: <b>16000</b> (bbls)	Sec. <b>26</b> Twp. <b>33S</b> R. <b>43</b> <input type="checkbox"/> East <input checked="" type="checkbox"/> West <b>1250</b> Feet from <input checked="" type="checkbox"/> North / <input type="checkbox"/> South Line of Section <b>1250</b> Feet from <input checked="" type="checkbox"/> East / <input type="checkbox"/> West Line of Section <b>Morton</b> County
Is the pit located in a Sensitive Ground Water Area? <input type="checkbox"/> Yes <input checked="" type="checkbox"/> No		Chloride concentration: _____ mg/l <small>(For Emergency Pits and Settling Pits only)</small>
Is the bottom below ground level? <input checked="" type="checkbox"/> Yes <input type="checkbox"/> No	Artificial Liner? <input type="checkbox"/> Yes <input checked="" type="checkbox"/> No	How is the pit lined if a plastic liner is not used? <b>Bentonite &amp; Cuttings</b>
Pit dimensions (all but working pits): <b>150</b> Length (feet) <b>150</b> Width (feet) <b>N/A: Steel Pits</b> Depth from ground level to deepest point: <b>4</b> (feet)		
If the pit is lined give a brief description of the liner material, thickness and installation procedure.		Describe procedures for periodic maintenance and determining liner integrity, including any special monitoring.
Distance to nearest water well within one-mile of pit <b>977</b> feet    Depth of water well <b>180</b> feet		Depth to shallowest fresh water <b>110</b> feet. Source of information: _____ measured    _____ well owner    _____ electric log <input checked="" type="checkbox"/> KDWR
<b>Emergency, Settling and Burn Pits ONLY:</b> Producing Formation: _____ Number of producing wells on lease: _____ Barrels of fluid produced daily: _____ Does the slope from the tank battery allow all spilled fluids to flow into the pit? <input type="checkbox"/> Yes <input type="checkbox"/> No		<b>Drilling, Workover and Haul-Off Pits ONLY:</b> Type of material utilized in drilling/workover: <b>Fresh Water Mud</b> Number of working pits to be utilized: <b>1</b> Abandonment procedure: <b>Evaporation and Backfill</b>  RECEIVED Drill pits must be closed within 365 days of spud date. KANSAS CORPORATION COMMISSION
I hereby certify that the above statements are true and correct to the best of my knowledge and belief.		<b>NOV 05 2008</b>
<b>11/04/2008</b> Date	 Signature of Applicant or Agent	CONSERVATION DIVISION WICHITA, KS

15-129-2188-000

<b>KCC OFFICE USE ONLY</b>			
Date Received: <b>11/5/08</b>	Permit Number: _____	Permit Date: <b>11/5/08</b>	Lease Inspection: <input type="checkbox"/> Yes <input checked="" type="checkbox"/> No

Mail to: KCC - Conservation Division, 130 S. Market - Room 2078, Wichita, Kansas 67202