

For KCC Use:
 Effective Date: 11-22-08
 District # 3
 SGA? Yes No

KANSAS CORPORATION COMMISSION
 OIL & GAS CONSERVATION DIVISION

Form C-1
 October 2007
 Form must be Typed
 Form must be Signed
 All blanks must be Filled

NOTICE OF INTENT TO DRILL

Must be approved by KCC five (5) days prior to commencing well

Expected Spud Date: 11 month 30 day 2008 year

OPERATOR: License# 33252
 Name: Matador, Inc.
 Address 1: P. O. Box 337
 Address 2: _____
 City: Sedan State: Ks. Zip: 67361 + _____
 Contact Person: Tim Nordell
 Phone: 620-725-3366
 CONTRACTOR: License# 8736
 Name: James David Dixon

Spot Description:
 NE NE SE SE Sec. 33 Twp. 33 S. R. 11 E W
 (1/4/1/4) 1,000 feet from N / S Line of Section
270 feet from E / W Line of Section

Is SECTION: Regular Irregular?
 (Note: Locate well on the Section Plat on reverse side)
 County: Chautauqua

Lease Name: Homestead Well #: 9
 Field Name: Peru-Sedan
 Is this a Prorated / Spaced Field? Yes No
 Target Formation(s): Arbuckle

Well Drilled For: Oil Gas Seismic; # of Holes _____
 Enh Rec Storage Disposal
 Other: _____
 Well Class: Infield Pool Ext. Wildcat Other
 Type Equipment: Mud Rotary Air Rotary Cable

Nearest Lease or unit boundary line (in footage): 270
 Ground Surface Elevation: 840 topo _____ feet MSL
 Water well within one-quarter mile: Yes No
 Public water supply well within one mile: Yes No
 Depth to bottom of fresh water: 250 / 100
 Depth to bottom of usable water: 100 / 280
 Surface Pipe by Alternate: I II
 Length of Surface Pipe Planned to be set: 40'
 Length of Conductor Pipe (if any): none
 Projected Total Depth: 2100'
 Formation at Total Depth: Arbuckle

If OWWO: old well information as follows:
 Operator: _____
 Well Name: _____
 Original Completion Date: _____ Original Total Depth: _____

Water Source for Drilling Operations:
 Well Farm Pond Other: _____
 DWR Permit #: _____
 (Note: Apply for Permit with DWR
 Will Cores be taken? Yes No
 If Yes, proposed zone: _____

Directional, Deviated or Horizontal wellbore? Yes No
 If Yes, true vertical depth: _____
 Bottom Hole Location: _____
 KCC DKT #: _____

AFFIDAVIT

The undersigned hereby affirms that the drilling, completion and eventual plugging of this well will comply with K.S.A. 55 et. seq.
 It is agreed that the following minimum requirements will be met:

1. Notify the appropriate district office **prior** to spudding of well;
2. A copy of the approved notice of intent to drill **shall be** posted on each drilling rig;
3. The minimum amount of surface pipe as specified below **shall be set** by circulating cement to the top; in all cases surface pipe **shall be set** through all unconsolidated materials plus a minimum of 20 feet into the underlying formation.
4. If the well is dry hole, an agreement between the operator and the district office on plug length and placement is necessary **prior to plugging**;
5. The appropriate district office will be notified before well is either plugged or production casing is cemented in;
6. If an ALTERNATE II COMPLETION, production pipe shall be cemented from below any usable water to surface within **120 DAYS** of spud date. Or pursuant to Appendix "B" - Eastern Kansas surface casing order #133,891-C, which applies to the KCC District 3 area, alternate II cementing must be completed within 30 days of the spud date or the well shall be plugged. **In all cases, NOTIFY district office** prior to any cementing.

I hereby certify that the statements made herein are true and correct to the best of my knowledge and belief.

Date: 11/12/08 Signature of Operator or Agent: Tim D. Nordell Title: President

For KCC Use ONLY
 API # 15 - 019-26949-0000
 Conductor pipe required None feet
 Minimum surface pipe required 300 feet per ALT. I II
 Approved by: Tim D. Nordell 11-17-08
 This authorization expires: 11-17-09
 (This authorization void if drilling not started within 12 months of approval date.)
 Spud date: _____ Agent: _____

- Remember to:
- File Drill Pit Application (form CDP-1) with Intent to Drill;
 - File Completion Form ACO-1 within 120 days of spud date;
 - File acreage attribution plat according to field proration orders;
 - Notify appropriate district office 48 hours prior to workover or re-entry;
 - Submit plugging report (CP-4) after plugging is completed (within 60 days);
 - Obtain written approval before disposing or injecting salt water.
 - If this permit has expired (See: authorized expiration date) please check the box below and return to the address below.

Well Not Drilled - Permit Expired Date: _____
 Signature of Operator or Agent: _____

RECEIVED
 KANSAS CORPORATION COMMISSION

Mail to: KCC - Conservation Division, 130 S. Market - Room 2078, Wichita, Kansas 67202

NOV 14 2008

CONSERVATION DIVISION
 WICHITA, KS

IN ALL CASES PLOT THE INTENDED WELL ON THE PLAT BELOW

Plat of acreage attributable to a well in a prorated or spaced field

If the intended well is in a prorated or spaced field, please fully complete this side of the form. If the intended well is in a prorated or spaced field complete the plat below showing that the well will be properly located in relationship to other wells producing from the common source of supply. Please show all the wells and within 1 mile of the boundaries of the proposed acreage attribution unit for gas wells and within 1/2 mile of the boundaries of the proposed acreage attribution unit for oil wells.

API No. 15 - 019-26949-0000

Operator: Matador, Inc.

Lease: Homestead

Well Number: 9

Field: Peru-Sedan

Number of Acres attributable to well: _____

QTR/QTR/QTR/QTR of acreage: NE - NE - SE - SE

Location of Well: County: Chautauqua

1,000 feet from N / S Line of Section

270 feet from E / W Line of Section

Sec. 33 Twp. 33 S. R. 11 E W

Is Section: Regular or Irregular

If Section is Irregular, locate well from nearest corner boundary.

Section corner used: NE NW SE SW

PLAT

(Show location of the well and shade attributable acreage for prorated or spaced wells.)

(Show footage to the nearest lease or unit boundary line.)

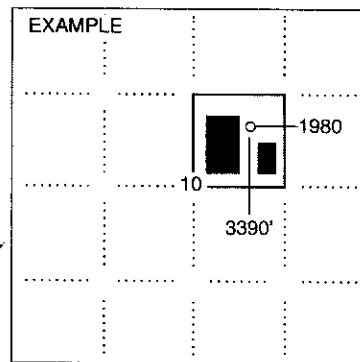
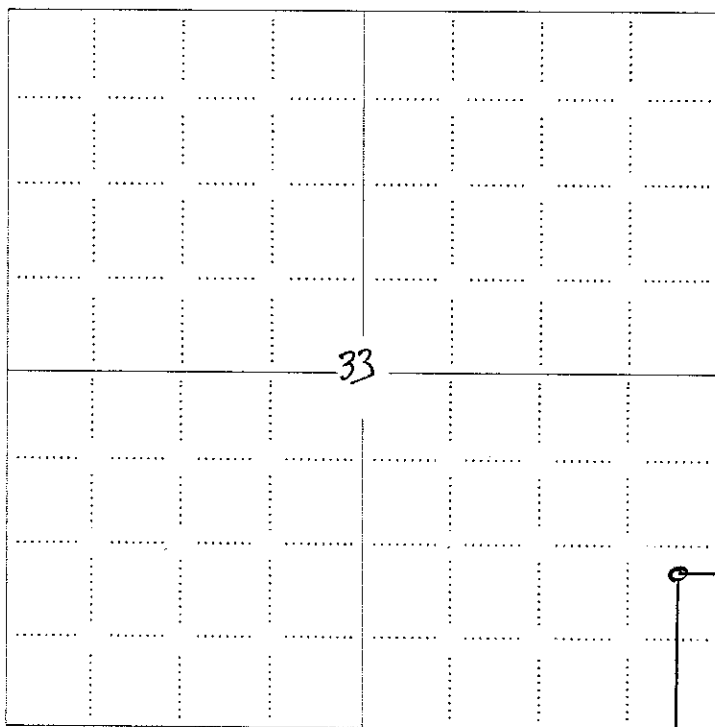

NOTE: In all cases locate the spot of the proposed drilling location.

RECEIVED
KANSAS CORPORATION COMMISSION

NOV 14 2008

CONSERVATION DIVISION
WICHITA, KS

In plotting the proposed location of the well, you must show:

1. The manner in which you are using the depicted plat by identifying section lines, i.e. 1 section, 1 section with 8 surrounding sections, 4 sections, etc.
2. The distance of the proposed drilling location from the south / north and east / west outside section lines.
3. The distance to the nearest lease or unit boundary line (in footage).
4. If proposed location is located within a prorated or spaced field a certificate of acreage attribution plat must be attached: (CO-7 for oil wells; CG-8 for gas wells).

**KANSAS CORPORATION COMMISSION
OIL & GAS CONSERVATION DIVISION
APPLICATION FOR SURFACE PIT**

Form CDP-1
April 2004
Form must be Typed

Submit in Duplicate

Operator Name: Matador, Inc.		License Number: 33252
Operator Address: P. O. Box 337		Sedan Ks. 67361
Contact Person: Tim Nordell		Phone Number: 620-725-3366
Lease Name & Well No.: Homestead 9		Pit Location (QQQQ): NE NE SE SE Sec. 33 Twp. 33 R. 11 <input checked="" type="checkbox"/> East <input type="checkbox"/> West 1,000 Feet from <input type="checkbox"/> North / <input checked="" type="checkbox"/> South Line of Section 270 Feet from <input checked="" type="checkbox"/> East / <input type="checkbox"/> West Line of Section Chautauqua County
Type of Pit: <input type="checkbox"/> Emergency Pit <input type="checkbox"/> Burn Pit <input type="checkbox"/> Settling Pit <input checked="" type="checkbox"/> Drilling Pit <input type="checkbox"/> Workover Pit <input type="checkbox"/> Haul-Off Pit <small>(If WP Supply API No. or Year Drilled)</small>	Pit is: <input checked="" type="checkbox"/> Proposed <input type="checkbox"/> Existing If Existing, date constructed: _____ Pit capacity: 350 (bbls)	
Is the pit located in a Sensitive Ground Water Area? <input type="checkbox"/> Yes <input checked="" type="checkbox"/> No		Chloride concentration: _____ mg/l <small>(For Emergency Pits and Settling Pits only)</small>
Is the bottom below ground level? <input checked="" type="checkbox"/> Yes <input type="checkbox"/> No	Artificial Liner? <input type="checkbox"/> Yes <input checked="" type="checkbox"/> No	How is the pit lined if a plastic liner is not used? Clay
Pit dimensions (all but working pits): 60 Length (feet) 7 Width (feet) <input type="checkbox"/> N/A: Steel Pits Depth from ground level to deepest point: 6 (feet) <input type="checkbox"/> No Pit		
If the pit is lined give a brief description of the liner material, thickness and installation procedure. DUG IN NATURAL CLAY MATERIAL		Describe procedures for periodic maintenance and determining liner integrity, including any special monitoring. SHORT TERM PIT
Distance to nearest water well within one-mile of pit 3300 feet Depth of water well 78 feet		Depth to shallowest fresh water 78 39 feet. Source of information: <input type="checkbox"/> measured <input type="checkbox"/> well owner <input type="checkbox"/> electric log <input checked="" type="checkbox"/> KDWR
Emergency, Settling and Burn Pits ONLY: Producing Formation: _____ Number of producing wells on lease: _____ Barrels of fluid produced daily: _____ Does the slope from the tank battery allow all spilled fluids to flow into the pit? <input type="checkbox"/> Yes <input type="checkbox"/> No		Drilling, Workover and Haul-Off Pits ONLY: Type of material utilized in drilling/workover: FRESH WATER Number of working pits to be utilized: 2 Abandonment procedure: Evaporate water & backfill Drill pits must be closed within 365 days of spud date.
I hereby certify that the above statements are true and correct to the best of my knowledge and belief.		
11/12/08 Date		Tim O. Nordell, President Signature of Applicant or Agent
KCC OFFICE USE ONLY		
Date Received: 11/14/08 Permit Number: _____		Steel Pit <input type="checkbox"/> RFAC <input type="checkbox"/> RFAS <input type="checkbox"/>
Permit Date: 11/14/08 Lease Inspection: <input type="checkbox"/> Yes <input checked="" type="checkbox"/> No		

15-019-26949-888 NOV 14 2008

CONSERVATION DIVISION
WICHITA, KS