

Plugged 7-30-87

SIDE ONE

STATE CORPORATION COMMISSION OF KANSAS
OIL & GAS CONSERVATION DIVISION
WELL COMPLETION OR RECOMPLETION FORM
ACO-1 WELL HISTORY
DESCRIPTION OF WELL AND LEASE

API NO. 15-065-22,391-00-DD
County Graham
SE SW SE Sec 33 Twp 10S Rge 22 East West
330 Ft North from Southeast Corner of Section
1650 Ft West from Southeast Corner of Section
(Note: Locate well in section plat below)
Lease Name Jim Faulkner Well # 1
Field Name
Producing Formation N/A
Elevation: Ground 2262' KB 2267'

Operator: License # 4767
Name Ritchie Exploration, Inc.
Address 125 N. Market, Suite 1000
Wichita, KS 67202
City/State/Zip

Purchaser N/A

Operator Contact Person Leah Ann Kasten
Phone 316-267-4375

Contractor: License # 6033
Name Murfin Drilling Company

Wellsite Geologist Bob Mathiesen
Phone 316-267-4375

Designate Type of Completion
x New Well Re-Entry Workover
Oil SWD Temp Abd
Gas Inj Delayed Comp.
X Dry Other (Core, Water Supply etc.)

If OWNO: old well info as follows:
Operator
Well Name
Comp. Date Old Total Depth

WELL HISTORY

Drilling Method:
x Mid Rotary Air Rotary Cable
7-16-87 7-19-87 7-20-87
Spud Date Date Reached TD Completion Date
3608' N/A
Total Depth PBDT
Amount of Surface Pipe Set and Cemented at 8-5/8" @ 215' feet
Multiple Stage Cementing Collar Used? Yes X No
If yes, show depth set feet
If alternate 2 completion, cement circulated from feet depth to w/SX cmt
Cement Company Name
Invoice #

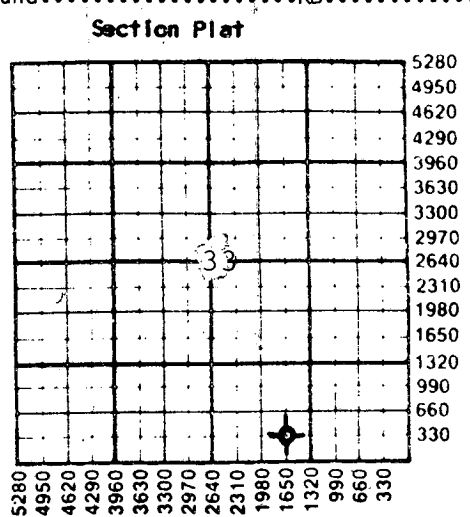

WATER SUPPLY INFORMATION

Disposition of Produced Water: Disposal
Docket # N/A Repressuring

Questions on this portion of the ACO-1 call:
Water Resources Board (913) 296-3717

Source of Water: Hauled.
Division of Water Resources Permit #
Groundwater Ft North from Southeast Corner (Well) Ft West from Southeast Corner of Sec Twp Rge East West
Surface Water Ft North from Southeast Corner (Stream, pond etc) Ft West from Southeast Corner Sec Twp Rge East West
Other (explain) (purchased from city, R.W.D. #)

INSTRUCTIONS: This form shall be completed in triplicate and filed with the Kansas Corporation Commission, 200 Colorado Derby Building, Wichita, Kansas 67202, within 120 days of the spud date of any well. Rule 82-3-130, 82-3-107 and 82-3-106 apply. Information on side two of this form will be held confidential for a period of 12 months if requested in writing and submitted with the form. See rule 82-3-107 for confidentiality in excess of 12 months. One copy of all wireline logs and drillers time log shall be attached with this form. Submit CP-4 form with all plugged wells. Submit CP-111 form with all temporarily abandoned wells.

All requirements of the statutes, rules and regulations promulgated to regulate the oil and gas industry have been fully complied with and the statements herein are complete and correct to the best of my knowledge.

Signature [Signature]
Title Vice President Date 11/20/87

Subscribed and sworn to before me this 20th day of November 1987.
Notary Public Linda K. Rice
Date Commission Expires 6/07/88

K.C.C. OFFICE USE ONLY
F Letter of Confidentiality Attached
C [x] Wireline Log Received
C Drillers Timelog Received
Distribution
[x] KCC SWD/Rep NGPA
[x] KGS Plug Other (Specify)

LINDA K. RICE
NOTARY PUBLIC
STATE OF KANSAS
My Appt. Exp. 6/07/88

NOV 25 1987
NOV 25 1987

Sec 33 Twp 10 Rge 22 E

SIDE TWO

Operator Name Ritchie Exploration, Inc. Lease Name..... Jim Faulkner Well #..... 1

Sec..... 33 Twp..... 10S Rge..... 22 East West County..... Graham

WELL LOG

INSTRUCTIONS: Show important tops and base of formations penetrated. Detail all cores. Report all drill stem tests giving interval tested, time tool open and closed, flowing and shut-in pressures, whether shut-in pressure reached static level, hydrostatic pressures, bottom hole temperature, fluid recovery, and flow rates if gas to surface during test. Attach extra sheet if more space is needed. Attach copy of log.

Drill Stem Tests Taken Yes No
 Samples Sent to Geological Survey Yes No
 Cores Taken Yes No

Formation Description
 Log Sample

Name	Top	Bottom
Anhydrite	1745' (+ 522)	
B/Anhydrite	1787' (+ 480)	
Topeka	3303' (-1036)	
Heebner	3519' (-1252)	
Toronto	3540' (-1273)	
Lansing	3555' (-1288)	
LTD	3607' (-1340)	

CASING RECORD <input checked="" type="checkbox"/> New <input type="checkbox"/> Used							
Report all strings set-conductor, surface, intermediate, production, etc.							
Purpose of String	Size Hole Drilled	Size Casing Set (in O.D.)	Weight Lbs/Ft.	Setting Depth	Type of Cement	#Sacks Used	Type and Percent Additives
.....Surface.....	12 1/2"	8-5/8"	23#	215	60-40 Poz	140	2% gel, 3% cc
.....
.....

PERFORATION RECORD		Acid, Fracture, Shot, Cement Squeeze Record	
Shots Per Foot	Specify Footage of Each Interval Perforated	(Amount and Kind of Material Used)	Depth
.....
.....
.....
.....

TUBING RECORD	Size	Set At	Packer at	Liner Run	<input type="checkbox"/> Yes <input type="checkbox"/> No
Date of First Production	Producing Method <input type="checkbox"/> Flowing <input type="checkbox"/> Pumping <input type="checkbox"/> Gas Lift <input type="checkbox"/> Other (explain).....				
Estimated Production Per 24 Hours	Oil	Gas	Water	Gas-Oil Ratio	Gravity
	Bbls	MCF	Bbls	CFPB	

METHOD OF COMPLETION

Production Interval

Disposition of gas: Vented Open Hole Perforation
 Solid Other (Specify)
 Used on Lease Dually Completed
 Commingled