

WELL PLUGGING RECORD

Give All Information Completely
Make Required Affidavit
Mail or Deliver Report to:
Conservation Division
State Corporation Commission
212 North Market, Insurance Bldg.
Wichita, Kansas

Graham County, Sec. 29 Twp. 10s Rge. 25W (E) (W)

Location as "NE/CNW/SW" or footage from lines C SE NW
Lease Owner John O. Farmer, Inc.
Lease Name Brungardt C Well No. 1
Office Address P.O. Box 352, Russell, Kansas
Character of Well (completed as Oil, Gas or Dry Hole) Dry Hole
Date well completed 5/31 1963
Application for plugging filed 5/31 1963
Application for plugging approved 5/31 1963
Plugging commenced 5/31 1963
Plugging completed 3:30 A. M. 5/31 1963
Reason for abandonment of well or producing formation Dry

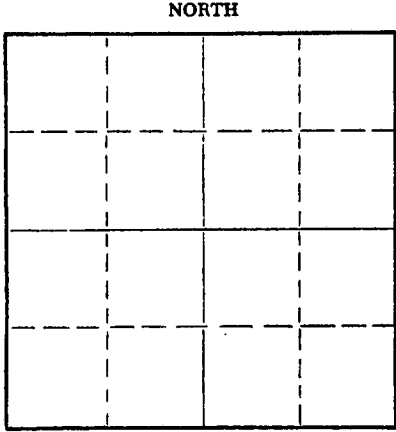

Locate well correctly on above Section Plat

If a producing well is abandoned, date of last production _____ 19____
Was permission obtained from the Conservation Division or its agents before plugging was commenced? Yes

Name of Conservation Agent who supervised plugging of this well W. L. Nichols
Producing formation _____ Depth to top _____ Bottom _____ Total Depth of Well 4085 Feet
Show depth and thickness of all water, oil and gas formations.

OIL, GAS OR WATER RECORDS

CASING RECORD

FORMATION	CONTENT	FROM	TO	SIZE	PUT IN	PULLED OUT

Describe in detail the manner in which the well was plugged, indicating where the mud fluid was placed and the method or methods used in introducing it into the hole. If cement or other plugs were used, state the character of same and depth placed, from _____ feet to _____ feet for each plug set.

Plug # 1 @ 540' 20 sx. cement thru drill pipe
Plug # 2 @ 150' 1/4 sx. hulls 20 sx. cement
Plug # 3 @ 40' 1/4 sx. hulls 10 sx. cement

Completed 3:30 A.M. 5/31/63

RECEIVED
STATE CORPORATION COMMISSION
JUN 6 1963
06-06-1963
CONSERVATION DIVISION
Wichita, Kansas

(If additional description is necessary, use BACK of this sheet)
Name of Plugging Contractor John O. Farmer, Inc.
Address P.O. Box 352, Russell, Kansas

STATE OF KANSAS COUNTY OF RUSSELL, ss.
JOHN O. FARMER (employee of owner) or (owner or operator) of the above-described well, being first duly sworn on oath, says: That I have knowledge of the facts, statements, and matters herein contained and the log of the above-described well as filed and that the same are true and correct. So help me God.

(Signature) John O. Farmer
P.O. Box 352, Russell, Kansas President
(Address)

SUBSCRIBED AND SWORN to before me this 4th. day of June, 1963

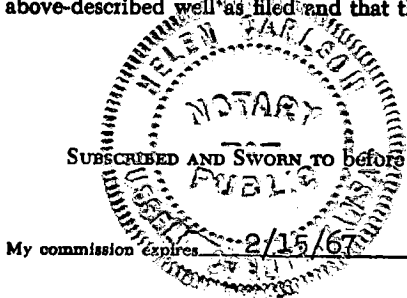

Helen Carlson Notary Public.

ADDRESS P.O. Box 352, Russell, Kansas

Give detailed description and thickness of all formation drilled through, contents of sand, whether dry, water, oil or gas.

RGE. TWP. SEC. COUNTY. WELL NO. FARM NAME

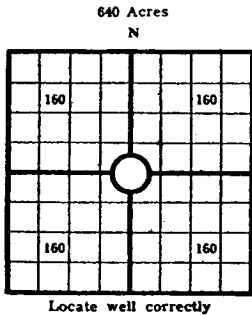

COUNTY Graham, SEC. 29, TWP. 10S, RGE. 25W
 COMPANY OPERATING John O. Farmer, Inc.
 OFFICE ADDRESS P.O. Box 352, Russell, Ks.
 DRILLING STARTED 5/23, 1963, DRILLING FINISHED 5/31, 1963
 DATE OF FIRST PRODUCTION _____ COMPLETED _____
 WELL LOCATED C 1/4 SE 1/4 NW 1/4, North of South
 Line and _____ ft. East of West Line of Quarter Section
 Elevation (Relative to sea level) DERRICK FLOOR 2518 GROUND 2516
 CHARACTER OF WELL (Oil, gas or dryhole) Dry Hole

OIL OR GAS SANDS OR ZONES

Name	From	To	Name	From	To
1			4		
2			5		
3			6		

Perforating Record If Any

Shot Record

Formation	From	To	No. of Shots	Formation	From	To	Size of Shot

CASING RECORD

Amount Set							Amount Pulled		Packer Record		
Size	Wt.	Thds.	Make	Ft.	In.	Ft.	In.	Size	Length	Depth Set	Make

Liner Record: Amount _____ Kind _____ Top _____ Bottom _____

CEMENTING AND MUDDING

Size	Amount Set		Sacks Cement	Chemical		Method of Cementing	Amount	Mudding Method	Results (See Note)
	Ft.	In.		Gal.	Make				
8 5/8	129'		150						

Note: What method was used to protect sands if outer strings were pulled? _____

NOTE: Were bottom hole plugs used? _____ If so, state kind, depth set and results obtained _____

TOOLS USED

Rotary Tools were used from 0 feet to T.D. Cable tools were used from _____ feet to _____ feet, and from _____ feet to _____ feet, and from _____ feet to _____ feet.

Type Rig Rotary

INITIAL PRODUCTION TEST

Describe initial test: whether by flow through tubing or casing or by pumping _____

Amount of Oil Production _____ bbls. Size of choke, if any _____ Length of test _____ Water

Production _____ bbls. Gravity of oil _____ Type of Pump if pump is used, describe _____

Formation	Top	Bottom	Formation	Top	Bottom
Shale	160	1430			
Shale & Sand	1430	1810			
Shale & Shells	2172	2600			
Shale & Lime	2600	2940			
Lime & Shale	2940	4085			
T. D.	4085'				
			Log Tops		
			Heebner	3804	(-1284)
			Toronto	3826	(-1304)
			Lansing KC	3842	(-1322)
			Base-Kansas C	4073	(-1553)
			Total Depth	4086	(-1566)

RECEIVED
 STATE CORPORATION COMMISSION
 JUN 6 1963
 CONSERVATION DIVISION
 WICHITA, KANSAS

I, the undersigned, being first duly sworn upon oath state that this well record is true, correct and complete according to the records of this office and to the best of my knowledge and belief.

John O. Farmer
 Name and title of representative of company
 President

Subscribed and sworn to before me this 4th day of June, 1963

My Commission expires 2/15/67
Helen Carlson
 Notary Public.