

EFFECTIVE DATE: 12-18-90

15-065-22615-00-00

FORM MUST BE TYPED  
FORM C-1 4/90

State of Kansas  
NOTICE OF INTENTION TO DRILL

FORM MUST BE SIGNED  
ALL BLANKS MUST BE FILLED

Must be approved by the K.C.C. five (5) days prior to commencing well

Expected Spud Date ... 1 month ... 4 day ... 91 year

SW NE SE Sec ... 1 Twp 10 S, Rg 25 X East West

OPERATOR: License # 30063  
Name: Weststar Resources, Inc.  
Address: P.O. Box 509  
City/State/Zip: Purcell, OK 73080-0509  
Contact Person: Larry Cory  
Phone: 405-5273900 or 405-527-5515

1650 feet from South line of Section  
990 feet from East line of Section  
(Note: Locate well on Section Plat on Reverse Side)

CONTRACTOR: License #: 8241  
Name: Emphasis Oil Operations

County: Graham  
Lease Name: Herman Well #: 1  
Field Name: Harmony North  
Is this a Prorated Field? yes X no  
Target Formation(s): Lansing-K.C.  
Nearest lease or unit boundary: 990  
Ground Surface Elevation: 2177 feet MSL  
Domestic well within 330 feet: yes X no  
Municipal well within one mile: yes X no  
Depth to bottom of fresh water: 150 100  
Depth to bottom of usable water: 1125 1050  
Surface Pipe by Alternate: 1 X 2  
Length of Surface Pipe Planned to be set: 200  
Length of Conductor pipe required: N/A  
Projected Total Depth: 4200  
Formation at Total Depth: Mississippi  
Water Source for Drilling Operations:  
... well X farm pond ... other  
DWR Permit #:   
Will Cores Be Taken?: yes X no  
If yes, proposed zone:

Well Drilled For: Well Class: Type Equipment:  
X Oil Inj X Infield X Mud Rotary  
... Gas ... Storage ... Pool Ext. ... Air Rotary  
... OWWO ... Disposal ... Wildcat ... Cable  
... Seismic; ... # of Holes

If OWWO: old well information as follows:  
Operator:   
Well Name:   
Comp. Date: Old Total Depth

Directional, Deviated or Horizontal wellbore? yes X no  
If yes, total depth location:

AFFIDAVIT

The undersigned hereby affirms that the drilling, completion and eventual plugging of this well will comply with K.S.A. 55-101, et. seq.

It is agreed that the following minimum requirements will be met:

- 1. The appropriate district office shall be notified before setting surface pipe;
- 2. The minimum amount of surface pipe as specified above shall be set by circulating cement to the top; in all cases surface pipe shall be set through all unconsolidated materials plus a minimum of 20 feet into the underlying formation;
- 3. If the well is dry, a plugging proposal shall be submitted to the district office. An agreement between the operator and the district office on plug length and placement is necessary prior to plugging;
- 4. The appropriate district office will be notified before well is either plugged or production casing is cemented in;
- 5. If an Alternate II completion, production pipe shall be cemented from below any usable water to surface within 120 days of spud date. In all cases, notify district office prior to any cementing.

I hereby certify that the statements made herein are true and to the best of my knowledge and belief.

Date: 12/6/90 Signature of Operator or Agent: [Signature] Title: Owner/Operator  
Geologist

FOR KCC USE:  
API # 15- 065-22,615  
Conductor pipe required None feet  
Minimum surface pipe required 200 feet per Alt. (2)  
Approved by: [Signature] 12-13-90  
EFFECTIVE DATE: 12-18-90  
This authorization expires: 6-13-91  
(This authorization void if drilling not started within 6 months of effective date.)  
Spud date: Agent:

RECEIVED  
STATE CORPORATION COMMISSION  
12-13-90  
DEC 13 1990  
CONSERVATION DIVISION  
Wichita, Kansas

REMEMBER TO:

- File Drill Pit Application (form CDP-1) with Intent to Drill;
- File Completion Form ACO-1 within 120 days of spud date;
- File acreage attribution plat according to field proration orders;
- Notify appropriate district office 48 hours prior to workover or re-entry;
- Submit plugging report (CP-4) after plugging is completed;
- Obtain written approval before disposing or injecting salt water.

1  
10  
25m

### PLAT OF ACREAGE ATTRIBUTABLE TO A WELL

State Corporation Commission, Conservation Division  
200 Colorado Derby Bldg. Wichita, Kansas 67202

OPERATOR Weststar Resources, Inc. LOCATION OF WELL:  
 LEASE Herman 1650 feet north of SE corner  
 WELL NUMBER 1 990 feet west of SE corner  
 FIELD Harmony North SE/4 Sec. 1 T 10 R 25 NE/W  
 COUNTY Graham  
 NO. OF ACRES ATTRIBUTABLE TO WELL 10 IS SECTION X REGULAR IRREGULAR?  
 IF IRREGULAR, LOCATE WELL FROM NEAREST  
 DESCRIPTION OF ACREAGE SE/4 SE/4 CORNER BOUNDARY.

NOTE: If plat depicted is insufficient for your circumstances, you may attach your own scaled or surveyed plat.

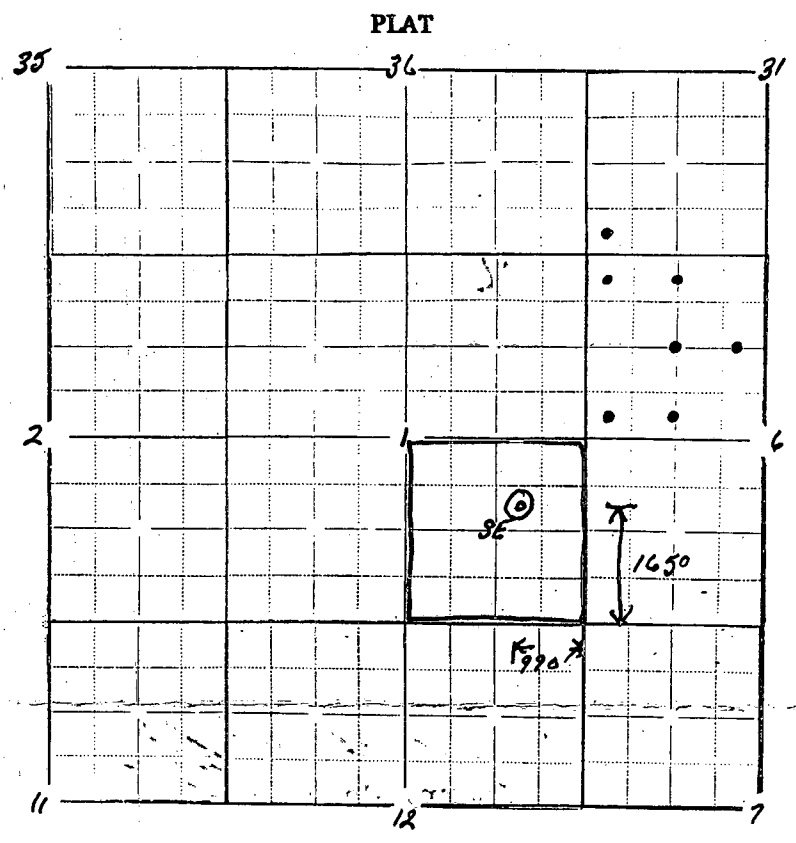

- In plotting the proposed location of the well, you must show:
- 1) The manner in which you are using the depicted plat by identifying section lines, i.e. 1 section, 4 sections, 16 sections, etc.;
  - 2) the well's location relative to the location of other wells producing from the same common source of supply in adjoining drilling units, pursuant to K.A.R. 82-3-108, 82-3-207, 82-3-312, or special orders of the Commission;
  - 3) the distance of the proposed drilling location from the section's east and south lines; and
  - 4) the distance to the nearest lease or unit boundary line.

I hereby certify that the statements made herein are true and to the best of my knowledge and belief.

Signature of Operator or Agent [Signature]  
 Date 12/6/90 Title Geologist