

Give All Information Completely
Make Required Affidavit
Mail or Deliver Report to:
Conservation Division
State Corporation Commission
212 No. Market
Wichita, Kansas

WELL PLUGGING RECORD

GRAHAM County, Sec. 12 Twp. 10s Rge. 25 (E) (W)
Location as "NE/CNW*SW*" or footage from lines C SE NW
Lease Owner PETROLEUM, INC.,
Lease Name HERMAN Well No. H-1
Office Address R.R. #2, GREAT BEND, KANSAS
Character of Well (completed as Oil, Gas or Dry Hole)
Date well completed MAY 31 19 69
Application for plugging filed MAY 31 19 69
Application for plugging approved MAY 31 19 69
Plugging commenced MAY 31 19 69
Plugging completed MAY 31 19 69
Reason for abandonment of well or producing formation NO PRODUCIBLE ZONE

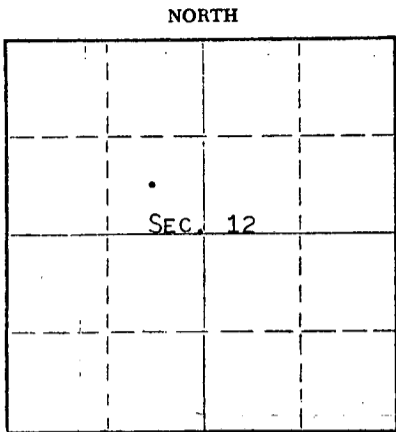

Locate well correctly on above
Section Plat

If a producing well is abandoned, date of last production NONE 19
Was permission obtained from the Conservation Division or its agents before plugging was com-
menced? YES

Name of Conservation Agent who supervised plugging of this well W. L. NICHOLS
Producing formation Depth to top Bottom Total Depth of Well 40 44 Feet
Show depth and thickness of all water, oil and gas formations.

OIL, GAS OR WATER RECORDS

CASING RECORD

FORMATION	CONTENT	FROM	TO	SIZE	PUT IN	PULLED OUT
				8-5/8"	214	NONE

Describe in detail the manner in which the well was plugged, indicating where the mud fluid was placed and the method or methods used in introducing it into the hole. If cement or other plugs were used, state the character of same and depth placed, from feet to feet for each plug set.

HEAVY MUD TO 1225', WOODEN PLUG, PLACED 85 SACKS CEMENT ON TOP OF PLUG.
HEAVY MUD TO 245', WOODEN PLUG, PLACED 10 SACKS CEMENT ON TOP OF PLUG.
HEAVY MUD TO 40', WOODEN PLUG, PLACED 5 SACKS CEMENT ON TOP OF PLUG TO
BASE OF WELL CELLAR.

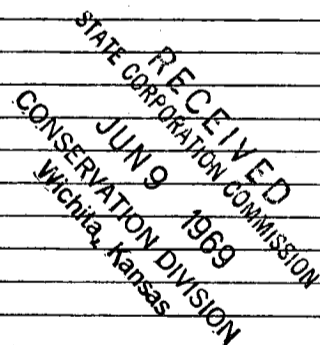

(If additional description is necessary, use BACK of this sheet)

Name of Plugging Contractor GARVEY DRILLING COMPANY
Address ROUTE #2, GREAT BEND, KANSAS

STATE OF KANSAS, COUNTY OF BARTON, ss.
MONTE CHADD (employee of owner) or (owner or operator) of the above-described

well, being first duly sworn, depose and say: That I have knowledge of the facts, statements, and matters herein contained and the log of the above-described well, and that the same are true and correct. So help me God. MONTE CHADD, DIST. PROD. SUPT.

(Signature) Monte Chadd
R.R. #2, GREAT BEND, KANSAS
(Address)

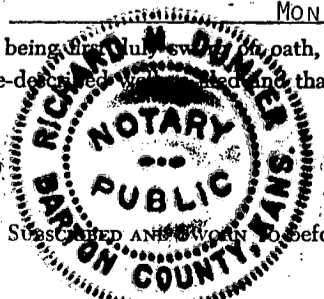

Subscribed and sworn to before me this 6 day of JUNE, 19 69

My commission expires MAY 28, 1973 Notary Public.

WELL LOG

COMPANY Petroleum, Inc.

SEC. 12 T. 10S. R. 25W

FARM Herman 'H'

NO. 1

LOC. C SE NW

TOTAL DEPTH 4044'

COUNTY Graham, Kansas

COMM. 5-24-69

COMP. 5-31-69

CONTRACTOR Garvey Drilling Company

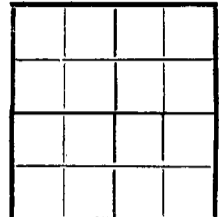

CASING

8 5/8" @ 214' w/165sx

ELEVATION 2503' KB

PRODUCTION D & A

FIGURES INDICATE BOTTOM OF FORMATIONS

- 214' Surface Soil & Shale
- 685' Shale
- 730' Anhydrite
- 1520' Shale & Sand
- 2137' Shale
- 2170' Anhydrite
- 2470' Shale
- 2690' Shale & Lime
- 3305' Lime & Shale
- 3966' Lime
- 3988' Lime & Shale
- 4044' Lime
- 4044' RTD

RECEIVED
 STATE CORPORATION COMMISSION
 JUN 9 1969
 CONSERVATION DIVISION
 Wichita, Kansas

State of Kansas }
 County of Barton } SS

I, Charlene Marker of Garvey Drilling Company

upon oath state the above and foregoing is a true and correct copy of the log of the Herman 'H' No. 1 well.

Charlene Marker

Subscribed and sworn to before me this 3rd day of June 1969

My Commission Expires: November 5, 1969

Richard S. Boy
 NOTARY PUBLIC