

STATE CORPORATION COMMISSION OF KANSAS
OIL & GAS CONSERVATION DIVISION
WELL COMPLETION OR RECOMPLETION FORM
ACO-1 WELL HISTORY
DESCRIPTION OF WELL AND LEASE

API NO. 15-.....065-22,471-00:00.....

County.....Graham.....

NW SE SW Sec. 36 Twp. 10 Rge. 24 East
..... West

990..... Ft North from Southeast Corner of Section
3630..... Ft West from Southeast Corner of Section
(Note: Locate well in section plat below)

Lease Name.....Ruder.....Well #.....1.....

Field Name.....

Producing Formation.....

Elevation: Ground.....2310.....KB.....2318.....

Operator: License # 5011
Name Viking Resources
Address 120 S. Market, Suite 518
Wichita, KS 67202-3819
City/State/Zip

Purchaser.....N/A.....

Operator Contact Person Jim Devlin
Phone (316) 262-2502

Contractor: License # 4958
Name Mallard JV, Inc.

Wellsite Geologist Don Strong
Phone

Designate Type of Completion
 New Well Re-Entry Workover

Oil SWD Temp Abd
 Gas Inj Delayed Comp.
 Dry Other (Core, Water Supply etc.)

If OWNED: old well info as follows:
Operator
Well Name
Comp. Date Old Total Depth

WELL HISTORY

Drilling Method:
 Mud Rotary Air Rotary Cable

7/6/88 Spud Date 7/12/88 Date Reached TD 7-12-88 Completion Date

3950 Total Depth PBD

Amount of Surface Pipe Set and Cemented at 227 feet
Multiple Stage Cementing Collar Used? Yes No
If yes, show depth set.....feet
If alternate 2 completion, cement circulated
from.....feet depth to.....w/.....SX cmt
Cement Company Name
Invoice #
ALT D DYA

RECEIVED
STATE CORPORATION COMMISSION
08-02-1988
AUG - 2 1988
CONSERVATION DIVISION
Wichita, Kansas

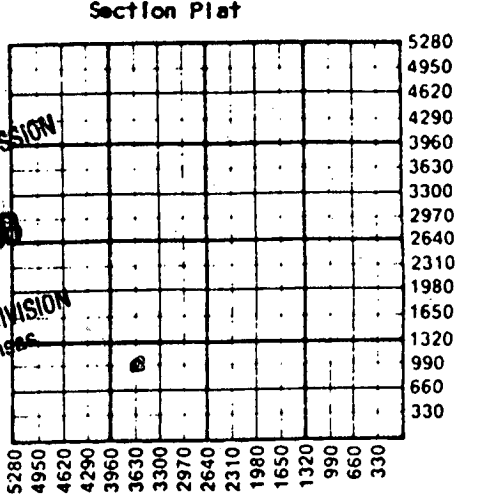

WATER SUPPLY INFORMATION
Disposition of Produced Water: Disposal
Docket # Repressuring

Questions on this portion of the ACO-1 call:
Water Resources Board (913) 296-3717
Source of Water:
Division of Water Resources Permit #.....
 Groundwater.....Ft North from Southeast Corner
(Well)Ft West from Southeast Corner of
Sec Twp Rge East West
 Surface Water 990 Ft North from Southeast Corner
(Stream, pond etc) 3780 Ft West from Southeast Corner
Sec 36 Twp 10 Rge 24 East West
 Other (explain).....
(purchased from city, R.W.O. #)

INSTRUCTIONS: This form shall be completed in triplicate and filed with the Kansas Corporation Commission, 200 Colorado Derby Building, Wichita, Kansas 67202, within 120 days of the spud date of any well. Rule 82-3-130, 82-3-107 and 82-3-106 apply. Information on side two of this form will be held confidential for a period of 12 months if requested in writing and submitted with the form. See rule 82-3-107 for confidentiality in excess of 12 months. One copy of all wireline logs and drillers time log shall be attached with this form. Submit CP-4 form with all plugged wells. Submit CP-111 form with all temporarily abandoned wells.

All requirements of the statutes, rules and regulations promulgated to regulate the oil and gas industry have been fully complied with and the statements herein are complete and correct to the best of my knowledge.

Signature James B. Devlin
Title Operator Date 7/15/88

Subscribed and sworn to before me this 15th day of July 1988
Notary Public Paula R. Dunagan
Date Commission Expires 2 March 1989

K.C.C. OFFICE USE ONLY
F Letter of Confidentiality Attached
C Wireline Log Received
C Drillers Time Log Received
Distribution
KCC SWD/Rep NGPA
KGS Plug Other (Specify)
8-2-88
Form ACO-1 (5-86)

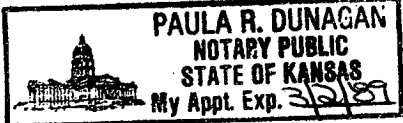

Operator Name Viking Resources Lease Name Ruder Well # 1

Sec. 36 Twp. 10 Rge. 24 East West County Graham

WELL LOG

INSTRUCTIONS: Show important tops and base of formations penetrated. Detail all cores. Report all drill stem tests giving interval tested, time tool open and closed, flowing and shut-in pressures, whether shut-in pressure reached static level, hydrostatic pressures, bottom hole temperature, fluid recovery, and flow rates if gas to surface during test. Attach extra sheet if more space is needed. Attach copy of log.

Drill Stem Tests Taken Yes No
 Samples Sent to Geological Survey Yes No
 Cores Taken Yes No

Formation Description
 Log Sample

DST #1, 3832-3874, 30-30-60-60, Rec. 5' oil, 30' OCM, 60' M, BHP: 513/360, FP: 65/69 76/87

| Name | Top | Bottom |
|--------------|--------------|--------|
| Anhydrite | 1924 (+394) | |
| B. Anhydrite | 1963 (-355) | |
| Heebner | 3645 (-1327) | |
| Toronto | 3667 (-1349) | |
| Lansing | 3680 (-1362) | |
| BKC | 3922 (-1604) | |
| RTD | 3950 (-1632) | |
| LTD | 3950 (-1632) | |

CASING RECORD New Used
 Report all strings set-conductor, surface, intermediate, production, etc.

| Purpose of String | Size Hole Drilled | Size Casing Set (in O.D.) | Weight Lbs/Ft. | Setting Depth | Type of Cement | #Sacks Used | Type and Percent Additives |
|-------------------|-------------------|---------------------------|----------------|---------------|----------------|-------------|----------------------------|
| Surface | 12 1/4 | 8-5/8 | 20 | 227 | 50/40 poz | 145 | 2% gel, 3% cc |

| Shots Per Foot | Specify Footage of Each Interval Perforated | Acid, Fracture, Shot, Cement Squeeze Record (Amount and Kind of Material Used) | Depth |
|----------------|---|--|-------|
| | | | |

TUBING RECORD Size Set At Packer at Liner Run Yes No

Date of First Production Producing Method Flowing Pumping Gas Lift Other (explain).....

| Estimated Production Per 24 Hours | Oil Bbls | Gas MCF | Water Bbls | Gas-Oil Ratio CFPB | Gravity |
|-----------------------------------|----------|---------|------------|--------------------|---------|
| | | | | | |

METHOD OF COMPLETION Production Interval

Disposition of gas: Vented Open Hole Perforation
 Sold Other (Specify)
 Used on Lease Dually Completed
 Commingled