

15-193-20095-00-00

STATE OF KANSAS
STATE CORPORATION COMMISSION

WELL PLUGGING RECORD

Give All Information Completely
Make Required Affidavit
Mail or Deliver Report to
Conservation Division
State Corporation Comm.
245 North Water
Wichita, KS 67202

Thomas County. Sec. 18 Twp. 10S Rge. 32 ~~W~~/W
Location as "NE/CNW $\frac{1}{4}$ /SW $\frac{1}{4}$ " or footage from lines
C NE SE

Lease Owner Cities Service Oil Co.
Lease Name FLIPSE "A" Well No. 1
Office Address 700 Sutton Place, 209 E. William, Wichita, Ks.
Character of Well (Completed as Oil, Gas or Dry Hole)
Dry Hole

Date Well completed October 26 1976
Application for plugging filed (Verbally) October 26 1976
Application for plugging approved (Verbally) October 26 1976
Plugging commenced October 26 1976
Plugging completed October 26 1976
Reason for abandonment of well or producing formation
No commercial quantity of oil or gas encountered
If a producing well is abandoned, date of last production
19

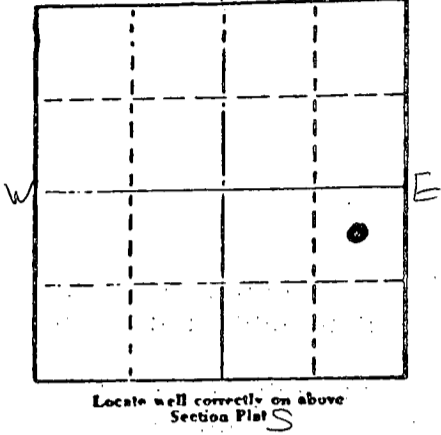

Was permission obtained from the Conservation Division or its agents before plugging was commenced? Yes

Name of Conservation Agent who supervised plugging of this well Gilbert Balthazor
Producing formation _____ Depth to top _____ Bottom _____ Total Depth of Well _____
Show depth and thickness of all water, oil and gas formations.

OIL, GAS OR WATER RECORDS

CASING RECORD

FORMATION	CONTENT	FROM	TO	DATE	PUT IN	PULLED OUT

Describe in detail the manner in which the well was plugged, indicating where the mud fluid was placed and the method or methods used in introducing it into the hold. If cement or other plugs were used, state the character of same and depth placed, from _____ feet to _____ feet for each plug set.

1st plug set at 1500' with 70 sx.
2nd plug set at 350' with 20 sx.
3rd plug set at 40' with 10 sx.

Plug was down at 10:15 a.m. 10-26-76
State Plugger - Gilbert Balthazor.

RECEIVED
STATE CORPORATION COMMISSION

NOV 03 1976
11-03-1976
CONSERVATION DIVISION
WICHITA, KANSAS

(If additional description is necessary, use BACK of this sheet)

Name of Plugging Contractor Abercrombie Drilling, Inc.

STATE OF Kansas COUNTY OF Sedgwick ss:
Jack L. Partridge, Asst. Sec.-Treas. (employee of owner) or (owner or operator) of the above-described well, being first duly sworn on oath, says: That I have knowledge of the facts, statements, and matters herein contained and the log of the above-described well as filed and that the same are true and correct. So help me God.

(Signature) Jack L. Partridge
801 Union Center, Wichita, Kansas 67202
(Address)

SUBSCRIBED AND SWORN TO before me this 29th day of October 1976

My commission expires _____
Kathy S. Goertz
Kathy S. Goertz Notary Public.



15-193-20095-00-00

CONTRACTOR'S WELL LOG

OPERATOR: Cities Service Oil Co.
 CONTRACTOR: Abercrombie Drilling, Inc.
 WELL NAME: FLIPSE "A" #1
 LOCATION: C NE SE, Sec. 18-10S-32W
 Thomas County, Kansas
 SPUD DATE: October 12, 1976
 COMPLETION DATE: October 26, 1976

0	445	Top Soil & Sand
445	1115	Sand & Shells
1115	1700	Sand & Shale
1700	1755	Sand
1755	2640	Sand & Shale
2640	3333	Shale & Lime
3333	3525	Lime & Shale
3525	3645	Shale & Lime
3645	3990	Lime & Shale
3990	4058	Lime
4058	4095	Shale & Lime
4095	4199	Lime
4199	4205	Shale & Lime
4205	4272	Lime
4272	4285	Shale & Lime
4285	4334	Lime
4334	4595	Shale & Lime
4595	4625	Lime
4625	4698	Shale & Lime
4698	4710	Lime
	4710	Rotary Total Depth

Spudded at 11:45 a.m. 10-12-76. Drilled 445' of 12 1/4" hole. Ran 11 jts. of 8 5/8" - 24# casing. (Tally 429.68') Set at 437.67' with 325 sx. common cement, 2% Ca. Cl. Plug was down at 1:15 p.m. Cement circulated.

T.D. 4698', set 1st plug at 1500' with 70 sx., 2nd plug at 350' with 20 sx., 3rd plug at 40' with 10 sx. Plug was down at 10:15 a.m. 10-26-76. State Plugger - Gilbert Balthazor.

SAMPLE TOPS:

Anhydrite 2598'
 B/Anhydrite 2634'

NOV 03 1976
 11-03-1976
 RECEIVED
 STATE OF KANSAS
 CONSERVATION DEPARTMENT
 DIVISION OF OIL & GAS

STATE OF KANSAS .)
) SS
 COUNTY OF SEDGWICK)

Jack L. Partridge, Assistant Secretary-Treasurer of Abercrombie Drilling, Inc., does hereby state that the above and foregoing is a true and correct copy of the log of the FLIPSE "A" #1, C NE SE, Section 18-10S-32W, Thomas County, Kansas.

ABERCROMBIE DRILLING, INC.

BY: Jack L. Partridge
 Jack L. Partridge, Assistant Sec.-Treas.

Subscribed and sworn to before me, a Notary Public, in and for the aforesaid county and state as of this 29th day of October, 1976.



Kathy S. Goertz
 Kathy S. Goertz, Notary Public