

EFFECTIVE DATE: 4-7-91

FORM MUST BE TYPED  
FORM C-1 4/90

State of Kansas  
NOTICE OF INTENTION TO DRILL

FORM MUST BE SIGNED  
ALL BLANKS MUST BE FILLED

Must be approved by the K.C.C. five (5) days prior to commencing well

Expected Spud Date April 15, 1991  
month day year

NE NE SW Sec 6 Twp 10 S, Rg 31 XX East West ✓

OPERATOR: License # 30269  
Name: Argent Energy, Inc.  
Address: 110 South Main, Suite 510  
City/State/Zip: Wichita, KS 67202-3745  
Contact Person: James C. Remsberg  
Phone: 316/262-5111

2310 feet from South line of Section  
2970 feet from East line of Section  
(Note: Locate well on Section Plat on Reverse Side)

CONTRACTOR: License #: 5422  
Name: Abercrombie Drilling

County: Thomas  
Lease Name: Wiens "A" Well #: 1  
Field Name: unnamed

Well Drilled For: Well Class: Type Equipment:  
 Oil ... Inj ... Infield   Mud Rotary  
... Gas ... Storage ... Pool Ext. ... Air Rotary  
... OWWO ... Disposal  Wildcat ... Cable  
... Seismic; ... # of Holes

Is this a Prorated Field? ... yes  no  
Target Formation(s): Mississippian  
Nearest lease or unit boundary: 330'  
Ground Surface Elevation: 3065' est. feet MSL ✓  
Domestic well within 330 feet: ... yes  no  
Municipal well within one mile: ... yes  no  
Depth to bottom of fresh water: 230  
Depth to bottom of usable water: 1825  
Surface Pipe by Alternate: ... 1  2  
Length of Surface Pipe Planned to be set: 275  
Length of Conductor pipe required: none  
Projected Total Depth: 4700  
Formation at Total Depth: Mississippian  
Water Source for Drilling Operations:  
... well ... farm pond  other ✓  
DWR Permit #: \_\_\_\_\_  
Will Cores Be Taken?: ... yes  no ✓  
If yes, proposed zone: \_\_\_\_\_

If OWWO: old well information as follows:  
Operator: \_\_\_\_\_  
Well Name: \_\_\_\_\_  
Comp. Date: \_\_\_\_\_ Old Total Depth \_\_\_\_\_

Directional, Deviated or Horizontal wellbore? ... yes  no  
If yes, total depth location: \_\_\_\_\_

**AFFIDAVIT**

The undersigned hereby affirms that the drilling, completion and eventual plugging of this well will comply with K.S.A. 55-101, et. seq.

It is agreed that the following minimum requirements will be met:

1. The appropriate district office shall be notified before setting surface pipe;
2. The minimum amount of surface pipe as specified above shall be set by circulating cement to the top; in all cases surface pipe shall be set through all unconsolidated materials plus a minimum of 20 feet into the underlying formation;
3. If the well is dry, a plugging proposal shall be submitted to the district office. An agreement between the operator and the district office on plug length and placement is necessary prior to plugging;
4. The appropriate district office will be notified before well is either plugged or production casing is cemented in;
5. If an Alternate II completion, production pipe shall be cemented from below any usable water to surface within 120 days of spud date. In all cases, notify district office prior to any cementing.

I hereby certify that the statements made herein are true and to the best of my knowledge and belief.

Date: April 1, 1991 Signature of Operator or Agent: James C. Remsberg Title: President  
James C. Remsberg

RECEIVED  
STATE CORPORATION COMMISSION

APR 02 1991  
04-02-1991  
CONSERVATION DIVISION  
Wichita, Kansas

FOR KCC USE:

API # 15- 193-20,553-00-00

Conductor pipe required None feet

Minimum surface pipe required 275 feet per Alt. • (2)

Approved by: mhw 4-2-91

EFFECTIVE DATE: 4-7-91

This authorization expires: 10-2-91

(This authorization void if drilling not started within 6 months of effective date.)

Spud date: \_\_\_\_\_ Agent: \_\_\_\_\_

REMEMBER TO:

- File Drill Pit Application (form CDP-1) with Intent to Drill;
- File Completion Form ACO-1 within 120 days of spud date;
- File acreage attribution plat according to field proration orders;
- Notify appropriate district office 48 hours prior to workover or re-entry;
- Submit plugging report (CP-4) after plugging is completed;
- Obtain written approval before disposing or injecting salt water.

6  
10  
31W

**PLAT OF ACREAGE ATTRIBUTABLE TO A WELL**

State Corporation Commission, Conservation Division  
200 Colorado Derby Bldg. Wichita, Kansas 67202

OPERATOR Argent Energy, Inc. LOCATION OF WELL:  
 LEASE Wiens "A" 2310 feet north of SE corner  
 WELL NUMBER 1 2970 feet west of SE corner  
 FIELD unnamed SW/4 Sec. 6 T 10S R 31 ~~X~~X  
 COUNTY Thomas  
 NO. OF ACRES ATTRIBUTABLE TO WELL 10 IS SECTION XX REGULAR     IRREGULAR?  
 DESCRIPTION OF ACREAGE NE-NE-SW IF IRREGULAR, LOCATE WELL FROM NEAREST  
 CORNER BOUNDARY.

NOTE: If plat depicted is insufficient for your circumstances, you may attach your own scaled or surveyed plat.

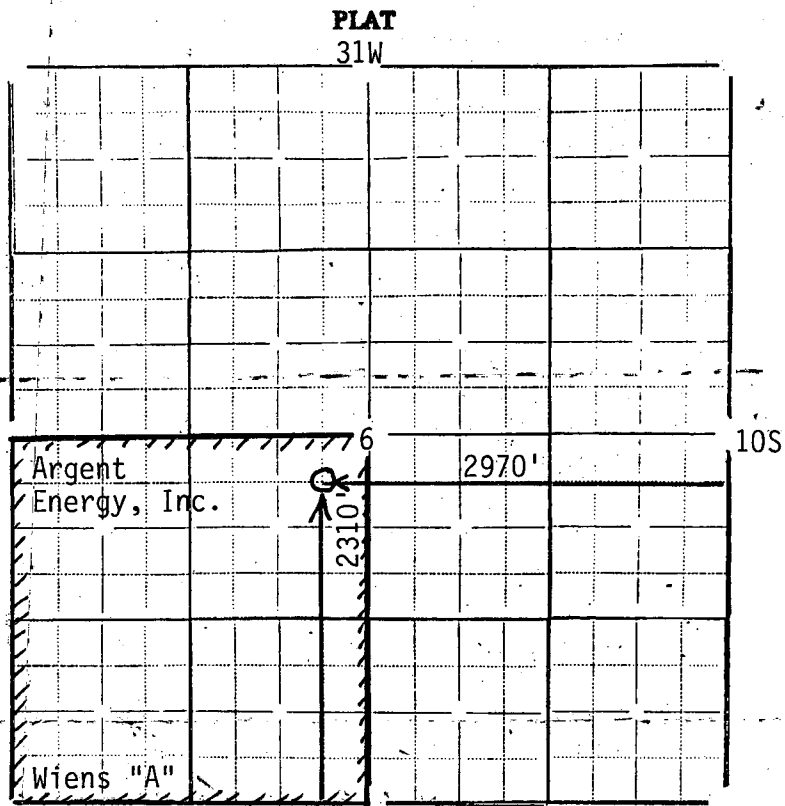

In plotting the proposed location of the well, you must show:

- 1) The manner in which you are using the depicted plat by identifying section lines, i.e. 1 section, 1 section with 8 surrounding partial sections, 4 sections, 16 sections, etc.;
- 2) the well's location relative to the location of other wells producing from the same common source of supply in adjoining drilling units, pursuant to K.A.R. 82-3-108, 82-3-207, 82-3-312, or special orders of the Commission;
- 3) the distance of the proposed drilling location from the section's east and south lines; and
- 4) the distance to the nearest lease or unit boundary line.

I hereby certify that the statements made herein are true and to the best of my knowledge and belief.

Signature of Operator or Agent James C. Remsberg  
 Date April 1, 1991 Title President