

STATE CORPORATION COMMISSION OF KANSAS  
OIL & GAS CONSERVATION DIVISION  
WELL COMPLETION OR RECOMPLETION FORM  
ACO-1 WELL HISTORY  
DESCRIPTION OF WELL AND LEASE

S.C

API NO. 15-.....179-20.897-00-00.....  
County.....Sheridan.....  
.....NW.....SE.....Sec. 8.....Twp. 10S.....Rge. 30W.....X East West

Operator: License # .....5140.....  
Name ..Frontier Oil Company.....  
Address ..125 N. Market, Ste. 1720.....  
.....Wichita, Kansas.. 67202.....  
City/State/Zip .....

.....1980+ North from Southeast Corner of Section  
.....1980+ West from Southeast Corner of Section  
(Note: Locate well in section plat below)

Purchaser...N/A.....

Lease Name...Schroeder.....Well #.....1.....

Operator Contact Person ....Jean Angle.....  
Phone ..316-263-1201.....

Field Name.....WC.....

Producing Formation...N/A.....

Contractor: License # ....5302.....  
Name ..Red Tiger Drilling Co.....

Elevation: Ground.....2943.....KB.....2948.....

Wellsite Geologist...Richard D. Parker.....  
Phone..913-483-5348.....

Designate Type of Completion  
 New Well  Re-Entry  Workover  
  
 Oil  SWD  Temp Abd  
 Gas  Inj  Delayed Comp.  
 Dry  Other (Core, Water Supply etc.)

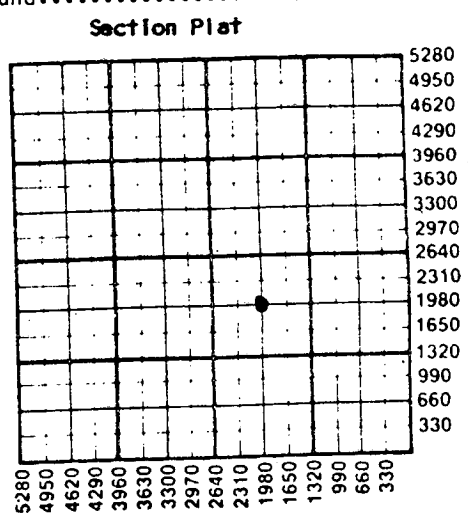

If **OWWO**: old well info as follows:  
Operator ..  
Well Name ..  
Comp. Date .....Old Total Depth.....

WATER SUPPLY INFORMATION

Disposition of Produced Water:  Disposal  
Docket # .....  Repressuring

WELL HISTORY

Drilling Method:  
 Mud Rotary  Air Rotary  Cable

6-7-87..... 6-18-87..... 6-19-87.....  
Spud Date Date Reached TD Completion Date  
4405..... N/A.....  
Total Depth PBDT

Amount of Surface Pipe Set and Cemented at.....249.....feet  
Multiple Stage Cementing Collar Used?  Yes  No  
If yes, show depth set.....feet  
If alternate 2 completion, cement circulated  
from.....feet depth to.....w/.....SX cmt  
Cement Company Name ..  
Invoice # ..

Questions on this portion of the ACO-1 call:  
Water Resources Board (913) 296-3717  
Source of Water:  
Division of Water Resources Permit #.....N/A.....  
Raymond Schroeder & Donald Schroeder  
Grinnell, Kansas 67738  
 Groundwater.....800.....Ft North from Southeast Corner  
(Well) .....600.....Ft West from Southeast Corner of  
Sec 8 Twp 10S Rge 30W ~~XXX~~ East  West  
  
 Surface Water.....Ft North from Southeast Corner  
(Stream, pond etc).....Ft West from Southeast Corner  
Sec Twp Rge East West  
  
 Other (explain).....  
(purchased from city, R.W.D. #)

INSTRUCTIONS: This form shall be completed in triplicate and filed with the Kansas Corporation Commission, 200 Colorado Derby Building, Wichita, Kansas. 67202, within 120 days of the spud date of any well. Rule 82-3-130, 82-3-107 and 82-3-106 apply.  
Information on side two of this form will be held confidential for a period of 12 months if requested in writing and submitted with the form. See rule 82-3-107 for confidentiality in excess of 12 months.  
One copy of all wireline logs and drillers time log shall be attached with this form. Submit CP-4 form with all plugged wells. Submit CP-111 form with all temporarily abandoned wells.

All requirements of the statutes, rules and regulations promulgated to regulate the oil and gas industry have been fully complied with and the statements herein are complete and correct to the best of my knowledge.

Signature *Jean Angle*.....  
Title.....Agent..... Date July 6, 1987

K.C.C. OFFICE USE ONLY  
 Letter of Confidentiality Attached  
 Wireline Log Received  
 Drillers Timelog Received  
Distribution  
 KCC  SWD/Rep  NGPA  
 KGS  Plug  Other  
STATE CORPORATION COMMISSION  
RECEIVED  
JUL 7 1987  
Form ACO-1 (5-86)  
CONSERVATION DIVISION  
WICHITA, KANSAS

Subscribed and sworn to before me this 6th day of July 19.....  
Notary Public.....  
Date Commission Expires.....2-10-90.....

Sec. 8, Twp. 10, Rge. 30W

Operator Name Frontier Oil Company Lease Name Schroeder Well # 1

Sec 8 Twp 10S Rge 30W East West County Sheridan

CONFIDENTIAL

WELL LOG

INSTRUCTIONS: Show important tops and base of formations penetrated. Detail all cores. Report all drill stem tests giving interval tested, time tool open and closed, flowing and shut-in pressures, whether shut-in pressure reached static level, hydrostatic pressures, bottom hole temperature, fluid recovery, and flow rates if gas to surface during test. Attach extra sheet if more space is needed. Attach copy of log.

Drill Stem Tests Taken [X] Yes [ ] No
Samples Sent to Geological Survey [X] Yes [ ] No
Cores Taken [X] Yes [ ] No

Formation Description [ ] Log [X] Sample

DST #1 3586-3666 60-30-60-30 1st op - wk blo inc. to fair blo 2nd op - wk blo Rec. 295' MW. IF 74-104 FF 111-147 ISIP 1059 FSIP 1025

DST #2 3846-3908 30-30-30-30. Wk blo TO. Rec. 425' WM IF 62-136 FF 168-226 ISIP 1170 FSIP 1145

DST #3 3938-3993 30-30-30-30. wk blo TO. Rec. 70' WM w/scum of oil on top. IF 56-61 FF 70-70 ISIP 1179 FSIP 1119

DST #4 4012-4040 30-30-30-30. 1st op - wk blo for 10". 2nd op - no blo. Rec. 1' M IF 27-27 FF 27-27 ISIP 168 FSIP 173

DST #5 4038-4046 60-30-60-30. 1st op - fair inc to strong blo. 2nd op - fair inc to strong blo. Rec. 180' MW w/scum of oil on top, 900' MW IF 38-285 FF 296-474 ISIP 1201 FSIP 1182

DST #6 4078-4089 60-30-60-30. 1st op - wk inc to fair blo. 2nd op - wk inc to fair blo.

Table with 3 columns: Name, Top, and values. Rows include Anhydrite, Tarkio, Howard, Topeka, Heebner, Toronto, Lansing-Kansas City, Base of Kansas City, Pawnee, and RTD.

RELEASED

AUG 16 1988

FROM CONFIDENTIAL

Form sections: CASING RECORD, PERFORATION RECORD, TUBING RECORD, Date of First Production, Producing Method, Estimated Production Per 24 Hours.

METHOD OF COMPLETION

Production Interval

Disposition of gas: [ ] Vented [ ] Sold [ ] Used on Lease [ ] Open Hole [ ] Perforation [ ] Other (Specify) [ ] Dually Completed [ ] Commingled

**CONFIDENTIAL**

SIDE TWO (Page Two)

ACO-1 WELL HISTORY

OPERATOR Frontier Oil Company LEASE NAME Schroeder \* 1 SEC. 8 TWP. 10S RGE. 30W

**FILL IN WELL LOG AS REQUIRED:**

Show all important zones of porosity and contents thereof; cored intervals, and all drill-stem tests, including depth interval tested, cushion used, time tool open, flowing and shut-in pressures, and recoveries.

SHOW GEOLOGICAL MARKERS, LOGS RUN, OR OTHER DESCRIPTIVE INFORMATION.

FORMATION DESCRIPTION, CONTENTS, ETC.	TOP	BOTTOM	NAME	DEPTH
DST #6 4078-4089 (Continued) Rec. 370' MW IF29-107 FF 125-182 ISIP 1274 FSIP 1260				
DST #7 4134-4155 30-30-30-30. 1st op - wk blo 2nd op - no blo. Rec. 1' M. IF 22-22 FF 34-34 ISIP 1283 FSIP 1214				
DST #8 4152-4240 30-30-30-30. 1st op - wk to no blo in 20". 2nd op - no blo Rec. 30' Oil spotted M. IF & FF 22-22 ISIP 57 FSIP 34				
DST #9 4360-4400 30-30-30-30. 1st op - wk blo to no blo in 12". 2nd op - no blo Rec. 1' oil spotted M IF & FF 34-34 ISIP 45 FSIP 34				

FROM CONFIDENTIAL

AUG 16 1988

RELEASED

KANSAS GEOLOGICAL SURVEY  
WICHITA BRANCH

JUL 08 1987

RECEIVED  
STATE CORPORATION COMMISSION

JUL 7 1987

CONSERVATION DIVISION  
Wichita, Kansas