

STATE CORPORATION COMMISSION OF KANSAS
OIL & GAS CONSERVATION DIVISION
WELL COMPLETION OR RECOMPLETION FORM
ACO-1 WELL HISTORY
DESCRIPTION OF WELL AND LEASE

API NO. 15-179-20,847-00-00
County SHERIDAN
C. S/2 NE Sec 31. Twp. 10. Rge 30 West

Operator: License # 8318
Name CARROLL OIL PRODUCTION INC.
Address Box 1987
City/State/Zip GREAT BEND, KS 67530

3300 Ft North from Southeast Corner of Section
1300 Ft West from Southeast Corner of Section
(Note: Locate well in section plat below)

Purchaser

Lease Name BECKMAN Well # 1

Operator Contact Person JON M. CARROLL
Phone 316-793-7156

Field Name UNKNOWN

Producing Formation NONE

Contractor: License # 6033
Name MURFIN DRILLING CO.

Elevation: Ground 2973 KB 2978

Wellsite Geologist JIM MUSE ROVE
Phone 316-792-8251

Designate Type of Completion
 New Well Re-Entry Workover
 Oil SWD Temp Abd
 Gas Inj Delayed Comp.
 Dry Well Other (Core, Water Supply etc.)
If ONWO: old well Info as follows:
Operator
Well Name
Comp. Date Old Total Depth

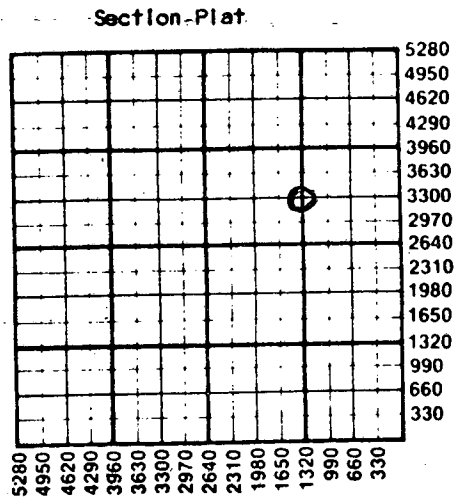

Section-Plat
WATER SUPPLY INFORMATION
Disposition of Produced Water: Disposal Repressuring
Docket #

WELL HISTORY
Drilling Method: Mud Rotary Air Rotary Cable
10-13-85 10-19-85 10-19-85
Spud Date Date Reached TD Completion Date
4650'
Total Depth PBTD
Amount of Surface Pipe Set and Cemented at 302 feet
Multiple Stage Cementing Collar Used? Yes No
If yes, show depth set...feet
If alternate 2 completion, cement circulated from 302 feet depth to SURFACE 250 SX cmt
Cement Company Name B.J. TITAN
Invoice # 221260

Questions on this portion of the ACO-1 call:
Water Resources Board (913) 296-3717
Source of Water:
Division of Water Resources Permit #
Groundwater...Ft North from Southeast Corner (Well) ...Ft West from Southeast Corner of Sec Twp Rge East West
Surface Water...Ft North from Southeast Corner (Stream, pond etc)...Ft West from Southeast Corner Sec Twp Rge East West
 Other (explain) Landowner
(purchased from city, R.W.D. #)

INSTRUCTIONS: This form shall be completed in duplicate and filed with the Kansas Corporation Commission, 200 Colorado Derby Building, Wichita, Kansas 67202, within 90 days after completion or recompletion of any well. Rule 82-3-130 and 82-3-107 apply.
Information on side two of this form will be held confidential for a period of 12 months if requested in writing and submitted with the form. See rule 82-3-107 for confidentiality in excess of 12 months.
One copy of all wireline logs and drillers time log shall be attached with this form. Submit CP-4 form with all plugged wells. Submit CP-111 form with all temporarily abandoned wells.

All requirements of the statutes, rules and regulations promulgated to regulate the oil and gas industry have been fully complied with and the statements herein are complete and correct to the best of my knowledge.

Signature Jon M. Carroll
Title President Date 1-28-86
Subscribed and sworn to before me this 28th day of January 1986
Notary Public Helen R. Cheely
Date Commission Expires August 01, 1987

K.C.C. OFFICE USE ONLY
F Letter of Confidentiality Attached
C Wireline Log Received
C Drillers Timelog Received
Distribution
 KCC SWD/Rep NGPA
 KGS Plug Other
(Specify)



Sec 31 Twp 10 Rge 30W

SIDE TWO

Operator Name CARROLL OIL Production INC. Lease Name BECKMAN Well # 1

Sec. 31 Twp. 10 Rge. 30 East West County Sheridan

WELL LOG

INSTRUCTIONS: Show important tops and base of formations penetrated. Detail all cores. Report all drill stem tests giving interval tested, time tool open and closed, flowing and shut-in pressures, whether shut-in pressure reached static level, hydrostatic pressures, bottom hole temperature, fluid recovery, and flow rates if gas to surface during test. Attach extra sheet if more space is needed. Attach copy of log.

Drill Stem Tests Taken Yes No
Samples Sent to Geological Survey Yes No
Cores Taken Yes No

Formation Description
 Log Sample

Name	Top	Bottom
ANhydrite	2535	
TOPEKA	3769	
HECBER	3994	
TORONTO	4014	
LANSING	4033	
BASE KC	4366	
MARIMATON	4360	
PAWNEE	4441	
FT SCOTT	4512	
CHEROKEE SHALE	4540	
CHEROKEE SAND	4613	
TD Log	4649	
RTO	4650	

CASING RECORD <input checked="" type="checkbox"/> New <input type="checkbox"/> Used							
Report all strings set-conductor, surface, intermediate, production, etc.							
Purpose of String	Size Hole Drilled	Size Casing Set (in O.D.)	Weight Lbs/Ft.	Setting Depth	Type of Cement	#Sacks Used	Type and Percent Additives
..SURFACE..	..12 1/4..	..8 5/8..	..20..	..392..	..60/40BZ..	..250..	..370.56..
.....
.....

PERFORATION RECORD		Acid, Fracture, Shot, Cement Squeeze Record (Amount and Kind of Material Used)	
Shots Per Foot	Specify Footage of Each Interval Perforated		Depth
.....
.....
.....
.....

TUBING RECORD	Size	Set At	Packer at	Liner Run <input type="checkbox"/> Yes <input type="checkbox"/> No
.....

Date of First Production	Producing Method
.....	<input type="checkbox"/> Flowing <input type="checkbox"/> Pumping <input type="checkbox"/> Gas Lift <input type="checkbox"/> Other (explain).....

Estimated Production Per 24 Hours	Oil	Gas	Water	Gas-Oil Ratio	Gravity
	Bbls	MCF	Bbls	CFPB	
.....

METHOD OF COMPLETION

Production Interval

Disposition of gas: Vented Sold Used on Lease Open Hole Other (Specify)..... Perforation Dually Completed Conmingled

RECEIVED STATE CORPORATION COMMISSION JAN 30 1986 CONSERVATION DIVISION Wichita, Kansas