

KANSAS CORPORATION COMMISSION
OIL & GAS CONSERVATION DIVISION
WELL PLUGGING APPLICATION
Please TYPE Form and File ONE Copy

Form CP-1
September 2003
This Form must be Typed
Form must be Signed
All blanks must be Filled

API # 15 - 163-22742-0001 (Identifier Number of this well). This must be listed for wells drilled since 1967; if no API # was issued,

indicate original spud or completion date Spud July 19, 1991

Well Operator: Bowman Oil Company (Owner / Company Name) KCC License #: 6931 (Operator's)

Address: 805 Codell Road City: Codell

State: Kansas Zip Code: 67663 Contact Phone: (785) 434 - 2286 M-F

Lease: Sutor D Well #: 1 Sec. 24 Twp. 10S S. R. 20 East West

- NW - SE - SW Spot Location / QQQQ County: Rooks County, Kansas

990 Feet (in exact footage) From North / South (from nearest outside section corner) Line of Section (Not Lease Line)

3630 Feet (in exact footage) From East / West (from nearest outside section corner) Line of Section (Not Lease Line)

Check One: Oil Well Gas Well D&A Cathodic Water Supply Well
 SWD Docket # _____ ENHR Docket # _____ Other: _____

Conductor Casing Size: N/A Set at: N/A Cemented with: N/A Sacks

Surface Casing Size: 8 5/8" Set at: 305' Cemented with: 215 sxs Sacks

Production Casing Size: 4 1/2" Set at: 3693' Cemented with: 150 sxs Sacks

List (ALL) Perforations and Bridgeplug Sets: Perforations 3542' to 3546' Plug set @3680' - Wireline Plug

Elevation: 2128' (G.L. / K.B.) T.D.: 3696' PBTD: 3690' Anhydrite Depth: 1553'
(Stone Corral Formation)

Condition of Well: Good Poor Casing Leak Junk in Hole

Proposed Method of Plugging (attach a separate page if additional space is needed): Will Cement to Plug Well According to Kansas Corporation

Commission - District #4's, Hays, Kansas, Instructions.

RECEIVED
KANSAS CORPORATION COMMISSION

Is Well Log attached to this application as required? Yes No Is ACO-1 filed? Yes No

NOV 03 2008

If not explain why? _____ CONSERVATION DIVISION
WICHITA, KS

Plugging of this Well will be done in accordance with K.S.A. 55-101 et. seq. and the Rules and Regulations of the State Corporation Commission.

List Name of Company Representative authorized to be in charge of plugging operations: Louis "Don" Bowman or William "Bill" Bowman

Phone: (785) 434 - 2286 M-F

Address: 805 Codell Road City / State: Codell, Kansas 67663

Plugging Contractor: Allied Cementing Company, Inc. KCC License #: 99996 PKTKCC
(Company Name) (Contractor's)

Address: 24 S. Lincoln Russell, Kansas 67665 Phone: (785) 483 - 2627

Proposed Date and Hour of Plugging (if known?): November 5, 2008

Payment of the Plugging Fee (K.A.R. 82-3-118) will be guaranteed by Operator or Agent

Date: October 31, 2008 Authorized Operator (Agent) Connie J. Austin
(Signature)

Mail to: KCC - Conservation Division, 130 S. Market - Room 2078, Wichita, Kansas 67202

Dusty
PKT

*Corrected ACO-1
24-10-20W
nd. 81

STATE CORPORATION COMMISSION OF KANSAS
OIL & GAS CONSERVATION DIVISION

WELL COMPLETION OR RECOMPLETION FORM
ACO-1 WELL HISTORY

DESCRIPTION OF WELL AND LEASE

Operator: License # 5020
Name Rine Exploration Company
Address Suite #645
300 W. Douglas
City/State/Zip Wichita, KS 67202

* Purchaser ~~AT&T~~ Mobil Oil
K.C. K.C.

Operator Contact Person M. Bradford Rine
Phone 316/262-5418

Contractor: License # 5422
Name Abercrombie Drilling, Inc.

Well site Geologist Steve Kriedler
Phone 316/265-5370

Designate Type of Completion
 New Well Re-Entry Workover
 Oil SWD Temp Other (Core, Water Supply, etc.)
 Gas Inj Other (Core, Water Supply, etc.)
 Dry Other (Core, Water Supply, etc.)

If OWN: old well info as follows:
Operator
Well Name
Comp. Date
Old Total Depth

WELL HISTORY

Drilling Method:
 Mud Rotary Air Rotary Cable

08/27/85 09/02/85 09/03/85
Spud Date Date Reached TD Completion Date
3696' 3690'
Total Depth PBD

Amount of Surface Pipe Set and Cemented at 305' feet
Multiple Stage Cementing Collar Used? Yes No
If yes, show depth set... feet
If alternate 2 completion, cement circulated
from... feet depth to... w/... SX amt

API NO. 15-163-22-742
County Rooks
NW 1/4 SE 1/4 SW 1/4 Sec. 24 Twp. 10S Rge. 20W West

990 Ft North from Southeast Corner of Section
3630 Ft West from Southeast Corner of Section
(Note: Locate well in section plat below)

Lease Name Sutor Well # 1-24

Field Name Marcotte

Producing Formation Arbuckle

Elevation: Ground 2128' KB 2133'
Section Plat

NOV 07 1985
State Geological Survey
WICHITA BRANCH

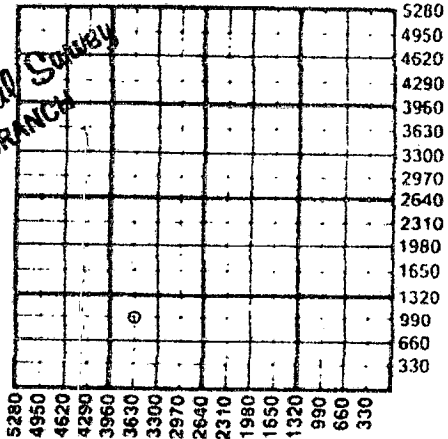

WATER SUPPLY INFORMATION

Disposition of Produced Water: Disposal
Docket # Repressuring

Questions on this portion of the ACO-1 call:
Water Resources Board (913) 296-3717

Source of Water:
Division of Water Resources Permit #

Groundwater... Ft North from Southeast Corner (Well) ... Ft West from Southeast Corner of Sec Twp Rge East West

Surface Water... 850 Ft North from Southeast Corner (Stream, pond etc) 3630 Ft West from Southeast Corner Sec 24 Twp 10S Rge 20 East West

Other (explain) (purchased from city, R.W.D. #)

INSTRUCTIONS: This form shall be completed in duplicate and filed with the Kansas Corporation Commission, 200 Colorado Derby Building, Wichita, Kansas 67202, within 90 days after completion or recompletion of any well. Rule 82-3-130 and 82-3-107 apply.
Information on side two of this form will be held confidential for a period of 12 months if requested in writing and submitted with the form. See rule 82-3-107 for confidentiality in excess of 12 months.
One copy of all wireline logs and drillers time log shall be attached with this form. Submit CP-4 form with plugged wells. Submit CP-111 form with all temporarily abandoned wells.

75635

SIDE TWO

Operator Name RINE EXPLORATION COMPANY Lease Name Sutor Well # 1-24

24 10 South 20 West ^{XX West} _{51 West} County Rooks

Date of First Production Approx. Oct. 15, 1985 Producing Method Flowing Pumping Gas Lift Other (explain).....

Estimated Production Per 24 Hours	Oil 50 Bbls	Gas -0- MCF	Water Trace Bbls	Gas-Oil Ratio CFPB	Gravity
-----------------------------------	----------------	----------------	---------------------	-----------------------	---------

Drill Stem Tests Taken Yes No
 Samples Sent to Geological Survey Yes No
 Cores Taken Yes No

Formation Description
 Log Sample

DST #1 / 3160'-3206' (Topeka) 30-45-45-60. Weak blow, rec. 120' watery cut mud with slight show of oil.
 IFP 21 - 21 ISIP 690
 FFP 32 - 32 FSIP 679

DST #2 / 3527'-3657' (KC-Marm.) 30-30-30-30. Weak blow died in 20 min., rec. 10' mud.
 IFP 32 - 32 ISIP 345
 FFP 43 - 43 FSIP 226

DST #3 / 3636'-3696' (Arbuckle) 30-60-30-60. Strong blow, rec. 154' oil cut mud, 124' heavy oil and gas cut mud - 65% oil, 434' gassy oil.
 IFP 86 - 216 ISIP 1055
 FFP 280 - 313 FSIP 1012

Name	Top	Bottom
<u>SAMPLE TOPS</u>		
Anhydrite	1553	+ 580
Base Anhydrite	1586	+ 547
Topeka	3143	-1010
Heebner	3352	-1219
Lansing	3390	-1257
Base Kansas City	3597	-1464
Arbuckle	3692	-1559
RTD	3696	-1563
<u>E-LOG TOPS</u>		
Anhydrite	1551	+ 582
Base Anhydrite	1589	+ 544
Topeka	3143	-1010
Heebner	3351	-1218
Lansing	3389	-1256
Base Kansas City	3597	-1464
Arbuckle	Not on Log	
LTD	3696	-1563

METHOD OF COMPLETION

Open Hole Perfora
 Other (Specify)

State Geological Survey
MONTA BRANCH
1985

CASING RECORD New Used
 Report all strings set conductor, surface, intermediate, production, etc.

Purpose of String	Size Hole Drilled	Size Casing Set (in O.D.)	Weight Lbs/Ft.	Setting Depth	Type of Cement	#Sacks Used	Type and Percent Additives
Surface	12 1/4"	8 5/8"	24#	305.50'	Common	215	2% gel/3% cc
Production	7 7/8"	4 1/2"	10 1/2#	3693.50'	Mud Flush	10#	
				50-50 pop	150 10%	Salt,	75% CFR2

PERFORATION RECORD Acid, Fracture, Shot, Cement Squeeze Record
 Shots Per Foot Specify Footage of Each Interval Perforated (Amount and Kind of Material Used) Depth

Two	At 1554' and squeeze-cemented off the Dakota Sandstone with 300 sacks	300 gal. of MOD-202 (15% HCL-10% Acetic) ATR - 1/3 bbl. per min. 1/3 bbl. per min. ATP - 300#	MTR 300#
-----	---	---	----------

TUBING RECORD

Size	Set At	Packer at	Liner Run	<input type="checkbox"/> Yes <input type="checkbox"/> No
2 3/8"	3691'	N/A		

G

STEPHEN M. KREIDLER

PETROLEUM GEOLOGIST

850 Sutton Place Wichita, Kansas 67202

(316) 265-5370

24-10-2
NW SE SW
GEOLOGI
REPORT
LOG

COMPANY Rine Exploration Company

WELL No. 1-24 Sutor

FIELD _____

LOCATION 175 ft. of NW SE SW

SEC 24 TWP 10S RGE 20W

COUNTY Rooks

STATE Kansas

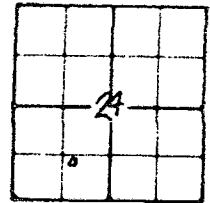

PRODUCTION _____

ELEVATION KB 2133

DF _____

GL 2128

Drilling Measured From K.B.

Samples Saved From 3100 To 3696

Drilling Time From 3100 To 3696

Samples Examined From 3100 To 3696

Geological Supervision From 3100 To Total Depth _____

Wellsite Geologist Stephen M. Kreidler

Electrical Surveys Radiation Guard
Gamma Ray w/caliper

OPERATOR Rine Exploration Company
CONTRACTOR Abercrombie Dr. Rig 7
COMM 8/27/85 COMP 9/13/85

CASING RECORD

8 7/8" @ 306' PROD 4 1/2" @ 3693.5'

TOTAL DEPTH DRILLERS 3696

DEPTH LOG 3696

RECEIVED
KANSAS CORPORATION COMMISSION
NOV 13 2008
CONSERVATION DIVISION
WICHITA, KS

FORMATION TOPS & STRUCTURAL POSITION

FORMATION	SAMPLE TOP	ELECTRIC LOG TOP	SUB-SEA DATUM	STRUCTURAL POSITION
Anhydrite	1553	1551	+582	-5
Base Anhydrite	1986	1589	+544	-3
Topeka	3143	3143	-1010	-1
Heebner	3352	3351	-1218	+1
Toronto	3375	3375	-1242	-2
Lansing	3391	3389	-1256	+1
Base Kansas City	3597	3597	-1464	even
Arbuckle	3693	NR	-1560	+2

K. G. S. LIBRARY

REFERENCE WELL FOR STRUCTURE Nadel & Gussman, No. 1 Earl,
SE SE SW, 24-1105-R20W, 4 & 9

200
J
C

DAILY PENETRATION		BIT RECORD						
DATE	DEPTH	NO.	SIZE	MAKE	TYPE	DEPTH OUT	FEET	HOURS
8/27/85	Spud 8:30 PM	1	7 7/8"	Security	S-3-F	1475	1169	6 1/4
8/28	306 ft. Woc	2	"	Reed	Y-13T	2115	640	12 1/2
8/29	2115 ft. drilling	3	"	Security	S-84F	3696	1581	24 1/4
8/30	2723 ft. "							
8/31	3207 ft. dst no. 1							
9/1	3389 ft. drilling							
9/2	3648 ft. "							
9/3	3696 ft. logging							

No	Interval	
1	3160-3207	2
2	3527-3657	3
3	3636-3696	8

FORMATION	INTERVAL	DESCRIPTION OF SHOW	log Analysis	S.M.
Topeka	3169-3177	ls: tan, fxdn, pp φ 8%, gd sfo, med odor, fnt fluor, tr 'dead' oil.	24%	62%
	3174-3176		22	83
	3196-3200	ls: tan, gy, fxdn, 5% pp φ, fr sfo, fnt odor, fnt fluor.		
	3293-3296	ls: gy, tan, fxdn, dns, tr fo, no odor, no fluor.		
	3323-3328	ls: crm/wh, fxdn, chalky, tr seum oil.		
Lansing/ Kansas City	3426-3435	ls: wh/crm, tan, micro-fxdn, scat pp-vug φ: 1%, fr sfo, fnt-med odor, fnt fluor.		no calc: title
	3446-3453	ls: wh, fxdn, chalky, tan, micro-fxdn, od, tr pp int-cool φ, v sfo, no odor, tr fluor.		
	3462-3477	ls: wh-crm, vt-fxdn, chalky, pr sfo: 9%, v fnt odor, no fluor.	11	54
	3465-3467			
	3482-3485	ls: wh/crm, fxdn, tr pp φ, tr fo, no odor, no fluor.		
	3525-3537	ls: wh/crm, micro-fxdn, tr pp φ, tr fo, no odor, fnt fluor.		no calc: title
	3560-3566	ls: wh/gy, chalky, fxdn, pp φ: 5%, sfo, scat sat str, no odor, med-brt fluor.		
	3576-3583	ls: tan/crm, gy, fxdn, pp φ: 2%, sfo, no odor, no fluor.		
3588-3593	ls: wh/crm, fxdn, pp-vug φ: 3%, scat sat str, pr sfo, fnt odor, no fluor.	11	44	
	3588-3590			
Marmaton	3629-3641	ls: wh/crm vt-fxdn, pp-vug φ: 8% (150 vug φ), abund sat str, fr sfo, fnt odor, fnt fluor.	15	25
	3630-3632			
Congl Ss	3685-3690	ss: grn-yy, glauc, fmg, asph resid; clt, m-csegr, fri, unc ip-silic cat, gd sfo - 'dead' no odor, tr fluor, gd cut.		not reached
Arbuckle	3697-3696	dolo: tan/gy, brn, f-m xln, rhomb, pp-vug φ: 10%, sat str, gd sfo gy, strong odor, dull fluor.		not reached

REMARKS & RECOMM
are L
The To
Marmat
calculat
not wor
The
drill ste
to further

K G S LIBRARY

24-10-20

GREAT GUNS

R A Guard Log

DIGITAL

FILE NO.	COMPANY RINE EXPLORATION COMPANY	
	WELL	SUTOR NO. 1-24
	FIELD	RELEASED NO SMALL SCALE
	COUNTY	ROOKS STATE KANSAS
LOCATION: 175'N of NW SE SW		OTHER SERVICES
SEC	24 TWP 10S RGE 20W	

Permanent Datum	GROUND LEVEL	Elev.	2128	Elevations:	KB 2133
Log Measured from	KELLY BUSHING	5 Ft. Above Permanent Datum		DF	
Drilling Measured from	KELLY BUSHING			GL	2128

Date	9-3-85							
Run No.	ONE	K. G. S. LIBRARY						
Depth—Driller	3696							
Depth—Logger	3696							
Bottom Logged Interval	3692							
Top Logged Interval	SURFACE							
Casing—Driller	8-5/8 @ 305					@	@	@
Casing—Logger								
Bit Size	7-7/8							
Type Fluid in Hole	STARCH							
	27,000 ppm							
Density and Viscosity	9.7 43							
pH and Fluid Loss	7.0 12.0cc		cc	cc	cc			
Source of Sample	FLOWLINE							
Rm @ Meas. Temp.	.23 @ 78F	@ °F	@ °F	@ °F				
Rmf @ Meas. Temp.	.17 @ 78F	@ °F	@ °F	@ °F				
Rmc @ Meas. Temp.	.28 @ 78F	@ °F	@ °F	@ °F				
Source of Rmf and Rmc	CHARTS							
Rm @ BHT	.16 @ 110F	@ °F	@ °F	@ °F				
Time Since Circ.	1-1/2 HOURS							
Max. Rec. Temp. Deg. F.	110F							
Equip No. and Location	64 HAYS							
Recorded By	D. LEGLEITER & R. NITZ							
Witnessed By	MR. KREIDLER							

RECEIVED
KANSAS CORPORATION COMMISSION

NOV 03 2008

CONSERVATION DIVISION
WICHITA, KS



CORPORATION COMMISSION

Kathleen Sebelius, Governor Thomas E. Wright, Chairman Michael C. Moffet, Commissioner Joseph F. Harkins, Commissioner

NOTICE OF RECEIPT OF WELL PLUGGING APPLICATION (CP-1)

BOWMAN OIL COMPANY, A GENERAL PARTNERSHIP
805 CODELL RD
CODELL, KS 67663-8500

November 07, 2008

Re: SUTOR D #1
API 15-163-22742-00-01
24-10S-20W, 990 FSL 1650 FWL
ROOKS COUNTY, KANSAS

Dear Operator:

This letter is to notify you that the Conservation Division has received your plugging proposal, form CP-1, for the above well and has reviewed the proposal for completeness. The central office will now forward your CP-1 to the district office listed below for review of the proposed plugging method. **Please contact the district office for approval of your proposed plugging method at least five (5) days before plugging the well, pursuant to K.A.R. 82-3-113(b). If a workover pit will be used during the plugging of the well it must be permitted. A CDP-1 form must be filed and approved prior to the use of the pit in accordance with K.A.R. 82-3-600.**

The Conservation Division's review of form CP-1, either in the central or district office, does not include an inquiry into well ownership or the filing operator's legal right to plug the well. This notice in no way constitutes authorization to plug the above well by persons not having legal rights of ownership or interest in the well.

This notice is void after May 6, 2009. The CP-1 filing does not bring the above well into compliance with K.A.R. 82-3-111 with regard to the Commission's temporary abandonment requirements.

Sincerely,

Steve Bond
Production Department Supervisor

District: #4
2301 E. 13th
Hays, KS 67601
(785) 625-0550