

STATE CORPORATION COMMISSION OF KANSAS  
OIL & GAS CONSERVATION DIVISION  
WELL COMPLETION OR RECOMPLETION FORM  
ACO-1 WELL HISTORY  
DESCRIPTION OF WELL AND LEASE

5

API NO. 15-.....179-20,926-00-00.....  
County.....Sheridan.....  
.....SE. NW. ...SE Sec. 15. Twp. 10S. Rge. 26. East  
..... West

Operator: License # .....5063.....  
Name .....Energy Exploration, Inc.....  
Address 1002 S. Broadway.....  
.....  
City/State/Zip Wichita, KS 67211.....

.....4290..... Ft North from Southeast Corner of Section  
.....1650..... Ft West from Southeast Corner of Section  
(Note: Locate well in section plat below)

Purchaser NA.....

Lease Name.....B.H. WERTH.....Well #.....1.....  
Field Name.....wildcat.....

Operator Contact Person Kevin Howard.....  
Phone .....267-7336.....

Producing Formation.....NA.....  
Elevation: Ground.....2602.....KB.....2607.....

Contractor: License # .....5883.....  
Name .....Warrior Drilling Co. Rig #1.....

Wellsite Geologist.....Kent Roberts.....  
Phone.....316-262-5300.....

Designate Type of Completion  
 New Well     Re-Entry     Workover  
 Oil             SWD             Temp Abd  
 Gas             Inj             Delayed Comp  
 Dry             Other (Core, Water Supply etc.)

RECEIVED  
STATE CORPORATION COMMISSION  
AUG - 2 1988  
08-02-88  
CONSERVATION DIVISION  
Wichita, Kansas

If **OWO**: old well info as follows: NA  
Operator .....  
Well Name .....  
Comp. Date .....Old Total Depth.....

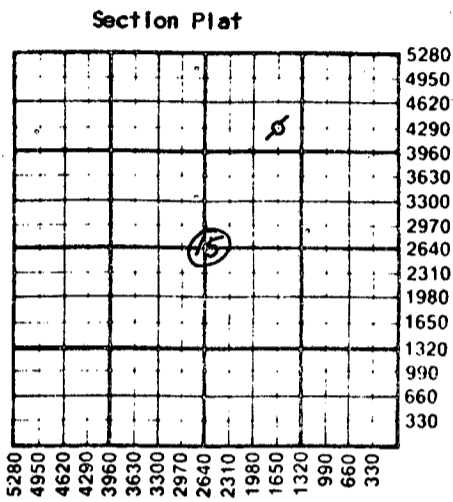

WATER SUPPLY INFORMATION  
Disposition of Produced Water: \_\_\_\_\_ Disposal  
Docket # ..... \_\_\_\_\_ Repressuring

WELL HISTORY  
Drilling Method:  
 Mud-Rotary     Air-Rotary     Cable  
7-09-88..    7-15-88....    7-15-88...  
Spud Date    Date Reached TD    Completion Date  
4150'                    NA  
.....  
Total Depth    PBTD  
Amount of Surface Pipe Set and Cemented at 222' feet  
Multiple Stage Cementing Collar Used?  Yes  No  
If yes, show depth set.....feet  
If alternate 2 completion, cement circulated  
from.....feet depth to.....w/.....SX cmt  
Cement Company Name .....  
Invoice # .....  
AGI D&S

Questions on this portion of the ACO-1 call:  
Water Resources Board (913) 296-3717  
Source of Water:  
Division of Water Resources Permit #...31036.....  
 Groundwater.....Ft North from Southeast Corner  
(Well)                    .....Ft West from Southeast Corner of  
NE/4                    Sec 32 Twp 10SRge26    East  West  
 Surface Water.....Ft North from Southeast Corner  
(Stream,pond etc).....Ft West from Southeast Corner  
Sec    Twp    Rge    East    West  
 Other (explain).....  
(purchased from city, R.W.D. #)

INSTRUCTIONS: This form shall be completed in triplicate and filed with the Kansas Corporation Commission, 200 Colorado Derby Building, Wichita, Kansas 67202, within 120 days of the spud date of any well. Rule 82-3-130, 82-3-107 and 82-3-106 apply.  
Information on side two of this form will be held confidential for a period of 12 months if requested in writing and submitted with the form. See rule 82-3-107 for confidentiality in excess of 12 months.  
One copy of all wireline logs and drillers time log shall be attached with this form. Submit CP-4 form with all plugged wells. Submit CP-111 form with all temporarily abandoned wells.

All requirements of the statutes, rules and regulations promulgated to regulate the oil and gas industry have been fully complied with and the statements herein are complete and correct to the best of my knowledge.

Signature .....  
Joseph D. Mace  
Title.....President..... Date 7-27-88

Subscribed and sworn to before me this 27th day of July  
1988.....  
Notary Public.....  
Date Commission Expires 1-30-89

CHERYL L. IDLEMAN  
NOTARY PUBLIC  
STATE OF KANSAS  
My Appt. Exp. 1-30-89

K.C.C. OFFICE USE ONLY  
F \_\_\_\_\_ Letter of Confidentiality Attached  
C  Wireline Log Received  
C \_\_\_\_\_ Drillers Timelog Received  
Distribution  
 KCC                    \_\_\_\_\_ SWD/Rep                    \_\_\_\_\_ NGPA  
 KGS                    \_\_\_\_\_ Plug                    \_\_\_\_\_ Other  
(Specify)  
.....  
8-2-88  
Form ACO-1 (5-86)

Sec. 15 Twp. 10 Rge. 26

Operator Name ..... Energy Exploration Inc. .... Lease Name... B.H. Werth ..... Well #... 1....

Sec... 15... Twp... 10S... Rge... 26...  East  West County... Sheridan.....

WELL LOG

INSTRUCTIONS: Show important tops and base of formations penetrated. Detail all cores. Report all drill stem tests giving interval tested, time tool open and closed, flowing and shut-in pressures, whether shut-in pressure reached static level, hydrostatic pressures, bottom hole temperature, fluid recovery, and flow rates if gas to surface during test. Attach extra sheet if more space is needed. Attach copy of log.

Drill Stem Tests Taken  Yes  No  
 Samples Sent to Geological Survey  Yes  No  
 Cores Taken  Yes  No

Formation Description  
 Log  Sample

Name \_\_\_\_\_ Top \_\_\_\_\_ Bottom \_\_\_\_\_

DST #1 3901-3919 (Lns. B) 30-30-30-30, Rec. 5'  
 0 spk. M, IHP 1993, IFP 52-52, ISIP 737, FFP 42-42, FSIP 633, FHP 1951, temp. 119°.

DST #2 3919-3935 (Lns. D) 30-30-30-30, Rec. 30'  
 MW, 25,000 chl., IHP 1972, IFP 52-52, ISIP 956, FFP 52-52, FSIP 914, FHP 1888, temp. 119°.

Formation	Sample	Log
Anhydrite	2246 +360	2241 +365
Topeka	3626 -1020	3627 -1021
King Hill Shale	3735 -1129	3736 -1130
Heebner	3845 -1239	3846 -1240
Toronto	3871 -1265	3870 -1264
Lansing	3887 -1281	3887 -1281
Muncie Creek	4006 -1400	4008 -1402
Stark Shale	4076 -1470	4076 -1470
BKC	4116 -1510	4117 -1511
T.D.	4150	4152

CASING RECORD <input checked="" type="checkbox"/> New <input type="checkbox"/> Used							
Report all strings set-conductor, surface, intermediate, production, etc.							
Purpose of String	Size Hole Drilled	Size Casing Set (in O.D.)	Weight Lbs/Ft.	Setting Depth	Type of Cement	#Sacks Used	Type and Percent Additives
Surface	12 1/4"	8 5/8"	23#	222'	common	150	3%cc 2%gel

PERFORATION RECORD		Acid, Fracture, Shot, Cement Squeeze Record	
Shots Per Foot	Specify Footage of Each Interval Perforated	(Amount and Kind of Material Used)	Depth

TUBING RECORD				Liner Run <input type="checkbox"/> Yes <input type="checkbox"/> No	
Size	Set At	Packer at			

Date of First Production	Producing Method				
	<input type="checkbox"/> Flowing <input type="checkbox"/> Pumping <input type="checkbox"/> Gas Lift <input type="checkbox"/> Other (explain).....				
	Oil	Gas	Water	Gas-Oil Ratio	Gravity
Estimated Production Per 24 Hours	Bbls	MCF	Bbls	CFPB	

METHOD OF COMPLETION

Production Interval

Disposition of gas:  Vented  Open Hole  Perforation  
 Sold  Other (Specify) .....  
 Used on Lease  Dually Completed  
 Commingled

