

OWWO

For KCC Use: 1-25-09
Effective Date: 1-25-09
District #: 2
SGA? Yes No

KANSAS CORPORATION COMMISSION
OIL & GAS CONSERVATION DIVISION

Form C-1
October 2007
Form must be Typed
Form must be Signed
All blanks must be Filled

NOTICE OF INTENT TO DRILL

Must be approved by KCC five (5) days prior to commencing well

Expected Spud Date: January 15, 2009
month day year

OPERATOR: License# 4419 ✓
Name: Bear Petroleum, Inc.
Address 1: P.O. Box 438
Address 2:
City: Haysville State: KS Zip: 67060 +
Contact Person: Dick Schremmer
Phone: 316-524-1225

CONTRACTOR: License# 3004 ✓
Name: Gressel Oil Field Service, Inc.

Well Drilled For: Oil Gas Seismic Other
 Enh Rec Storage Disposal
Well Class: Infield Pool Ext. Wildcat Other
Type Equipment: Mud Rotary Air Rotary Cable
of Holes: _____

If OWWO: old well information as follows:
Operator: Gulf Oil Corporation
Well Name: Blood #3
Original Completion Date: 4-29-55 Original Total Depth: 3200'

Directional, Deviated or Horizontal wellbore? Yes No
If Yes, true vertical depth: _____
Bottom Hole Location: _____
KCC DKT #: _____

Spot Description: _____
NE - SE - SW - Sec. 29 Twp. 28 S. R. 1 E W
(a/a/a) 990 feet from N / S Line of Section
2,310 feet from E / W Line of Section

Is SECTION: Regular Irregular?

(Note: Locate well on the Section Plat on reverse side)
County: Sedgwick
Lease Name: G. Blood Well #: 3
Field Name: Gladys Pool

Is this a Prorated / Spaced Field? Yes No
Target Formation(s): Mississippi

Nearest Lease or unit boundary line (in footage): 330'
Ground Surface Elevation: 1259 feet MSL

Water well within one-quarter mile: Yes No
Public water supply well within one mile: Yes No

Depth to bottom of fresh water: 15
Depth to bottom of usable water: 60' 130'

Surface Pipe by Alternate: I II

Length of Surface Pipe Planned to be set: 159'
Length of Conductor Pipe (if any): NA

Projected Total Depth: 3200'
Formation at Total Depth: Mississippi

Water Source for Drilling Operations:
 Well Farm Pond Other: Trucked

DWR Permit #: _____
(Note: Apply for Permit with DWR)

Will Cores be taken? Yes No
If Yes, proposed zone: _____

AFFIDAVIT

RECEIVED
KANSAS CORPORATION COMMISSION

DEC 12 2008

The undersigned hereby affirms that the drilling, completion and eventual plugging of this well will comply with K.S.A. 55 et. seq.
It is agreed that the following minimum requirements will be met:

CONSERVATION DIVISION
WICHITA, KS

- 1. Notify the appropriate district office prior to spudding of well;
- 2. A copy of the approved notice of intent to drill shall be posted on each drilling rig;
- 3. The minimum amount of surface pipe as specified below shall be set by circulating cement to the top; in all cases surface pipe shall be set through all unconsolidated materials plus a minimum of 20 feet into the underlying formation.
- 4. If the well is dry hole, an agreement between the operator and the district office on plug length and placement is necessary prior to plugging;
- 5. The appropriate district office will be notified before well is either plugged or production casing is cemented in;
- 6. If an ALTERNATE II COMPLETION, production pipe shall be cemented from below any usable water to surface within 120 DAYS of spud date. Or pursuant to Appendix "B" - Eastern Kansas surface casing order #133,891-C, which applies to the KCC District 3 area, alternate II cementing must be completed within 30 days of the spud date or the well shall be plugged. In all cases, NOTIFY district office prior to any cementing.

I hereby certify that the statements made herein are true and correct to the best of my knowledge and belief.

Date: 12-11-08 Signature of Operator or Agent: [Signature] Title: President

For KCC Use ONLY
API # 15 - 173-01811-00-01
Conductor pipe required None feet
Minimum surface pipe required 159 feet per ALT. I II
Approved by: [Signature] 1-20-09
This authorization expires: 1-20-2010
(This authorization void if drilling not started within 12 months of approval date.)
Spud date: _____ Agent: _____

Remember to:

- File Drill Pit Application (form CDP-1) with Intent to Drill;
- File Completion Form ACO-1 within 120 days of spud date;
- File acreage attribution plat according to field proration orders;
- Notify appropriate district office 48 hours prior to workover or re-entry;
- Submit plugging report (CP-4) after plugging is completed (within 60 days);
- Obtain written approval before disposing or injecting salt water.
- If this permit has expired (See: authorized expiration date) please check the box below and return to the address below.

Well Not Drilled - Permit Expired Date: _____
Signature of Operator or Agent: _____

29
28
1
 E
 W

IN ALL CASES PLOT THE INTENDED WELL ON THE PLAT BELOW

Plat of acreage attributable to a well in a prorated or spaced field

If the intended well is in a prorated or spaced field, please fully complete this side of the form. If the intended well is in a prorated or spaced field complete the plat below showing that the well will be properly located in relationship to other wells producing from the common source of supply. Please show all the wells and within 1 mile of the boundaries of the proposed acreage attribution unit for gas wells and within 1/2 mile of the boundaries of the proposed acreage attribution unit for oil wells.

API No. 15 - 173-01811-00-01
 Operator: Bear Petroleum, Inc.
 Lease: G. Blood
 Well Number: 3
 Field: Gladys Pool

Location of Well: County: Sedgwick
 990 feet from N / S Line of Section
 2,310 feet from E / W Line of Section
 Sec. 29 Twp. 28 S. R. 1 E W

Number of Acres attributable to well: _____
 QTR/QTR/QTR/QTR of acreage: NE - SE - SW - _____

Is Section: Regular or Irregular

If Section is Irregular, locate well from nearest corner boundary.

Section corner used: NE NW SE SW

PLAT

(Show location of the well and shade attributable acreage for prorated or spaced wells.)

(Show footage to the nearest lease or unit boundary line.)

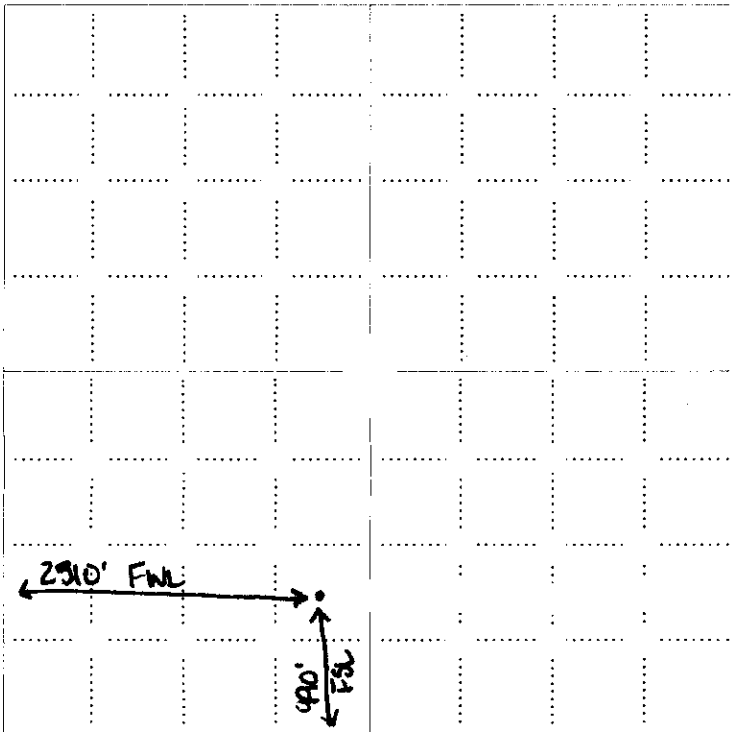

NOTE: In all cases locate the spot of the proposed drilling location.

RECEIVED
 KANSAS CORPORATION COMMISSION
 DEC 12 2008
 CONSERVATION DIVISION
 WICHITA, KS

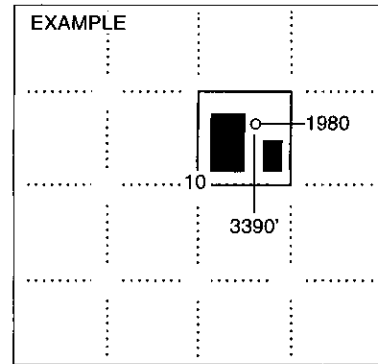

In plotting the proposed location of the well, you must show:

1. The manner in which you are using the depicted plat by identifying section lines, i.e. 1 section, 1 section with 8 surrounding sections, 4 sections, etc.
2. The distance of the proposed drilling location from the south / north and east / west outside section lines.
3. The distance to the nearest lease or unit boundary line (in footage).
4. If proposed location is located within a prorated or spaced field a certificate of acreage attribution plat must be attached: (CO-7 for oil wells; CG-8 for gas wells).

**KANSAS CORPORATION COMMISSION
OIL & GAS CONSERVATION DIVISION
APPLICATION FOR SURFACE PIT**

Form GDP-1
April 2004
Form must be Typed

Submit in Duplicate

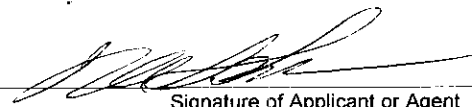
Operator Name: Bear Petroleum, Inc.		License Number: 4419
Operator Address: P.O. Box 438		Haysville KS 67060
Contact Person: Dick Schremmer		Phone Number: 316-524-1225
Lease Name & Well No.: G. Blood 3		Pit Location (QQQQ): NE SE SW
Type of Pit: <input type="checkbox"/> Emergency Pit <input type="checkbox"/> Burn Pit <input type="checkbox"/> Settling Pit <input checked="" type="checkbox"/> Drilling Pit <input type="checkbox"/> Workover Pit <input type="checkbox"/> Haul-Off Pit <small>(If W/P Supply API No. or Year Drilled)</small>	Pit is: <input checked="" type="checkbox"/> Proposed <input type="checkbox"/> Existing If Existing, date constructed: _____ Pit capacity: _____ (bbls)	Sec. 29 Twp. 28 R. 1 <input checked="" type="checkbox"/> East <input type="checkbox"/> West Feet from 990 North / <input checked="" type="checkbox"/> South Line of Section 2,310 Feet from <input type="checkbox"/> East / <input checked="" type="checkbox"/> West Line of Section Sedgwick County
Is the pit located in a Sensitive Ground Water Area? <input checked="" type="checkbox"/> Yes <input type="checkbox"/> No		Chloride concentration: _____ mg/l <small>(For Emergency Pits and Settling Pits only)</small>
Is the bottom below ground level? <input checked="" type="checkbox"/> Yes <input type="checkbox"/> No	Artificial Liner? <input checked="" type="checkbox"/> Yes <input type="checkbox"/> No	How is the pit lined if a plastic liner is not used?
Pit dimensions (all but working pits): 10 Length (feet) 40 Width (feet) <input type="checkbox"/> N/A: Steel Pits Depth from ground level to deepest point: 4 (feet) <input type="checkbox"/> No Pit		
If the pit is lined give a brief description of the liner material, thickness and installation procedure. 20 ml Plastic		Describe procedures for periodic maintenance and determining liner integrity, including any special monitoring.
Distance to nearest water well within one-mile of pit 1200 feet Depth of water well 30 feet		Depth to shallowest fresh water 15 feet. Source of information: <input type="checkbox"/> measured <input checked="" type="checkbox"/> well owner <input type="checkbox"/> electric log <input type="checkbox"/> KDWR
Emergency, Settling and Burn Pits ONLY: Producing Formation: _____ Number of producing wells on lease: _____ Barrels of fluid produced daily: _____ Does the slope from the tank battery allow all spilled fluids to flow into the pit? <input type="checkbox"/> Yes <input type="checkbox"/> No		Drilling, Workover and Haul-Off Pits ONLY: Type of material utilized in drilling/workover: Fresh water Number of working pits to be utilized: 2 Abandonment procedure: Empty with vac truck, remove liner, and backfill. Drill pits must be closed within 365 days of spud date.
I hereby certify that the above statements are true and correct to the best of my knowledge and belief.		
12-11-08 Date	 Signature of Applicant or Agent	RECEIVED KANSAS CORPORATION COMMISSION DEC 12 2008 CONSERVATION DIVISION WICHITA, KS
KCC OFFICE USE ONLY		
Steel Pit <input type="checkbox"/>		RFAC <input checked="" type="checkbox"/> RFAS <input type="checkbox"/>
Date Received: 12/2/08	Permit Number: _____	Permit Date: 1/20/09 Lease Inspection: <input checked="" type="checkbox"/> Yes <input type="checkbox"/> No

Mail to: KCC - Conservation Division, 130 S. Market - Room 2078, Wichita, Kansas 67202

Public Water Supply Well - Sec. 28-28-1E
Depth = 36'

15773-01811-00-01



*Kathleen Sebelius, Governor
Thomas E. Wright, Chairman
Michael C. Moffet, Commissioner
Joseph F. Harkins, Commissioner*

January 20, 2009

Bear Petroleum, Inc.
PO Box 438
Haysville, KS 67060

Re: Drilling Pit Application
G. Blood Lease Well No. 3
SW/4 Sec. 29-28S-01E
Sedgwick County, Kansas

Dear Sir or Madam:

District staff has inspected the above referenced location and has determined that the reserve pit shall be constructed **without slots**, the bottom shall be flat and reasonably level, and the free fluids must be removed. The fluids are to be removed from the reserve pit within 72 hours of drilling completion.

If production casing is set all completion fluids shall be removed from the working pits daily. NO completion fluids or non-exempt wastes shall be placed in the reserve pit.

The fluids should be taken to an authorized disposal well. Please call the District Office at (316) 630-4000 when the fluids have been removed. Please file form CDP-5 (August 2004), Exploration and Production Waste Transfer, within 30 days of fluid removal. Conservation division forms are available through our office and on the KCC web site:
www.kcc.state.ks.us/conservation/forms.

A copy of this letter should be posted in the doghouse along with the approved Intent to Drill.

If you have any questions or concerns please feel free to contact the undersigned at the above address.

Sincerely,

Kathy Haynes
Environmental Protection and Remediation Department

cc: File



Kathleen Sebelius, Governor
Thomas E. Wright, Chairman
Michael C. Moffet, Commissioner
Joseph F. Harkins, Commissioner

December 18, 2008

Dick Schremmer
Bear Petroleum, Inc.
PO Box 438
Haysville, KS 67060

RE: Exception to Table 1 Surface Casing Requirements for the G. Blood #3, 990' FSL, 2310' FWL, Sec. 29-T28S-R1E, Sedgwick County, Kansas.

Dear Mr. Schremmer: *Dick:*

The Kansas Corporation Commission (KCC) has received your request, dated December 17, 2008, for an exception to Table 1 surface pipe requirements for the above-referenced well, which was plugged as the Blood #3 in 1955 by Gulf Oil Corporation. From your request, the KCC understands that Bear Petroleum, Inc. desires to re-enter this well, which has 159' of surface pipe set. The Table 1 minimum surface pipe requirement for wells drilled in Sedgwick County is 200'. The surface pipe set in this previously plugged well does not meet the present surface pipe setting depth requirements.

After review of this matter by technical staff it was determined that:

1. Bedrock at this location is the Permian Sumner Group overlain with approximately 40 feet of alluvial material.
2. A review of water well records indicated that water wells within approximately one mile of the G. Blood #3 are less than 100 feet deep.
3. The annulus between the borehole and existing 5½" casing was squeezed from 355 feet to the surface when the well was plugged in 1985. The existing 159 feet of surface casing and subsequent cementing of the 5½" casing adequately protects fresh and usable ground water.

Based on this information, an exception is granted for the Table 1 Minimum Surface Casing Requirements with the following stipulation:

1. In the event the well is dry and no additional production pipe has been cemented in-place, plugging will be performed according to KCC rules per KCC District #2 requirements.

Sincerely,

Doug Louis
Director

cc: Steve Bond ✓ SB
Jeff Klock - Dist #2 ✓ 12/15/08

CONSERVATION DIVISION

Finney State Office Building, 130 S. Market, Room 2078, Wichita, KS 67202-3802
(316) 337-6200 • Fax: (316) 337-6211 • <http://kcc.ks.gov/>



BEAR PETROLEUM, INC.

POST OFFICE BOX 438
HAYSVILLE, KANSAS 67060
PHONE: (316) 524-1225
FAX: (316) 524-1027



December 17, 2008

KCC – Conservation Division
Attn: Rick Hesterman
130 S. Market, Room 2078
Wichita, KS 67202

RE: G. Blood #3
NE SE SW Sec 29-28-1E
Sedgwick County, KS

Dear Mr. Hesterman:

I am writing to ask for a surface pipe exception on the above described well. An intent has been filed to re-enter the well.

Please contact me, if you have any questions or need further information.

Yours Truly,

R. A. (Dick) Schremmer
President

RECEIVED
KANSAS CORPORATION COMMISSION

DEC 17 2008

CONSERVATION DIVISION
WICHITA, KS

STATE OF KANSAS
 CORPORATION COMMISSION
 Colorado Derby Building
 Topeka, Kansas 67202

WELL PLUGGING RECORD
 K.A.R.-82-3-117

15-173-01811-00-00

API NUMBER D&C 03-15-55

LEASE NAME East Gladys Unit

WELL NUMBER Blood #3

990 Ft. from S Section Line

2970 Ft. from E Section Line

SEC. 29 TWP. 28S RGE. 1 (E) or ~~XXX~~

COUNTY Sedgwick

Date Well Completed 03-15-55

Plugging Commenced 03-25-85

Plugging Completed 03-25-85

TYPE OR PRINT
 NOTICE: Fill out completely
 and return to Cons. Div.
 office within 30 days.

EASE OPERATOR Gulf Oil Corporation

ADDRESS P.O. Box 12116, Oklahoma City, OK 73157

PHONE# (405) 949-7000 OPERATORS LICENSE NO. 5816

Character of Well Oil

(Oil, Gas, D&A, SWD, Input, Water Supply Well)

Did you notify the KCC/KDHE Joint District Office prior to plugging this well? Yes

Which KCC/KDHE Joint Office did you notify? District #2

Is ACO-1 filed? No Record if not, is well log attached? Yes

Producing Formation Mississippi Depth to Top 3146 Bottom 3187 T.D. 3190

Show depth and thickness of all water, oil and gas formations.

OIL, GAS OR WATER RECORDS

CASING RECORD

RECEIVED
 STATE CORPORATION COMMISSION

Formation	Content	From	To	Size	Put in	Pulled out
Mississippi	Oil			8 5/8"	159	None
				5 1/2"	3189	None

APR 22 1985

CONSERVATION DIVISION
 Wichita, Kansas

Describe in detail the manner in which the well was plugged, indicating where the mud fluid was placed and the method or methods used in introducing it into the hole. If cement or other plugs were used, state the character of same and depth placed, from feet to feet each set.

SHOWN ON BACK OF FORM

(If additional description is necessary, use BACK of this form.)

Name of Plugging Contractor Gressel Corporation License No. 5822

Address P.O. Box 322, Haysville, KS 67060

STATE OF Oklahoma COUNTY OF Oklahoma, ss.

Dorretta Moore (Employee of Operator) or ~~(Operator)~~ of above-described well, being first duly sworn on oath, says: That I have knowledge of the facts, statements, and matters herein contained and the log of the above-described well as filed that the same are true and correct, so help me God.

(Signature) Dorretta Moore

(Address) Same as operator

SUBSCRIBED AND SWORN TO before me this 18th day of April, 19 85

Patricia A. Wanderly
 Notary Public

My Commission Expires: 01/31/87

15-173-01811-00-00

GLADYS FIELD

East Gladys Unit, Blood #3

Sec 29-28S-1E

Sedgwick Co., KS

TD 3200', PBD 3200', 5½" csg @3189'. 3-25-85: MIRU PU. POH w/rods & tbg. MIRU Welex. RIH w/gauge ring to 3110' GL. RIH & set CIBP @3100' GL. RIH w/4" HSCG. Shot 4 sq holes @355' GL. MIRU Howco. RIH w/2-3/8" tbg to 3099. Circ well w/9 ppg mud. Spot 50 sk Cl A cmt f/3110-2680'. POH w/tbg to 400' GL. Circ 5½" csg to sfc w/50 sks Cl A cmt. POH w/tbg. Tie onto 5½" csg. Circ 140 sks cmt through sqz holes to 8-5/8 x 5½ sfc. WOC. Topped off cmt. Cut csg off 6' BGL.

Capped well, ID well. Restored sfc. Well P & A'd 3/25/85. State man Glen Ward on loc. Not Last Well on Lease. [REDACTED] FINAL REPORT DROP

D R I L L I N G L O G

15-173-01811-00-00

COMPANY: Francis M. Raymond
 CONTRACTOR: Pabco Drilling, Inc.

LOCATION: NE SE SW
 29-28S-1E
 Sedgwick Co.
 Kansas

FARM NAME: No. 3 Blood

COMMENCED: 3-7-55
 COMPLETED: 3-15-55

CASING USED:

8-5/8" 159' cem w/150 sx
 5-1/2" 3189' cem w/60 sx

FORMATION	FROM	TO	
Sand	0	60	
Shale & Sand	60	135	
Anhydrite	135	157	
Shale & Lime	157	965	ST & SLM OK @ 500
Shale & Shells	965	1315	ST & SLM OK @ 1050
Shale & Lime	1315	1740	
Lime	1740	1870	
Lime & Shale	1870	2223	ST & SLM OK @ 2175
Shale	2223	2627	
Lime	2627	2800	
Shale & Lime	2800	3137	ST & SLM OK @ 2930
Coring	3137	3190	
Total Depth	3190		

STATE OF KANSAS)
) ss:
 SEDGWICK COUNTY)

I, D. J. Briggs, do hereby certify that the above is a true and correct copy of the log on the above captioned well, as shown on the daily drilling reports.

PABCO DRILLING, INC.

By D. J. Briggs
 D. J. Briggs, President

Subscribed and sworn to before me this 16th day of March 1955

RECEIVED
 STATE CORPORATION COMMISSION

L. L. Tolson
 Notary Public FEB 27 1955
 CONSERVATION DIVISION
 Wichita, Kansas

My commission expires March 2, 1957.