

EFFECTIVE DATE: 6-27-92  
DISTRICT # 4  
SGA?  Yes  No

State of Kansas  
NOTICE OF INTENTION TO DRILL

Must be approved by the K.C.C. five (5) days prior to commencing well

Expected Spud Date June 26 1991  
month day year

Spot  SW  SW  NE  Sec 25  Twp 10-S S, Rg 34-W  East West

OPERATOR: License # 06113  
Name: Landmark Oil Exploration, Inc.  
Address: 250 N. Water, Suite 308  
City/State/Zip: Wichita, Kansas 67202  
Contact Person: Jeff Wood  
Phone: (316) 265-8181

2970 feet from South North line of Section  
2310 feet from East West line of Section  
IS SECTION XX REGULAR IRREGULAR?

CONTRACTOR: License #: 6033  
Name: Murfin Drilling Co., Inc.

(NOTE: Locate well on the Section Plat on Reverse Side)  
County: Thomas  
Lease Name: Mai Trust Well #: 1-25  
Field Name: unnamed

Well Drilled For: Well Class: Type Equipment:  
XX Oil ... Enh Rec ... Infield XX Mud Rotary  
... Gas ... Storage ... Pool Ext. ... Air Rotary  
... OWWO ... Disposal XX Wildcat ... Cable  
... Seismic; ... # of Holes ... Other  
... Other

Is this a Prorated/Spaced Field? ... yes XX no  
Target Formation(s): LKC Johnson Zone  
Nearest lease or unit boundary: 330'  
Ground Surface Elevation: 3160 feet MSL  
Water well within one-quarter mile: ... yes XX no  
Public water supply well within one mile: ... yes XX no  
Depth to bottom of fresh water: 315  
Depth to bottom of usable water: 1710  
Surface Pipe by Alternate: 1 XX-2  
Length of Surface Pipe Planned to be set: 350'  
Length of Conductor pipe required: n/a  
Projected Total Depth: 4700'  
Formation at Total Depth: Mississippian  
Water Source for Drilling Operations:

If OWWO: old well information as follows:  
Operator: \_\_\_\_\_  
Well Name: \_\_\_\_\_  
Comp. Date: \_\_\_\_\_ Old Total Depth \_\_\_\_\_

... well ... farm pond XX other  
DWR Permit #: \_\_\_\_\_  
Will Cores Be Taken?: ... yes XX no  
If yes, proposed zone: \_\_\_\_\_

Directional, Deviated or Horizontal wellbore? ... yes XX no  
If yes, true vertical depth: \_\_\_\_\_  
Bottom Hole Location: \_\_\_\_\_

AFFIDAVIT

The undersigned hereby affirms that the drilling, completion and eventual plugging of this well will comply with K.S.A. 55-101, et. seq.  
It is agreed that the following minimum requirements will be met:

- 1. Notify the appropriate district office prior to spudding of well;
- 2. A copy of the approved notice of intent to drill shall be posted on each drilling rig;
- 3. The minimum amount of surface pipe as specified below shall be set by circulating cement to the top; in all cases surface pipe shall be set through all unconsolidated materials plus a minimum of 20 feet into the underlying formation;
- 4. If the well is dry hole, an agreement between the operator and the district office on plug length and placement is necessary prior to plugging;
- 5. The appropriate district office will be notified before well is either plugged or production casing is cemented in;
- 6. IF AN ALTERNATE II COMPLETION, PRODUCTION PIPE SHALL BE CEMENTED FROM BELOW ANY USABLE WATER TO SURFACE WITHIN 120 DAYS OF SPUD DATE. IN ALL CASES, NOTIFY DISTRICT OFFICE PRIOR TO ANY CEMENTING.

I hereby certify that the statements made herein are true and to the best of my knowledge and belief.

Date: 06-22-92 Signature of Operator or Agent: Karri Wolken Title: Exec. Assistant

FOR KCC USE:  
API # 15- 193-20597-00-00  
Conductor pipe required None feet  
Minimum surface pipe required 265' feet per Alt. X(2)  
Approved by: C.B. 6-22-92  
This authorization expires: 12-22-92  
(This authorization void if drilling not started within 6 months of effective date.)  
Spud date: \_\_\_\_\_ Agent: \_\_\_\_\_

RECEIVED  
KANSAS CORPORATION COMMISSION  
JUN 22 1992  
06-22-1992  
CONSERVATION DIVISION  
WICHITA KS

REMEMBER TO:

- File Drill Pit Application (form CDP-1) with Intent to Drill;
- File Completion Form ACO-1 within 120 days of spud date;
- File acreage attribution plat according to field proration orders;
- Notify appropriate district office 48 hours prior to workover or re-entry;
- Submit plugging report (CP-4) after plugging is completed;
- Obtain written approval before disposing or injecting salt water.

Mail to: Conservation Division, 200 Colorado Derby Building, 202 W. First St., Wichita, Kansas 67202-1286.

25  
10  
34

IN ALL CASES PLOT THE INTENDED WELL ON THE PLAT BELOW

PLAT OF ACREAGE ATTRIBUTABLE TO A WELL IN A PRORATED OR SPACED FIELD

If the intended well is in a prorated or spaced field, please fully complete this side of the form. If the intended well is in a prorated or spaced field complete the plat below showing that the well will be properly located in relationship to other wells producing from the common source of supply. Please show all the wells within 1 mile of the boundaries of the proposed acreage attribution unit for gas wells and within 1/2 mile of the boundaries of the proposed acreage attribution unit for oil wells.

API NO. 15- \_\_\_\_\_  
 OPERATOR \_\_\_\_\_  
 LEASE \_\_\_\_\_  
 WELL NUMBER \_\_\_\_\_  
 FIELD \_\_\_\_\_

LOCATION OF WELL: COUNTY \_\_\_\_\_  
 \_\_\_\_\_ feet from south/north line of section  
 \_\_\_\_\_ feet from east/west line of section  
 SECTION \_\_\_\_\_ TWP \_\_\_\_\_ RG \_\_\_\_\_

NUMBER OF ACRES ATTRIBUTABLE TO WELL \_\_\_\_\_  
 QTR/QTR/QTR OF ACREAGE \_\_\_\_\_

IS SECTION \_\_\_\_\_ REGULAR or \_\_\_\_\_ IRREGULAR  
IF SECTION IS IRREGULAR, LOCATE WELL FROM NEAREST CORNER BOUNDARY.

Section corner used: \_\_\_\_\_ NE \_\_\_\_\_ NW \_\_\_\_\_ SE \_\_\_\_\_ SW  
PLAT

(Show location of the well and shade attributable acreage for prorated or spaced wells.)  
 (Show footage to the nearest lease or unit boundary line.)

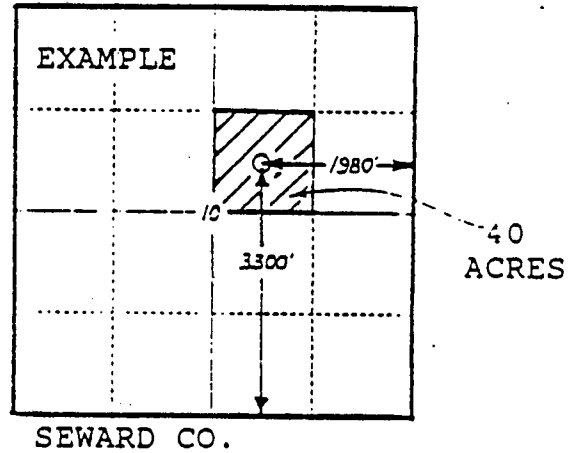
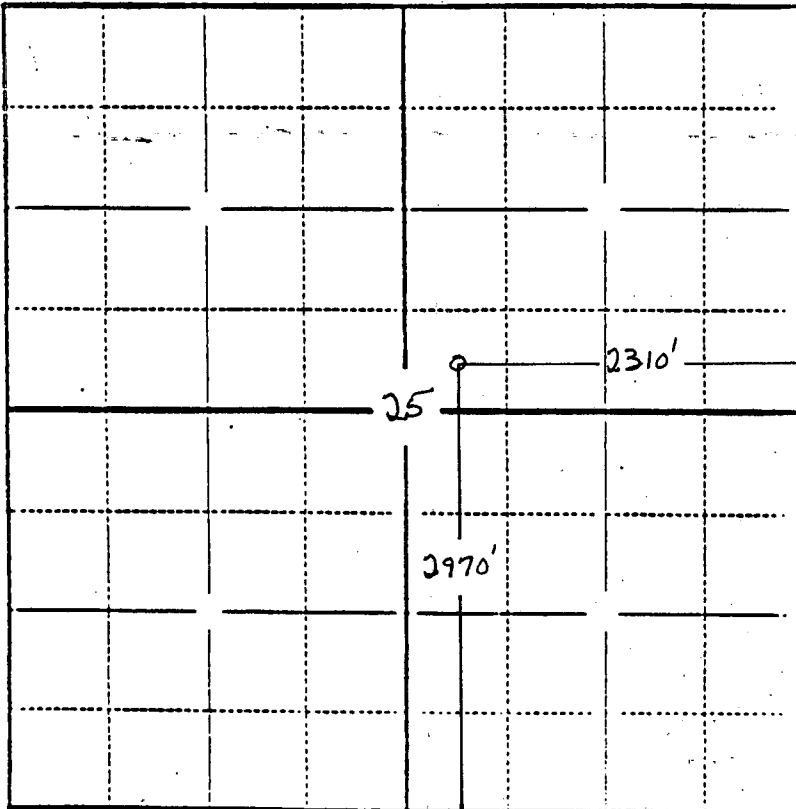

In plotting the proposed location of the well, you must show:

- 1) The manner in which you are using the depicted plat by identifying section lines, i.e. 1 section, 1 section with 8 surrounding sections, 4 sections, etc.;
- 2) the distance of the proposed drilling location from the section's south/north and east/west lines; and
- 3) the distance to the nearest lease or unit boundary line.