

JAN 11 1987

SIDE ONE

STATE CORPORATION COMMISSION OF KANSAS
OIL & GAS CONSERVATION DIVISION
WELL COMPLETION OR RECOMPLETION FORM
ACO-1 WELL HISTORY
DESCRIPTION OF WELL AND LEASE

API NO. 15-193-20,437-0000
County... Thomas
W/2 SW NW Sec 8 Twp 10S Rge 33 East X West

3300 Ft North from Southeast Corner of Section
4950 Ft West from Southeast Corner of Section
(Note: Locate well in section plat below)

Lease Name... Steinle "C" Well #... 1

Field Name.....

Producing Formation.....

Elevation: Ground... 3200' KB... 3206'

Operator: License # 5181
Name Donald C. Slawson
Address 104 S. Broadway
200 Douglas Bldg
City/State/Zip Wichita, KS 67202

Purchaser.....

Operator Contact Person William R. Horigan
Phone (316) 263-3201

Contractor: License # 5657
Name Slawson Drilling Company

Wellsite Geologist Rich Robba
Phone.....

Designate Type of Completion
X New Well Re-Entry Workover
Oil SWD Temp Abd
Gas Inj Delayed Comp.
X Dry Other (Core, Water Supply etc.)

If ONWO: old well info as follows:
Operator.....
Well Name.....
Comp. Date..... Old Total Depth.....

WELL HISTORY

Drilling Method:
X Mud Rotary Air Rotary Cable
5-20-87 5-30-87 5-30-87
Spud Date Date Reached TD Completion Date
4790'
Total Depth PBD

Amount of Surface Pipe Set and Cemented at 304 feet
Multiple Stage Cementing Collar Used? Yes No
If yes, show depth set.....feet
If alternate 2 completion, cement circulated
from.....feet depth to.....w/.....SX cmt
Cement Company Name.....
Invoice #.....

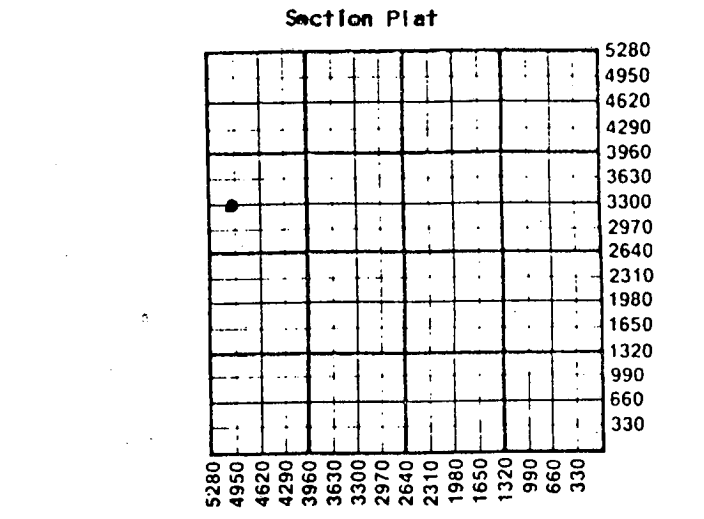

WATER SUPPLY INFORMATION
Disposition of Produced Water: Disposal
Docket #..... Repressuring

Questions on this portion of the ACO-1 call:
Water Resources Board (913) 296-3717
Source of Water:
Division of Water Resources Permit # 10637
X Groundwater.....Ft North from Southeast Corner
(Well)Ft West from Southeast Corner of
Sec 8 Twp 10S Rge 33 East X West
Surface Water.....Ft North from Southeast Corner
(Stream, pond etc).....Ft West from Southeast Corner
Sec Twp Rge East West
Other (explain).....
(purchased from city, R.W.D. #)

INSTRUCTIONS: This form shall be completed in triplicate and filed with the Kansas Corporation Commission, 200 Colorado Derby Building, Wichita, Kansas 67202, within 120 days of the spud date of any well. Rule 82-3-130, 82-3-107 and 82-3-106 apply. Information on side two of this form will be held confidential for a period of 12 months if requested in writing and submitted with the form. See rule 82-3-107 for confidentiality in excess of 12 months. One copy of all wireline logs and drillers time log shall be attached with this form. Submit CP-4 form with all plugged wells. Submit CP-111 form with all temporarily abandoned wells.

All requirements of the statutes, rules and regulations promulgated to regulate the oil and gas industry have been fully complied with and the statements herein are complete and correct to the best of my knowledge.

Signature William R. Horigan
Title Kansas Operations Manager Date 6-18-87

Subscribed and sworn to before me this 18th day of June 1987
Notary Public Elizabeth Cochran
Date Commission Expires.....

ELIZABETH COCHRAN
NOTARY PUBLIC
STATE OF KANSAS
My Appt. Exp. 7-8-90

K.C.C. OFFICE USE ONLY
Letter of Confidentiality Attached
Wireline Log Received
Drillers Time Log Received
Distribution
KCC NGPA
KGS STATE PLUGGING COMMISSION Other
6-30-87 (Specify)
JUN 30 1987
Form ACO-1 (5-86)

Sec. 8 Twp. 10S Rge. 33 W