

CONFIDENTIAL

SIDE ONE

STATE CORPORATION COMMISSION OF KANSAS
OIL & GAS CONSERVATION DIVISION
WELL COMPLETION OR RECOMPLETION FORM
ACO-1 WELL HISTORY
DESCRIPTION OF WELL AND LEASE

API NO. 15-193-20,436-0000
County Thomas
SW SW NE Sec 24 Twp 10S Rge 33 East
X West

2900
2970 Ft North from Southeast Corner of Section
2310 Ft West from Southeast Corner of Section
2310
2310 (Note: Locate well in section plat below)

Operator: License # 5181
Name Donald C. Slawson
Address 104 S. Broadway
200 Douglas Bldg.
City/State/Zip Wichita, KS 67202

Purchaser Inland Purchasing

Operator Contact Person William R. Horigan
Phone (316) 263-3201

Contractor: License # 5657
Name Slawson Drilling Company

Wellsite Geologist George Mueller
Phone

Designate Type of Completion
X New Well Re-Entry Workover

X Oil SWD Temp Abd
Gas Inj Delayed Comp.
Dry Other (Core, Water Supply etc.)

If OMNO: old well info as follows:
Operator
Well Name
Comp. Date Old Total Depth

WELL HISTORY

Drilling Method:
X Mud Rotary Air Rotary Cable
5-8-87 5-20-87 6-10-87
Spud Date Date Reached TD Completion Date
4735' 4690'
Total Depth PBTD

Amount of Surface Pipe Set and Cemented at 280 feet
Multiple Stage Cementing Collar Used? XX Yes No
If yes, show depth set 2635 feet
If alternate 2 completion, cement circulated from 2635 feet depth to surface w/ 350sx cmt
Cement Company Name Allied Cementing Co.
Invoice # 49455

Lease Name G & S Investment "E" Well # 1
Field Name Unnamed Riverford West
Producing Formation Lansing-KC
Elevation: Ground 3119' KB 3125'

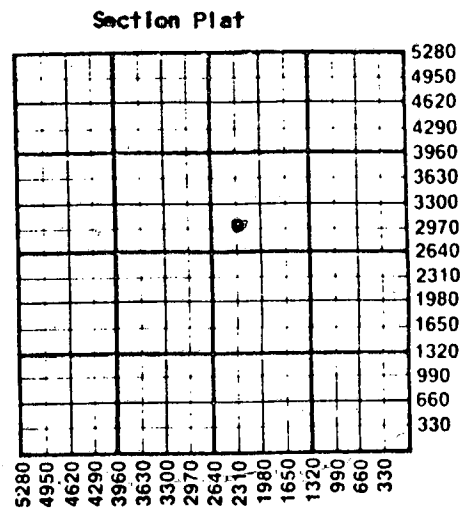

WATER SUPPLY INFORMATION
Disposition of Produced Water: X Disposal
Docket # D-18,344 Repressuring

Questions on this portion of the ACO-1 call:
Water Resources Board (913) 296-3717
Source of Water:
Division of Water Resources Permit # 13-000-241
X Groundwater Ft North from Southeast Corner (Well) Ft West from Southeast Corner of SE/4 Sec 10 Twp 10S Rge 33 East X West
Surface Water Ft North from Southeast Corner (Stream, pond etc) Ft West from Southeast Corner Sec Twp Rge East West
Other (explain) (purchased from city, R.W.D. #)

INSTRUCTIONS: This form shall be completed in triplicate and filed with the Kansas Corporation Commission, 200 Colorado Derby Building, Wichita, Kansas 67202, within 120 days of the spud date of any well. Rule 82-3-130, 82-3-107 and 82-3-106 apply. Information on side two of this form will be held confidential for a period of 12 months if requested in writing and submitted with the form. See rule 82-3-107 for confidentiality in excess of 12 months. One copy of all wireline logs and drillers time log shall be attached with this form. Submit CP-4 form with all plugged wells. Submit CP-111 form with all temporarily abandoned wells.

All requirements of the statutes, rules and regulations promulgated to regulate the oil and gas industry have been fully complied with and the statements herein are complete and correct to the best of my knowledge.

Signature William R. Horigan
Title Kansas Operations Manager Date 8-24-87

Subscribed and sworn to before me this 24th day of August 1987
Notary Public Jacqueline J. Scheck
Date Commission Expires July 28, 1990

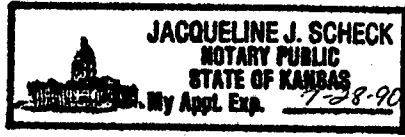

K.C.C. OFFICE USE ONLY
F Letter of Confidentiality Attached
C Wireline Log Received
C Drillers Timelog Received
Distribution
X KCC RSWD/REP NGPA
X KGS STATE CORPORATION COMMISSION Other
9-11-87 (Specify)
SEP 14 1987
CONSERVATION DIVISION
Form ACO-1a(5-86)

Sec 24 Twp 10S Rge 33E

~~CONFIDENTIAL~~

Operator Name Donald C. Slawson Lease Name Investment "E" Well #..... 1.....

Sec..... 24 Twp..... 10S Rge..... 33W East West County..... Thomas

WELL LOG

INSTRUCTIONS: Show important tops and base of formations penetrated. Detail all cores. Report all drill stem tests giving interval tested, time tool open and closed, flowing and shut-in pressures, whether shut-in pressure reached static level, hydrostatic pressures, bottom hole temperature, fluid recovery, and flow rates if gas to surface during test. Attach extra sheet if more space is needed. Attach copy of log.

Drill Stem Tests Taken Yes No
Samples Sent to Geological Survey Yes No
Cores Taken Yes No

Formation Description
 Log Sample

Name	Top	Bottom
ANHY	2614	(+511)
B/ANHY	2642	(+483)
HEEB	4018	(-893)
TOR	4038	(-913)
LANS	4058	(-933)
MUN CR	4192	(-1067)
STK	4278	(-1153)
BKC	4336	(-1211)
MARM	4368	(-1243)
PAW	4478	(-1353)
FS	4534	(-1409)
L/CHER	4561	(-1436)
JZ	4605	(-1480)
MISS	4653	(-1528)
LTD	4735	(-1610)

DST. #1: 3968-3989 (OREAD)
Straddle Packers
@ 4105' circ. for samp. Had DST. #1.
1° dev. @ 4052'. Pipe strap - 4068.09,
board - 4066.91, diff. 1.18.
DST. #1: 3968-3989 (OREAD)
STRAD. PKRS. 30-45-45-60 SBTO. Rec. 1630'
SW. IFP: 42-428, FFP: 428-763, ISIP: 1182,
FSIP: 1182.
DST. #2: 4076-4105 (35')
Drlg. @ 4135'. Had DST. #2 & 3.
DST. #2: 4076-4105 (35')
30-45-45-60 FB incr. to SB. Rec. 5' OCM,
333' O Spkd SW, 10' Mud w/Oil Spks.
IFP: 25-92, FFP: 92-185, ISIP: 1165, "
FSIP: 1148.
DST. #3: 4098-4117 (50')
30-20-20-20 Wk. Bl. Decr. Rec. 40' MSW/
SSO, 10' Mud/SSO. IFP: 25-34, FFP: 34-42,
ISIP: 888, FSIP: 821.

CASING RECORD <input checked="" type="checkbox"/> New <input type="checkbox"/> Used							
Report all strings set-conductor, surface, intermediate, production, etc.							
Purpose of String	Size Hole Drilled	Size Casing Set (in O.D.)	Weight Lbs/Ft.	Setting Depth	Type of Cement	#Sacks Used	Type and Percent Additives
Surface	12-1/4"	8-5/8"	24#	280'	60/40 poz	190	2% gel
Production		4-1/2"	10.5#	4734'	50/50 poz	275	18% salt
DV Tool		4-1/2"		2635'	Lite	350	
PERFORATION RECORD				Acid, Fracture, Shot, Cement Squeeze Record			
Shots Per Foot	Specify Footage of Each Interval Perforated			(Amount and Kind of Material Used)		Depth	
2 JSPF	4211-4213'			250 gal 7-1/2% MCA, displ. w/ 74 bbl brine.		4211-13'	
TUBING RECORD				Liner Run <input type="checkbox"/> Yes <input checked="" type="checkbox"/> No			
Date of First Production		Size	Set At	Packer at			
6-2-87		2-3/8"	4224'	N/A			
Date of First Production		Producing Method					
6-2-87		<input type="checkbox"/> Flowing <input checked="" type="checkbox"/> Pumping <input type="checkbox"/> Gas Lift <input type="checkbox"/> Other (explain).....					
Estimated Production Per 24 Hours		Oil	Gas	Water	Gas-Oil Ratio	Gravity	
Per 24 Hours		24 Bbls	TSTM MCF	81 Bbls		31.5°	

METHOD OF COMPLETION Vented Open Hole Perforation
 Soid Other (Specify) 4211-4213'.....
 Used on Lease Dually Completed
 Commingled

~~CONFIDENTIAL~~

15-193-20436-0000

Drill Stem Test (continued)
Donald C. Slawson
G&S Investment "E" #1

DST. #4: 4125-4140 (70')
30-20-20-20 WBTO Rec. 20' Mud/NS. IFP: 20-25
FFP: 25-34, ISIP: 1198, FSIP: 1173.
DST. #5: 4185-4250 (140', 160')
30-45-45-60 SBT0. Rec. 248' GIP, 930' TF.
248' Mdy Oil, 124' SOCM (10%O, 87%M, 3%W)
124' SOCMW, 124' MSW, 310' SW. IFP: 59-243,
FFP: 243-445, ISIP: 1333, FSIP: 1316.
CCL-32,000, SYS-9,000.

DST. #6: 4218-4250 (160')
30-45-45-60 Str. Bl. Rec. 73' TF. 5' Mud, 10' FO.
558'W, CHL-37,000, SYS-11,000. IFP: 34-143,
FFP: 143-277, ISIP: 1291, FSIP: 1274.
DST. #7: 4264-4282 (180')
30-45-45-60 Str. Bl. Rec. 35' OCWM
40%O, 55%M, 5%W) 1330' SO&GCW (2%)
36,000 CHL. IFP: 34-344, FFP: 344-637.
ISIP: 1224, FSIP: 1164.
@ 4340' LD test tool. Had DST. #8 & 9.
DST. #8: 4275-4340 (200, 220')
30-45-45-60 Str. Bl. Rec. 189' OCM (8%)
248' SW, 35,000 CCL. IFP: 42-126, FFP: 126-235,
ISIP: 1308, FSIP: 1266.
DST. #9: 4185-4218 Straddle Packer (140')
30-45-45-60 Str. Bl. Rec. 248' GIP,
275' TF. 90' CGO, 33.6 GR @ 60°. 185'
Gsy Mdy Oil (12%G, 48%O, 40%M)
(54%O, 46%M)
(60%O, 40%M)
No water. IFP: 34-76, FFP: 76-143, ISIP: 1333
FSIP: 1333 Sli Damage.
@ 4575' TOOH for DST. #10.
DST. #10: 4385-4575 (ALTA 'B', PAW, MYR ST. FS)
Drlg. @ 4664'. Had DST. #10 & 11.
DST. #10: 4385-4575 (ALTA 'B', PAW, MYR ST, FS)
30-20-20-20 Wk bl. - died. Rec. 25' Mud/SSO.
IFP: 104-114, FFP: 114-114, ISIP: 218, FSIP: 146
DST #11: 4559-4650 (JZ)
30-20-20-20 WBTO. Rec. 25' SOCM (5%).
IFP: 52-62, FFP: 62-62, ISIP: 94, FSIP: 83.

RECEIVED
STATE CORPORATIONS COMMISSION

SEP 11 1987

CONSERVATION DIVISION
Wichita, Kansas

RECEIVED
STATE CORPORATIONS COMMISSION

1987

CONSERVATION DIVISION
Wichita, Kansas