

STATE OF KANSAS  
STATE CORPORATION COMMISSION

15-193-20161-00-00

WELL PLUGGING RECORD

Give All Information Completely  
Make Required Affidavit  
Mail or Deliver Report to  
Conservation Division  
State Corporation Comm.  
245 North Water  
Wichita, KS 67202

Thomas County. Sec. 27 Twp. 10S Rge. 32 E/W  
Location as "NE/CNW $\frac{1}{4}$ SW $\frac{1}{4}$ " or footage from lines

C NE SE  
Lease Owner Abercrombie Drilling, Inc.  
Lease Name Smith Well No. 1

Office Address 801 Union Center, Wichita, Kansas 67202  
Character of Well (Completed as Oil, Gas or Dry Hole)  
Dry Hole

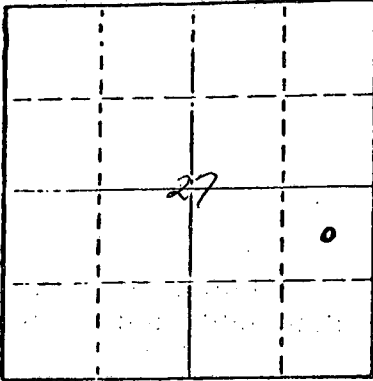

Locate well correctly on above  
Section Plat

Date Well completed March 26 1978  
Application for plugging filed (verbally) March 26 1978  
Application for plugging approved (verbally) March 26 1978  
Plugging commenced March 26 1978  
Plugging completed March 26 1978

Reason for abandonment of well or producing formation  
No commercial quantity of oil or gas encountered  
If a producing well is abandoned, date of last production 19

Was permission obtained from the Conservation Division or  
its agents before plugging was commenced? Yes

Name of Conservation Agent who supervised plugging of this well Gilbert Balthazor  
Producing formation \_\_\_\_\_ Depth to top \_\_\_\_\_ Bottom \_\_\_\_\_ Total Depth of Well 4660  
Show depth and thickness of all water, oil and gas formations.

OIL, GAS OR WATER RECORDS

RECEIVED  
STATE CORPORATION COMMISSION

CASING RECORD

FORMATION	STATE	CONTENT	FROM	TO	SIZE	PUT IN	PULLED OUT

APR 04 1978  
04-04-1978  
CONSERVATION DIVISION  
Wichita, Kansas

Describe in detail the manner in which the well was plugged, indicating where the mud fluid  
was placed and the method or methods used in introducing it into the hold. If cement or other  
plugs were used, state the character of same and depth placed, from \_\_\_\_\_ feet to  
\_\_\_\_\_ feet for each plug set.

Set 1st plug at 720' with 70 sacks  
2nd plug at 240' with 20 sacks  
40' solid bridge with 10 sacks

(If additional description is necessary, use BACK of this sheet)

Name of Plugging Contractor Abercrombie Drilling, Inc.

STATE OF Kansas COUNTY OF Sedgwick ss.  
Jack L. Partridge, Ass't. Sec.-Treas. (employee of owner) or (owner or operator) of the above-described  
well, being first duly sworn on oath, says: That I have knowledge of the facts, statements, and matters herein contained and the log of the  
above-described well as filed and that the same are true and correct. So help me God.

(Signature) *Jack L. Partridge*  
801 Union Center, Wichita, Kansas 67202  
(Address)



July 21, 1979

Subscribed and sworn to before me this 3rd day of April 1978  
*Sandra Richman*  
Sandra Richman Notary Public.

**IMPORTANT**  
 Kans. Geo. Survey request  
 samples on this well.

**KANSAS DRILLERS LOG**

S. 27 T. 10 R. 32 <sup>N</sup>/<sub>W</sub>

API No. 15 — 193 — 20,161-00-00  
County Number

Loc. NE SE

County Thomas

Operator  
Abercrombie Drilling, Inc.

Address  
801 Union Center Wichita, Kansas 67202

Well No. #1 Lease Name Smith

Footage Location  
 feet from (N) (S) line \_\_\_\_\_ feet from (E) (W) line \_\_\_\_\_

Principal Contractor Abercrombie Drilling, Inc. Geologist \_\_\_\_\_

Spud Date March 14, 1978 Total Depth 4660 P.B.T.D. \_\_\_\_\_

Date Completed March 26, 1978 Oil Purchaser \_\_\_\_\_

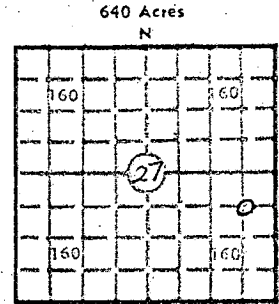

Elev.: Gr. 3026

DF 3029 KB 3031

**CASING RECORD**

Report of all strings set — surface, intermediate, production, etc.

Purpose of string	Size hole drilled	Size casing set (in O.D.)	Weight lbs./ft.	Setting depth	Type cement	Sacks	Type and percent additives
Surface	12 1/4"	8-5/8"	28#	268.87	Common	190	2% gel 3% CaCl

**LINER RECORD**

**PERFORATION RECORD**

Top, ft.	Bottom, ft.	Sacks cement	Shots per ft.	Size & type	Depth interval

**TUBING RECORD**

Size	Setting depth	Packer set at

**ACID, FRACTURE, SHOT, CEMENT SQUEEZE RECORD**

Amount and kind of material used	Depth interval treated

**RECEIVED**  
 STATE CORPORATION COMMISSION  
 APR 04 1978  
 04-04-1978  
 CONSERVATION DIVISION  
 Wichita, Kansas

**INITIAL PRODUCTION**

Date of first production \_\_\_\_\_ Producing method (flowing, pumping, gas lift, etc.) \_\_\_\_\_

RATE OF PRODUCTION PER 24 HOURS	Oil	Gas	Water	Gas-oil ratio
	bbls.	bbls.	MCF	CFPB

Disposition of gas (vented, used on lease or sold) \_\_\_\_\_ Producing interval(s) \_\_\_\_\_

INSTRUCTIONS: As provided in KCC Rule 82-2-125, within 90 days after completion of a well, one completed copy of this Drillers Log shall be transmitted to the State Geological Survey of Kansas, 4150 Monroe Street, Wichita, Kansas 67209. Copies of this form are available from the Conservation Division, State Corporation Commission, 3830 So. Meridian (P.O. Box 17027), Wichita, Kansas 66217. Phone AC 316-522-2206. If confidential custody is desired, please note Rule 82-2-125. Drillers Logs will be on open file in the Oil and Gas Division, State Geological Survey of Kansas, Lawrence, Kansas 66044.

Operator: Abercrombie Drilling, Inc. 15-193-20161-0000  
 DESIGNATE TYPE OF COMP.: OIL, GAS, DRY HOLE, SWDW, ETC.: Dry Hole

Well No. 1 Lease Name Smith

s 27 T 10S R 32 <sup>EX</sup> W

**WELL LOG**  
 Show all important zones of porosity and contents thereof; cored intervals, and all drill-stem tests, including depth interval tested, cushion used, time tool open, flowing and shut-in pressures, and recoveries.  
 SHOW GEOLOGICAL MARKERS, LOGS RUN, OR OTHER DESCRIPTIVE INFORMATION.

FORMATION DESCRIPTION, CONTENTS, ETC.	TOP	BOTTOM	NAME	DEPTH
Sand & shale	0	2398	SAMPLE TOPS:	
Shale & shells	2398	2568		
Anhydrite	2568	2604	Anhydrite	2568 (+ 463)
Shale & shells	2604	2898	B/Anhydrite	2604 (+ 427)
Lime & shale	2898	3107	Heebner	3986 (- 955)
Shale & lime	3107	3665	Toronto	4008 (- 977)
Lime & shale	3665	4115	Lansing	4027 (- 996)
Shale & lime	4115	4190	B/KC	4306 (-1275)
Lime & shale	4190	4195	Marmaton	4335 (-1304)
Lime	4195	4245	Pawnee	4433 (-1402)
Shale & lime	4245	4270	Ft. Scott	4497 (-1466)
Shale	4270	4369		
Shale & lime	4369	4480		
Lime	4480	4660	ELECTRIC LOG TOPS:	
Rotary Total Depth		4660		
DST#1 (4040-4070) 30", 45", 30", 45". Weak blow 30". Rec.			Anhydrite	2567 (+ 464)
20' mud. IFP 10-16, IBHP 1289, FFP 1278,			Heebner	3985 (- 954)
DST#2 (4070-4115) 30", 45", 60", 45". Good blow. Rec. 731'			Toronto	4008 (- 977)
water. IFP 53-150, IBHP 1236, FFP 204-334, FBHP 1204.			Lansing	4021 (- 990)
DST#3 (4150-4195) 30", 45", 60", 95". Weak blow. Rec. 10'			Stark Shale	4245 (-1214)
ocm, 120' soc watery mud. IFP 32-38, IBHP 1331,			B/KC	4308 (-1277)
FFP 53-75, FBHP 1289.			Marmaton	4348 (-1307)
DST#4 (4200-4245) 30", 45", 60", 45". Good blow. Rec. 300'			Pawnee	4430 (-1399)
gip, 105' mo, IFP 39-52, IBHP 330,			Ft. Scott	4498 (-1467)
FFP 66-79, FBHP 925.			Cherokee	4526 (-1495)
DST#5 PACKER FAILURE			Miss.	4612 (-1581)
DST#6 (4240-4270) 30", 30", 30", 30". Weak blow 15". Rec.			LTD	4663
20' mud. IBHP 355, FFP 86-86, FBHP 665,				
DST#7 (4532-4590) 30", 30", 30", 30". Weak blow 15". Rec.			RTD	4660
10' mud. IFP 21-21, IBHP 43, FFP 43-43, FBHP 43.				

STATE RECEIVED CORPORATION COMMISSION  
 APR 04 1978

CONSERVATION DIVISION  
 Wichita, Kansas

USE ADDITIONAL SHEETS, IF NECESSARY, TO COMPLETE WELL RECORD.

Date Received \_\_\_\_\_  
 Signature: Jack L. Partridge  
 Title: Jack L. Partridge, Ass't. Secretary-Treasurer  
 Date: April 3, 1978