

Give All Information Completely  
Make Required Affidavit  
Mail or Deliver Report to:  
Conservation Division  
State Corporation Commission  
212 North Market, Insurance Bldg.  
Wichita, Kansas

NORTH

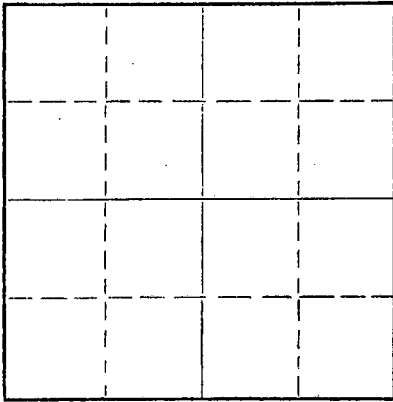

Locate well correctly on above  
Section Plat

Thomas County. Sec. 24 Twp. 10S Rge. (E) 34 (W)  
Location as "NE/CNW&SW¼" or footage from lines NW NW  
Lease Owner JOHN O. FARMER, INC.  
Lease Name BERTRAND Well No. 1  
Office Address Russell, Kansas  
Character of Well (completed as Oil, Gas or Dry Hole) Dry  
Date well completed 12/30 1959  
Application for plugging filed 12/30 1959  
Application for plugging approved 12/30 1959  
Plugging commenced 12/30 1959  
Plugging completed 12/30 1959  
Reason for abandonment of well or producing formation Dry

If a producing well is abandoned, date of last production 19  
Was permission obtained from the Conservation Division or its agents before plugging was commenced? yes

Name of Conservation Agent who supervised plugging of this well Fabricius, Hill City, Kansas  
Producing formation \_\_\_\_\_ Depth to top \_\_\_\_\_ Bottom \_\_\_\_\_ Total Depth of Well 4820 Feet  
Show depth and thickness of all water, oil and gas formations.

OIL, GAS OR WATER RECORDS

CASING RECORD

FORMATION	CONTENT	FROM	TO	SIZE	PUT IN	PULLED OUT
				8-5/8"	213'	None

Describe in detail the manner in which the well was plugged, indicating where the mud fluid was placed and the method or methods used in introducing it into the hole. If cement or other plugs were used, state the character of same and depth placed, from \_\_\_\_\_ feet to \_\_\_\_\_ feet for each plug set.

First plug set at 500 feet with 20 sacks cement

Second plug set at 210 feet with 20 sacks cement

Third plug set at 40 feet with 10 sacks cement

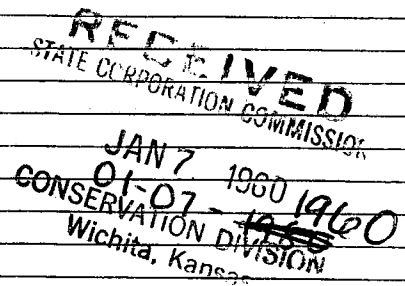

(If additional description is necessary, use BACK of this sheet)  
Name of Plugging Contractor JOHN O. FARMER, INC.  
Address Russell, Kansas

STATE OF KANSAS, COUNTY OF RUSSELL, ss.  
I, JOHN O. FARMER (employee or owner) or (owner or operator) of the above-described well, being first duly sworn on oath, says: That I have knowledge of the facts, statements, and matters herein contained and the log of the above-described well as filed and that the same are true and correct. So help me, God.

(Signature) John O. Farmer  
Russell, Kansas (Address)

SUBSCRIBED AND SWORN TO before me this 31st day of December, 19 59

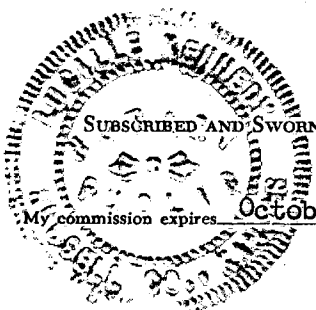

Lucille Kennedy  
Lucille Kennedy Notary Public.

ADDRESS Russell, Kansas

Give detailed description and thickness of all formation drilled through, contents of sand, whether dry, water, oil or gas.

WELL NO. BERTRAND COUNTY Thomas SEC. 24 TWP. 10S RGE. 34W

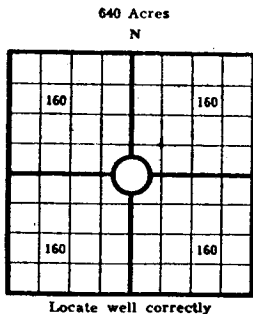

COUNTY Thomas, SEC. 24, TWP. 10S, RGE. 34W  
 COMPANY OPERATING JOHN O. FARMER, INC.  
 OFFICE ADDRESS Russell, Kansas  
 DRILLING STARTED 12/12/59 DRILLING FINISHED 12/30/59  
 DATE OF FIRST PRODUCTION \_\_\_\_\_ COMPLETED \_\_\_\_\_  
 WELL LOCATED NW 1/4 NW 1/4, North of South  
 Line and \_\_\_\_\_ ft. East of West Line of Quarter Section  
 Elevation (Relative to sea level) DERRICK FLOOR 3178 GROUND 3175  
 CHARACTER OF WELL (Oil, gas or dryhole) Dry

OIL OR GAS SANDS OR ZONES

Name	From	To	Name	From	To
1			4		
2			5		
3			6		

Perforating Record If Any

Shot Record

Formation	From	To	No. of Shots	Formation	From	To	Size of Shot

CASING RECORD

Amount Set						Amount Pulled		Packer Record	
Size	Wt.	Thds.	Make	Ft.	In.	Size	Length	Depth Set	Make
8-5/8				213					

Liner Record: Amount \_\_\_\_\_ Kind \_\_\_\_\_ Top \_\_\_\_\_ Bottom \_\_\_\_\_

CEMENTING AND MUDDING

Size	Amount Set		Sacks Cement	Chemical		Method of Cementing	Amount	Mudding Method	Results (See Note)
	Ft.	In.		Gal.	Make				
8-5/8	213		150						

Note: What method was used to protect sands if outer strings were pulled? \_\_\_\_\_

NOTE: Were bottom hole plugs used? \_\_\_\_\_ If so, state kind, depth set and results obtained \_\_\_\_\_

TOOLS USED

Rotary Tools were used from \_\_\_\_\_ feet to \_\_\_\_\_ Cable tools were used from \_\_\_\_\_ feet to \_\_\_\_\_ feet, and from \_\_\_\_\_ feet to \_\_\_\_\_ feet, and from \_\_\_\_\_ feet to \_\_\_\_\_ feet to \_\_\_\_\_

Type Rig \_\_\_\_\_

INITIAL PRODUCTION TEST

Describe initial test: whether by flow through tubing or casing or by pumping \_\_\_\_\_

Amount of Oil Production \_\_\_\_\_ bbls. Size of choke, if any \_\_\_\_\_ Length of test \_\_\_\_\_ Water

Production \_\_\_\_\_ bbls. Gravity of oil \_\_\_\_\_ Type of Pump if pump is used, describe \_\_\_\_\_

Formation	Top	Bottom	Formation	Top	Bottom
Sand shale	0	213	FARM NAME:		
Shale	213	313	BERTRAND #1		
Shale & sand	315	1200	ELEVATION:	RB	3178
Shale & shells	1200	1665	sample		log
Shale, shells & sand	1665	1900	Anhydrite	2690	<del>2690</del>
Shale & shells	1900	2435	Topeka		3922
Shale, shells & redbed	2435	2580	Heebner	4080	4078
Shale, lime & redbed	2580	2690	Toronto	4103	4102
Anhydrite	2690	2720	Lansing	4124	4116
Lime & shale	2720	2735	B/KC	4410	4420
Lime shale	2735	3100	Cherokee	4590	4590
Shale & lime	3100	3510	Mississippi	4741	4742
Lime	3510	3565	T.D.	4820	4820
Shale & lime	3565	4095			
Lime & shale	4095	4210			
Lime	4210	4525			
Lime & shale	4525	4560	D & A		
Lime	4560	4606			
Cherokee	4606	4618			
Lime & shale	4618	4655			
Cherokee	4655	4685			
Lime & shale	4685	4815			
Mississippi	4815	4820			
T.D.		4820			

I, the undersigned, being first duly sworn upon oath, state that this well record is true, correct and complete according to the records of this office and to the best of my knowledge and belief.

*John O. Farmer*  
 Name and title of representative of company

Subscribed and sworn to before me this 31st day of December, 1959

My Commission expires 10/11/62  
*Quinn Lennett*  
 Notary Public.

JAN 7 1960  
 01-07-1960  
 CONSERVATION DIVISION  
 Wichita, Kansas