

STATE CORPORATION COMMISSION OF KANSAS
OIL & GAS CONSERVATION DIVISION

WELL COMPLETION OR RECOMPLETION FORM
ACO-1 WELL HISTORY

DESCRIPTION OF WELL AND LEASE

Operator: license # 5063
name Energy Exploration, Inc.
address 1002 So. Broadway
City/State/Zip Wichita, KS 67201

Operator Contact Person Brad Lehl
Phone (316) 267-7336

Contractor: license # 5422
name Abercrombie Drilling, Inc.

Wellsite Geologist Mark Torr
Phone (913) 628-3131

Designate Type of Completion
 New Well Re-Entry Workover

Oil SWD Temp Abd
 Gas Inj Delayed Comp.
 Dry Other (Core, Water Supply etc.)

If OWWO: old well info as follows:
Operator N/A
Well Name
Comp. Date Old Total Depth

WELL HISTORY

Drilling Method: Mud Rotary Air Rotary Cable

12/06/84 12/14/84 12/15/84
Spud Date Date Reached TD Completion Date
4600
Total Depth PBTD

Amount of Surface Pipe Set and Cemented at 298' feet

Multiple Stage Cementing Collar Used? Yes No

If Yes, Show Depth Set feet

If alternate 2 completion, cement circulated
from feet depth to w/ SX cmt

API NO. 15-193-20,335-0000

County Thomas

NE SE NE Sec 34 Twp 10S Rge 31 West

Ft North from Southeast Corner of Section
Ft West from Southeast Corner of Section
(Note: locate well in section plat below)

Lease Name J.R. Well# 1

Field Name N/A

Producing Formation N/A

Elevation: Ground 2930' KB 2935'

Section Plat

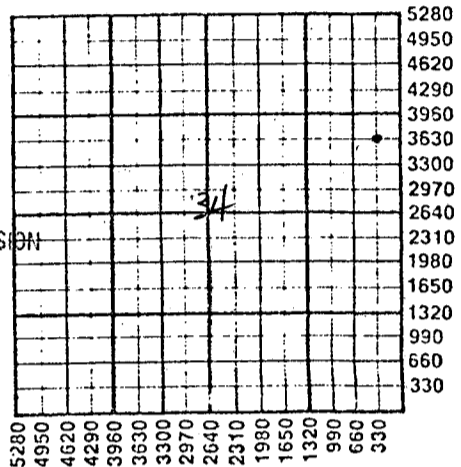

RECEIVED
STATE CORPORATION COMMISSION

MAR 28 1985

CONSERVATION DIVISION
Wichita, Kansas

WATER SUPPLY INFORMATION

Source of Water:
Division of Water Resources Permit #

Groundwater 3740' Ft North From Southeast Corner and
(Well) 1770' Ft. West From Southeast Corner of
Sec 34 Twp 10S Rge 31 East West

Surface Water Ft North From Southeast Corner and
(Stream, Pond etc.) Ft West From Southeast Corner
Sec Twp Rge East West

Other (explain)
(purchased from city, R.W.D.#)

Disposition of Produced Water: Disposal Repressuring

Docket #

INSTRUCTIONS: This form shall be completed in duplicate and filed with the Kansas Corporation Commission, 200 Colorado Derby Building, Wichita, Kansas 67202, within 90 days after completion or recompletion of any well. Rules 82-3-130 and 82-3-107 apply.

Information on side two of this form will be held confidential for a period of 12 months if requested in writing and submitted with the form. See rule 82-3-107 for confidentiality in excess of 12 months.

One copy of all wireline logs and drillers time log shall be attached with this form. Submit CP-4 form with all plugged wells. Submit CP-111 form with all temporarily abandoned wells.

All requirements of the statutes, rules, and regulations promulgated to regulate the oil and gas industry have been fully complied with and the statements herein are complete and correct to the best of my knowledge.

Signature Joseph D. Mace
Title President Date 3-26-85

Subscribed and sworn to before me this 26th day of March 19 85

Notary Public Cheryl L. Idleman
Date Commission Expires 1-30-89

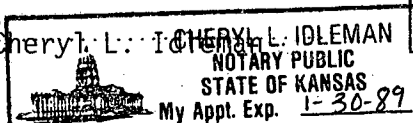

K.C.C. OFFICE USE ONLY
F Letter of Confidentiality Attached
C Wireline Log Received
C Drillers Timelog Received
Distribution
 KCC SWD Rep NGPA
 KGS Plug Other
(Specify)

Form ACO-1
(This form supercedes previous forms)

Sec. 34 Twp. 10S Rge. 31W

Operator Name Energy Exploration, Inc. Lease Name J.R. Well# 1 SEC. 34 TWP. 10S RGE. 31 East West

WELL LOG

INSTRUCTIONS: Show important tops and base of formations penetrated. Detail all cores. Report all drill stem tests giving interval tested, time tool open and closed, flowing and shut-in pressures, whether shut-in pressure reached static level, hydrostatic pressures, bottom hole temperature, fluid recovery, and flow rates if gas to surface during test. Attach extra sheet if more space is needed. Attach copy of log.

Drill Stem Tests Taken Yes No
 Samples Sent to Geological Survey Yes No
 Cores Taken Yes No

Formation Description
 Log Sample

	Name	Top	Bottom
DST #1 4032-60, 25-60-60-60, Rec. 90' of gas, 345' of sli. gsy. oil, 190' of sli. gsy. mdy. wtr.; IFP 67-118, FFP 153-255, ISIP 1285, FSIP 1231, IHP 2087, FHP 2053, BHT 117 'F	Anhydrite top	2486	+449
	Anhydrite bottom	2513	+422
	Topeka	3728	-793
	Heebner	3949	-1014
	Toronto	3973	-1038
DST #2 4168-96, 30-30-30-30, Rec. 5' of wtry. mud, IFP 41-41, FFP 44-44, ISIP 715, FSIP 623, IHP 2131, FHP 2126, BHT 110 'F	Lansing-K.C.	3995	-1060
	B/KC	4267	-1332
	Pawnee	4397	-1462
	Ft. Scott	4457	-1522
	Cherokee	4485	-1550
DST #3 4386-4451, 25-60-60-60, Rec. 153' of sli. oil cut mdy. wtr., IFP 68-455, FFP 477-766, ISIP 1098, FSIP 1077, IHP 2266, FHP 2233, BHT 127 'F	Mississippi	4593	-1658
	RTD	4600	-1665
DST #4 4054-76, 25-57-60-60, Rec. 890' of gas in pipe, 180' of cln. gsy. oil, 100' of oil & wtr. cut mud (65% M; 10% O; 25% W), IFP 36-72, FFP 87-130, ISIP 1284, FSIP 1234, IHP 2177, FHP 2077, BHT 110 'F			
DST #5 4414-42, 25-57-60-60, Rec. 1530' of sli. oil cut mdy. wtr., IFP 82-441, FFP 465-759, ISIP 1115, FSIP 1097, BHT 128 'F			

CASING RECORD <input checked="" type="checkbox"/> new <input type="checkbox"/> used							
Report all strings set-conductor, surface, intermediate, production, etc.							
Purpose of string	size hole drilled	size casing set (in O.D.)	weight lbs/ft.	setting depth	type of cement	# sacks used	type and percent additives
Surface	12 1/4"	8 5/8"	20#	298'	60-40 poz.	200	2% gel., 3% a.c.
PERFORATION RECORD				Acid, Fracture, Shot, Cement Squeeze Record			
shots per foot	specify footage of each interval perforated			(amount and kind of material used)			Depth
				N/A			
TUBING RECORD				Liner Run <input type="checkbox"/> Yes <input type="checkbox"/> No			
Date of First Production	Producing method			dry hole			
N/A	<input type="checkbox"/> flowing <input type="checkbox"/> pumping <input type="checkbox"/> gas lift <input type="checkbox"/> Other (explain)						
Estimated Production Per 24 Hours	Oil	Gas	Water	Gas-Oil Ratio	Gravity		
	Bbls	MCF	Bbls	CFPB	Dry hole		

Disposition of gas: vented open hole perforation
 sold other (specify)
 used on lease Dually Completed.
 Commingled

PRODUCTION INTERVAL
 N/A