

FROM : Pelican Hill Oil And Gas Inc PHONE NO. : 714 498 2101

FOR JAN 29 '93 14:37 ALLEN DRILLING CO.

FORM MUST BE TYPED  
FORM MUST BE STORED  
ALL BLANKS MUST BE FILLED

EFFECTIVE DATE: 2-7-93  
DISTRICT # 4  
SEAT: Yes

State of Kansas  
NOTICE OF INTENTION TO DRILL

Must be approved by the K.C.C. five (5) days prior to commencing well

Expected Spud Date: 1 month 5 day 1993 year

Spot NW SE SW Sec 23 Twp 11 S. Rg 16 X East

OPERATOR: License # 31120  
Name: PELICAN HILL OIL and GAS, INC.  
Address: 2139 Avenida Escada  
City/State/Zip: San Clemente, CA 92672  
Contact Person: Allen Cross  
Phone: 714-498-2101

990 feet from South / North line of Section  
1650 feet from East / West line of Section  
IS SECTION X REGULAR \_\_\_\_\_ IRREGULAR?

(NOTE: Locate well on the Section Plat on Reverse Side)  
County: Ellis  
Lease Name: BOWLBY Well #: L-2  
Field Name: R.C.B.  
Is this a Prorated/Spaced Field? yes X no  
Target Formation(s): Arbuckle  
Nearest lease or unit boundary: 990  
Ground Surface Elevation: 1770 feet  
Water well within one-quarter mile: yes X  
Public water supply well within one mile: yes X  
Depth to bottom of fresh water: 425  
Depth to bottom of usable water: 700  
Surface Pipe by Alternate: X 1 2  
Length of Surface Pipe Planned to be set: 990 770  
Length of Conductor pipe required: None  
Projected Total Depth: 3400  
Formation at Total Depth: Arbuckle  
Water Source for Drilling Operations:  
... well ... farm pond ... oth

CONTRACTOR: License # 5418  
Name: ALLEN DRILLING COMPANY

Well Drilled For:	Well Class:	Type Equipment:
<input checked="" type="checkbox"/> Oil	<input type="checkbox"/> Enh Rec	<input checked="" type="checkbox"/> Mud Rotary
<input type="checkbox"/> Gas	<input type="checkbox"/> Storage	<input type="checkbox"/> Pool Ext.
<input type="checkbox"/> OWD	<input type="checkbox"/> Disposal	<input type="checkbox"/> Wildcat
<input type="checkbox"/> Seismic	<input type="checkbox"/> # of Holes	<input type="checkbox"/> Cable
<input type="checkbox"/> Other	<input type="checkbox"/> Other	

If OWD, old well information as follows:  
Operator: N/A  
Well Name: \_\_\_\_\_  
Comp. Date: \_\_\_\_\_ Old Total Depth \_\_\_\_\_

Directional, Deviated or Horizontal wellbore? yes X no  
If yes, true vertical depth: \_\_\_\_\_  
Bottom Hole Location: \_\_\_\_\_

Permit #: \_\_\_\_\_  
Will Core be Taken? yes X no  
If yes, proposed zone: \_\_\_\_\_

**AFFIDAVIT**

The undersigned hereby affirms that the drilling, completion and eventual plugging of this well will comply with K.S.A. 101, et. seq.  
It is agreed that the following minimum requirements will be met:

1. Notify the appropriate district office prior to spudding of well.
2. A copy of the approved notice of intent to drill shall be posted on each drilling rig.
3. The minimum amount of surface pipe as specified below shall be set by circulating cement to the top; in all cases surface pipe shall be set through all unconsolidated materials plus a minimum of 20 feet into the underlying formation.
4. If the well is dry hole, an agreement between the operator and the district office on plug length and placement necessary prior to plugging.
5. The appropriate district office will be notified before well is either plugged or production casing is cemented in.
6. IF AN ALTERNATE IS COMPLETION, PRODUCTION PIPE SHALL BE CEMENTED FROM BELOW ANY USABLE WATER TO SURFACE WITHIN 120 DAYS OF SPUD DATE. IN ALL CASES, NOTIFY DISTRICT OFFICE PRIOR TO ANY CEMENTING.

I hereby certify that the statements made herein are true and to the best of my knowledge and belief.  
Date: 1-28-93 Signature of Operator or Agent: Allen Cross Title: President

FOR KCC USE:  
API # 15- 051-24,827-00-00  
Conductor pipe required None feet  
Minimum surface pipe required 770 feet per Alt. ① X  
Approved by: CB 2-2-93  
This authorization expires: 8-2-93  
(This authorization void if drilling not started within 6 months of effective date.)  
Spud date: \_\_\_\_\_ Agent: \_\_\_\_\_

**REMEMBER TO:**

- File Drill Pit Application (form CDP-1) with Intent to Drill;
  - File Completion form AGO-1 within 120 days of spud date;
  - File acreage attribution plat according to field proration orders;
  - Notify appropriate district office 48 hours prior to workover or re-entry;
  - Submit plugging report (CP-4) after plugging is completed;
  - Obtain written approval before disposing or injecting salt water.
- Well to: Conservation Division, 200 Colorado Derby Building, 202 W. First St., Wichita, Kansas 67202-1204.

JAN 29 '93 14:40 ALLEN DRILLING CO.

**IN ALL CASES PLOT THE INTENDED WELL ON THE PLAT BELOW**

**PLAT OF ACREAGE ATTRIBUTABLE TO A WELL IN A PRORATED OR SPACED FIELD**

If the intended well is in a prorated or spaced field, please fully complete this side of the form. If the intended well is in a prorated or spaced field complete the plat below showing that the well will be properly located in relationship to other wells producing from the common source of supply. Please show all the wells within 1 mile of the boundaries of the proposed acreage attribution unit for gas wells and within 1/2 mile of the boundaries of the proposed acreage attribution unit for oil wells.

API NO. 15- \_\_\_\_\_  
OPERATOR Pelican Hill Oil And Gas, Inc.  
LEASE Bowlby #L-2  
WELL NUMBER #L-2  
FIELD Chrisler Extension

LOCATION OF WELL: COUNTY Ellis  
990 feet from south north line of section  
1650 feet from east west line of section  
SECTION 23 TWP 11 RC 16

NUMBER OF ACRES ATTRIBUTABLE TO WELL 10  
QTR/QTR/QTR OF ACREAGE Nw Se Sw

IS SECTION X REGULAR or IRREGULAR  
IF SECTION IS IRREGULAR, LOCATE WELL FROM NEAR  
CORNER BOUNDARY.  
Section corner used: NE NW SE X

**PLAT**

(Show location of the well and shade attributable acreage for prorated or spaced well.)  
(Show footage to the nearest lease or unit boundary line.)

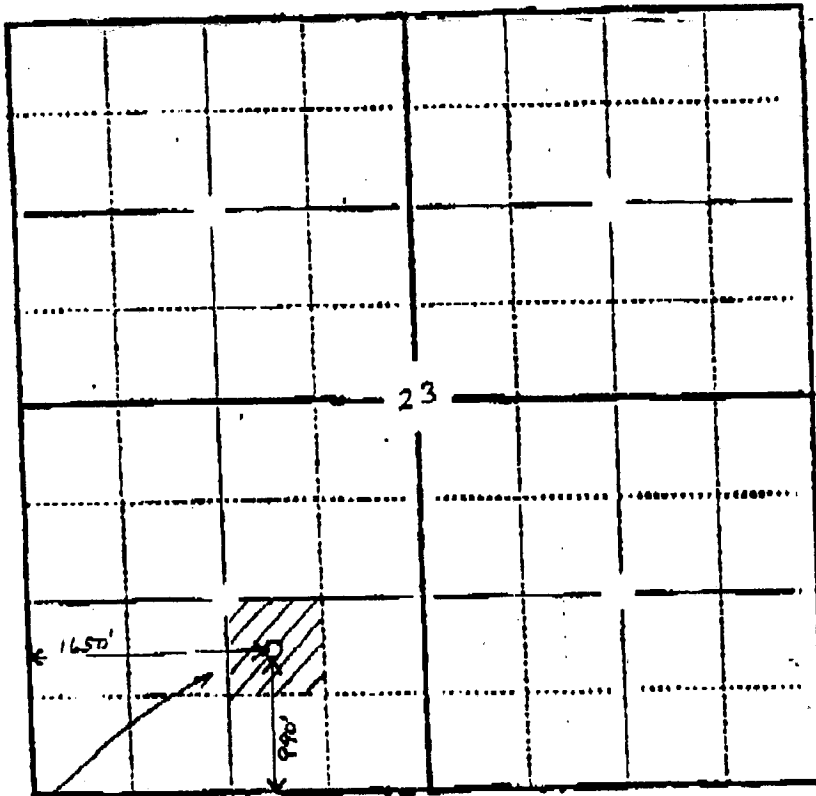

10 ACRES

ELLIS CO.

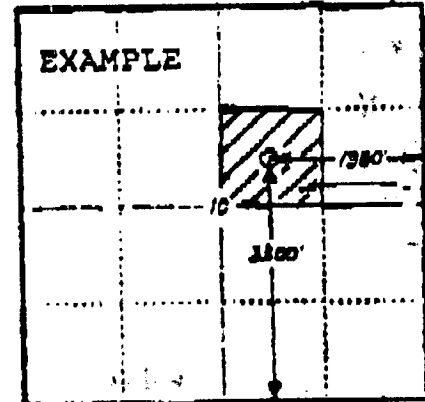

40 ACRES

SEWARD CO.

In plotting the proposed location of the well, you must show:

- 1) The manner in which you are using the depicted plat by identifying section lines, 1 section, 1 section with 8 surrounding sections, 4 sections, etc.;
- 2) the distance of the proposed drilling location from the section's south/north east/west lines; and