

EFFECTIVE DATE: 1-26-94  
DISTRICT #: 4  
SGA? Yes  No

State of Kansas  
**NOTICE OF INTENTION TO DRILL**

Must be approved by the K.C.C. five (5) days prior to commencing well

Expected Spud Date: February/15/1994  
month day year

Spot SE - NW - SW Sec 35 Twp 9 S, Rg 23 East  West

OPERATOR: License # 5034/5364 <sup>P.T. REC</sup>  
Name: Beren Corporation  
Address: 100 North Broadway, Suite 970  
City/State/Zip: Wichita, Kansas 67202-2209  
Contact Person: Leon Rodak  
Phone: 316.265.3311

1650 feet from South line of Section  
 4290 feet from East line of Section  
IS SECTION XX REGULAR IRREGULAR?  
(NOTE: Locate well on the Section Plat on Reverse Side)

County: Graham  
Lease Name: Diebolt Well #: 5  
Field Name: Law  
Is this a Prorated/Spaced Field? no  yes  no  
Target Formation(s): Lansing - Kansas City   
Nearest Lease or unit boundary: 990'  
Ground Surface Elevation: 2448 (estimated) feet MSL  
Water well within one-quarter mile:  yes  no  
Public water supply well within one mile:  yes  no  
Depth to bottom of fresh water: 180'  
Depth to bottom of usable water: 1320' / 1150'  
Surface Pipe by Alternate: 1  2  
Length of Surface Pipe Planned to be set: (250') 200'  
Length of Conductor pipe required: None  
Projected Total Depth: 3960'  
Formation at Total Depth: Marmaton  
Water Source for Drilling Operations: well  farm pond  other   
DWR Permit #: applied for  
Will Cores Be Taken?: yes  no  
If yes, proposed zone:

CONTRACTOR: License #: Unknown  
Name: Unknown

Well Drilled For: Well Class: Type Equipment:  
 Oil  Enh Rec  Infield  Mud Rotary  
 Gas  Storage  Pool Ext.  Air Rotary  
 OWWO  Disposal  Wildcat  Cable  
 Seismic; # of Holes  Other

OWWO: old well information as follows:  
Operator: \_\_\_\_\_  
Well Name: \_\_\_\_\_  
Comp. Date: \_\_\_\_\_ Old Total Depth \_\_\_\_\_

Directional, Deviated or Horizontal wellbore? yes  no   
yes, true vertical depth: \_\_\_\_\_  
Bottom Hole Location \_\_\_\_\_

**AFFIDAVIT**

The undersigned hereby affirms that the drilling, completion and eventual plugging of this well will comply with K.S.A. 55- et. seq.

It is agreed that the following minimum requirements will be met:

1. Notify the appropriate district office prior to spudding of well;
2. A copy of the approved notice of intent to drill shall be posted on each drilling rig;
3. The minimum amount of surface pipe as specified below shall be set by circulating cement to the top' in all cases surface pipe shall be set through all unconsolidated materials plus a minimum of 20 feet into the underlying formation;
4. If the well is dry hole, and agreement between the operator and the district office on plug length and placement is necessary prior to plugging;
5. The appropriate district office will be notified before well is either plugged or production casing is cemented in;
6. IF AN ALTERNATE II COMPLETION, PRODUCTION PIPE SHALL BE CEMENTED FROM BELOW ANY USABLE WATER SURFACE WITHIN 120 DAYS OF SPUD DATE. IN ALL CASES, NOTIFY DISTRICT OFFICE PRIOR TO ANY CEMENTING.

I hereby certify that the statements made herein are true and to the best of my knowledge and belief.

Date 1/18/94 Signature of Operator or Agent: [Signature] Title: Vice - President

FOR KCC USE:  
API # 15 065-22735  
Conductor pipe required NONE feet  
Minimum surface pipe required 200' feet per Alt.  2  
Approved by: CB 1-21-94  
This authorization expires: 2-21-94  
(This authorization void if drilling not started within 6 months of effective date.)  
Spud Date: \_\_\_\_\_ Agent: \_\_\_\_\_

**REMEMBER TO:**

- File Drill Pit Application (form CDP-1) with Intent to Drill;
- File Completion Form ACO-1 within 120 days of spud date;
- File acreage attribution plat according to filed proration orders;
- Notify appropriate district office 48 hours prior to workover or re-entry;
- Submit plugging report (CP-4) after plugging is completed;
- Obtain written approval before disposing or injecting salt water.

**RECEIVED**  
KANSAS CORPORATION, COMMISSION  
JAN 20 1994  
CONSERVATION DIVISION  
WICHITA, KS

35  
9  
23

**IN ALL CASES PLOT THE INTENDED WELL ON THE PLAT BELOW**

**PLAT OF ACREAGE ATTRIBUTABLE TO A WELL IN A PRORATED OR SPACED FIELD**

If the intended well is in a prorated or spaced field, please fully complete this side of the form. If the intended well is in a prorated or spaced field complete the plat below showing that the well will be properly located in relationship to other wells producing from the common source of supply. Please show all wells within 1 mile of the boundaries of the proposed acreage attribution unit for gas wells and within 1/2 mile of the boundaries of the proposed acreage attribution unit for oil wells.

API NO. 15- \_\_\_\_\_  
 OPERATOR Beren Corporation  
 LEASE Diebolt  
 WELL NUMBER 5  
 FIELD Law

NUMBER OF ACRES ATTRIBUTABLE TO WELL \_\_\_\_\_  
 QTR/QTR/QTR OF ACREAGE \_\_\_\_\_

LOCATION OF WELL: COUNTY Graham  
 1650 feet from South line of Section  
 4290 feet from East line of Section  
 SECTION 35 TWP 9 RG 23 W

IS SECTION XX REGULAR or IRREGULAR  
 IF SECTION IS IRREGULAR, LOCATE WELL FROM NEAREST  
 CORNER BOUNDARY.  
 Section corner used: NE NW SE SW

**PLAT**

(Show location of the well and shade attributable acreage for prorated or spaced wells.)  
 (Show footage to the nearest lease or unit boundary line.)

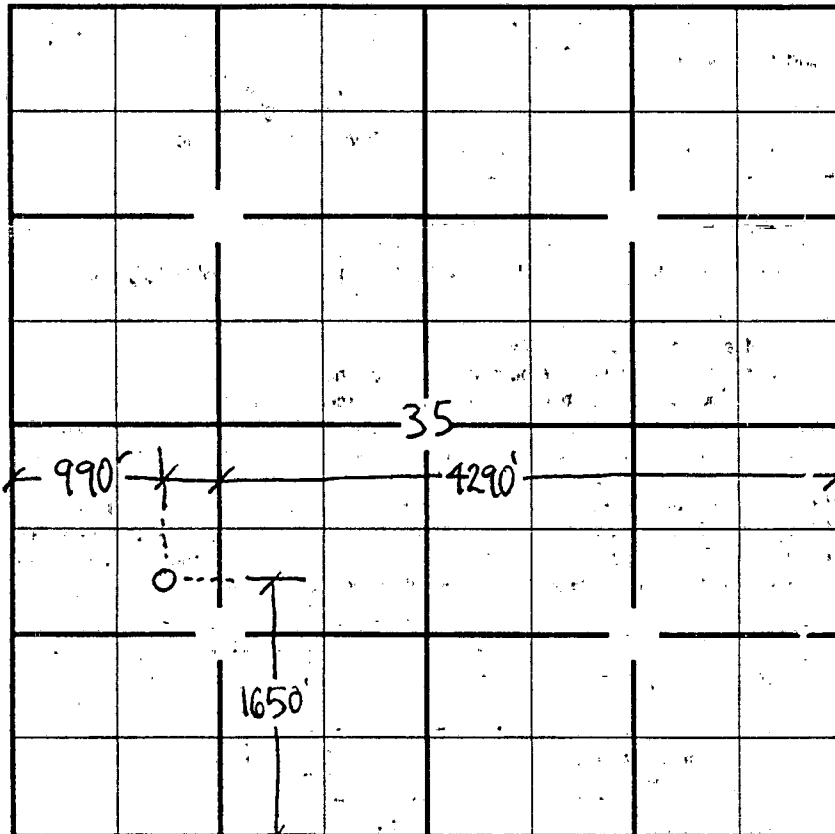

In plotting the proposed location of the well, you must show:

- (1) The manner in which you are using the depicted plat by identifying section lines, i.e. 1 section, 1 section with 8 surrounding section, 4 sections, etc.;
- (2) the distance of the proposed drilling location from the section's south/north and east/west lines; and
- (3) the distance to the nearest lease or unit boundary line.

**RECEIVED**  
 KANSAS CORPORATION COMMISSION

JAN 20 1994

CONSERVATION DIVISION  
 WICHITA, KS