

ORIGINAL

STATE CORPORATION COMMISSION OF KANSAS
OIL & GAS CONSERVATION DIVISION
WELL COMPLETION FORM
ACO-1 WELL HISTORY
DESCRIPTION OF WELL AND LEASE

Operator: License # 5447

Name: OXY USA, Inc.

Address P.O. Box 2528

City/State/Zip Liberal, KS 67905

Purchaser: _____

Operator Contact Person: Del Oliver

Phone (316) 629-4200

Contractor: Name: Cheyenne Drilling Inc

License: 5382

Wellsite Geologist: None

Designate Type of Completion

New Well Re-Entry Workover

Oil SWD SIOW Temp. Abd.

Gas ENHR SIGW

Dry Other (Core, WSW, Expl., Cathodic, etc)

If Workover:

Operator: OXY USA, Inc.

Well Name: Hitch S

Comp. Date 4-30-98 Old Total Depth 6176

Deepening Re-perf. Conv. to Inj/SWD

Plug Back PBTD

Commingled Docket No. _____

Dual Completion Docket No. _____

Other (SWD or Inj?) Docket No. Horizontal

11-18-99 12-1-99 2-18-00

Spud Date Date Reached TD Completion Date

API NO. 15-175-21701 - 0101

County Seward

W/2-NW-NE Sec. 28 Twp. 32S Rge. 34W

750 Feet from the North Line of the Section

2480 Feet from the East Line of the Section

Footages Calculated from Nearest Outside Section Corner:
NE, SE, NW or SW (circle one)

Lease Name Hitch S Well # 2

Field Name Shuck

Producing Formation Chester

Elevation: Ground 2913 KB 2923

Total Depth 6131 TVD PBTD 6640 MD

Amount of Surface Pipe Set and Cemented at _____ Feet

Multiple Stage Cementing Collar Used? Yes No

If yes, show depth set _____ Feet

If Alternate II completion, cement circulated from _____

feet depth to _____ w/ _____ sx cmt.

Drilling Fluid Management Plan AITT-Dlg-2/1/09
(Data must be collected from the Reserve Pit)

Chloride content 1100 ppm Fluid volume 600 bbls

Dewatering method used Evaporation

Location of fluid disposal if hauled offsite:

Operator Name _____

Lease Name _____ License No. _____

Quarter Sec. _____ Twp. S Rng. W

County _____ Docket No. _____

INSTRUCTIONS: An original and two copies of this form shall be filed with the Kansas Corporation Commission, 130 S. Market - Room 2078, Wichita, Kansas 67202, within 120 days of the spud date, recompletion, workover or conversion of a well. Rule 82-3-130, 82-3-106 and 82-3-107 apply. Information on side two of this form will be held confidential for a period of 12 months if requested in writing and submitted with the form (see rule 82-3-107 for confidentiality in excess of 12 months). One copy of all wireline logs and geologist well report shall be attached with this form. ALL CEMENTING TICKETS MUST BE ATTACHED. Submit CP-4 form with all plugged wells. Submit CP-111 form with all temporarily abandoned wells.

All requirements of the statutes, rules and regulations promulgated to regulate the oil and gas industry have been fully complied with and the statements herein are complete and correct to the best of my knowledge.

Signature William A. Oliver

Title OPS ENGR Date 30 MAR 00

Subscribed and sworn to before me this 30 day of March, 2000.

Notary Public Anita Peterson

Date Commission Expires Oct. 1, 2001

K.C.C. OFFICE USE ONLY		
F	<input type="checkbox"/>	Letter of Confidentiality Attached
C	<input type="checkbox"/>	Wireline Log Received
C	<input type="checkbox"/>	Geologist Report Received
Distribution		
<input type="checkbox"/>	KCC	<input type="checkbox"/> SWD/Rep <input type="checkbox"/> NGPA
<input type="checkbox"/>	KGS	<input type="checkbox"/> Plug <input type="checkbox"/> Other
(Specify)		

NOTARY PUBLIC, State of Kansas
ANITA PETERSON
My Appt. Exp. Oct. 1, 2001

SIDE TWO

Operator Name OXY USA, Inc.

Lease Name Hitch S Well # 2

Sec. 28 Twp. 32S Rge. 34W

County Seward

INSTRUCTIONS: Show important tops and base of formations penetrated. Detail all cores. Report all drill stem tests giving interval tested, time tool open and closed, flowing and shut-in pressures, whether shut-in pressure reached static level, hydrostatic pressures, bottom hole temperature, fluid recovery, and flow rates if gas to surface during test. Attach extra sheet if more space is needed. Attach copy of log.

Drill Stem Tests Take <input type="checkbox"/> Yes <input checked="" type="checkbox"/> No (Attach Additional Sheets.) Samples Sent to Geological Survey <input type="checkbox"/> Yes <input checked="" type="checkbox"/> No Cores Taken <input type="checkbox"/> Yes <input checked="" type="checkbox"/> No Electric Log Run <input type="checkbox"/> Yes <input checked="" type="checkbox"/> No (Submit Copy.) List All E.Logs Run:	<input checked="" type="checkbox"/> Log Formation (Top), Depth and Datums <input type="checkbox"/> Sample <table style="width:100%; border-collapse: collapse;"> <tr> <td style="width:60%;">Name</td> <td style="width:20%;">Top</td> <td style="width:20%;">Datum</td> </tr> <tr> <td>Chester</td> <td>6106</td> <td>-3179</td> </tr> </table>	Name	Top	Datum	Chester	6106	-3179
Name	Top	Datum					
Chester	6106	-3179					

CASING RECORD New Used

Report all strings set-conductor, surface, intermediate, production, etc.

Purpose of String	Size Hole Drilled	Size Casing Set (In O.D.)	Weight Lbs./Ft.	Setting Depth	Type of Cement	# Sacks Used	Type and Percent Additives
Liner	4.75"	3.5"	9.2	6238		0	

ADDITIONAL CEMENTING/SQUEEZE RECORD

Purpose:	Depth Top - Bottom	Type of Cement	# Sacks Used	Type and Percent Additives
<input type="checkbox"/> Perforate				
<input type="checkbox"/> Protect Casing	6114-6118	H	75	First 25 Sks was Micro Matrix, followed by 50 Sacks Cl H. PBTD now 6100' in Vertical Wellbore
<input type="checkbox"/> Plug Back TD	-			
<input checked="" type="checkbox"/> Plug Off Zone	-			

Shots Per Foot	PERFORATION RECORD - Bridge Plugs Set/Type Specify Footage of Each Interval Perforated	Acid, Fracture, Shot, Cement Squeeze Record (Amount and Kind of Material Used)	Depth
None	Open Hole from 6238 to 6640 Horizontal Wellbore Window cut in 5.5" csg at 6011 to 6018 with 3.5"	None Liner to 6238 (Not Cemented).	

TUBING RECORD	Size	Set At	Packer At	Liner Run
	None			<input checked="" type="checkbox"/> Yes <input type="checkbox"/> No

Date of First, Resumed Production, SWD or Inj. None Producing Method Flowing Pumping Gas Lift Other (Explain)

Estimated Production Per 24 Hours	Oil Bbls. TA'd	Gas Mcf	Water Bbls.	Gas-Oil Ratio	Gravity

Disposition of Gas:

METHOD OF COMPLETION

Production Interval _____

Vented Sold Used on Lease Open Hole Perf. Dually Comp. Commingled _____
 (If vented, submit ACO-18.)

Other (Specify) Temporarily Abandon

REGION North America	NWA/COUNTRY	BDA / STATE KS	TICKET # 282893	TICKET DATE 11-11-99
MBU ID / EMP # MCIT 0112/105943	EMPLOYEE NAME RCrist	PSL DEPARTMENT ZI	COUNTY Seward	
LOCATION Liberal KS	COMPANY Oxy	CUSTOMER REP / PHONE Cal Wylie		
TICKET AMOUNT 6075.18	WELL TYPE O2	API / UWI #		
WELL LOCATION Land	DEPARTMENT ZI	JOB PURPOSE CODE 075		
LEASE / WELL # Hitch S-2	SEC / TWP / RNG 28-32S-34W			

HES EMP NAME/EMP#/(EXPOSURE HOURS) :HRS	HES EMP NAME/EMP#/(EXPOSURE HOURS) :HRS	HES EMP NAME/EMP#/(EXPOSURE HOURS) :HRS	HES EMP NAME/EMP#/(EXPOSURE HOURS) :HRS
RCrist 105943 4			
S Woodrow 105849 4			
S Owens 106125 4			

HES UNIT NUMBERS	R/T MILES	HES UNIT NUMBERS	R/T MILES	HES UNIT NUMBERS	R/T MILES	HES UNIT NUMBERS	R/T MILES
420621							
54219-78299							
54116-77031							

Form Name _____ Type: _____
 Form Thickness _____ From _____ To _____
 Packer Type _____ Set At _____
 Bottom Hole Temp. _____ Pressure _____
 Misc. Data _____ Total Depth _____

TOOLS AND ACCESSORIES

TYPE AND SIZE	QTY	MAKE
Float Collar		
Float Shoe		
Guide Shoe		
Centralizers		
Bottom Plug		
Top Plug		
Head		
Packer		
Other		

MATERIALS

Treat Fluid	Density	Lb/Gal
Disp. Fluid	Density	Lb/Gal
Prop. Type	Size	Lb.
Prop. Type	Size	Lb.
Acid Type	Gal.	%
Acid Type	Gal.	%
Surfactant	Gal.	In
NE Agent	Gal.	In
Fluid Loss	Gal/Lb	In
Gelling Agent	Gal/Lb	In
Fric. Red.	Gal/Lb	In
Breaker	Gal/Lb	In
Blocking Agent	Gal/Lb	
Perpac Balls	Qty.	
Other		
Other		
Other		

DATE	CALLED OUT	ON LOCATION	JOB STARTED	JOB COMPLETED
11-11-99	0900	1200	1300	1527

WELL DATA

	NEW/USED	WEIGHT	SIZE	FROM	TO	MAX ALLOW
Casing	4	15.5	5 1/2	KB	6323	
Liner						
Liner						
Tbg/D.P.	4	4.7	2 3/8	KB	5915	
Tbg/D.P.						
Open Hole						SHOTS/FT.
Perforations						
Perforations						
Perforations						

HOURS ON LOCATION	OPERATING HOURS	DESCRIPTION OF JOB
DATE RECEIVED HOURS	DATE HOURS	
MAR 31 2000		
TOTAL	TOTAL	

HYDRAULIC HORSEPOWER

ORDERED Avail. Used

AVERAGE RATES IN BPM

TREATED Disp. Overall

CEMENT LEFT IN PIPE

FEET Reason

CEMENT DATA

STAGE	SACKS	CEMENT	BULK/SKS	ADDITIVES	YIELD	LBS/GAL
	25	Micropak S	S	.5% Helad 322, 1/4" D Riv	1.4	11.5
	50	H	B	N 007	1.18	15.6

Circulating Displacement 26	Preflush: Gal - BBI _____	Type _____
Breakdown Maximum _____	Load & Bkdn: Gal - BBI _____	Pad: BBI - Gal _____
Average Frac Gradient _____	Treatment Gal - BBI _____	Disp: BBI - Gal _____
Shut In: Instant _____ 5 Min _____ 15 Min _____	Cement Slurr Gal - BBI 6.2 x 10.5	Total Volume Gal - BBI _____

Frac Ring #1 _____ Frac Ring #2 _____ Frac Ring #3 _____ Frac Ring #4 _____

THE INFORMATION STATED HEREIN IS CORRECT

CUSTOMER'S REPRESENTATIVE SIGNATURE _____



JOB LOG 4239-5

REGION North America	NW/COUNTRY	TICKET #	TICKET DATE
MBU ID / EMP #	EMPLOYEE NAME	BDA / STATE	COUNTY
LOCATION	COMPANY	PSL DEPARTMENT	
TICKET AMOUNT	WELL TYPE	CUSTOMER REP / PHONE	
WELL LOCATION	DEPARTMENT	API / UWI #	
LEASE / WELL #	SEC / TWP / RNG	JOB PURPOSE CODE	

HES EMP NAME/EMP#/(EXPOSURE HOURS) HRS	HES EMP NAME/EMP#/(EXPOSURE HOURS) HRS	HES EMP NAME/EMP#/(EXPOSURE HOURS) HRS	HES EMP NAME/EMP#/(EXPOSURE HOURS) HRS

CHART NO.	TIME	RATE (BPM)	VOLUME (BBL)(GAL)	PUMPS		PRESS. (psi)		JOB DESCRIPTION / REMARKS
				T	C	Tbg	Csg	
	0430							UNITED CUT
	0718							ON LOCATION CREW LAYING CUT DEADMEN
	0720							LEAVE RTTS #50242. 508' & 2314. 5511 ONL
	1131							ON LOCATION FROM VICTORY LANSING 601 Ra 611
	1342							w/RTTS 203.0111 ON LOC = 4500.24
	1414							INSTALL BOP.
	1419		100		X	500		SET RTTS # 5975 w/ 192 JOINTS
	1530							LOAD AND PRESSURE TEST ANNULUS HOLDING AND
1111	1150							RELEASED TILL H.V.
	1211							ON LOCATION FROM VICTORY LANSING 601
								RELEASED - SAFETY. HOLDING PRESSURE TEST
					X	500		LOAD ANNULUS
	1231	2		X		500	500	LOAD W/ 10' SECTION W/2
	1235	2	16.80	X		550	500	CONCRETE PLUG MATEL 50' SLASH
	1250							FINISH MIXING JACKING W/RTTS
	1257	2		X		500	500	DISPLACE
		1		X		500	500	10' SECTION W/RTTS
								14' SECTION W/RTTS PRESSURE TEST
		5K1		X		440	500	CONCRETE
		5		X		470	500	
		10		X		550	500	
		10		X		600	500	
		10		X		1500	500	
	1457							STAGE LEASE - NEW 10.3 - 1500 PSI - HOLDING
	14133					150	500	RELEASE PRESSURE AND RETURN TO BACK
	14148							RELEASE PRESSURE - HOLD ON
	14507							REVERSE 500' CEMENT TO PIT
								LOAD ON
					X	500	500	PRESSURE TESTED 100' - HOLD ON
								RELEASE PRESSURE
								RELEASE PRESSURE
								RELEASE PRESSURE
								RELEASE PRESSURE
								RELEASE PRESSURE

RECEIVED
STATE CORPORATION COMMISSION

MAR 31 2000

CONSERVATION DIVISION
Wichita Kansas

WARRANTY...
WARRANTY...
WARRANTY...



Halliburton Energy Services, Inc.

Remit to: P.O. Box 951046
Dallas, TX 75395-1046

INVOICE

Site/Well Address: OXY USA HITCH S-2, SEWARD HITCH LIBERAL KS 67901	DIRECT CORRESPONDENCE TO: P.O. Box 1598 Liberal, KS 67905-1598 (316) 624-3879	Invoice No. 90194160	Date 11/14/1999
		Customer PO No. N/A	Date
		Delivery No. 80345226	Date 11/11/1999
		Order/Ticket No. 304323	Date 11/10/1999
		Manual Ticket No.	

TO: OXY USA INC. P.O. BOX 2528 LIBERAL KS 67905-2528 USA	Job Location Liberal, KS, USA	Order/Ticket No. 304323	Date 11/10/1999
	Land		
	Shipping Point LIBERAL Shipping Poi	Manual Ticket No.	
	Service Location	Customer No. 304323	
	Payment Terms Net due in 20 days	Payment Due Date 12/04/1999	

Reference Number	Description	QTY	U/M	Unit Price	Amount
7526	PSL-CMT Squeeze Perforations-BOM JP075	1	JOB		
1	MILEAGE FROM NEAREST HES BASE,/UNIT,ZI Discount : \$40.88- With the following configuration: Number of Units 000-117	40	MI	3.65	146.00
2	MILEAGE FOR CEMENTING CREW,ZI Discount : \$24.08- With the following configuration: Number of Units 000-119	40	MI	2.15	86.00
23	SQUEEZE PUMPING CHARGE Discount : \$848.96- With the following configuration: CHARGE BY FT OR RANGE OF FEET 009-134	1	UN	3,032.00	3,032.00
		6,118	ft		

RECEIVED
STATE CORPORATION COMMISSION

MAR 31 2000

CONSERVATION DIVISION
Wichita, Kansas

Terms: If customer does not have an approved open account with Halliburton, all sums are payable in cash at the time of performance of services or delivery of equipment, products, or materials. If customer has an approved open account, Invoices are payable on the twentieth day after date of invoice. Customer agrees to pay interest on unpaid balance from the date payable until paid at the highest lawful contract rate applicable, but never to exceed 18% per annum. In the event Halliburton employs an attorney for collection of any amount, Customer agrees to pay attorney fees of 20% of the unpaid account, plus all collection and court costs.



Continuation	
Invoice No.	Date
90194150	11/14/1999

INVOICE

Halliburton Energy Services, Inc.

Reference Number	Description	QTY	U/M	Unit Price	Amount
132	PORTABLE DAS,/DAY/JOB,ZI Discount : \$570.00- With the following configuration: NUMBER OF DAYS 045-050	1	JOB	760.00	760.00
4020	DELIVERY CHG, PKG MTLs,F/HD UNITS ZI Discount : \$128.80- With the following configuration: Number of Units 500-884	4	H	115.00	460.00
3966	SPECIAL HNDLG CHG,MICRO MATRIX CMT,ZI Discount : \$210.00- With the following configuration: NUMBER OF UNITS 500-210	1	JOB	750.00	750.00
3975	MILEAGE,CMTG MTLs DEL/RETURNED,ZI Discount : \$35.00- With the following configuration: NUMBER OF TONS 500-306	75	TMI	1.67	125.00
100003770	CHEMICAL - MICRO MATRIX CEMENT - 50 LB Discount : \$567.00- 504-211516.00611 CHEMICAL - MICRO MATRIX CEMENT - 50 LB SACK	25	SK	81.00	2,025.00
101007446	CHEMICAL - D-AIR 3000 Discount : \$5.77- Chemical - D-Air 3000	4	LB	5.15	20.60

RECEIVED
STATE CORPORATION COMMISSION
MAY 31 2000

Terms: If customer does not have an approved open account with Halliburton, all sums are payable in cash at the time of performance of services or delivery of equipment, products or materials. If customer has an approved open account, invoices are payable on the twentieth day after date of invoice. Customer agrees to pay interest on unpaid balance from the date payable until paid at the highest lawful contract rate applicable, but never to exceed 18% per annum. In the event Halliburton employs an attorney for collection of any amount, Customer agrees to pay attorney fees of 20% of the unpaid account, plus all collection and court costs.



Continuation	
Invoice No.	Date
90194150	11/14/1999

INVOICE

Halliburton Energy Services, Inc.

Reference Number	Description	QTY	U/M	Unit Price	Amount
100003646	HALAD-322 Discount : \$15.09- 507-775516.00144 CHEMICAL - HALAD-322 - 50 LB SACK	7	LB	7.70	53.90
100003687	CEMENT- Premium (Bulk) Discount : \$214.76- CEMENT - CLASS H - PREMIUM - BULK CEMENT - CLASS H - PREMIUM - BULK	50	SK	15.34	767.00
3965	HANDLE&DUMP SVC CHRГ, CMT&ADDITIVES,ZI Discount : \$23.24- With the following configuration: NUMBER OF EACH 500-207	50	CF	1.66	83.00
100003646	HALAD-322 Discount : \$25.87- 507-775516.00144 CHEMICAL - HALAD-322 - 50 LB SACK 9-1543556 x 33110 7-1542377 David E Rice <i>P.M. Wylh-</i>	12	LB	7.70	92.40
INVOICE SUBTOTAL					8,400.90
DISCOUNT					2,709.45
INVOICE AMOUNT					5,691.45
Sales Tax - State					275.83
Sales Tax - County					51.60
Sales Tax - City/Loc					56.30
INVOICE TOTAL - PLEASE PAY THIS AMOUNT					6,075.18

RECEIVED
STATE CORPORATION COMMISSION

MAR 31 2000

CONSERVATION DIVISION
Wichita, Kansas

Terms: If customer does not have an approved open account with Halliburton, all sums are payable in cash at the time of performance of services or delivery of equipment, products, or materials. If customer has an approved open account, Invoices are payable on the twentieth day after date of invoice. Customer agrees to pay interest on unpaid balance from the date payable until paid at the highest lawful contract rate applicable, but never to exceed 18% per annum. In the event Halliburton employs an attorney for collection of any amount, Customer agrees to pay attorney fees of 20% of the unpaid account, plus all collection and court costs.



Halliburton Energy Services, Inc.

SOLD TO

11/11
11/11
OXY USA INC.
P O BOX 245
TULSA OK 74102
USA

SHIP TO

WELL OPERATOR
OXY USA HITCH S-2, SEWARD
LEASE NAME / OFFSHORE AREA
HITCH
WELL NUMBER
S-2
WELL PERMIT NO.
SEC 28 - 32S - 34W
ADDRESS
*
CITY, STATE, ZIP CODE
LIBERAL KS 67901 US

TICKET TYPE	COMPANY CODE	HALLIBURTON ORDER NO.
Integrated Solutions	1100	282891
CUSTOMER P.O. NO.	JOB DATE	PRIMARY SERVICE LOC.
N/A	11/11/1999	Liberal, KS, USA

SALES OFFICE	WELL TYPE	WELL CATEGORY	RIG NAME / NO.
Mid-Continent BD	Gas	Workover	OXY USA INC.

ITEM	MATERIAL	DESCRIPTION	QTY	UNIT	UNIT PRICE	AMOUNT
10	7526	PSL-CMT Squeeze Perforations-BOM Liberal, KS, USA Hwy 54 West JP075	1.00	JOB	0.00	0.00
20	1	MILEAGE FROM NEAREST HES BASE,/UNIT,ZI Liberal, KS, USA Hwy 54 West 000-117 With the following configuration: Number of Units	40	MI	3.65	146.00
			40	MI	1.02-	40.88-
			40	MI	2.63	105.12
30	2	MILEAGE FOR CEMENTING CREW,ZI Liberal, KS, USA Hwy 54 West 000-119 With the following configuration: Number of Units	40	MI	2.15	86.00
			40	MI	0.60-	24.08-
			40	MI	1.55	61.92

The customer hereby acknowledges receipt of the materials and services listed on this ticket.

INVOICE INSTRUCTIONS	
PAYMENT TERMS Net due in 20 days	HALLIBURTON APPROVAL
HALLIBURTON OPERATOR / ENGINEER <i>Ron Crist</i>	CUSTOMER SIGNATURE <i>[Signature]</i>

TOTAL FROM THIS PAGE	167.04
TOTAL FROM NEXT PAGE(S)	5,524.41
SUBTOTAL	5,691.45
TAXES	383.73
GRAND TOTAL	6,075.18
	US Dollars

RECEIVED
 STATE CORPORATION COMMISSION
 MAR 3 1 2000
 CONSERVATION DIVISION
 Wichita Kansas

Halliburton Energy Services, Inc.

ITEM	MATERIAL	DESCRIPTION	QTY	UNIT	UNIT PRICE	AMOUNT
40	23	SQUEEZE PUMPING CHARGE				
	Liberal, KS, USA Hwy 54 West		1.00	UN	3,032.00	3,032.00
			1.00	UN	848.96-	848.96-
			1.00	UN	2,183.04	2,183.04
		009-134				
		With the following configuration:				
		CHARGE BY FT OR RANGE OF FEET	6,118	ft		
50	132	PORTABLE DAS,/DAY/JOB,ZI				
	Liberal, KS, USA Hwy 54 West		1.00	JOB	760.00	760.00
			1.00	JOB	570.00-	570.00-
			1.00	JOB	190.00	190.00
		045-050				
		With the following configuration:				
		NUMBER OF DAYS	1	Days		
	00003770	CHEMICAL - MICRO MATRIX CEMENT - 50 LB				
	Hugoton, KS, USA		25.00	SK	81.00	2,025.00
			25.00	SK	22.68-	567.00-
			25.00	SK	58.32	1,458.00
		504-211516.00611				
		CHEMICAL - MICRO MATRIX CEMENT - 50 LB SACK				
75	101007446	CHEMICAL - D-AIR 3000				
	Hugoton, KS, USA		4.00	LB	5.15	20.60
			4.00	LB	1.44-	5.77-
			4.00	LB	3.71	14.83
		Chemical - D-Air 3000				
80	4020	DELIVERY CHG, PKG MTLS,F/HD UNITS ZI				
	Liberal, KS, USA Hwy 54 West		4.000	H	115.00	460.00
			4.000	H	32.20-	128.80-
			4.000	H	82.80	331.20
		500-884				
		With the following configuration:				
		Number of Units	1	unit		

 CONSERVATION DIVISION
 Wichita, Kansas

MAR 31 2000

 RECEIVED
 STATE CORPORATION COMMISSION

Halliburton Energy Services, Inc.

ITEM	MATERIAL	DESCRIPTION	QTY	UNIT	UNIT PRICE	AMOUNT
90	3966	SPECIAL HNDLG CHG,MICRO MATRIX CMT,ZI				
	Liberal, KS, USA Hwy 54 West		1.00	JOB	750.00	750.00
			1.00	JOB	210.00-	210.00-
			1.00	JOB	540.00	540.00
		500-210				
		With the following configuration:				
		NUMBER OF UNITS	1	each		
100	100003646	HALAD-322				
	Hugoton, KS, USA		7.00	LB	7.70	53.90
			7.00	LB	2.16-	15.09-
			7.00	LB	5.54	38.81
		507-775516.00144				
		CHEMICAL - HALAD-322 - 50 LB SACK				
100	100003687	CEMENT- Premium (Bulk)				
	Hugoton, KS, USA		50.00	SK	15.34	767.00
			50.00	SK	4.30-	214.76-
			50.00	SK	11.04	552.24
		CEMENT - CLASS H - PREMIUM - BULK				
		CEMENT - CLASS H - PREMIUM - BULK				
120	3965	HANDLE&DUMP SVC CHR, CMT&ADDITIVES,ZI				
	Hugoton, KS, USA		50.00	CF	1.66	83.00
			50.00	CF	0.46-	23.24-
			50.00	CF	1.20	59.76
		500-207				
		With the following configuration:				
		NUMBER OF EACH	1	each		
130	3975	MILEAGE,CMTG MTLs DEL/RETURNED,ZI				
	Liberal, KS, USA Hwy 54 West		75.0	TMI	1.67	125.00
			75.0	TMI	0.47-	35.00-
			75.0	TMI	1.20	90.00
		500-306				
		With the following configuration:				
		NUMBER OF TONS	1.00	ton		

Wichita, Kansas

MAR 31 2000

STATE CORPORATION COMMISSION

RECEIVED

CONSERVATION DIVISION

Halliburton Energy Services, Inc.

ITEM	MATERIAL	DESCRIPTION	QTY	UNIT	UNIT PRICE	AMOUNT
140	100003646 Hugoton, KS, USA	HALAD-322				
			<i>0013</i>	LB	7.70	92.40
				LB	2.16-	25.87-
				LB	5.54	66.53
		507-775516.00144 CHEMICAL - HALAD-322 - 50 LB SACK				
		INVOICE AMOUNT				5,691.45
		Sales Tax - State				275.83
		Sales Tax - County				51.60
		Sales Tax - City/Loc				56.30
		INVOICE TOTAL				6,075.18
						US Dollars

RECEIVED
 STATE CORPORATION COMMISSION

MAR 31 2000

CONSERVATION DIVISION
 Wichita, Kansas



Work Order Contract

Halliburton Energy Services, Inc.
Houston Texas 77056

Order Number

282893

70012 SAP

TO: HALLIBURTON ENERGY SERVICES, INC. - YOU ARE HEREBY REQUESTED TO FURNISH EQUIPMENT AND SERVICE PERSONNEL TO DELIVER AND OPERATE THE SAME AS AN INDEPENDENT CONTRACTOR TO CUSTOMER LISTED BELOW AND DELIVER AND SELL PRODUCTS, SUPPLIES AND MATERIALS FOR THE PURPOSE OF SERVICING:

Well No. S-2	Farm or Lease HITCH	County Seward	State KS	Well Permit #
Customer Oxy	Well Owner SAME	Job Purpose 075		

THIS WORK ORDER MUST BE SIGNED BEFORE WORK IS COMMENCED

A. CUSTOMER REPRESENTATION - Customer warrants that the well is in proper condition to receive the services, equipment, products, and materials to be supplied by Halliburton Energy Services, Inc. (hereinafter "Halliburton").

B. PRICE AND PAYMENT - The services, equipment, products, and/or materials to be supplied hereunder are priced in accordance with Halliburton's current price list. All prices are exclusive of taxes. If Customer does not have an approved open account with Halliburton, all sums due are payable in cash at the time of performance of services or delivery of equipment, products or materials. If Customer has an approved open account, invoices are payable on the twentieth day after the date of invoice. Customer agrees to pay interest on any unpaid balance from the date payable until paid at the highest lawful contract rate applicable, but never to exceed 18% per annum. In the event Halliburton employs an attorney for collection of any account, Customer agrees to pay attorney fees of 20% of the unpaid account, or Halliburton's actual attorneys fees, whichever is greater, plus all collection and court costs. Customer agrees that the amount of attorney fees set out herein are reasonable and necessary.

C. RELEASE AND INDEMNITY - Customer agrees to **RELEASE** Halliburton Group from any and all liability for any and all damages whatsoever to property of any kind owned by, in the possession of, or leased by Customer and those persons and entities Customer has the ability to bind by contract or which are co-interest owners or joint ventures with Customer. Customer also agrees to **DEFEND, INDEMNIFY, AND HOLD** Halliburton Group **HARMLESS** from and against any and all liability, claims, costs, expenses, attorney fees and damages whatsoever for personal injury, illness, death, property damage and loss resulting from:

loss of well control; services to control a wild well whether underground or above the surface; reservoir or underground damage, including loss of oil, gas, other mineral substances or water; surface damage arising from underground damage; damage to or loss of the well bore; subsurface trespass or any action in the nature thereof; fire; explosion; subsurface pressure; radioactivity; and pollution and contamination and its cleanup and control.

CUSTOMER'S RELEASE, DEFENSE, INDEMNITY AND HOLD HARMLESS obligations will apply even if the liability and claims are caused by the sole, concurrent, active or passive negligence, fault, or strict liability of one or more members of the Halliburton Group, the unseaworthiness of any vessel or any defect in the data, products, supplies, materials or equipment furnished by any member or members of the Halliburton Group whether in the design, manufacture, maintenance or marketing thereof or from a failure to warn of such defect. "Halliburton Group" is defined as Halliburton Energy Services, Inc., its parent, subsidiary, and affiliated companies, insurers and subcontractors and all its/their officers, directors, employees, consultants and agents. **Customer's RELEASE, DEFENSE, INDEMNITY AND HOLD HARMLESS** obligations apply whether the personal injury, illness, death, property damage or loss is suffered by one or more members of the Halliburton Group, Customer, or any other person or entity. Customer agrees to support such obligations assumed herein with liability insurance with limits of not less than \$500,000. Customer agrees to name Halliburton Group as named additional insureds on all of its general liability policy(s). Customer agrees that its liability under this Contract is not limited by the amounts of its insurance coverage, except where and as may be required by applicable local law for the provisions of this Contract to be enforceable.

D. EQUIPMENT LIABILITY - Customer shall at its risk and expense attempt to recover any Halliburton Group equipment lost or lodged in the well. If the equipment is recovered and repairable, Customer shall pay the repair costs, unless caused by Halliburton's sole negligence. If the equipment is not recovered or is irreparable, Customer shall pay the replacement cost, unless caused by Halliburton's sole negligence. If a radioactive source becomes lost or lodged in the well, Customer shall meet all requirements of Section 39.15(a) of the Nuclear Regulatory Commission regulations and any other applicable laws or regulations concerning retrieval or abandonment and shall permit Halliburton to monitor the recovery or abandonment efforts all at no risk or liability to Halliburton Group. Customer shall be responsible for damage to or loss of Halliburton group equipment, products, and materials while in transit aboard Customer-supplied transportation, even if such is arranged by Halliburton at Customer's request, and during loading and unloading from such transport. Customer will also pay for the repair or replacement of Halliburton group equipment damaged by corrosion or abrasion due to well effluents.

E. LIMITED WARRANTY - Halliburton warrants only title to the equipment, products, and materials supplied under this Contract and that same are free from defects in workmanship and materials for thirty (30) days from the date of delivery. **THERE ARE NO WARRANTIES, EXPRESS OR IMPLIED, OF MERCHANTABILITY, FITNESS OR OTHERWISE BEYOND THOSE STATED IN THE IMMEDIATELY PRECEDING SENTENCE.** Halliburton's sole liability and Customer's exclusive remedy in any cause of action (whether in contract, tort, breach of warranty or otherwise) arising out of the sale, lease or use of any equipment, products, or materials is expressly limited to the replacement of such on their return to Halliburton or, at Halliburton's option, to the allowance to Customer of credit for the cost of such items. In no event shall Halliburton be liable for special, incidental, indirect, consequential, or punitive damages. Because of the uncertainty of variable well conditions and the necessity of relying on facts and supporting services furnished by others, **HALLIBURTON IS UNABLE TO GUARANTEE THE EFFECTIVENESS OF THE EQUIPMENT, MATERIALS, OR SERVICE, NOR THE ACCURACY OF ANY CHART INTERPRETATION, RESEARCH ANALYSIS, JOB RECOMMENDATION OR OTHER DATA FURNISHED BY HALLIBURTON GROUP.** Halliburton personnel will use their best efforts in gathering such information and their best judgment in interpreting it, but Customer agrees that Halliburton Group shall not be liable for and **CUSTOMER SHALL INDEMNIFY HALLIBURTON GROUP AGAINST ANY DAMAGES ARISING FROM THE USE OF SUCH INFORMATION**, even if such is contributed to or caused by the active or passive negligence, fault or strict liability of any member or members of Halliburton Group. Halliburton also does not warrant the accuracy of data transmitted by electronic process, and Halliburton will not be responsible for accidental or intentional interception of such data by third parties.

F. GOVERNING LAW - The validity, interpretation and construction of this Contract shall be determined by the laws of the jurisdiction where the services are performed or the equipment or materials are delivered.

G. DISPUTE RESOLUTION Customer and Halliburton agree that any dispute that may arise out of the performance of this Contract shall be resolved by binding arbitration by a panel of three arbitrators under the rules of the American Arbitration Association. The arbitration will take place in Houston, TX.

H. SEVERABILITY - If any provision or part thereof of this Contract shall be held to be invalid, void, or of no effect for any reason, such holding shall not be deemed to affect the validity of the remaining provisions of this Contract which can be given effect, without the invalid provision or part thereof, and to this end, the provisions of this Contract are declared to be severable. Customer and Halliburton agree that any provision of this Contract that is unenforceable or void under applicable law will be modified to achieve the intent of the parties hereunder to the greatest extent allowed by applicable law.

I. MODIFICATIONS - Customer agrees that Halliburton shall not be bound by any modifications to this Contract, except where such modification is made in writing by a duly authorized executive officer of Halliburton. Requests for modifications should be directed to the Vice President - Legal, 4100 Clinton Drive, Houston, TX. 77020.

I HAVE READ AND UNDERSTAND THIS WORK ORDER CONTRACT WHICH CONTAINS RELEASE AND INDEMNITY LANGUAGE WHICH CUSTOMER ACKNOWLEDGES IS CONSPICUOUS AND AFFORDS FAIR AND ADEQUATE NOTICE AND I REPRESENT THAT I AM AUTHORIZED TO SIGN THE SAME AS CUSTOMER'S AGENT.

SIGNED: X M. W. [Signature] CUSTOMER Authorized Signatory DATE: _____ TIME: _____ A.M./P.M.

Customer Acceptance of Materials and Services

THE CUSTOMER HEREBY ACKNOWLEDGES RECEIPT OF THE MATERIALS AND SERVICES DESCRIBED ON THE ATTACHED ORDER NUMBER _____ X M. W. [Signature] CUSTOMER Authorized Signatory

White-Office Canary-Field Office Pink-Customer Green-Retain

Section 1

Survey Data

Contents: Final Well Survey submitted as the official certified survey.

RECEIVED
STATE CORPORATION COMMISSION

JAN 24 2000

CONSERVATION DIVISION
Wichita, Kansas

Sperry-Sun Drilling Services

Survey Report for Hitch S #2



API No. 15-175-21701-0101

Seward

Sec. 28-T32S-R34W

OXY USA

Measured Depth (ft)	Incl. (Deg)	Azim. (Deg)	Station TVD (ft)	Coordinates Northings (ft)	Coordinates Eastings (ft)	Vertical Section (ft)	Dogleg Rate (/100ft)	Comment
Gyro								
0.00	0.000	0.000	0.00	0.00 N	0.00 E	0.00		
100.00	0.510	323.570	100.00	0.36 N	0.28 W	-0.44	0.510	
200.00	0.290	268.800	200.00	0.71 N	0.78 W	-1.02	0.417	
300.00	0.360	264.050	299.99	0.67 N	1.35 W	-1.29	0.075	
400.00	0.250	249.660	399.99	0.56 N	1.86 W	-1.48	0.133	
500.00	0.320	263.850	499.99	0.46 N	2.35 W	-1.65	0.099	
600.00	0.210	173.100	599.99	0.25 N	2.60 W	-1.61	0.365	
700.00	0.470	162.210	699.99	0.33 S	2.45 W	-1.04	0.267	
800.00	0.530	153.840	799.99	1.13 S	2.13 W	-0.19	0.094	
900.00	0.710	114.160	899.98	1.80 S	1.36 W	0.79	0.454	
1000.00	0.430	111.780	999.98	2.19 S	0.44 W	1.61	0.281	
1100.00	0.640	180.860	1099.97	3.08 S	0.10 W	2.53	0.795	
1200.00	0.630	217.960	1199.96	4.23 S	0.45 W	3.32	0.508	
1300.00	0.790	250.540	1299.96	4.89 S	1.44 W	3.35	0.427	
1400.00	0.730	254.650	1399.95	5.29 S	2.71 W	3.01	0.081	
1500.00	0.920	262.160	1499.94	5.57 S	4.12 W	2.49	0.218	
1600.00	1.410	273.960	1599.92	5.59 S	6.14 W	1.42	0.543	
1700.00	1.270	293.050	1699.89	5.08 S	8.39 W	-0.23	0.465	
1800.00	1.050	306.150	1799.87	4.10 S	10.15 W	-1.99	0.343	
1900.00	0.910	307.840	1899.85	3.07 S	11.51 W	-3.59	0.143	
2000.00	0.680	319.910	1999.84	2.13 S	12.52 W	-4.93	0.283	
2100.00	0.510	338.600	2099.84	1.26 S	13.07 W	-5.95	0.256	
2200.00	0.420	348.160	2199.83	0.49 S	13.30 W	-6.73	0.119	
2300.00	0.360	30.840	2299.83	0.15 N	13.21 W	-7.23	0.293	
2400.00	0.330	56.920	2399.83	0.59 N	12.80 W	-7.36	0.167	
2500.00	0.460	87.370	2499.83	0.77 N	12.16 W	-7.18	0.242	
2600.00	0.440	89.960	2599.83	0.79 N	11.37 W	-6.77	0.029	
2700.00	0.400	72.290	2699.82	0.90 N	10.65 W	-6.48	0.135	
2800.00	0.330	69.020	2799.82	1.10 N	10.05 W	-6.33	0.073	
2900.00	0.360	77.840	2899.82	1.27 N	9.48 W	-6.17	0.061	
3000.00	0.120	27.550	2999.82	1.43 N	9.12 W	-6.11	0.298	
3100.00	0.280	20.680	3099.82	1.75 N	8.99 W	-6.31	0.162	
3200.00	0.270	18.330	3199.82	2.21 N	8.83 W	-6.60	0.015	
3300.00	0.190	346.560	3299.82	2.59 N	8.79 W	-6.91	0.148	
3400.00	0.080	67.380	3399.82	2.78 N	8.76 W	-7.05	0.194	

Continued...

Sperry-Sun Drilling Services

Survey Report for Hitch S #2



OXY USA

Seward
Sec. 28-T32S-R34W

Measured Depth (ft)	Incl. (Deg)	Azim. (Deg)	Station Coordinates			Vertical Section (ft)	Dogleg Rate ("/100ft)	Comment
			TVD (ft)	Northings (ft)	Eastings (ft)			
3500.00	0.320	128.280	3499.81	2.83 N	8.48 W	-6.78	0.280	
3600.00	0.170	165.280	3599.81	2.32 N	8.22 W	-6.37	0.211	
3700.00	0.250	228.530	3699.81	2.02 N	8.34 W	-6.19	0.225	
3800.00	0.280	223.880	3799.81	1.69 N	8.68 W	-6.09	0.042	
3900.00	0.380	215.620	3899.81	1.24 N	9.05 W	-5.91	0.102	
4000.00	0.620	214.860	3999.81	0.53 N	9.55 W	-5.57	0.240	
4100.00	0.580	221.070	4099.80	0.30 S	10.19 W	-5.22	0.076	
4200.00	0.370	212.420	4199.80	0.95 S	10.70 W	-4.94	0.221	
4300.00	0.420	234.880	4299.80	1.44 S	11.17 W	-4.79	0.161	
4400.00	0.550	235.230	4399.79	1.92 S	11.86 W	-4.75	0.130	
4500.00	0.470	237.670	4499.79	2.41 S	12.60 W	-4.74	0.083	
4600.00	0.460	245.600	4599.78	2.81 S	13.33 W	-4.80	0.086	
4700.00	0.430	239.180	4699.78	3.17 S	14.04 W	-4.87	0.071	
4800.00	0.530	240.890	4799.78	3.59 S	14.76 W	-4.90	0.101	
4900.00	0.560	239.280	4899.77	4.08 S	15.61 W	-4.94	0.082	
5000.00	0.540	254.210	4999.77	4.47 S	16.50 W	-5.10	0.155	
5100.00	0.480	239.410	5099.76	4.80 S	17.30 W	-5.24	0.151	
5200.00	0.390	245.080	5199.76	5.15 S	17.96 W	-5.30	0.082	
5300.00	0.430	257.270	5299.76	5.38 S	18.63 W	-5.47	0.096	
5400.00	0.180	247.890	5399.76	5.52 S	19.14 W	-5.63	0.254	
5500.00	0.090	135.610	5499.76	5.64 S	19.23 W	-5.58	0.230	
5600.00	0.190	230.990	5599.76	5.80 S	19.31 W	-5.49	0.218	
5700.00	0.630	224.390	5699.75	6.29 S	19.82 W	-5.34	0.442	
5800.00	0.570	183.980	5799.75	7.18 S	20.24 W	-4.82	0.418	
5900.00	0.860	158.790	5899.74	8.22 S	20.07 W	-3.85	0.282	
5975.00	0.960	155.140	5974.74	9.19 S	19.65 W	-2.81	0.406	Gyro Tie On
MWD								
6022.00	6.700	147.000	6021.61	11.85 S	17.99 W	0.33	12.237	Whipstock Oriented Direction
6057.82	21.400	165.000	6056.28	19.96 S	15.14 W	8.70	42.332	MWD Inc. Angle; Imputed Azimuth
6072.82	27.000	165.100	6069.95	25.90 S	13.55 W	14.56	37.334	MWD Inc. Angle; Imputed Azimuth
6089.45	33.400	166.200	6084.32	34.00 S	11.49 W	22.50	38.627	Begin Full MWD Surveys
6100.45	38.000	162.900	6093.25	40.18 S	9.77 W	28.64	45.322	
6121.02	48.600	162.100	6108.20	53.61 S	5.53 W	42.25	51.599	
6152.42	69.100	161.500	6124.36	79.00 S	2.84 E	68.15	65.307	
6161.01	74.000	162.800	6127.07	86.75 S	5.33 E	76.03	58.820	
6180.00	83.300	162.700	6130.81	104.51 S	10.85 E	93.98	48.976	End Short Radius Build Section
6192.57	85.200	162.000	6132.07	116.43 S	14.64 E	106.06	16.099	

Continued...

Sperry-Sun Drilling Services

Survey Report for Hitch S #2



OXY USA

Seward
Sec. 28-T32S-R34W

Measured Depth (ft)	Incl. (Deg)	Azim. (Deg)	Station Coordinates			Vertical Section (ft)	Dogleg Rate (°/100ft)	Comment
			TVD (ft)	Northings (ft)	Eastings (ft)			
6223.60	90.400	160.100	6133.26	145.75 S	24.71 E	136.20	17.839	
6255.35	91.600	159.900	6132.70	175.58 S	35.56 E	167.19	3.832	
6287.14	92.900	159.400	6131.45	205.36 S	46.61 E	198.24	4.381	
6319.19	90.400	158.500	6130.53	235.26 S	58.12 E	229.64	8.290	
6350.84	88.900	158.000	6130.73	264.65 S	69.84 E	260.73	4.996	
6382.12	89.600	157.600	6131.13	293.61 S	81.66 E	291.50	2.577	
6413.65	91.000	157.200	6130.97	322.72 S	93.78 E	322.56	4.618	
6445.15	90.500	156.800	6130.56	351.71 S	106.09 E	353.63	2.033	
6476.89	90.900	156.900	6130.17	380.89 S	118.56 E	384.94	1.289	
6508.31	92.500	156.200	6129.24	409.70 S	131.06 E	415.96	5.558	
6539.56	93.400	155.700	6127.63	438.20 S	143.78 E	446.83	3.294	
6571.23	93.700	154.900	6125.67	466.92 S	156.99 E	478.14	2.693	
6640.00	93.700	154.900	6121.23	529.07 S	186.10 E	546.20	0.000	Projection Only

All data is in feet unless otherwise stated. Directions and coordinates are relative to True North.
Vertical depths are relative to Well. Northings and Eastings are relative to Well.

Magnetic Declination at Surface is 7.977° (19-Nov-99)

The Dogleg Severity is in Degrees per 100ft.

Vertical Section is from Well and calculated along an Azimuth of 147.500° (True).

Based upon Minimum Curvature type calculations, at a Measured Depth of 6640.00ft.,
The Bottom Hole Displacement is 560.84ft., in the Direction of 160.621° (True).

15-175-21701-09-01



OXY USA



**Kansas
Seward County
Sec. 28-T32S-R34W
Hitch S #2**

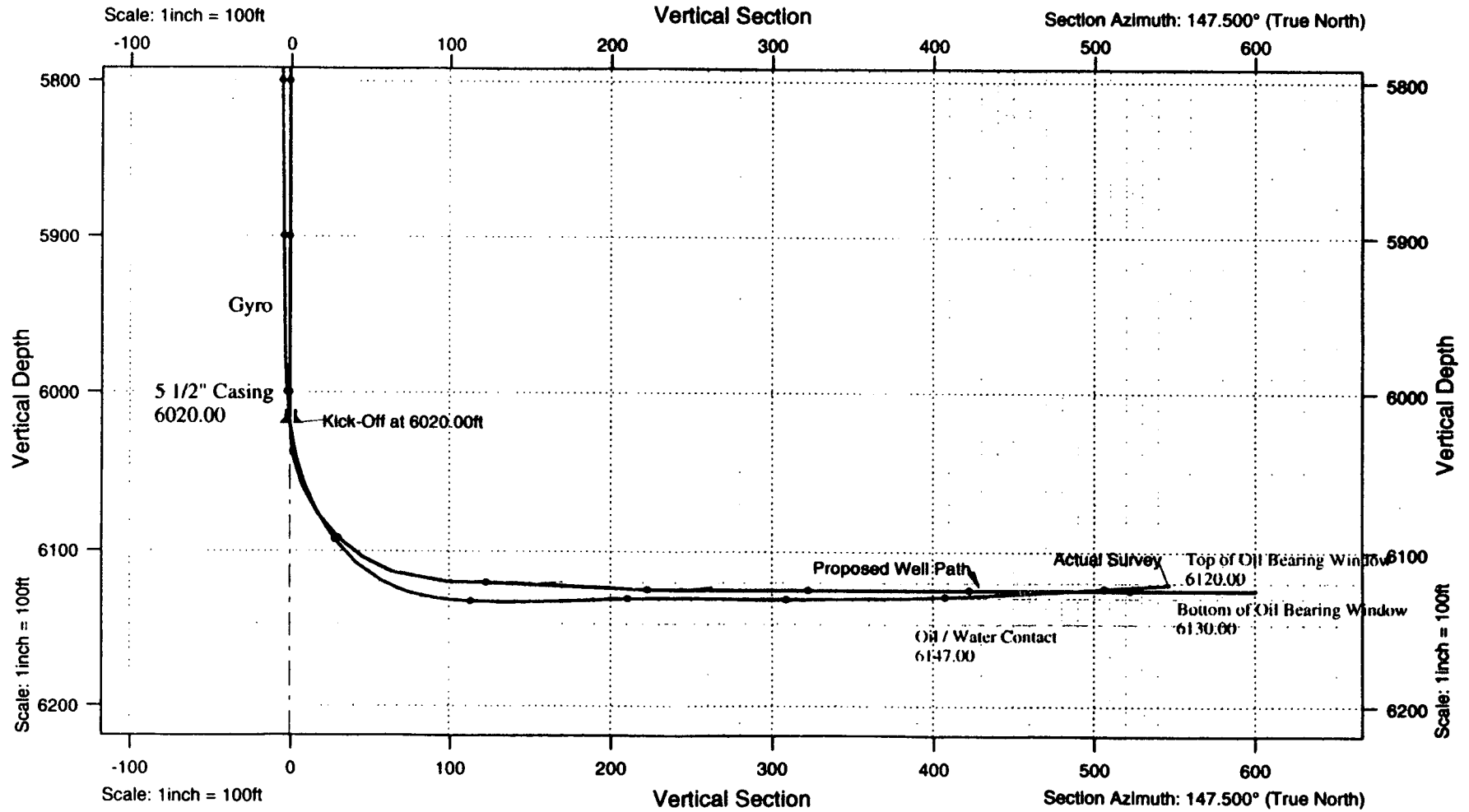

Prepared:

Checked:

Approved:

Kansas
Seward County
Sec. 28-T32S-R34W
Hitch S #2

Scale: 1 inch = 100ft

Eastings

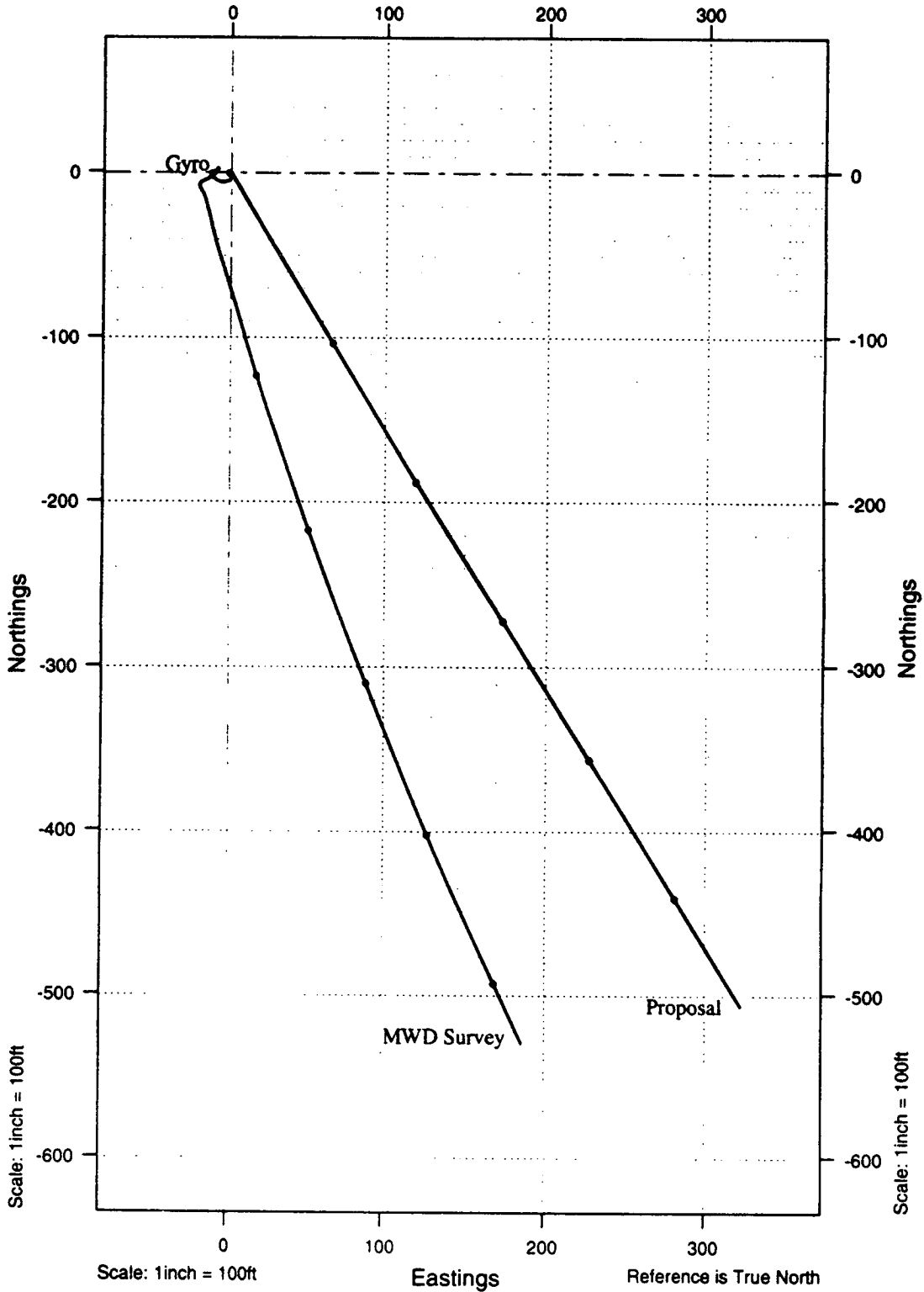

Prepared:

Checked:

Approved:

SCIENTIFIC DRILLING INTERNATIONAL
CASPER, WYOMING

Finder Survey
for

OXY U.S.A.
P.O. BOX 2528
LIBERAL KANSAS 67905

Job Number : 41FW1199105
Well Number : HITCH S # 2
Site Location : SEWARD COUNTY, KANSAS
Latitude : 37.250
Survey Date(s) : 18-NOV-1999
S.D.C. personnel : DAVE DONEY
Calculation Method : Minimum Curvature
Survey Depth Zero : K.B
Proposal Direction : 147.50
Depth Unit : Feet

Comments :

MAR 17 1999
AUS BARS

Outrun Survey
OXY U.S.A.

Well number : HITCH S # 2

Date : 18-NOV-1999

Measured Depth	Vertical Depth	Vert. Section	Inc Deg	Azimuth Deg	Coordinates		D-leg /100ft
					Latitude	Departure	
0.0	0.00	0.0	0.00	0.00	0.00	0.00	0.00
100.0	100.00	-0.4	0.51	323.57	0.36	-0.26	0.51
200.0	200.00	-1.0	0.29	268.80	0.71	-0.78	0.42
300.0	299.99	-1.3	0.36	264.05	0.67	-1.35	0.07
400.0	399.99	-1.5	0.25	249.66	0.56	-1.86	0.13
500.0	499.99	-1.6	0.32	263.85	0.46	-2.35	0.10
600.0	599.99	-1.6	0.21	173.10	0.25	-2.60	0.39
700.0	699.99	-1.0	0.47	162.21	-0.33	-2.45	0.27
800.0	799.98	-0.2	0.53	153.84	-1.13	-2.12	0.09
900.0	899.98	0.8	0.71	114.16	-1.80	-2.36	0.45
1000.0	999.97	1.6	0.43	111.78	-2.19	-0.44	0.28
1100.0	1099.97	2.5	0.84	180.86	-3.06	-0.10	0.80
1200.0	1199.96	3.3	0.63	217.96	-4.23	-0.45	0.51
1300.0	1299.95	3.4	0.79	250.54	-4.89	-1.44	0.43
1400.0	1399.94	3.0	0.73	254.65	-5.29	-2.71	0.08
1500.0	1499.93	2.5	0.92	262.16	-5.57	-4.12	0.22
1600.0	1599.91	1.4	1.41	273.99	-5.59	-6.14	0.54
1700.0	1699.88	-0.2	1.27	293.05	-5.08	-8.39	0.46
1800.0	1799.86	-2.0	1.05	306.15	-4.10	-10.15	0.34
1900.0	1899.85	-3.6	0.91	307.84	-3.07	-11.51	0.14
2000.0	1999.84	-4.9	0.68	319.91	-2.13	-12.52	0.28
2100.0	2099.83	-6.0	0.51	338.60	-1.26	-13.07	0.26
2200.0	2199.83	-6.7	0.42	348.16	-0.49	-13.30	0.12
2300.0	2299.83	-7.2	0.38	30.84	0.15	-13.21	0.29
2400.0	2399.82	-7.4	0.33	56.92	0.59	-12.80	0.17
2500.0	2499.82	-7.2	0.46	87.37	0.77	-12.15	0.24
2600.0	2599.82	-6.8	0.44	89.96	0.79	-11.37	0.03
2700.0	2699.82	-6.5	0.40	72.29	0.90	-10.65	0.13
2800.0	2799.82	-6.3	0.33	69.02	1.10	-10.05	0.07
2900.0	2899.81	-6.2	0.36	77.84	1.27	-9.48	0.06
3000.0	2999.81	-6.1	0.12	27.55	1.43	-9.12	0.30
3100.0	3099.81	-6.3	0.28	20.68	1.75	-8.99	0.16
3200.0	3199.81	-6.6	0.27	18.33	2.21	-8.83	0.02
3300.0	3299.81	-6.9	0.19	346.56	2.59	-8.79	0.15
3400.0	3399.81	-7.1	0.08	67.38	2.78	-8.76	0.19
3500.0	3499.81	-6.8	0.32	128.26	2.63	-8.48	0.29
3600.0	3599.81	-6.4	0.17	165.28	2.32	-8.22	0.21
3700.0	3699.81	-6.2	0.25	226.53	2.02	-8.34	0.22
3800.0	3799.80	-6.1	0.29	223.88	1.69	-8.68	0.04

COPY

STATE CORPORATION COMMISSION OF KANSAS
OIL & GAS CONSERVATION DIVISION
WELL COMPLETION FORM
ACO-1 WELL HISTORY
DESCRIPTION OF WELL AND LEASE

RECEIVED
KANSAS CORPORATION COMMISSION

API NO. 15-175-21701-0101

County Seward

SECTION - W/2 - NW - NE Sec. 28 Twp. 32S Rge. 34W

750 Feet from the North Line of the Section

2480 Feet from the East Line of the Section

Footages Calculated from Nearest Outside Section Corner:
NE, SE, NW or SW (circle one)

Lease Name Hitch S Well # 2

Field Name Shuck

Producing Formation Chester

Elevation: Ground 2913 KB 2923

Total Depth 6131 TVD PBTD 6640 MD

Amount of Surface Pipe Set and Cemented at Feet

Multiple Stage Cementing Collar Used? Yes X No

If yes, show depth set Feet

If Alternate II completion, cement circulated from

feet depth to w/ sx cmt.

Drilling Fluid Management Plan
(Data must be collected from the Reserve Pit)

Chloride content 1100 ppm Fluid volume 600 bbls

Dewatering method used Evaporation

Location of fluid disposal if hauled offsite:

Operator Name

Lease Name License No.

Quarter Sec. Twp. S Rng. W

County Docket No.

Operator: License # 5447

Name: OXY USA, Inc. AUG 10 2000

Address P.O. Box 2528

City/State/Zip Liberal, KS 67905

Purchaser: Pending

Operator Contact Person: Del Oliver

Phone (316) 629-4200

Contractor: Name: Cheyenne Drilling Inc

License: 5382

Wellsite Geologist:

Designate Type of Completion

New Well Re-Entry X Workover

X Oil SWD SIOW Temp. Abd.

Gas ENHR SIGW

Dry Other (Core, WSW, Expl., Cathodic, etc)

If Workover:

Operator: OXY USA, Inc.

Well Name: Hitch S #2

Comp. Date 4/30/98 Old Total Depth 6176

Deepening Re-perf. Conv. to Inj/SWD

Plug Back PBTD

Commingled Docket No.

Dual Completion Docket No.

X Other (SWD or Inj?) Docket No. Horizontal

11/18/99 12/1/99 2/18/00

Spud Date Date Reached TD Completion Date

INSTRUCTIONS: An original and two copies of this form shall be filed with the Kansas Corporation Commission, 130 S. Market - Room 2078, Wichita, Kansas 67202, within 120 days of the spud date, recompletion, workover or conversion of a well. Rule 82-3-130, 82-3-106 and 82-3-107 apply. Information on side two of this form will be held confidential for a period of 12 months if requested in writing and submitted with the form (see rule 82-3-107 for confidentiality in excess of 12 months). One copy of all wireline logs and geologist well report shall be attached with this form. ALL CEMENTING TICKETS MUST BE ATTACHED. Submit CP-4 form with all plugged wells. Submit CP-111 form with all temporarily abandoned wells.

All requirements of the statutes, rules and regulations promulgated to regulate the oil and gas industry have been fully complied with and the statements herein are complete and correct to the best of my knowledge.

Signature Delbert A. Oliver
Title Production Lead Date 8/9/00
Subscribed and sworn to before me this 9th day of August, 2000.
Notary Public Anita Peterson
Date Commission Expires Oct. 1, 2001

K.C.C. OFFICE USE ONLY
F Letter of Confidentiality Attached
C Wireline Log Received
C Geologist Report Received
Distribution
KCC SWD/Rep NGPA
KGS Plug Other
(Specify)

NOTARY PUBLIC, State of Kansas
ANITA PETERSON
My Appt. Exp. Oct. 1, 2001

SIDE TWO

Operator Name OXY USA, Inc.

Lease Name Hitch S Well # 2

Sec. 28 Twp. 32S Rge. 34W

County Seward

INSTRUCTIONS: Show important tops and base of formations penetrated. Detail all cores. Report all drill stem tests giving interval tested, time tool open and closed, flowing and shut-in pressures, whether shut-in pressure reached static level, hydrostatic pressures, bottom hole temperature, fluid recovery, and flow rates if gas to surface during test. Attach extra sheet if more space is needed. Attach copy of log.

Drill Stem Tests Take Yes No
(Attach Additional Sheets.)

Samples Sent to Geological Survey Yes No

Cores Taken Yes No

Electric Log Run Yes No
(Submit Copy.)

List All E.Logs Run:

Log Formation (Top), Depth and Datums Sample
Name Top Datum

CASING RECORD New Used

Report all strings set-conductor, surface, intermediate, production, etc.

Purpose of String	Size Hole Drilled	Size Casing Set (In O.D.)	Weight Lbs./Ft.	Setting Depth	Type of Cement	# Sacks Used	Type and Percent Additives
Liner	4.75"	3.5"	9.2	6238		0	

ADDITIONAL CEMENTING/SQUEEZE RECORD

Purpose:	Depth Top - Bottom	Type of Cement	# Sacks Used	Type and Percent Additives
<input type="checkbox"/> Perforate				
<input type="checkbox"/> Protect Casing	9114-9118	H	75	First 25 sks was Micro Matrix, followed by 50 sks
<input type="checkbox"/> Plug Back TD	-			Cl H. PBTD now 6100' in Vertical Wellbore
<input checked="" type="checkbox"/> Plug Off Zone	-			

Shots Per Foot	PERFORATION RECORD - Bridge Plugs Set/Type Specify Footage of Each Interval Perforated	Acid, Fracture, Shot, Cement Squeeze Record (Amount and Kind of Material Used)	Depth
Non	Open Hole from 6238 to 6640 Horizontal Wellbore Window cut in 5.5" csg at 6011 to 6018 w/ 3.5"	None.	
		line to 6238 (not cemented).	

TUBING RECORD	Size	Set At	Packer At	Liner Run
	None			<input checked="" type="checkbox"/> Yes <input type="checkbox"/> No

Date of First, Resumed Production, SWD or Inj.	Producing Method
None	<input type="checkbox"/> Flowing <input type="checkbox"/> Pumping <input type="checkbox"/> Gas Lift <input checked="" type="checkbox"/> Other (Explain)

Estimated Production Per 24 Hours	Oil Bbls. TA'd	Gas Mcf	Water Bbls.	Gas-Oil Ratio	Gravity

Disposition of Gas:

METHOD OF COMPLETION

Production Interval _____

Vented Sold Used on Lease Open Hole Perf. Dually Comp. Commingled _____
(If vented, submit ACO-18.)

Other (Specify) _____

COPY

STATE CORPORATION COMMISSION OF KANSAS
OIL & GAS CONSERVATION DIVISION
WELL COMPLETION FORM
ACO-1 WELL HISTORY
DESCRIPTION OF WELL AND LEASE

Operator: License # 5447
Name: OXY USA, Inc.
Address P.O. Box 2528

City/State/Zip Liberal, KS 67905

Purchaser: _____

Operator Contact Person: Del Oliver

Phone (316) 629-4200

Contractor: Name: Cheyenne Drilling Inc

License: 5382

Wellsite Geologist: None

Designate Type of Completion

New Well Re-Entry Workover

Oil SWD SLOW Temp. Abd.
 Gas ENHR SIGW
 Dry Other (Core, WSW, Expl., Cathodic, etc)

If Workover:

Operator: OXY USA, Inc.

Well Name: Hitch S

Comp. Date 4-30-98 Old Total Depth 6176

Deepening Re-perf. Conv. to Inj/SWD
 Plug Back PBDT
 Commingled Docket No. _____
 Dual Completion Docket No. _____
 Other (SWD or Inj?) Docket No. Horizontal

11-18-99 12-1-99 2-18-00
Spud Date Date Reached TD Completion Date

API NO. 15-175-21701 - 0101

County Seward

W/2 -NW- NE Sec. 28 Twp. 32S Rge. 34W

750 Feet from the North Line of the Section

2480 Feet from the East Line of the Section

Footages Calculated from Nearest Outside Section Corner:
NE, SE, NW or SW (circle one)

Lease Name Hitch S Well # 2

Field Name Shuck

Producing Formation Chester

Elevation: Ground 2913 KB 2923

Total Depth 6131 TVD PBDT 6640 MD

Amount of Surface Pipe Set and Cemented at _____ Feet

Multiple Stage Cementing Collar Used? Yes No

If yes, show depth set _____ Feet

If Alternate II completion, cement circulated from _____

feet depth to _____ w/ _____ sx cmt.

Drilling Fluid Management Plan
(Data must be collected from the Reserve Pit)

Chloride content 1100 ppm Fluid volume 600 bbls

Dewatering method used Evaporation

Location of fluid disposal if hauled offsite:

Operator Name _____

Lease Name _____ License No. _____

Quarter Sec. _____ Twp. S Rng. W

County _____ Docket No. _____

STATE CORPORATION COMMISSION
RECEIVED
CONSERVATION DIVISION
Wichita, Kansas
MAR 31 2000

INSTRUCTIONS: An original and two copies of this form shall be filed with the Kansas Corporation Commission, 130 S. Market - Room 2078, Wichita, Kansas 67202, within 120 days of the spud date, recompletion, workover or conversion of a well. Rule 82-3-130, 82-3-106 and 82-3-107 apply. Information on side two of this form will be held confidential for a period of 12 months if requested in writing and submitted with the form (see rule 82-3-107 for confidentiality in excess of 12 months). One copy of all wireline logs and geologist well report shall be attached with this form. ALL CEMENTING TICKETS MUST BE ATTACHED. Submit CP-4 form with all plugged wells. Submit CP-111 form with all temporarily abandoned wells.

All requirements of the statutes, rules and regulations promulgated to regulate the oil and gas industry have been fully complied with and the statements herein are complete and correct to the best of my knowledge.

Signature Delbert G. Oliver

Title OPS ENGR Date 30 MAR 00

Subscribed and sworn to before me this 30 day of March,
18 2000.

Notary Public Anita Peterson

Date Commission Expires Oct. 1, 2001

K.C.C. OFFICE USE ONLY
F Letter of Confidentiality Attached
C Wireline Log Received
C Geologist Report Received

Distribution
____ KCC _____ SWD/Rep _____ NGPA
____ KGS _____ Plug _____ Other
(Specify)

NOTARY PUBLIC, State of Kansas
ANITA PETERSON
My Appt. Exp. Oct. 1, 2001

Operator Name OXY USA, Inc.
 Sec. 28 Twp. 32S Rge. 34W

Lease Name Hitch S Well # 2
 County Seward

INSTRUCTIONS: Show important tops and base of formations penetrated. Detail all cores. Report all drill stem tests giving interval tested, time tool open and closed, flowing and shut-in pressures, whether shut-in pressure reached static level, hydrostatic pressures, bottom hole temperature, fluid recovery, and flow rates if gas to surface during test. Attach extra sheet if more space is needed. Attach copy of log.

Drill Stem Tests Take (Attach Additional Sheets.) <input type="checkbox"/> Yes <input checked="" type="checkbox"/> No Samples Sent to Geological Survey <input type="checkbox"/> Yes <input checked="" type="checkbox"/> No Cores Taken <input type="checkbox"/> Yes <input checked="" type="checkbox"/> No Electric Log Run (Submit Copy.) <input type="checkbox"/> Yes <input checked="" type="checkbox"/> No List All E.Logs Run:	<input checked="" type="checkbox"/> Log Formation (Top), Depth and Datums <input type="checkbox"/> Sample <table border="0" style="width:100%"> <tr> <td style="width:60%">Name</td> <td style="width:20%">Top</td> <td style="width:20%">Datum</td> </tr> <tr> <td>Chester</td> <td>6106</td> <td>-3179</td> </tr> </table>	Name	Top	Datum	Chester	6106	-3179
Name	Top	Datum					
Chester	6106	-3179					

CASING RECORD New Used

Report all strings set-conductor, surface, intermediate, production, etc.

Purpose of String	Size Hole Drilled	Size Casing Set (In O.D.)	Weight Lbs./Ft.	Setting Depth	Type of Cement	# Sacks Used	Type and Percent Additives
Liner	4.75"	3.5"	9.2	6238		0	

ADDITIONAL CEMENTING/SQUEEZE RECORD

Purpose:	Depth Top - Bottom	Type of Cement	# Sacks Used	Type and Percent Additives
<input type="checkbox"/> Perforate				
<input type="checkbox"/> Protect Casing	6114-6118	H	75	First 25 Sks was Micro Matrix, followed by 50 Sacks Cl H.
<input type="checkbox"/> Plug Back TD	-			PBTD now 6100' in Vertical Wellbore
<input checked="" type="checkbox"/> Plug Off Zone	-			

Shots Per Foot	PERFORATION RECORD - Bridge Plugs Set/Type Specify Footage of Each Interval Perforated	Acid, Fracture, Shot, Cement Squeeze Record (Amount and Kind of Material Used)	Depth
None	Open Hole from 6238 to 6640 Horizontal Wellbore Window cut in 5.5" csq at 6011 to 6018 with 3.5"	None	
		Liner to 6238 (Not Cemented).	

TUBING RECORD	Size	Set At	Packer At	Liner Run
	None			<input checked="" type="checkbox"/> Yes <input type="checkbox"/> No

Date of First, Resumed Production, SWD or Inj. None Producing Method Flowing Pumping Gas Lift Other (Explain)

Estimated Production Per 24 Hours	Oil Bbls. TA'd	Gas Mcf	Water Bbls.	Gas-Oil Ratio	Gravity

Disposition of Gas:

METHOD OF COMPLETION

Production Interval _____

- Vented Sold Used on Lease Open Hole Perf. Dually Comp. Commingled
 (If vented, submit ACO-18.) Other (Specify) Temporarily Abandon

COPY

STATE CORPORATION COMMISSION OF KANSAS
OIL & GAS CONSERVATION DIVISION
WELL COMPLETION FORM
ACO-1 WELL HISTORY
DESCRIPTION OF WELL AND LEASE

RECEIVED
KANSAS CORPORATION COMMISSION

Operator: License # 5447

Name: OXY USA, Inc.

Address P.O. Box 2528

City/State/Zip Liberal, KS 67905

Purchaser: _____

Operator Contact Person: Del Oliver

Phone (316) 629-4200

Contractor: Name: Cheyenne Drilling Inc

License: 5382

Wellsite Geologist: None

Designate Type of Completion

New Well Re-Entry Workover

Oil SWD SIOW Temp. Abd.

Gas ENHR SIGW

Dry Other (Core, WSW, Expl., Cathodic, etc)

If Workover:

Operator: OXY USA, Inc.

Well Name: Hitch S

Comp. Date 4-30-98 Old Total Depth 6176

old well

Deepening Re-perf. Conv. to Inj/SWD

Plug Back PBDT

Commingled Docket No. _____

Dual Completion Docket No. _____

Other (SWD or Inj?) Docket No. Horizontal

11-18-99 12-1-99 2-18-00

Spud Date Date Reached TD Completion Date

API NO. 15-175-21701 - 0101

County Seward

W/2 -NW- NE Sec. 28 Twp. 32S Rge. 34W

750 Feet from the North Line of the Section

2480 Feet from the East Line of the Section

Footages Calculated from Nearest Outside Section Corner:
NE, SE, NW or SW (circle one)

Lease Name Hitch S Well # 2

Field Name Shuck

Producing Formation Chester

Elevation: Ground 2913 KB 2923

Total Depth 6131 TVD PBDT 6640 MD

Amount of Surface Pipe Set and Cemented at _____ Feet

Multiple Stage Cementing Collar Used? Yes No

If yes, show depth set _____ Feet

If Alternate II completion, cement circulated from _____

feet depth to _____ w/ _____ sx cmt.

Drilling Fluid Management Plan

(Data must be collected from the Reserve Pit)

Chloride content 1100 ppm Fluid volume 600 bbls

Dewatering method used Evaporation

Location of fluid disposal if hauled offsite:

Operator Name _____

Lease Name _____ License No. _____

Quarter Sec. _____ Twp. S Rng. W

County _____ Docket No. _____

CONSERVATION DIVISION
WICHITA, KS

RECEIVED
MAR 31 2000
CONSERVATION DIVISION
Wichita, Kansas

STATE CORPORATION COMMISSION
RECEIVED

New Well

INSTRUCTIONS: An original and two copies of this form shall be filed with the Kansas Corporation Commission, 130 S. Market - Room 2078, Wichita, Kansas 67202, within 120 days of the spud date, recompletion, workover or conversion of a well. Rule 82-3-130, 82-3-106 and 82-3-107 apply. Information on side two of this form will be held confidential for a period of 12 months if requested in writing and submitted with the form (see rule 82-3-107 for confidentiality in excess of 12 months). One copy of all wireline logs and geologist well report shall be attached with this form. ALL CEMENTING TICKETS MUST BE ATTACHED. Submit CP-4 form with all plugged wells. Submit CP-111 form with all temporarily abandoned wells.

All requirements of the statutes, rules and regulations promulgated to regulate the oil and gas industry have been fully complied with and the statements herein are complete and correct to the best of my knowledge.

Signature Delbert S. Oliver

Title OPS ENGR Date 30 MAR 00

Subscribed and sworn to before me this 30 day of March, 2000.

Notary Public Anita Peterson

Date Commission Expires Oct. 1, 2001

K.C.C. OFFICE USE ONLY		
F	<input type="checkbox"/>	Letter of Confidentiality Attached
C	<input type="checkbox"/>	Wireline Log Received
C	<input type="checkbox"/>	Geologist Report Received
Distribution		
<input type="checkbox"/>	KCC	<input type="checkbox"/> SWD/Rep <input type="checkbox"/> NGPA
<input type="checkbox"/>	KGS	<input type="checkbox"/> Plug <input type="checkbox"/> Other
(Specify)		

NOTARY PUBLIC, State of Kansas
ANITA PETERSON
My Appt. Exp. Oct. 1, 2001

Operator Name OXY USA, Inc.
 Sec. 28 Twp. 32S Rge. 34W

Lease Name Hitch S Well # 2
 County Seward

INSTRUCTIONS: Show important tops and base of formations penetrated. Detail all cores. Report all drill stem tests giving interval tested, time tool open and closed, flowing and shut-in pressures, whether shut-in pressure reached static level, hydrostatic pressures, bottom hole temperature, fluid recovery, and flow rates if gas to surface during test. Attach extra sheet if more space is needed. Attach copy of log.

Drill Stem Tests Take (Attach Additional Sheets.) <input type="checkbox"/> Yes <input checked="" type="checkbox"/> No Samples Sent to Geological Survey <input type="checkbox"/> Yes <input checked="" type="checkbox"/> No Cores Taken <input type="checkbox"/> Yes <input checked="" type="checkbox"/> No Electric Log Run (Submit Copy.) <input type="checkbox"/> Yes <input checked="" type="checkbox"/> No List All E.Logs Run:	<input checked="" type="checkbox"/> Log Formation (Top), Depth and Datums <input type="checkbox"/> Sample <table border="0" style="width:100%"> <tr> <td style="width:60%">Name</td> <td style="width:20%">Top</td> <td style="width:20%">Datum</td> </tr> <tr> <td>Chester</td> <td>6106</td> <td>-3179</td> </tr> </table>	Name	Top	Datum	Chester	6106	-3179
Name	Top	Datum					
Chester	6106	-3179					

CASING RECORD New Used
 Report all strings set-conductor, surface, intermediate, production, etc.

Purpose of String	Size Hole Drilled	Size Casing Set (In O.D.)	Weight Lbs./Ft.	Setting Depth	Type of Cement	# Sacks Used	Type and Percent Additives
Liner	4.75"	3.5"	9.2	6238		0	

ADDITIONAL CEMENTING/SQUEEZE RECORD

Purpose:	Depth Top - Bottom	Type of Cement	# Sacks Used	Type and Percent Additives
<input type="checkbox"/> Perforate <input type="checkbox"/> Protect Casing <input type="checkbox"/> Plug Back TD <input checked="" type="checkbox"/> Plug Off Zone	6114-6118	H	75	First 25 Sks was Micro Matrix, followed by 50 Sacks Cl H. PBTD now 6100' in Vertical Wellbore

Shots Per Foot	PERFORATION RECORD - Bridge Plugs Set/Type Specify Footage of Each Interval Perforated	Acid, Fracture, Shot, Cement Squeeze Record (Amount and Kind of Material Used)	Depth
None	Open Hole from 6238 to 6640 Horizontal Wellbore Window cut in 5.5" csq at 6011 to 6018 with 3.5" Liner to 6238 (Not Cemented).	None	

TUBING RECORD Size None Set At _____ Packer At _____ Liner Run Yes No

Date of First, Resumed Production, SWD or Inj. None Producing Method Flowing Pumping Gas Lift Other (Explain)

Estimated Production Per 24 Hours	Oil Bbls. TA'd	Gas Mcf	Water Bbls.	Gas-Oil Ratio	Gravity
-----------------------------------	----------------	---------	-------------	---------------	---------

Disposition of Gas: **METHOD OF COMPLETION** Production Interval _____
 Vented Sold Used on Lease Open Hole Perf. Dually Comp. Commingled _____
 (If vented, submit ACO-18.) Other (Specify) Temporarily Abandon