

Original

15-051-25059-00-00

K C C H H Y S D U #4

TEL No. 913-628-6913

Sep 18, :0 8:30 No.002 P.01

For KCC Use: Effective Date: 10-11-2000 District # 4 SGA? [X] Yes [] No

KANSAS CORPORATION COMMISSION OIL & GAS CONSERVATION DIVISION NOTICE OF INTENT TO DRILL

Form C-1 September 1999 Form must be Typed Form must be Signed All blanks must be Filled

Must be approved by KCC five (5) days prior to commencing well

Expected Spud Date Nov 6th 2000 month day year

Spud SE-NE-SW Sec. 12 Twp. 11 S. R. 17 1,650 feet from S N 2,970 feet from E W Is SECTION X Regular Irregular?

OPERATOR: License# #30762 Name: Oil Company of America, Inc. Address: 1200 Main Suite #406 City/State/Zip: Hays, Kansas 67601 Contact Person: Darrell Herl Phone: (785) 625-3800

County: Ellis Lease Name: Slimmer Well #: 3 Field Name: Bemis

CONTRACTOR: License# #31548 Name: Discovery Frilling Company, Inc.

Is this a Prorated Spaced Flood? [X] Yes [] No Target Formation(s): KC Lime or Arbuckle

Table with columns: Well Drilled For, Well Class, Type Equipment. Includes checkboxes for Oil, Gas, OWD, Seismic, Other, Enh Rec, Storage, Disposal, Infield, Pool Ext, Wildcat, Other, Mud Rotary, Air Rotary, Cable.

Nearest Lease or unit boundary: 330 Ft. Ground Surface Elevation: 1812 feet MSL Water well within one-quarter mile: [X] Yes [] No Public water supply well within one mile: [] Yes [X] No Depth to bottom of fresh water: 180 Ft. Depth to bottom of usable water: 650' 520 B/DAKOTA Surface Pipe by Alternate: X 1 2

If OWWO: old well information as follows: Operator: Well Name: N/A Original Completion Date: Original Total Depth: Directional, Deviated or Horizontal wellbore? [] Yes [X] No If Yes, true vertical depth: Bottom Hole Location: KCC DKT #:

Length of Surface Pipe Planned to be set: 1010 Ft. Length of Conductor Pipe required: None Projected Total Depth: 3,450 Formation at Total Depth: Arbuckle Water Source for Drilling Operations: Well Farm Pond Other River DWR Permit #: Will Cores be taken? [] Yes [X] No If Yes, proposed zone:

AFFIDAVIT

RECEIVED STATE CORPORATION COMMISSION

The undersigned hereby affirms that the drilling, completion and eventual plugging of this well will comply with K.S.A. 55-101, et seq. It is agreed that the following minimum requirements will be met: 1. Notify the appropriate district office prior to spudding of well; 2. A copy of the approved notice of intent to drill shall be posted on each drilling rig; 3. The minimum amount of surface pipe as specified below shall be set by circulating cement to the top; in all cases surface pipe shall be set through all unconsolidated materials plus a minimum of 20 feet into the underlying formation; 4. If the well is dry hole, an agreement between the operator and the district office on plug length and placement is necessary prior to plugging; 5. The appropriate district office will be notified before well is either plugged or production casing is cemented in; 6. If an ALTERNATE II COMPLETION, production pipe shall be cemented from below any usable water to surface within 120 days of spud date. In all cases, NOTIFY district office prior to any cementing.

OCT 4 2000 10-4-2000 CONSERVATION DIVISION

I hereby certify that the statements made herein are true and to the best of my knowledge and belief. Date: 10-2-00 Signature of Operator or Agent: Darrell Herl Title: Pres.

For KCC Use ONLY API # 15: 051-25059-0000 Conductor pipe required: NONE feet Minimum surface pipe required: 540 feet per Alt. (1) X Approved by: JK 10-6-2000 This authorization expires: 4-6-2001 (This authorization void if drilling not started within 6 months of effective date.)

Remember to: - File Drill Pit Application (form CDP-1) with Intent to Drill; - File Completion Form ACO-1 within 120 days of spud date; - File acreage attribution plat according to field proration orders; - Notify appropriate district office 48 hours prior to workover or re-entry; - Submit plugging report (CP-4) after plugging is completed; - Obtain written approval before disposing or injecting salt water.

12 11 175

Side Two

IN ALL CASES PLOT THE INTENDED WELL ON THE PLAT BELOW

Plat of acreage attributable to a well in a prorated or spaced field

If the intended well is in a prorated or spaced field, please fully complete this side of the form. If the intended well is in a prorated or spaced field complete the plat below showing that the well will be properly located in relationship to other wells producing from the common source of supply. Please show all the wells and within 1 mile of the boundaries of the proposed acreage attribution unit for gas wells and within 1/2 mile of the boundaries of the proposed acreage attribution unit for oil wells.

API No. 15 _____
 Operator: Oil Company of America, Inc.
 Lease: Slimmer
 Well Number: #3
 Field: Bemis
 Number of Acres attributable to well: 10
 QTR / QTR / QTR of acreage: SE NE SW

Location of Well: County: Ellis
1650' feet from S / N (circle one) Line of Section
2970' feet from E / W (circle one) Line of Section
 Sec. 12 Twp. 11 S. R. 17 East West
 Is Section Regular or Irregular
 If Section Is Irregular, locate well from nearest corner boundary.
 Section corner used: NE NW SE SW

PLAT

(Show location of the well and shade attributable acreage for prorated or spaced wells.)
(Show footage to the nearest lease or unit boundary line.)

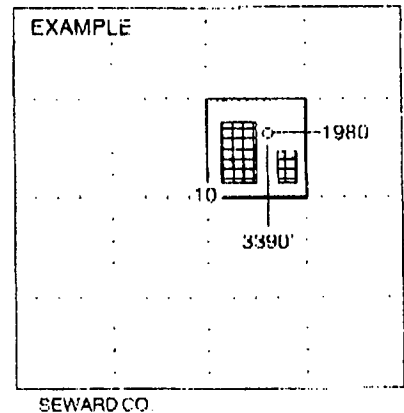
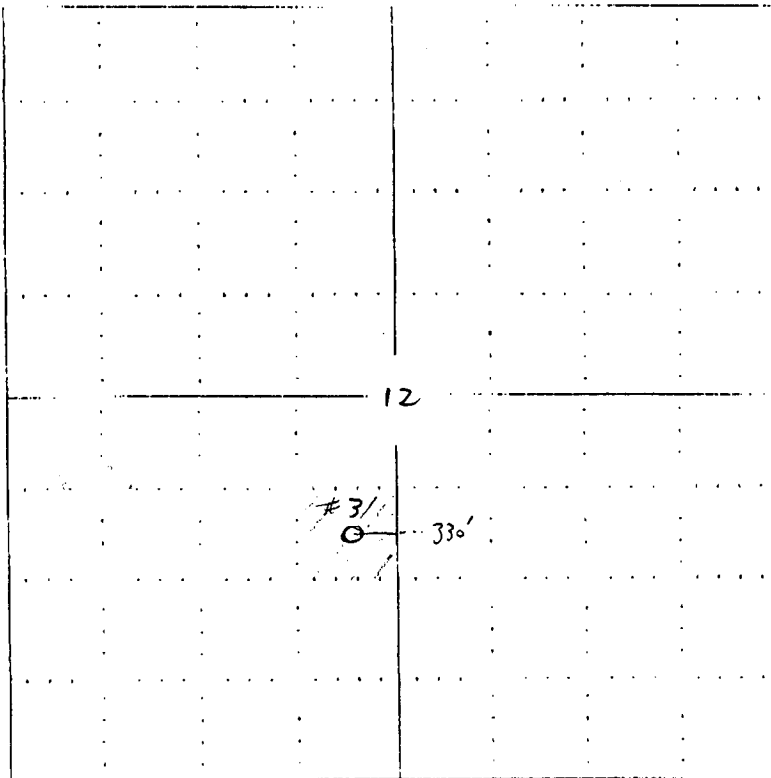

NOTE: In all cases locate the spot of the proposed drilling location.

In plotting the proposed location of the well, you must show:

1. The manner in which you are using the depicted plat by identifying section lines, i.e. 1 section, 1 section with 8 surrounding sections, 4 sections, etc.
2. The distance of the proposed drilling location from the section's south / north and east / west.
3. The distance to the nearest lease or unit boundary line.
4. If proposed location is located within a prorated or spaced field a certificate of acreage attribution plat must be attached: (CO-7 for oil wells; CG-8 for gas wells).

RECEIVED
STATE CORPORATION COMMISSION

OCT 4 2000
 10-4-2000
 CONSERVATION DIVISION
 Wichita, Kansas