

STATE OF KANSAS  
STATE CORPORATION COMMISSION

15-193-30030-00-00  
WELL PLUGGING RECORD

Give All Information Completely  
Make Required Affidavit  
Mail or Deliver Report to:  
Conservation Division  
State Corporation Commission  
212 North Market, Insurance Bldg.  
Wichita, Kansas

Thomas County, Sec. 2 Twp. 10s Rge. 33W (E) (W)

Location as "NE/CNW/SW" or footage from lines C NW NW  
Lease Owner John O. Farmer, Inc.  
Lease Name Hodges "B" Well No. 1  
Office Address P.O. Box 352, Russell, Kansas  
Character of Well (completed as Oil, Gas or Dry Hole) Dry  
Date well completed 9/19 1963  
Application for plugging filed 9/19 1963  
Application for plugging approved 9/19 1963  
Plugging commenced 9/19 1963  
Plugging completed 6 A.M. 9/19 1963  
Reason for abandonment of well or producing formation Dry

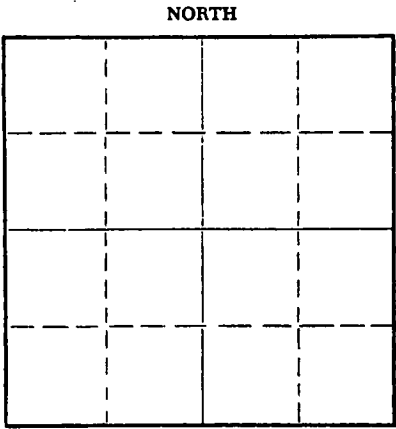

Locate well correctly on above Section Plat

If a producing well is abandoned, date of last production \_\_\_\_\_ 19\_\_\_\_  
Was permission obtained from the Conservation Division or its agents before plugging was commenced? Yes

Name of Conservation Agent who supervised plugging of this well W. L. Nichols  
Producing formation \_\_\_\_\_ Depth to top \_\_\_\_\_ Bottom \_\_\_\_\_ Total Depth of Well 4819 Feet  
Show depth and thickness of all water, oil and gas formations.

OIL, GAS OR WATER RECORDS

CASING RECORD

FORMATION	CONTENT	FROM	TO	SIZE	PUT IN	PULLED OUT

Describe in detail the manner in which the well was plugged, indicating where the mud fluid was placed and the method or methods used in introducing it into the hole. If cement or other plugs were used, state the character of same and depth placed, from \_\_\_\_\_ feet to \_\_\_\_\_ feet for each plug set.

Plug # 1 set @ 600' 20 sx. cement  
Plug # 2 set @ 270' 20 sx. cement  
Plug # 3 set @ 40' 10 sx. cement

**RECEIVED**  
STATE CORPORATION COMMISSION

SEP 26 1963  
09-26-1963  
CONSERVATION DIVISION  
Wichita, Kansas

(If additional description is necessary, use BACK of this sheet)  
Name of Plugging Contractor John O. Farmer, Inc.  
Address P.O. Box 352, Russell, Kansas

STATE OF KANSAS, COUNTY OF RUSSELL, ss.  
John O. Farmer (employee of owner) or (owner or operator) of the above-described well, being first duly sworn on oath, says: That I have knowledge of the facts, statements, and matters herein contained and the log of the above-described well as filed and that the same are true and correct. So help me God.

(Signature) John O. Farmer  
P.O. Box 352, Russell, Kansas  
(Address)

SUBSCRIBED AND SWORN TO before me this 24 day of September, 19 63

My commission expires February 15, 1967  
Helen Carlson Notary Public.

OPERATOR John O. Farmer, Inc.

15-193-30030-00-00

ADDRESS P.O. Box 352, Russell, Kansas

Give detailed description and thickness of all formation drilled through, contents of sand, whether dry, water, oil or gas.

FARM NAME Hodges "B" WELL NO. 1 COUNTY THOMAS SEC 2 TWP 10S, RGE 33W

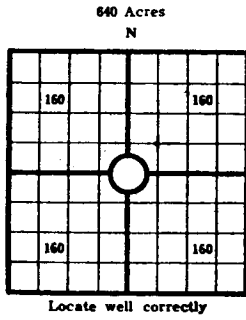

COUNTY Thomas SEC 2 TWP 10S RGE 33W  
 COMPANY OPERATING John O. Farmer, Inc.  
 OFFICE ADDRESS P.O. Box 352, Russell, Kansas  
 DRILLING STARTED 9/6 1963 DRILLING FINISHED 9/19 1963  
 DATE OF FIRST PRODUCTION \_\_\_\_\_ COMPLETED \_\_\_\_\_  
 WELL LOCATED C 1/4 NW 1/4 NW 1/4, North of South  
 Line and \_\_\_\_\_ ft. East of West Line of Quarter Section  
 Elevation (Relative to sea level) DERRICK FLOOR 3123 GROUND 3120  
 CHARACTER OF WELL (Oil, gas or dryhole) Dry

OIL OR GAS SANDS OR ZONES

Name	From	To	Name	From	To
1			4		
2			5		
3			6		

Perforating Record If Any

Shot Record

Formation	From	To	No. of Shots	Formation	Shot		
					From	To	Size of Shot

CASING RECORD

Amount Set						Amount Pulled				Packer Record	
Size	Wt.	Thds.	Make	Ft.	In.	Size	Length	Depth Set	Make		

Liner Record: Amount \_\_\_\_\_ Kind \_\_\_\_\_ Top \_\_\_\_\_ Bottom \_\_\_\_\_

CEMENTING AND MUDDING

Size	Amount Set		Sacks Cement	Chemical		Method of Cementing	Amount	Mudding Method	Results (See Note)
	Ft.	In.		Gal.	Make				
8 5/8"	280'		165	SX.					

Note: What method was used to protect sands if outer strings were pulled? \_\_\_\_\_

NOTE: Were bottom hole plugs used? \_\_\_\_\_ If so, state kind, depth set and results obtained \_\_\_\_\_

TOOLS USED

Rotary Tools were used from 0 feet to T. D. Eable tools were used from \_\_\_\_\_ feet to \_\_\_\_\_ feet, and from \_\_\_\_\_ feet to \_\_\_\_\_ feet, and from \_\_\_\_\_ feet to \_\_\_\_\_ feet

Type Rig Rotary

INITIAL PRODUCTION TEST

Describe initial test: whether by flow through tubing or casing test or by pumping \_\_\_\_\_

Amount of Oil Production \_\_\_\_\_ bbls. Size of choke, if any \_\_\_\_\_ Length of test \_\_\_\_\_ Water

Production \_\_\_\_\_ bbls. Gravity of oil \_\_\_\_\_ Type of Pump if pump is used, describe \_\_\_\_\_

Formation	Top	Bottom	Formation	Top	Bottom
Shale	0	2125			
Shale & Sand	2125	2679			
Shale & Shells	2679	2890			
Shale & Lime	2890	3160			
Lime & Shale	3160	4180			
Lime	4180	4330			
Lime & Shale	4330	4819'			
			Log Tops		
			Heebner	4028	(- 903)
			Toronto	4052	(- 927)
			Lansing KC	4070	(- 945)
			Base KC	4350	(-1225)
			Marmaton	4374	(-1249)
			Cherokee	4532	(-1407)
			Mississippi	4656	(-1531)
			Log T. D.	4817	(-1692)

RECEIVED  
STATE CORPORATION COMMISSION

SEP 26 1963  
09-26-63  
CONSERVATION DIVISION  
WICHITA, KANSAS

I, the undersigned, being first duly sworn upon oath, state that this well record is true, correct and complete according to the records of this office and to the best of my knowledge and belief.

*John O. Farmer*  
 Name and title of representative of company President  
 Subscribed and sworn to before me this 24 day of September, 1963  
*Helen Carlson*  
 My Commission expires 2/15/67  
Helen Carlson Notary Public.