

OWWO

For KCC Use: 4-15-2009
Effective Date: _____
District # _____
SGA? Yes No

KANSAS CORPORATION COMMISSION
OIL & GAS CONSERVATION DIVISION

Form C-1
October 2007

Form must be Typed
Form must be Signed
All blanks must be Filled

NOTICE OF INTENT TO DRILL

Must be approved by KCC five (5) days prior to commencing well

Expected Spud Date: 4/7/08
month day year

Spot Description: 70'w of C-
_____ NW Sec. 21 Twp. 30 S. R. 17 E W
(1/2/1/2) 1,320 feet from N / S Line of Section
1,250 feet from E / W Line of Section

OPERATOR: License# 33936
Name: Charles Griffin
Address 1: _____
Address 2: P. O. Box 127
City: Sawyer State: Ks. Zip: 67134 + 0127
Contact Person: Charles Griffin
Phone: 720/490=5648

Is SECTION: Regular Irregular?
(Note: Locate well on the Section Plat on reverse side)

CONTRACTOR: License# 5929
Name: DUKE DRILLING CO., INC.

County: Kiowa
Lease Name: CANTON "B" Well #: 2

Well Drilled For: Oil Enh Rec Gas Storage Disposal Seismic; _____ # of Holes Other: _____
Well Class: Infield Pool Ext. Wildcat Other: _____
Type Equipment: Mud Rotary Air Rotary Cable

* Field Name: Glick
Is this a Prorated / Spaced Field? Yes No

If OWWO: old well information as follows:
Operator: PETROLEUM, INC.
Well Name: Canton #2
Original Completion Date: 1977 Original Total Depth: 4983'

Target Formation(s): Arbuckle
Nearest Lease or unit boundary line (in footage): 1250'
Ground Surface Elevation: 2075' feet MSL

Directional, Deviated or Horizontal wellbore? Yes No
If Yes, true vertical depth: _____
Bottom Hole Location: _____
KCC DKT #: _____

Water well within one-quarter mile: Yes No
Public water supply well within one mile: Yes No

Depth to bottom of fresh water: 120'
Depth to bottom of usable water: 180'

Surface Pipe by Alternate: I II 523
Length of Surface Pipe Planned to be set: _____

Length of Conductor Pipe (if any): _____
Projected Total Depth: 5525'

Formation at Total Depth: Arbuckle
Water Source for Drilling Operations: Well Farm Pond Other: _____

DWR Permit #: _____
(Note: Apply for Permit with DWR)

Will Cores be taken? Yes No
If Yes, proposed zone: _____

* PRORATED & SPACED: Glick (Mississippi Chert)

AFFIDAVIT

The undersigned hereby affirms that the drilling, completion and eventual plugging of this well will comply with K.S.A. 55 et. seq.
It is agreed that the following minimum requirements will be met:

KANSAS CORPORATION COMMISSION

APR 06 2009
04-06-09
RECEIVED

1. Notify the appropriate district office **prior** to spudding of well;
2. A copy of the approved notice of intent to drill **shall be** posted on each drilling rig;
3. The minimum amount of surface pipe as specified below **shall be set** by circulating cement to the top; in all cases surface pipe **shall be set** through all unconsolidated materials plus a minimum of 20 feet into the underlying formation.
4. If the well is dry hole, an agreement between the operator and the district office on plug length and placement is necessary **prior to plugging**;
5. The appropriate district office will be notified before well is either plugged or production casing is cemented in;
6. If an ALTERNATE II COMPLETION, production pipe shall be cemented from below any usable water to surface within **120 DAYS** of spud date.
Or pursuant to Appendix "B" - Eastern Kansas surface casing order #133,891-C, which applies to the KCC District 3 area, alternate II cementing must be completed within 30 days of the spud date or the well shall be plugged. **In all cases, NOTIFY district office** prior to any cementing.

I hereby certify that the statements made herein are true and correct to the best of my knowledge and belief.

Date: April 6, 2009 Signature of Operator or Agent: Sally B. Byers Title: Agent

For KCC Use ONLY
API # 15 - 097-20401-00-01
Conductor pipe required None feet
Minimum surface pipe required 523 feet per ALT. I II
Approved by: RMB 4-10-2009
This authorization expires: 4-10-2010
(This authorization void if drilling not started within 12 months of approval date.)
Spud date: _____ Agent: _____

- Remember to:
- File Drill Pit Application (form CDP-1) with Intent to Drill;
 - File Completion Form ACO-1 within 120 days of spud date;
 - File acreage attribution plat according to field proration orders;
 - Notify appropriate district office 48 hours prior to workover or re-entry;
 - Submit plugging report (CP-4) after plugging is completed (within 60 days);
 - Obtain written approval before disposing or injecting salt water.
 - If this permit has expired (See: authorized expiration date) please check the box below and return to the address below.
- Well Not Drilled - Permit Expired Date: _____
Signature of Operator or Agent: _____

21
30
17
 E
 W

IN ALL CASES PLOT THE INTENDED WELL ON THE PLAT BELOW

Plat of acreage attributable to a well in a prorated or spaced field

If the intended well is in a prorated or spaced field, please fully complete this side of the form. If the intended well is in a prorated or spaced field complete the plat below showing that the well will be properly located in relationship to other wells producing from the common source of supply. Please show all the wells and within 1 mile of the boundaries of the proposed acreage attribution unit for gas wells and within 1/2 mile of the boundaries of the proposed acreage attribution unit for oil wells.

API No. 15 - 097-20401-00-01
 Operator: Charles Griffin
 Lease: CANTON "B"
 Well Number: 2
 Field: _____

Location of Well: County: Kiowa
 _____ feet from N / S Line of Section
 _____ feet from E / W Line of Section
 Sec. 21 Twp. 30 S. R. 17 E W

Number of Acres attributable to well: _____
 QTR/QTR/QTR/QTR of acreage: _____ - _____ - _____ - _____ NW

Is Section: Regular or Irregular

If Section is Irregular, locate well from nearest corner boundary.

Section corner used: NE NW SE SW

PLAT

(Show location of the well and shade attributable acreage for prorated or spaced wells.)

(Show footage to the nearest lease or unit boundary line.)

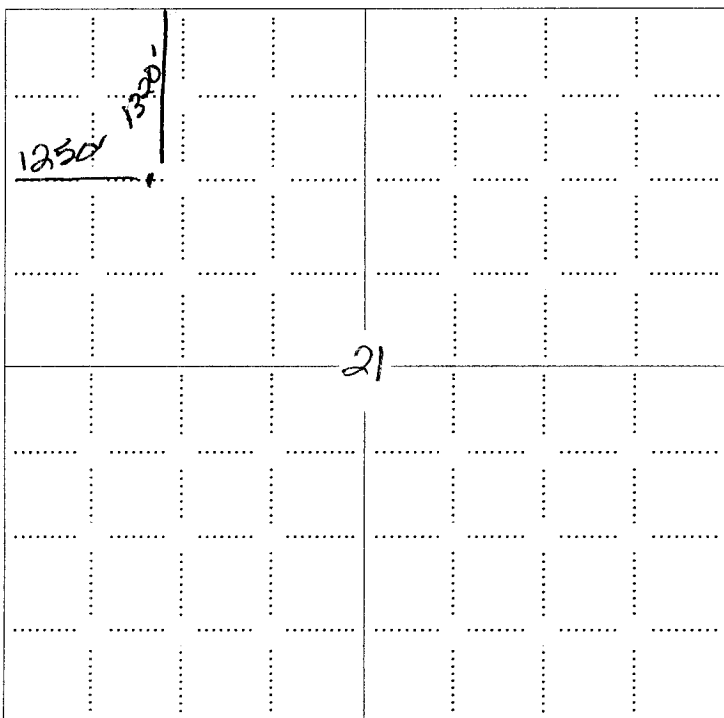

KANSAS CORPORATION COMMISSION

04-06-09

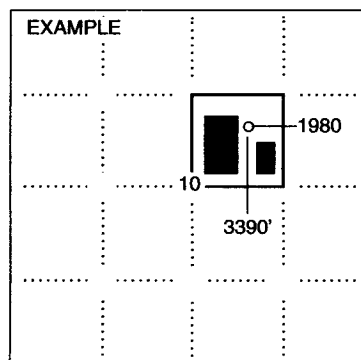

SEWARD CO.

NOTE: In all cases locate the spot of the proposed drilling location.

In plotting the proposed location of the well, you must show:

1. The manner in which you are using the depicted plat by identifying section lines, i.e. 1 section, 1 section with 8 surrounding sections, 4 sections, etc.
2. The distance of the proposed drilling location from the south / north and east / west outside section lines.
3. The distance to the nearest lease or unit boundary line (in footage).
4. If proposed location is located within a prorated or spaced field a certificate of acreage attribution plat must be attached: (CO-7 for oil wells; CG-8 for gas wells).

**KANSAS CORPORATION COMMISSION
OIL & GAS CONSERVATION DIVISION
APPLICATION FOR SURFACE PIT**

Form CDP-1
April 2004
Form must be Typed

Submit in Duplicate

Operator Name: Charles Griffin		License Number: 33936	
Operator Address:		P. O. Box 127 Sawyer Ks. 67134	
Contact Person: Charles Griffin		Phone Number: 720/490-5648	
Lease Name & Well No.: CANTON "B" 2		Pit Location (QQQQ): <u> Ea. W2 NW</u>	
Type of Pit: <input type="checkbox"/> Emergency Pit <input type="checkbox"/> Burn Pit <input type="checkbox"/> Settling Pit <input checked="" type="checkbox"/> Drilling Pit <input type="checkbox"/> Workover Pit <input type="checkbox"/> Haul-Off Pit <small>(If WP Supply API No. or Year Drilled)</small> 15-097-20401		Pit is: <input checked="" type="checkbox"/> Proposed <input type="checkbox"/> Existing If Existing, date constructed: _____ Pit capacity: 4,800 _____ (bbls)	
Is the pit located in a Sensitive Ground Water Area? <input checked="" type="checkbox"/> Yes <input type="checkbox"/> No		Chloride concentration: _____ mg/l <small>(For Emergency Pits and Settling Pits only)</small>	
Is the bottom below ground level? <input checked="" type="checkbox"/> Yes <input type="checkbox"/> No		Artificial Liner? <input type="checkbox"/> Yes <input checked="" type="checkbox"/> No	
How is the pit lined if a plastic liner is not used? Native mud and clay			
Pit dimensions (all but working pits): <u> 100 </u> Length (feet) <u> 100 </u> Width (feet) <input type="checkbox"/> N/A: Steel Pits		Depth from ground level to deepest point: <u> 4 </u> (feet) <input type="checkbox"/> No Pit	
If the pit is lined give a brief description of the liner material, thickness and installation procedure.		Describe procedures for periodic maintenance and determining liner integrity, including any special monitoring.	
Distance to nearest water well within one-mile of pit <u> 4427 </u> feet Depth of water well <u> 220 </u> feet		Depth to shallowest fresh water <u> 110 </u> feet. Source of information: <input type="checkbox"/> measured <input type="checkbox"/> well owner <input type="checkbox"/> electric log <input checked="" type="checkbox"/> KDWR	
Emergency, Settling and Burn Pits ONLY: Producing Formation: _____ Number of producing wells on lease: _____ Barrels of fluid produced daily: _____ Does the slope from the tank battery allow all spilled fluids to flow into the pit? <input type="checkbox"/> Yes <input type="checkbox"/> No		Drilling, Workover and Haul-Off Pits ONLY: Type of material utilized in drilling/workover: <u> fresh </u> Number of working pits to be utilized: <u> 1 </u> Abandonment procedure: <u> allowed to dry then backfilled </u> Drill pits must be closed within 365 days of spud date.	
I hereby certify that the above statements are true and correct to the best of my knowledge and belief.			
Date: <u> 4/6/09 </u>		Signature of Applicant or Agent: <u> Sally R. Byers </u> 04-06-09	
KCC OFFICE USE ONLY			
Date Received: <u> 4/6/09 </u> Permit Number: _____		Permit Date: <u> 4/9/09 </u> Lease Inspection: <input checked="" type="checkbox"/> Yes <input type="checkbox"/> No	

15-097-20401-00-01

Mail to: KCC - Conservation Division, 130 S. Market - Room 2078, Wichita, Kansas 67202



Kathleen Sebelius, Governor
Thomas E. Wright, Chairman
Michael C. Moffet, Commissioner
Joseph F. Harkins, Commissioner

April 9, 2009

Charles Griffin
PO Box 127
Sawyer KS 67134-0127

RE: Drilling Pit Application
Canton B Lease Well No. 2
NW/4 Sec. 21-30S-17W
Kiowa County, Kansas

Dear Sir or Madam:

District staff has inspected the above referenced location and has determined that the reserve pit shall be constructed **without slots**, the bottom shall be flat and reasonably level, **and lined with native clay or bentonite**. **Please call the district office once the pits have been dug.** District will determine at that time if additional measures concerning the pit will need to be taken. Unless notified otherwise, the free fluids must be removed. The fluids are to be removed from the reserve pit as soon as practical after drilling operations have ceased.

If production casing is set all completion fluids shall be removed from the working pits daily. NO completion fluids or non-exempt wastes shall be placed in the reserve pit.

The fluids should be taken to an authorized disposal well. Please call the District Office at (620) 225-8888 when the fluids have been removed. Please file form CDP-5, Exploration and Production Waste Transfer, within 30 days of fluid removal. Conservation division forms are available through our office and on the KCC web site: www.kcc.state.ks.us/conservation/forms.

A copy of this letter should be posted in the doghouse along with the approved Intent to Drill. If you have any questions or concerns please feel free to contact the undersigned at the above address.

Sincerely,

Kathy Haynes
Environmental Protection and Remediation Department

cc: district

KIOWA COUNTY

15-097-20401-00-01

GLICK MISSISSIPPI GAS POOL (30-16W, 30-17W, & 30-18W): Mississippi Chert reservoir

- 1) **Docket No.** 55-164-C (C-5,667)
- 2) **Order(s) issued**
 - A) June 8, 1967
 - B) September 28, 1977
 - C) April 13, 2004
- 3) **Effective** September 28, 1977
- 4) **Acreage** (pp. 1-2 of 9/28/77 Order)
 - A) **T 30S-R 16W:**
 - (1) **Section 7:** the South Half of the South Half (S/2 S/2);
 - (2) **Section 11:** all; and
 - (3) **Sections 13-36:** all
 - B) **T 30S-R 17W:**
 - (1) **Sections 8-19:** all;
 - (2) **Section 20:** the North Half of the Southeast Quarter (N/2 SE/4);
 - (3) **Sections 21-25:** all;
 - (4) **Section 27:** the North Half (N/2);
 - (5) **Section 28:** the East Half of the Northeast Quarter (E/2 NE/4);
 - (6) **Section 30:** the Northernmost 40 acres of the West two-thirds;
 - (7) **Sections 32 & 33:** all of Sections 32 & 33;
 - (8) **Section 34:** the West Half of the West Half (W/2 W/2); and
 - (9) **Section 36:** all
 - C) **T 30S-R 18W:**
 - (1) **Section 13:** all; and
 - (2) **Section 24:** the East Half of the East Half (E/2 E/2)
- 5) **Spacing:** 640 contiguous and adjoining acres w/ well located no closer than 1,250 feet from any boundary line (length shall not exceed approximately twice width at narrowest point) (p.3 of 9/28/77 Order)
- 6) **Prorated:** based upon open flow formula
- 7) **Termination:** "shall remain in force and effect until amended, changed or modified by further order of the Commission" (p.12 of 9/28/77 Order)

WIGGINS CREEK OIL & GAS POOL (30-19W): Mississippian

- 1) **Docket No.** 01-CONS-248-CBSO
- 2) **Order(s) issued** February 12, 2002
- 3) **Effective:** not given—February 12, 2002? (wells drilled before and during pendency of original application grandfathered in and entitled to appropriate allowable regardless of setbacks)
- 4) **Acreage:** T 30S, R 19W-Section 31 (p. 2 of 2/12/02 Order)
- 5) **Spacing:**
 1. 40 acres for oil wells
 2. 160 acres for gas wells, and
 3. Each well 660 feet from unit boundary lines (p. 3 of 2/12/02 Order)
- 6) **Prorated:** general/statewide rules and regs (p.3 of 2/12/02 Order)
- 7) **Termination:** "this Order shall terminate by its own terms on January 1, 2012 unless amended, changed, modified or extended by further Order of the Commission" (p. 3 of 2/12/02 Order)