

For KCC Use: 4-27-2009  
 Effective Date: \_\_\_\_\_  
 District # \_\_\_\_\_  
 SGA?  Yes  No

KANSAS CORPORATION COMMISSION  
 OIL & GAS CONSERVATION DIVISION

Form C-1  
 October 2007  
 Form must be Typed  
 Form must be Signed  
 All blanks must be Filled

NOTICE OF INTENT TO DRILL

Must be approved by KCC five (5) days prior to commencing well

Expected Spud Date: May 1 2009  
 month day year

OPERATOR: License# 32198  
 Name: PetroSantander USA Inc  
 Address 1: 6363 Woodway, #350  
 Address 2: \_\_\_\_\_  
 City: Houston State: TX Zip: 77057 + \_\_\_\_\_  
 Contact Person: Lilana Hernandez  
 Phone: 713-784-8700

CONTRACTOR: License# Will advise on ACO-1  
 Name: Will advise on ACO-1

Well Drilled For:  Oil  Enh Rec  Gas  Storage  Disposal  Seismic; \_\_\_\_\_ # of Holes  Other: \_\_\_\_\_  
 Well Class:  Infield  Pool Ext.  Wildcat  Other  
 Type Equipment:  Mud Rotary  Air Rotary  Cable  
 If OWWO: old well information as follows:

Operator: \_\_\_\_\_  
 Well Name: \_\_\_\_\_  
 Original Completion Date: \_\_\_\_\_ Original Total Depth: \_\_\_\_\_

Directional, Deviated or Horizontal wellbore?  Yes  No  
 If Yes, true vertical depth: \_\_\_\_\_  
 Bottom Hole Location: \_\_\_\_\_  
 KCC DKT #: \_\_\_\_\_

Spot Description: 325 south and 325 west from C-SW-SW  
 \_\_\_\_\_ SW - SW - SW Sec. 7 Twp. 21 S. R. 34  E  W  
 (a/a/a/a) 335 feet from  N /  S Line of Section  
335 feet from  E /  W Line of Section  
 Is SECTION:  Regular  Irregular?

(Note: Locate well on the Section Plat on reverse side)

County: Finney  
 Lease Name: Crist Well #: Crist 2-7  
 Field Name: Christabelle (Morrow) Unit

Is this a Prorated / Spaced Field?  Yes  No  
 Target Formation(s): Morrow

Nearest Lease or unit boundary line (in footage): 2305'  
 Ground Surface Elevation: 3068 feet MSL

Water well within one-quarter mile:  Yes  No  
 Public water supply well within one mile:  Yes  No

Depth to bottom of fresh water: 180' 220'  
 Depth to bottom of usable water: 1100'

Surface Pipe by Alternate:  I  II  
 Length of Surface Pipe Planned to be set: ~315'

Length of Conductor Pipe (if any): \_\_\_\_\_  
 Projected Total Depth: ~5000

Formation at Total Depth: Mississippian

Water Source for Drilling Operations:  
 Well  Farm Pond  Other: \_\_\_\_\_

DWR Permit #: \_\_\_\_\_  
 (Note: Apply for Permit with DWR)

Will Cores be taken?  Yes  No  
 If Yes, proposed zone: \_\_\_\_\_

PRORATED & SPACED: HUBOTDOW PANOMA

AFFIDAVIT

The undersigned hereby affirms that the drilling, completion and eventual plugging of this well will comply with K.S.A. 55 et. seq.

It is agreed that the following minimum requirements will be met:

1. Notify the appropriate district office **prior** to spudding of well;
2. A copy of the approved notice of intent to drill **shall be** posted on each drilling rig;
3. The minimum amount of surface pipe as specified below **shall be set** by circulating cement to the top; in all cases surface pipe **shall be set** through all unconsolidated materials plus a minimum of 20 feet into the underlying formation.
4. If the well is dry hole, an agreement between the operator and the district office on plug length and placement is necessary **prior to plugging**;
5. The appropriate district office will be notified before well is either plugged or production casing is cemented in;
6. If an ALTERNATE II COMPLETION, production pipe shall be cemented from below any usable water to surface within **120 DAYS** of spud date. Or pursuant to Appendix "B" - Eastern Kansas surface casing order #133,891-C, which applies to the KCC District 3 area, alternate II cementing must be completed within 30 days of the spud date or the well shall be plugged. **In all cases, NOTIFY district office** prior to any cementing.

I hereby certify that the statements made herein are true and correct to the best of my knowledge and belief.

Date: 04/21/09 Signature of Operator or Agent: [Signature] Title: S'WR. ENGINEER

For KCC Use ONLY  
 API # 15 - 055-22043-00-00  
 Conductor pipe required None feet  
 Minimum surface pipe required 240 feet per ALT.  I  II  
 Approved by: [Signature] 4-22-2009  
 This authorization expires: 4-22-2010  
 (This authorization void if drilling not started within 12 months of approval date.)  
 Spud date: \_\_\_\_\_ Agent: \_\_\_\_\_

Remember to:

- File Drill Pit Application (form CDP-1) with Intent to Drill;
- File Completion Form ACO-1 within 120 days of spud date;
- File acreage attribution plat according to field proration orders;
- Notify appropriate district office 48 hours prior to workover or re-entry;
- Submit plugging report (CP-4) after plugging is completed (within 60 days);
- Obtain written approval before disposing or injecting salt water.
- If this permit has expired (See: authorized expiration date) please check the box below and return to the address below.

Well Not Drilled - Permit Expired Date: \_\_\_\_\_  
 Signature of Operator or Agent: \_\_\_\_\_

RECEIVED

APR 22 2009

KCC WICHITA

7  
21  
34  
 E  
 W

**IN ALL CASES PLOT THE INTENDED WELL ON THE PLAT BELOW**

*Plat of acreage attributable to a well in a prorated or spaced field*

**If the intended well is in a prorated or spaced field, please fully complete this side of the form.** If the intended well is in a prorated or spaced field complete the plat below showing that the well will be properly located in relationship to other wells producing from the common source of supply. Please show all the wells and within 1 mile of the boundaries of the proposed acreage attribution unit for gas wells and within 1/2 mile of the boundaries of the proposed acreage attribution unit for oil wells.

API No. 15 - 055-22043-00-00  
 Operator: PetroSantander USA Inc  
 Lease: Crist  
 Well Number: Crist 2-7  
 Field: Christabelle (Morrow) Unit

Location of Well: County: Finney  
 335 feet from  N /  S Line of Section  
 335 feet from  E /  W Line of Section  
 Sec. 7 Twp. 21 S. R. 34  E  W

Number of Acres attributable to well: \_\_\_\_\_  
 QTR/QTR/QTR/QTR of acreage: \_\_\_\_\_ - SW - SW - SW

Is Section:  Regular or  Irregular

**If Section is Irregular, locate well from nearest corner boundary.**  
 Section corner used:  NE  NW  SE  SW

**PLAT**

*(Show location of the well and shade attributable acreage for prorated or spaced wells.)  
 (Show footage to the nearest lease or unit boundary line.)*

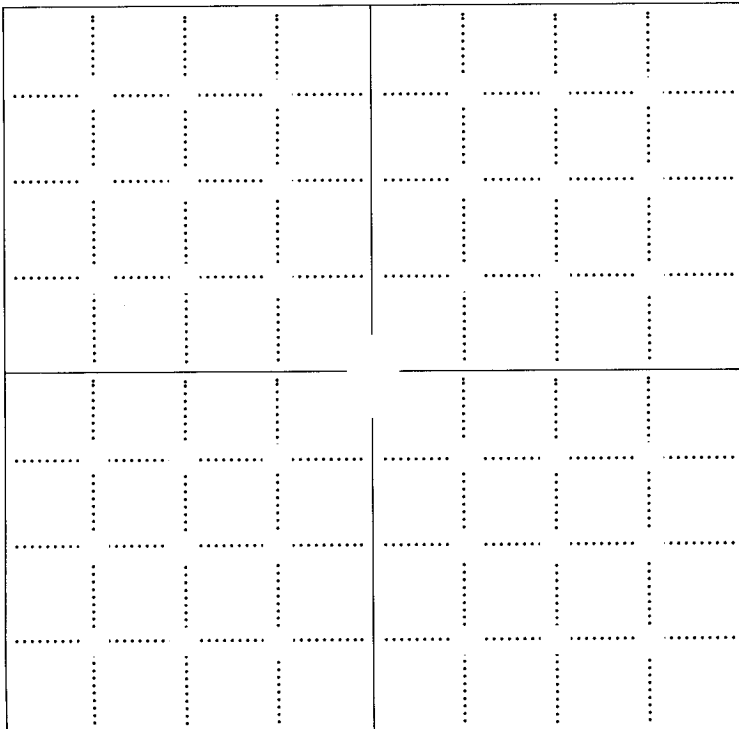

RECEIVED  
 APR 22 2009  
 KCC WICHITA

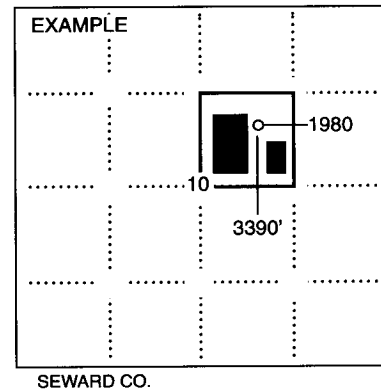

**NOTE: In all cases locate the spot of the proposed drilling location.**

**In plotting the proposed location of the well, you must show:**

1. The manner in which you are using the depicted plat by identifying section lines, i.e. 1 section, 1 section with 8 surrounding sections, 4 sections, etc.
2. The distance of the proposed drilling location from the south / north and east / west outside section lines.
3. The distance to the nearest lease or unit boundary line (in footage).
4. If proposed location is located within a prorated or spaced field a certificate of acreage attribution plat must be attached: (CO-7 for oil wells; CG-8 for gas wells).

15-055-22043-0000

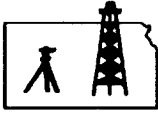

**ROBINSON SERVICES**  
Oil Field & Construction Staking  
P.O. Box 2324  
Garden City, Kansas 67846  
Office/Fax: (620) 276-6159  
Cell: (620) 272-1499

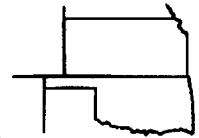

**y041509-u**  
PLAT NO.

**8184**  
INVOICE NO.

**PetroSantander, Inc.**  
OPERATOR  
**Finney County, KS**  
COUNTY

**Crist #2-7**  
LEASE NAME  
**335' FSL - 335' FWL**  
LOCATION SPOT

SCALE: **1" = 1000'**  
DATE STAKED: **April 15<sup>th</sup>, 2009**  
MEASURED BY: **Burt W.**  
DRAWN BY: **Gabe Q.**  
AUTHORIZED BY: **Bill A.**



GR. ELEVATION: **3067.9'**

**Directions:** From the NW side of Garden City, KS at the intersection of Hwy 50 & Hwy 83 - Now go 13 miles North on Hwy 83 - Now go 8 miles West on E Gano Rd - Now go 2 miles North on Ritchel RD - Now go 3 miles West on E Meade RD - Now go 1 mile North on Byrd RD to the SE corner of section 7-21s-34w - Now go 1 mile West on W Sondreagger RD to ingress stake North into - Now go 335' North through terraced wheat - Now go 335' East through terraced wheat into staked location.  
**Final ingress must be verified with land owner or PetroSantander, Inc.**

***This drawing does not constitute a monumented survey or a land survey plat***  
***This drawing is for construction purposes only***

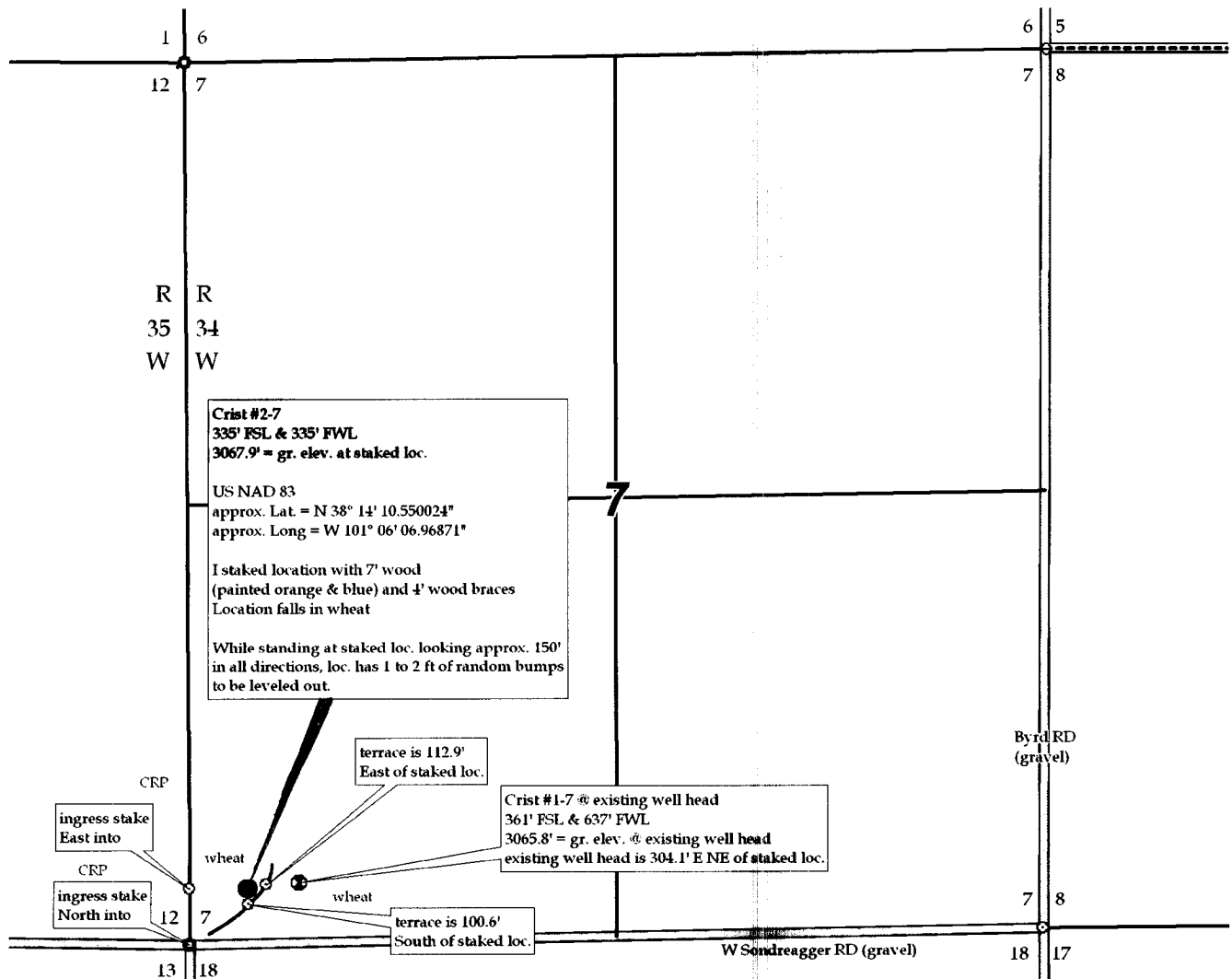

15-055-22043-0000

**Well:CRIST 2-7**  
**PROPOSED WATER INJECTION WELL**  
**SW SW SW Section 7-T21S-R34W**  
**Finney County, Ks**

**Wellbore Diagram**  
**as of 04/20/2009**  
**by Alan Edwards**

Date Pulled    Comments

**Location: 335' FNL; 335' FWL**  
**Elevation: GL=3068', KB=????'**  
**API # - 15-055-?????**

**Contractor:**  
**Spud Date:**  
**TD:**  
**Rig Release:**  
**Mud:**  
**Completion Date:**  
**First Production:**

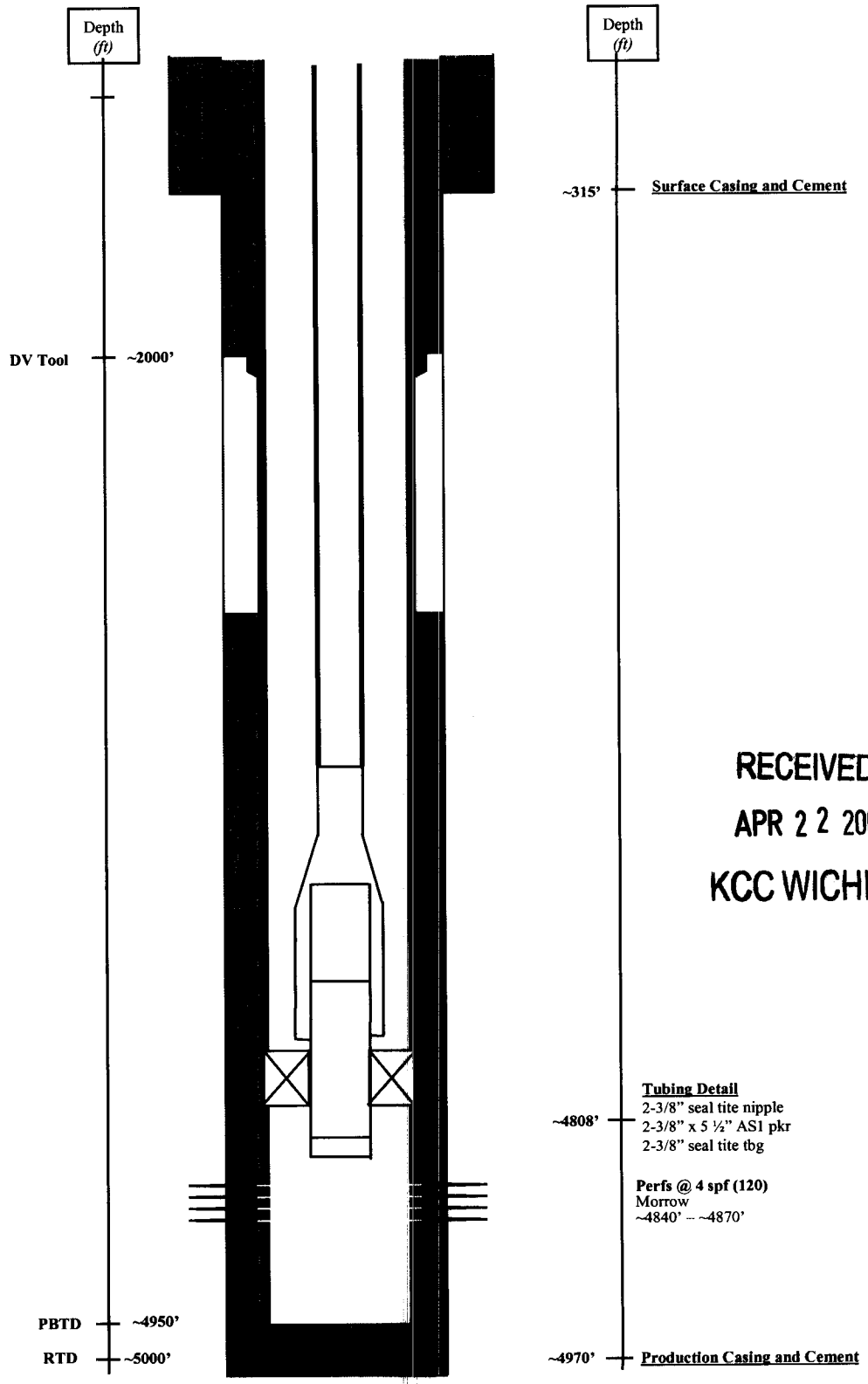

**RECEIVED**  
**APR 22 2009**  
**KCC WICHITA**

**KANSAS CORPORATION COMMISSION  
OIL & GAS CONSERVATION DIVISION  
APPLICATION FOR SURFACE PIT**

Form CDP-1  
April 2004  
Form must be Typed

*Submit in Duplicate*

Operator Name: <b>PetroSantander USA Inc</b>		License Number: <b>32198</b>	
Operator Address: <b>6363 Woodway, #350</b>		<b>Houston TX 77099</b>	
Contact Person: <b>Lilana Hernandez</b>		Phone Number: <b>713-784-8700</b>	
Lease Name & Well No.: <b>Crist Crist 2-7</b>		Pit Location (QQQQ): _____ <u>SW</u> _____ <u>SW</u> _____ <u>SW</u> Sec. <u>7</u> Twp. <u>21</u> R. <u>34</u> <input type="checkbox"/> East <input checked="" type="checkbox"/> West <u>335</u> Feet from <input type="checkbox"/> North / <input checked="" type="checkbox"/> South Line of Section <u>335</u> Feet from <input type="checkbox"/> East / <input checked="" type="checkbox"/> West Line of Section <b>Finney</b> _____ County	
Type of Pit: <input type="checkbox"/> Emergency Pit <input type="checkbox"/> Burn Pit <input type="checkbox"/> Settling Pit <input checked="" type="checkbox"/> Drilling Pit <input type="checkbox"/> Workover Pit <input type="checkbox"/> Haul-Off Pit <i>(If WP Supply API No. or Year Drilled)</i>		Pit is: <input checked="" type="checkbox"/> Proposed <input type="checkbox"/> Existing If Existing, date constructed: _____ Pit capacity: <b>10,000</b> (bbls)	
Is the pit located in a Sensitive Ground Water Area? <input type="checkbox"/> Yes <input checked="" type="checkbox"/> No		Chloride concentration: _____ mg/l <i>(For Emergency Pits and Settling Pits only)</i>	
Is the bottom below ground level? <input checked="" type="checkbox"/> Yes <input type="checkbox"/> No		Artificial Liner? <input type="checkbox"/> Yes <input checked="" type="checkbox"/> No	
How is the pit lined if a plastic liner is not used? <b>Natural clay and drilling mud</b>			
Pit dimensions (all but working pits): <u>125</u> Length (feet) <u>125</u> Width (feet) <input checked="" type="checkbox"/> N/A: Steel Pits Depth from ground level to deepest point: <u>4</u> (feet) <input type="checkbox"/> No Pit			
If the pit is lined give a brief description of the liner material, thickness and installation procedure.		Describe procedures for periodic maintenance and determining liner integrity, including any special monitoring.	
Distance to nearest water well within one-mile of pit <u>N/A</u> feet    Depth of water well _____ feet		Depth to shallowest fresh water _____ feet. Source of information: <input type="checkbox"/> measured <input type="checkbox"/> well owner <input type="checkbox"/> electric log <input type="checkbox"/> KDWR	
<b>Emergency, Settling and Burn Pits ONLY:</b> Producing Formation: _____ Number of producing wells on lease: _____ Barrels of fluid produced daily: _____ Does the slope from the tank battery allow all spilled fluids to flow into the pit? <input type="checkbox"/> Yes <input type="checkbox"/> No		<b>Drilling, Workover and Haul-Off Pits ONLY:</b> Type of material utilized in drilling/workover: <u>Drilling Mud</u> Number of working pits to be utilized: <u>3</u> Abandonment procedure: <u>Backfill and level when sufficiently dry</u> Drill pits must be closed within 365 days of spud date.	
I hereby certify that the above statements are true and correct to the best of my knowledge and belief.		<b>RECEIVED</b>	
Date: _____		<b>APR 22 2009</b>	
		<b>KCC WICHITA</b>	
<b>KCC OFFICE USE ONLY</b>			
Date Received: <u>4/22/09</u> Permit Number: _____		Steel Pit <input type="checkbox"/> RFAC <input type="checkbox"/> RFAS <input type="checkbox"/>	
Permit Date: <u>4/22/09</u> Lease Inspection: <input type="checkbox"/> Yes <input checked="" type="checkbox"/> No			

15-055-22043-0000

**NOTICE TO OPERATORS FILING INTENT TO DRILL  
FOR DISPOSAL OR ENHANCED RECOVERY  
INJECTION WELLS, (CLASS II INJECTION WELL)**

The attached approved Notice of Intent to Drill indicates the proposed well is to be used for injection. An approved "Intent to Drill" does not approve injection authority as a Class II Injection Well in Kansas.

Before any well is used for injection purposes, the operator must file an application for injection authority in accordance with K.A.R. 82-3-401 and provide notice in accordance with K.A.R. 82-3-402. The Conservation Division must issue a written permit granting the application before commencement of injection.

The Conservation Division requirements and restrictions associated with Class II Injection are identified in **K.A.R. 82-3-400 et seq** of our regulations. Associated regulations governing drilling, completion and injection applications may be found in K.A.R. 82-3-135, Table I, Table II, in the Cedar Hills Sandstone Moratorium, (Docket #156,397-C), and the Eastern Kansas Surface Casing Order, (Docket #133,891-C).

If you have questions regarding the approval of injection authority, an injection application may be filed as a "Design Approval" before actual drilling and completion of the well occurs. If you have any questions or concerns regarding Class II injection wells or regulations, call the Underground Injection Control Department at 316-337-6200.

Failure to obtain commission approval before beginning injection is punishable by a penalty, shut-in of the well or both.

CONSERVATION DIVISION