

STATE OF KANSAS  
STATE CORPORATION COMMISSION

Give All Information Completely  
Make Required Affidavit  
Mail or Deliver Report to:  
Conservation Division  
State Corporation Commission  
800 Biting Building  
Wichita, Kansas

15-051-00793-00-00  
WELL PLUGGING RECORD

NORTH

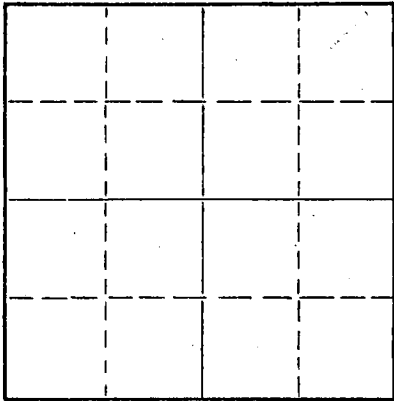

Locate well correctly on above  
Section Plat

Ellis

County. Sec. 25 Twp. 11 Rge. (E) 19 (W)

Location as "NE/CNW/SW" or footage from lines NW NW SW

Lease Owner Jones, Shelburne & Farmer, Inc.

Lease Name Jensen R #1

Well No. 1

Office Address Russell, Kansas

Character of Well (completed as Oil, Gas or Dry Hole) dry

Date well completed 10-30 1954

Application for plugging filed 10-30 1954

Application for plugging approved 10-30 1954

Plugging commenced 10-30 1954

Plugging completed 10-30 1954

Reason for abandonment of well or producing formation dry

If a producing well is abandoned, date of last production never produced 19

Was permission obtained from the Conservation Division or its agents before plugging was commenced? yes

Name of Conservation Agent who supervised plugging of this well Eldon Petty

Producing formation Depth to top Bottom Total Depth of Well 3655 Feet

Show depth and thickness of all water, oil and gas formations.

OIL, GAS OR WATER RECORDS

CASING RECORD

FORMATION	CONTENT	FROM	TO	SIZE	PUT IN	PULLED OUT
				8 5/8	155	none

Describe in detail the manner in which the well was plugged, indicating where the mud fluid was placed and the method or methods used in introducing it into the hole. If cement or other plugs were used, state the character of same and depth placed, from feet to feet for each plug set.

1. Filled hole with heavy mud
2. Pushed plug to 155'
3. Dumped 1/2 sack hulls on top of plug
4. Mixed 15 sacks cement and dumped on top of hulls
5. Filled hole to top
6. Pushed plug to 40'
7. Dumped in 1/2 sack hulls
8. Mixed 10 sacks cement and filled hole to top with same

(If additional description is necessary, use BACK of this sheet)

Name of Plugging Contractor Jones, Shelburne & Farmer, Inc.

Address Russell, Kansas

STATE OF Kansas, COUNTY OF Russell, ss.  
John O. Farmer

(employee of owner) or (owner or operator) of the above-described well, being first duly sworn on oath, says: That I have knowledge of the facts, statements, and matters herein contained and the log of the above-described well as filed and that the same are true and correct. So help me God.

(Signature)

Russell, Kansas  
(Address)

SUBSCRIBED AND SWORN TO before me this 1st day of November 1954

My commission expires July 14, 1958

Notary Public.

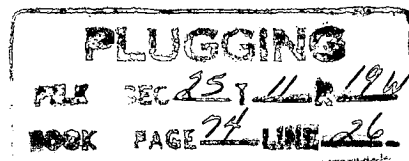

11-6-1954

FARM NAME Jenson B WELL NO. 1 COUNTY Ellis SEC. 25 TWP. 11 RGE. 19

Form 1002A

OPERATOR Jones, Shelburne & Farmer, Inc.

15-051-00793-00-00

FORMATION RECORD

ADDRESS Russell, Kansas

Give detailed description and thickness of all formations drilled through, contents of sand, whether dry, water, oil or gas.

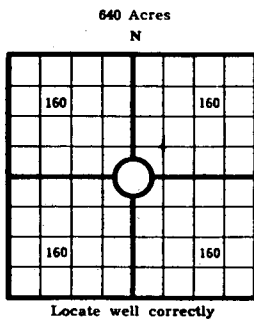

Locate well correctly

COUNTY Ellis SEC. 25 TWP. 11 RGE. 19  
 COMPANY OPERATING Jones, Shelburne & Farmer, Inc.  
 OFFICE ADDRESS Russell, Kansas  
 FARM NAME Jenson B WELL NO. 1  
 DRILLING STARTED 10-21, 54 DRILLING FINISHED 10-30, 54  
 DATE OF FIRST PRODUCTION \_\_\_\_\_ COMPLETED \_\_\_\_\_  
 WELL LOCATED NW 1/4 NW 1/4 SW 1/4 North of South  
 Line and \_\_\_\_\_ ft. East of West Line of Quarter Section  
 Elevation (Relative to sea level) DERRICK FLOOR 2072 GROUND \_\_\_\_\_  
 CHARACTER OF WELL (Oil, gas or dryhole) dry

OIL OR GAS SANDS OR ZONES

Name	From	To	Name	From	To
1			4		
2			5		
3			6		

Perforating Record If Any

Shot Record

Formation	From	To	No. of Shots	Formation	From	To	Size of Shot

CASING RECORD

Amount Set						Amount Pulled		Packer Record	
Size	Wt.	Thds.	Make	Ft.	In.	Size	Length	Depth Set	Make
8 5/8				155					

Liner Record: Amount \_\_\_\_\_ Kind \_\_\_\_\_ Top \_\_\_\_\_ Bottom \_\_\_\_\_

CEMENTING AND MUDDING

Size	Amount Set		Sacks Cement	Chemical		Method of Cementing	Amount	Mudding Method	Results (See Note)
	Ft.	In.		Gal.	Make				
8 5/8	155		125						

Note: What method was used to protect sands if outer strings were pulled? \_\_\_\_\_

NOTE: Were bottom hole plugs used? \_\_\_\_\_ If so, state kind, depth set and results obtained \_\_\_\_\_

TOOLS USED

Rotary Tools were used from \_\_\_\_\_ feet to \_\_\_\_\_ Cable tools were used from \_\_\_\_\_ feet to \_\_\_\_\_ feet, and from \_\_\_\_\_ feet to \_\_\_\_\_ feet, and from \_\_\_\_\_ feet to \_\_\_\_\_ feet to \_\_\_\_\_

Type Rig \_\_\_\_\_

INITIAL PRODUCTION TEST

Describe initial test: whether by flow through tubing or casing or by pumping \_\_\_\_\_

Amount of Oil Production \_\_\_\_\_ bbls. Size of choke, if any \_\_\_\_\_ Length of test \_\_\_\_\_ Water

Production \_\_\_\_\_ bbls. Gravity of oil \_\_\_\_\_ Type of Pump if pump is used, describe \_\_\_\_\_

Shale 0 - 653  
 Shale & sand 653 1160  
 Shale & redbed 1160 1353  
 Redbed & shale 1353 1432  
 Anhydrite 1432 1465  
 Shale & shells 1465 1940  
 Lime & shale 1940 2895  
 Shale & lime 2895 3045  
 Lime & shale 3045 3381  
 Lime 3381 3421  
 Lime & shale 3421 3517  
 Lime 3517 3562  
 Lime & shale 3562 3655

TOPS:

Elev 2074  
 Heebner 3301  
 Toronto 3319  
 Lansing 3338  
 Arbuckle 3631  
 T.D. 3655

11-6-1954

PLUGGING

I, the undersigned, being first duly sworn upon oath, state that this well record is true, correct and complete according to the records of this office and to the best of my knowledge and belief.

Shelburne Farmer, Inc.  
 Name and title of representative of company

Subscribed and sworn to before me this 4th day of November, 1954  
July 14, 1958  
 My Commission expires \_\_\_\_\_  
Donna Pratt  
 Notary Public.