

ORIGINAL

SIDE ONE

RELEASED
CONFIDENTIAL
MAR 05 1992

STATE CORPORATION COMMISSION OF KANSAS
OIL & GAS CONSERVATION DIVISION
WELL COMPLETION FORM
ACO-1 WELL HISTORY
DESCRIPTION OF WELL AND LEASE

API NO. 15-179-20,977-0000

County Sheridan FROM CONFIDENTIAL

C S/2 SE NE Sec. 23 Twp. 9S Rge. 26 East West

2970 Ft. North from Southeast Corner of Section

660 Ft. West from Southeast Corner of Section
(NOTE: Locate well in section plat below.)

Lease Name Pfeifer Well # 1

Field Name EPLER

Producing Formation Lansing-Kansas City

Elevation: Ground 2647' KB 2652'

Total Depth 4170' PBTD 4220' KCC

Operator: License # 9482

Name: National Petro. Reserves, Inc.

Address 250 N. Rock Rd., #340

City/State/Zip Wichita, KS 67206

Purchaser: Chen Creek, Inc.

Operator Contact Person: Ted C. Bredehoft

Phone (316) - 681-3515

Contractor: Name: Emphasis Oil Operations

License: 8241 STATE CORPORATION COMMISSION

Wellsite Geologist: Craig Caulk

Designate Type of Completion

New Well Re-Entry Workover

Oil SWD Temp. Abd.

Gas Inj Delayed Comp.

Dry Other (Core, Water Supply, etc.)

If OWWO: old well info as follows:
Operator: _____

Well Name: _____

Comp. Date _____ Old Total Depth _____

Drilling Method:
 Mud Rotary Air Rotary Cable

11/23/90 12/1/90 12/10/90
Spud Date Date Reached TD Completion Date

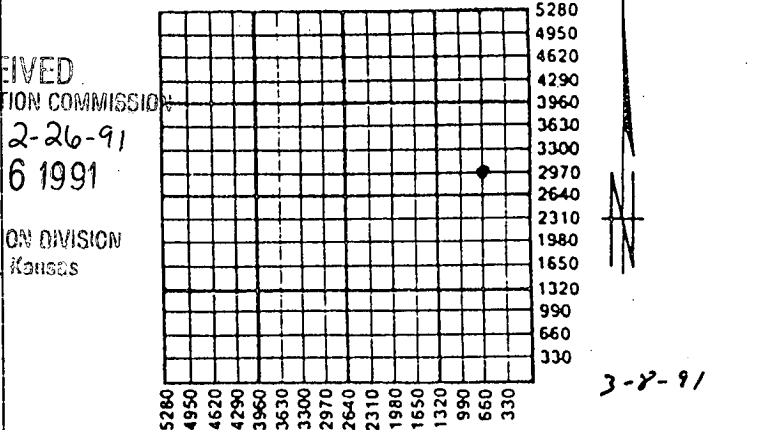

Amount of Surface Pipe Set and Cemented at 258 Feet

Multiple Stage Cementing Collar Used? Yes No

If yes, show depth set 2280' Feet

If Alternate II completion, cement circulated from 2280
feet depth to 0 w/ 350 sx cmt.

INSTRUCTIONS: This form shall be completed in triplicate and filed with the Kansas Corporation Commission, 200 Colorado Derby Building, Wichita, Kansas 67202, within 120 days of the spud date of any well. Rule 82-3-130, 82-3-107 and 82-3-106 apply. Information on side two of this form will be held confidential for a period of 12 months if requested in writing and submitted with the form. See rule 82-3-107 for confidentiality in excess of 12 months. One copy of all wireline logs and drillers time log shall be attached with this form. ALL CEMENTING TICKETS MUST BE ATTACHED. Submit CP-4 form with all plugged wells. Submit CP-111 form with all temporarily abandoned wells. Any recompletion, workover or conversion of a well requires filing of ACO-2 within 120 days from commencement date of such work.

All requirements of the statutes, rules and regulations promulgated to regulate the oil and gas industry have been fully complied with and the statements herein are complete and correct to the best of my knowledge.

Signature [Signature]
Title President Date 1/28/91

Subscribed and sworn to before me this 28 day of January, 19 91.

Notary Public [Signature]

Date Commission Expires 5-13-93

SUSAN E. BREDEHOFT
NOTARY PUBLIC
STATE OF KANSAS
Appt. Exp. 5-13-93

K.C.C. OFFICE USE ONLY
F Letter of Confidentiality Attached
C Wireline Log Received
C Drillers Timelog Received

Distribution
 KCC SWD/Rep NGPA
 KGS Plug Other
(Specify)

Operator Name National Petro. Res., Inc. Lease Name Pfeifer Well # 1
 East County Sheridan
 Sec. 23 Twp. 9S Rge. 26 West

INSTRUCTIONS: Show important tops and base of formations penetrated. Detail all cores. Report all drill stem tests giving interval tested, time tool open and closed, flowing and shut-in pressures, whether shut-in pressure reached static level, hydrostatic pressures, bottom hole temperature, fluid recovery, and flow rates if gas to surface during test. Attach extra sheet if more space is needed. Attach copy of log.

Drill Stem Tests Taken <input checked="" type="checkbox"/> Yes <input type="checkbox"/> No (Attach Additional Sheets.) Samples Sent to Geological Survey <input checked="" type="checkbox"/> Yes <input type="checkbox"/> No Cores Taken <input type="checkbox"/> Yes <input type="checkbox"/> No Electric Log Run <input checked="" type="checkbox"/> Yes <input type="checkbox"/> No (Submit Copy.)	<p align="center">Formation Description</p> <input checked="" type="checkbox"/> Log <input type="checkbox"/> Sample <table border="1" style="width:100%; border-collapse: collapse;"> <thead> <tr> <th>Name</th> <th>Top</th> <th>Bottom</th> </tr> </thead> <tbody> <tr> <td>Anhydrite</td> <td>2291</td> <td>+361</td> </tr> <tr> <td>B/Anhydrite</td> <td>2331</td> <td>+321</td> </tr> <tr> <td>Topeka</td> <td>3648</td> <td>-996</td> </tr> <tr> <td>Heebner</td> <td>3859</td> <td>-1207</td> </tr> <tr> <td>Toronto</td> <td>3882</td> <td>-1230</td> </tr> <tr> <td>Lansing</td> <td>3897</td> <td>-1245</td> </tr> <tr> <td>B/K.C.</td> <td>4126</td> <td>-1474</td> </tr> </tbody> </table>	Name	Top	Bottom	Anhydrite	2291	+361	B/Anhydrite	2331	+321	Topeka	3648	-996	Heebner	3859	-1207	Toronto	3882	-1230	Lansing	3897	-1245	B/K.C.	4126	-1474
Name	Top	Bottom																							
Anhydrite	2291	+361																							
B/Anhydrite	2331	+321																							
Topeka	3648	-996																							
Heebner	3859	-1207																							
Toronto	3882	-1230																							
Lansing	3897	-1245																							
B/K.C.	4126	-1474																							

CASING RECORD <input type="checkbox"/> New <input type="checkbox"/> Used							
Report all strings set-conductor, surface, intermediate, production, etc.							
Purpose of String	Size Hole Drilled	Size Casing Set (In O.D.)	Weight Lbs./Ft.	Setting Depth	Type of Cement	# Sacks Used	Type and Percent Additives
Surface Casing	12 3/4"	8 5/8"	20#	250'	common	175	3% cc
Production	7 7/8"	4 1/2"	10.5#	4168'	pozmix	350	3%cc 10% salt

PERFORATION RECORD		Acid, Fracture, Shot, Cement Squeeze Record	
Shots Per Foot	Specify Footage of Each Interval Perforated	(Amount and Kind of Material Used)	Depth
3	4068-4071	2,500 gal 15% PAD Acid	4063-71

TUBING RECORD		Size <u>2 3/8"</u>	Set At <u>4081</u>	Packer At <u>no</u>	Liner Run <input type="checkbox"/> Yes <input checked="" type="checkbox"/> No
Date of First Production <u>12-11-90</u>	Producing Method <input type="checkbox"/> Flowing <input checked="" type="checkbox"/> Pumping <input type="checkbox"/> Gas Lift <input type="checkbox"/> Other (Explain)				
Estimated Production Per 24 Hours:	Oil <u>160</u> Bbls.	Gas <u> </u> Mcf	Water <u>no water</u> Bbls.	Gas-Oil Ratio	Gravity

Disposition of Gas:	METHOD OF COMPLETION	Production Interval
<input type="checkbox"/> Vented <input type="checkbox"/> Sold <input checked="" type="checkbox"/> Used on Lease (If vented, submit ACO-18.)	<input type="checkbox"/> Open Hole <input checked="" type="checkbox"/> Perforation <input type="checkbox"/> Dually Completed <input type="checkbox"/> Conningled <input type="checkbox"/> Other (Specify) _____	_____

ORIGINAL

CONFIDENTIAL
MAY 5 1992
FROM CONFIDENTIAL

PFEIFER #1

- 11/28/90 DST #1 (3911-52), Lansing 35' and 50' zones; 30-30-45-60; 1st open-weak blow bldg off bottom bucket in 5 minutes; 2nd open-weak blow bldg off bottom bucket in 5 minutes; recovery: 2,825' gas-in-pipe, 675 ft clean oil; IFP 58-108; FFP 152-224; ISIP-1080; FSIP-1102; gravity 39°; drilling at 3,952 ft.
- 11/28/90 DST #2 (3951-77), Lansing 90 ft zone; 30-30-45-60; 1st open-strong blow off bottom bucket in 7 minutes; 2nd open-strong blow off bottom bucket in 7 minutes; recovered: 1,475 ft. gas-in-pipe; 300 ft clean gassy oil, 30 ft slightly muddy gassy oil; IFP 115-84; FFP 147-157; ISIP-966; FSIP-997; BHT 112°; drilling at 3,977 ft.
- 11/29/90 DST #3 (3996-4056); Lansing 140' and 160' zones; 30-30-45-45); 1st open-fair blow built to 10 1/2 inches; 2nd open-fair blow built to bottom bucket in 26 minutes; recovery: 375 ft. gas-in-pipe, 110 ft muddy oil, 60 ft heavily oil cut mud; IFP 50-72; 87-101; ISIP-1288; FSIP-1288; BHT 112°; drilling at 4,056 ft.
- DST #4 (4056-4077) Lansing 180 ft zone; 30-30-45-45; 1st open-strong blow off bottom bucket in 1 minute; 2nd open-strong blow gas to surface gauge 10,000 CFG; recovery: 2,600 ft clean gassy oil; IFP 173-529; FFP 616-899; ISIP-1116; FSIP-1116; BHT 132°; gravity 40.5°; drilling at 4,104 ft.
- 11/30/90 DST #5 (4077-4104); Lansing 200 ft zone (30-30-45-45); 1st open strong blow off bottom bucket in 1 minute; 2nd open-off bottom bucket in 90 seconds, gas to surface on final shut-in; recovery: 1,650 ft clean gassy oil; IFP 123-311; FFP 420-580; ISIP-899; FSIP-899; BHT 132°; drilling at 4,104 ft.

RECEIVED
STATE CORPORATION COMMISSION

FEB 26 1991

CONSERVATION DIVISION
Wichita, Kansas

ORIGINAL

MAR 05 1992

EMPHASIS OIL OPERATIONS
P. O. BOX 506
RUSSELL, KS 67665

FROM CONFIDENTIAL
CONFIDENTIAL

DRILLERS LOG

OPERATOR: National Petroleum Reserves, Inc.
250 N. Rock Rd., #340
Wichita, Kansas 67206

CONTRACTOR: Emphasis Oil Operations
Box 506
Russell, KS 67665

LEASE: Pfeifer

WELL #1

LOCATION: C S/2 SE NE
Section 23-9S-26W
Sheridan County, Kansas

ROTARY TOTAL DEPTH: 4170'

ELEVATION: 2652' K.B.

COMMENCED: 11/23/90

COMPLETED: 12/1/90

CASING: 8-5/8" @ 258' w/170 sks cement
4-1/2" @ 4185' w/140 sks cement (bottom stage)
w/420 sks (top stage)

STATUS: Oil Well

RECEIVED
STATE CORPORATION COMMISSION

FEB 26 1991

CONSERVATION DIVISION
Wichita, Kansas

DEPTHS & FORMATIONS

(All measurements from K.B.)

Top Soil & Sand	60'	Shale & Lime	3660'
Cedar Hills	1889'	Lime	3952'
Red Bed	2065'	Lime & Shale	4056'
Anhydrite	2296'	Lime	4077'
Red Bed	2337'	Kansas City-Lime	4104'
Lime & Shale	3255'	R.T.D.	4170'

STATE OF KANSAS)
) ss
COUNTY OF RUSSELL)

Kyle B. Branum, of Emphasis Oil Operations, states that the above and foregoing is a true and correct log of the above captioned well, to the best of his knowledge.

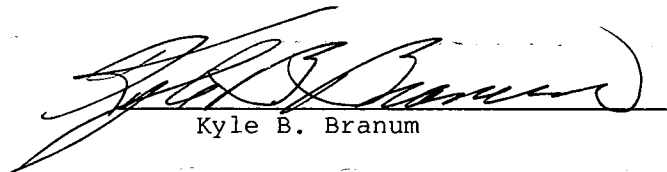
Kyle B. Branum

Subscribed and sworn to before me on December 4, 1990.

My commission expires: February 6, 1992.

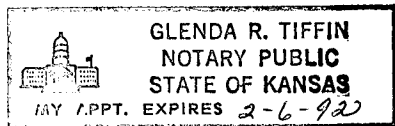

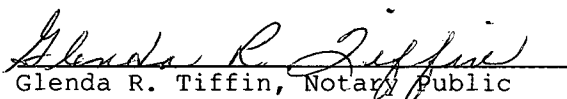
Glenda R. Tiffin, Notary Public



P.O. BOX 951046
DALLAS, TX 75295-1046
MAR 03 1999

HALLIBURTON SERVICES

INVOICE

A Halliburton Company

INVOICE NO.	DATE
904393	12/01/19

WELL LEASE NO./PLANT NAME		WELL/PLANT LOCATION	STATE	WELL/PLANT OWNER
PFIEFER 1		SHERIDAN	KS	NATIONAL PET. RES.
SERVICE LOCATION	CONTRACTOR	JOB PURPOSE		TICKET DATE
QBERLIN	EMPHASIS DRG.	TOP OUTSIDE PRODUCTION CASING		12/01/19
ACCT. NO.	CUSTOMER AGENT	VENDOR NO.	CUSTOMER P.O. NUMBER	SHIPPED VIA
623541	W. J. LUCK			COMPANY TRUCK

NATIONAL PETROLEUM RESERVES
250 N. ROCK RD.
SUITE 340
WICHITA, KS 67206

DIRECT CORRESPONDENCE TO:
SUITE 1300
LIBERTY TOWER
100 BROADWAY AVENUE
OKLAHOMA CITY, OK 73102-0000

PRICE REF. NO.	DESCRIPTION	QUANTITY	U/M	UNIT PRICE	AMOUNT
000-117	MILEAGE	45	MI	2.35	105.75
000-118	MILEAGE SURCHARGE-CEMENT-LAND	45	MI	.40	18.00
007-013	MULT STAGE CEMENTING-1ST STAGE	4158	FT	1,200.00	1,200.00
001-016	MULT STAGE CEMENTING-ADD STAGE	1	UNT		
007-161	MULT STAGE CEMENTING-ADD STAGE	1	STG	950.00	950.00
018-317	SUPER FLUSH	11	SK	74.00	814.00
26	INSERT VALVE F. S. - 4 1/2"	1	EA	216.00	216.00
847.6316	FILL-UP UNIT 4 1/2"-5"	1	EA	27.50	27.50
815.19111	CENTRALIZER 4-1/2" MODEL S-4	7	EA	41.00	287.00
807.93004	MULT STAGE CMTR-4-1/2 BRD	1	EA	2,350.00	2,350.00
813.80100	PLUG SET 4 1/2"	1	EA	330.00	330.00
812.0112	CEMENT BASKET 4 1/2"	1	EA	85.00	85.00
320	HALLIBURTON WELD-A	1	LB	11.00	11.00
800.8881	STANDARD CEMENT	140	SK	6.75	945.00
350	SALT	606	LB	.10	60.60
890.10802	CAL SEAL	6	SK	19.70	118.20
504-308	D-AIR 1, POWDER	32	LB	2.55	81.60
509-968	HALAD-322	64	LB	5.75	368.00
508-127	STANDARD CEMENT	98	SK	6.75	661.50
507-970	POZMIX A	52	SK	3.50	182.00
507-775	HALLIBURTON-GEL 2%	3	SK	.00	N/C
504-308	HALLIBURTON-GEL ADDED 8%	11	SK	13.75	151.25

RECEIVED
STATE CORPORATION COMMISSION
FEB 26 1999

***** CONTINUED ON NEXT PAGE *****

TERMS INVOICES PAYABLE NET BY THE 20TH OF THE FOLLOWING MONTH AFTER DATE OF INVOICE. UPON CUSTOMER'S DEFAULT IN PAYMENT OF CUSTOMER'S ACCOUNT BY THE LAST DAY OF THE MONTH FOLLOWING THE MONTH IN WHICH THE INVOICE IS DATED, CUSTOMER AGREES TO PAY INTEREST THEREON AFTER DEFAULT AT THE HIGHEST LAWFUL CONTRACT RATE APPLICABLE BUT NEVER TO EXCEED 18% PER ANNUM. IN THE EVENT IT BECOMES NECESSARY TO EMPLOY AN ATTORNEY TO ENFORCE COLLECTION OF SAID ACCOUNT, CUSTOMER AGREES TO PAY ALL COLLECTION COSTS AND ATTORNEY FEES IN THE AMOUNT OF 20% OF THE AMOUNT OF THE UNPAID ACCOUNT.



HALLIBURTON SERVICES

REMIT TO: P.O. BOX 5199 DALLAS, TX 75395-1046

INVOICE

A Halliburton Company

CONFIDENTIAL

INVOICE NO. 5199 DATE

WELL LEASE NO./PLANT NAME		WELL/PLANT LOCATION		STATE	WELL/PLANT OWNER	
PFEIFER 1		SHERIDAN		KS	NATIONAL PET. RES.	
SERVICE LOCATION		CONTRACTOR	JOB PURPOSE		TICKET DATE	
OBERLIN		EMPHASIS DRLG.	TOP OUTSIDE PRODUCTION CASING		12/01/90	
ACCT. NO.	CUSTOMER AGENT	VENDOR NO.	CUSTOMER P.O. NUMBER	SHIPPED VIA	FILE	
623541	W. J. LUCK			COMPANY TRUCK	001	

NATIONAL PETROLEUM RESERVES
250 N. ROCK RD.
SUITE 340
WICHITA, KS 67206

DIRECT CORRESPONDENCE TO:
SUITE 1300
LIBERTY TOWER
100 BROADWAY AVENUE
OKLAHOMA CITY, OK 73102-0000

PRICE REF. NO.	DESCRIPTION	QUANTITY	U/M	UNIT PRICE	AMOUNT
507-285	ECONOLITE	261	LB	.90	234.90
507-210	FLOCELE	38	LB	1.30	49.40
504-316	HALLIBURTON LIGHT W/STANDARD	200	SK	6.10	1,220.00
507-210	FLOCELE	50	LB	1.30	65.00
509-968	SALT	100	LB	.10	10.00
500-207	BULK SERVICE CHARGE	532	CFT	1.10	585.20
500-306	MILEAGE CMTG MAT DEL OR RETURN	1071.25	TMI	.75	803.44
500-307	MILEAGE SURCHARGE CEMENT MAT.	1071.25	TMI	.10	107.13
INVOICE SUBTOTAL					12,037.17
DISCOUNT-(BID)					2,382.46
INVOICE BID AMOUNT					9,655.00
*-KANSAS STATE SALES TAX					298.25
*-DECATUR COUNTY SALES TAX					70.19
INVOICE TOTAL - PLEASE PAY THIS AMOUNT					\$10,023.45

RECEIVED
STATE CORPORATION COMMISSION

FEB 26 1991

CONSERVATION DIVISION
Wichita, Kansas

TERMS INVOICES PAYABLE NET BY THE 20TH OF THE FOLLOWING MONTH AFTER DATE OF INVOICE. UPON CUSTOMER'S DEFAULT IN PAYMENT OF CUSTOMER'S ACCOUNT BY THE LAST DAY OF THE MONTH FOLLOWING THE MONTH IN WHICH THE INVOICE IS DATED, CUSTOMER AGREES TO PAY INTEREST THEREON AFTER DEFAULT AT THE HIGHEST LAWFUL CONTRACT RATE APPLICABLE BUT NEVER TO EXCEED 18% PER ANNUM. IN THE EVENT IT BECOMES NECESSARY TO EMPLOY AN ATTORNEY TO ENFORCE COLLECTION OF SAID ACCOUNT, CUSTOMER AGREES TO PAY ALL COLLECTION COSTS AND ATTORNEY FEES IN THE AMOUNT OF 20% OF THE AMOUNT OF THE UNPAID ACCOUNT.



ORIGINAL TICKET NO. 904393-6 FROM CONFIDENTIAL

MAR 05 1992

Form with fields: I.L. NO. - FARM OR LEASE NAME (L PFEIFER), COUNTY (SHERIDAN), STATE (KS), CITY/OFFSHORE LOCATION, DATE (12-1-90), OWNER (NATIONAL PET), CONTRACTOR (Emphasis Data), SERVICE (1), LOCATION (1), DELIVERED TO (S/STADLEY, KS), WELL CATEGORY (01), WELL PERMIT NO. (B-822365)

As consideration, the above-named Customer agrees to pay Halliburton in accord with the rates and terms stated in Halliburton's current price lists. Invoices payable NET by the 20th of the following month after date of invoice.

Halliburton warrants only title to the products, supplies and materials and that the same are free from defects in workmanship and materials. THERE ARE NO WARRANTIES, EXPRESS OR IMPLIED, OF MERCHANTABILITY.

Table with columns: PRICE REFERENCE, SECONDARY REF OR PART NO., L O C, ACCOUNT, DESCRIPTION, UNITS 1 (QTY, MEAS), UNITS 2 (QTY, MEAS), UNIT PRICE, AMOUNT. Includes items like MILEAGE 3529, Pump charge 1st stage, Pump charge 2nd stage, SUPER FLUID, INSERT FLOAT shoe, AUTO OIL ASSY, S-Y CENTRAL gears, MULTI-STAGE GEAR, Play SET, CAST IRON BIT.

NOT INVOICE

STATE CORPORATION COMMISSION MAR - 1 1992

AS PER ATTACHED BULK MATERIAL DELIVERY TICKET NO. B- 422 365

5643 22

Customer satisfaction fields: WAS JOB SATISFACTORILY COMPLETED?, IS OPERATION OF EQUIPMENT SATISFACTORY?, IS PERFORMANCE OF PERSONNEL SATISFACTORY? CUSTOMER OR HIS AGENT (PLEASE-PRINT) CUSTOMER OR HIS AGENT (SIGNATURE)

WE CERTIFY THAT THE FAIR LABOR STANDARDS ACT OF 1938, AS AMENDED HAS BEEN COMPLIED WITH IN THE PRODUCTION OF GOODS AND OR WITH RESPECT TO SERVICES FURNISHED UNDER THIS CONTRACT.

HALLIBURTON OPERATOR (Signature) HALLIBURTON APPROVAL CUSTOMER

CONSERVATION DIVISION Wichita, Kansas 12037 47 SUB TOTAL APPLICABLE TAXES WILL BE ADDED ON INVOICE.



**BULK MATERIALS DELIVERY
AND
TICKET CONTINUATION**

RELEASED

ORIGINAL

HALLIBURTON SERVICES

Duncan, Oklahoma 73538

A Division of Halliburton Company

FOR INVOICE AND
TICKET NO. **909393**

DATE 12-1-90	CUSTOMER ORDER NO.	WELL NO. AND FARM Pfeifer #1	COUNTY Shawnee	STATE Ks
CHARGE TO National Petroleum Reserve	OWNER Nat Pet Res.	CONTRACTOR Endress	No. B822365	
MAILING ADDRESS	DELIVERED FROM Merlin Ks	LOCATION CODE K25529	PREPARED BY <i>[Signature]</i>	
CITY & STATE	DELIVERED TO SW/Stradley, Ks	TRUCK NO. 50181 4718	RECEIVED BY <i>[Signature]</i>	

PRICE REFERENCE	SECONDARY REF. OR PART NO.	CODE		DESCRIPTION	UNITS 1		UNITS 2		UNIT PRICE	AMOUNT
		L	D		QTY.	MEAS.	QTY.	MEAS.		
504-308		1B		Std. Cement	140	sk			6.75	945.00
509-9168		1B		Salt Granulated 10%	600	lb			1.10	660.00
508-127		1B		Cal-Sol 5%	6	sk			19.70	118.20
507-970		1B		D-Air-1 25%	32	lb			2.55	81.60
507-775		1B		Hold-322 50%	64	lb			5.25	336.80
504-308		1B		Std. Cmt.	98	sk			6.75	661.50
506-105		1B		Poz Mix 'A'	52	sk			3.50	182.00
506-121		1B		(3) Hako Gel Added 20%						N/C
507-277		1B		Hako Gel Added 8%	41	sk			13.75	564.75
507-285		1B		Econolite	26	lb			1.90	497.40
507-210		1B		Flocele 1/4#	38	lb			1.30	49.40
504-316		1B		Halliburton Light Cement	200	sk			6.10	1220.00
507-210		1B		Flocele 1/4#	50	lb			1.30	65.00
509-9168		1B		Salt Granulated - On Side	100	lb	2	sk	1.10	110.00

Returned Mileage Charge	TOTAL WEIGHT	LOADED MILES	TON MILES	RECEIVED STATE CORPORATION COMMISSION
				MAR - 6 1991
SERVICE CHARGE ON MATERIALS RETURNED				CONSERVATION DIVISION CU. FEET Chita, Kansas
SERVICE CHARGE				532.110
Mileage Charge	47,611 TOTAL WEIGHT	45 LOADED MILES	1071.25 TON MILES	75 1.70
to. B 822365		CARRY FORWARD TO INVOICE	SUB-TOTAL	5643.22



WORK ORDER CONTRACT AND PRE-TREATMENT DATA

ORIGINAL

MAR 05 1992

ATTACH TO INVOICE & TICKET NO. 904393

M 1908 R-7

A Division of Halliburton Company

TRICT obencin, ks.

DATE 12-1-90

HALLIBURTON SERVICES YOU ARE HEREBY REQUESTED TO FURNISH EQUIPMENT AND SERVICEMEN TO DELIVER AND OPERATE THE SAME AS AN INDEPENDENT CONTRACTOR TO: NATIONAL PET. RESERVES (CUSTOMER) AND DELIVER AND SELL PRODUCTS, SUPPLIES, AND MATERIALS FOR THE PURPOSE OF SERVICING

LL NO. 1 LEASE PFETTEN SEC. 23 TWP. 9E RANGE 26W

LD _____ COUNTY Shenandoah STATE Ks. OWNED BY NAT. PET. RES.

THE FOLLOWING INFORMATION WAS FURNISHED BY THE CUSTOMER OR HIS AGENT

FORMATION ME _____ TYPE _____ FROM _____ TO _____ DEPTH 4170 MUD WEIGHT _____ TYPE D.V. Tool SET AT 2298 PRE HOLE 27 1/8 OIL _____ BPD, H2O _____ BPD, GAS _____ MCF

Table with columns: NEW USED, WEIGHT, SIZE, FROM, TO, MAX. ALLOW. P.S.I. Rows include CASING, LINER, TUBING, OPEN HOLE, PERFORATIONS.

PREVIOUS TREATMENT: DATE _____ TYPE _____ MATERIALS _____

TREATMENT INSTRUCTIONS: TREAT THRU TUBING [] ANNULUS [] CASING [] TUBING/ANNULUS [] HYDRAULIC HORSEPOWER ORDERED [] AT 4 1/2 csg w/ D.V. Tool @ 2298 on IT # 45, centralizers on 4, 7, 10, 13, 44 & 46, cut string on # 45, 1st stage - 2030L salt flush, signal supern flush, 140 STS EA-2 w/ 100% OSA CT, 250% O-Air, 15% NaCl 322 2nd stage - 150 STS ALD w/ 1/4 LB Flocculo - 200 STS ALD w/ 1/4 LB Flocculo

CUSTOMER OR HIS AGENT WARRANTS THE WELL IS IN PROPER CONDITION TO RECEIVE THE PRODUCTS, SUPPLIES, MATERIALS, AND SERVICES

The above-named Customer agrees: THIS CONTRACT MUST BE SIGNED BEFORE WORK IS COMMENCED Halliburton in accord with the rates and terms stated in Halliburton's current price list. Invoices are payable NET by the 20th of the following month after date of invoice.

1. Indemnify, release and hold harmless Halliburton, its divisions, subsidiaries, parent and affiliated companies and the officers, directors, employees, agents and servants of all of them from and against all claims, liability, expenses, attorneys fees, and costs of defense to the extent permitted by law for: Damage to property owned by, in the possession of, or leased by Customer, and/or the well owner (if different from Customer), including, but not limited to, surface and subsurface damage.

2. Indemnify, release and hold harmless obligations of Customer provided for in this Section b) and Section c) below shall apply to claims or liability even if caused or contributed to by Halliburton's negligence, or the unseaworthiness of any vessel owned, operated, or furnished by Halliburton or any defect in the data, products, supplies, materials, or equipment of Halliburton whether in the preparation, design, manufacture, distribution, or marketing thereof, or from a failure to warn any person of such defect.

3. In the event of the uncertainty of variable well conditions and the necessity of relying on facts and supporting services furnished by others, Halliburton is unable to guarantee the effectiveness of the products, materials, or the results of any treatment or service, nor the accuracy of any chart interpretation, research analysis, job recommendation or other data furnished by Halliburton.

4. Halliburton warrants only title to the products, supplies and materials and that the same are free from defects in workmanship and materials. THERE ARE NO WARRANTIES, EXPRESS OR IMPLIED, MERCHANTABILITY, FITNESS OR OTHERWISE WHICH EXTEND BEYOND THOSE STATED IN THE IMMEDIATELY PRECEDING SENTENCE.

5. Customer shall, at its risk and expense, attempt to recover any Halliburton equipment, tools or instruments which are lost in the well and if such equipment, tools or instruments are not recovered, Customer shall pay Halliburton its replacement cost unless such loss is due to the sole negligence of Halliburton.

6. This contract shall be governed by the law of the state where services are performed or materials are furnished.

I HAVE READ AND UNDERSTAND THIS CONTRACT AND REPRESENT THAT I AM AUTHORIZED TO SIGN THE SAME AS CUSTOMER'S AGENT.

SIGNED _____ DATE 12-1-90 CUSTOMER

certify that the Fair Labor Standards Act of 1938, as amended, has been complied with in the production of goods and/or with respect to services furnished under this contract.

TIME 0700 A.M. P.M. CUSTOMER