

15-065-016450000

STATE OF KANSAS  
STATE CORPORATION COMMISSION

Form CP-4

WELL PLUGGING RECORD

Give All Information Completely  
Make Required Affidavit  
Mail or Deliver Report to:  
Conservation Division  
State Corporation Commission  
212 No. Market  
Wichita, Kansas

NORTH

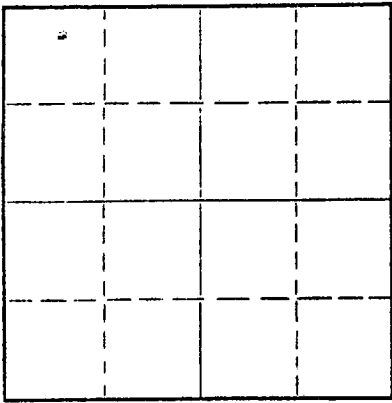

Locate well correctly on above  
Section Plat

Graham County, Sec. 34 Twp. 9S Rge. 25 (E) (W) X

Location as "NE/CNW/SW" or footage from lines SW NW  
Lease Owner John O. Farmer, Inc.  
Lease Name Rome Well No. 1  
Office Address 379 West Wichita Russell, Kansas  
Character of Well (completed as Oil, Gas or Dry Hole)  
Date well completed \_\_\_\_\_ 19\_\_\_\_  
Application for plugging filed 9-16-69 \_\_\_\_\_ 19\_\_\_\_  
Application for plugging approved \_\_\_\_\_ 19\_\_\_\_  
Plugging commenced 9-2-69 \_\_\_\_\_ 19\_\_\_\_  
Plugging completed 9-6-69 \_\_\_\_\_ 19\_\_\_\_  
Reason for abandonment of well or producing formation \_\_\_\_\_

RECEIVED  
STATE CORPORATION COMMISSION  
SEP 16 1969  
CONSERVATION DIVISION  
Wichita, Kansas

If a producing well is abandoned, date of last production \_\_\_\_\_ 19\_\_\_\_  
Was permission obtained from the Conservation Division or its agents before plugging was commenced? Yes

Name of Conservation Agent who supervised plugging of this well W. L. Nichols 45  
Producing formation \_\_\_\_\_ Depth to top \_\_\_\_\_ Bottom \_\_\_\_\_ Total Depth of Well 4031 FT Feet  
Show depth and thickness of all water, oil and gas formations. KCC

OIL, GAS OR WATER RECORDS

CASING RECORD

FORMATION	CONTENT	FROM	TO	SIZE	PUT IN	PULLED OUT
				8 5/8	160	None
				1 1/2	None 4041	1250
					BT KCC	

Describe in detail the manner in which the well was plugged, indicating where the mud fluid was placed and the method or methods used in introducing it into the hole. If cement or other plugs were used, state the character of same and depth placed, from \_\_\_\_\_ feet to \_\_\_\_\_ feet for each plug set.

Moved in. Rigged up unit. Cleaned out cellar. Working pipe.

Sanded to 400'. Dumped 4 sacks of cement. Working pipe. Shot pipe at 3520'. Circulating. Spotted 50 bbl of oil.

Working pipe. Shot pipe at 2400' - 2200' and 2000'.

Working pipe. Shot pipe at 1600' - 1500' - 1400' and 1250'. Pulling pipe.

Squeezed well with 35 sacks of mud - 5 sacks of hulls and 220 sacks of cement. Pumped 20 sacks of mud - 4 sacks of hulls and 70 sacks of cement. Pumped 1 sack of hulls - 15 sacks of mud and 50 sacks of cement.

(If additional description is necessary, use BACK of this sheet)

Name of Plugging Contractor Forbes Casing Pulling Company, Inc.  
Address P. O. Box 221 Great Bend, Kansas

STATE OF Kansas, COUNTY OF Barton, ss.  
James W. Rockhold (employee of owner) or (owner or operator) of the above-described well, being first duly sworn on oath, says: That I have knowledge of the facts, statements, and matters herein contained and the log of the above-described well as filed and that the same are true and correct. So help me God.

(Signature) James W. Rockhold  
P. O. Box 221 Great Bend, Kansas  
(Address)

SUBSCRIBED AND SWORN to before me this 12 day of September, 19 69

My commission expires May 27, 1973

(Signature) Notary Public.

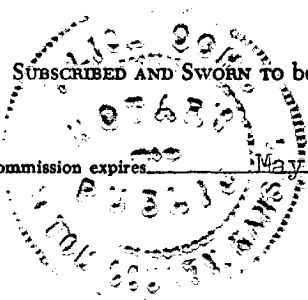

OPERATOR John O. Farmer, Inc.

ADDRESS P.O. Box 352, Russell, Kansas

Give detailed description and thickness of all formation drilled through, contents of sand, whether dry, water, oil or gas.

Formation	Top	Bottom	Formation	Top	Bottom
Shale & Sand		1340			
Shale	1340	1670			
Shale & Sand	1670	2210			
Shale & Shells	2210	2340			
Shale & Lime	2340	2825			
Lime & Shale	2825	4045			
Log Tops					
			Heebner	3790	(-1261)
			Toronto	3812	(-1283)
			Lansing Kansas C	3828	(-1299)
			Total Depth	4046	(-1517)

RECEIVED  
 STATE CORPORATION COMMISSION  
 AUG 25 1969  
 CONSERVATION DIVISION  
 Wichita, Kansas

I, the undersigned, being first duly sworn upon oath, state that this well record is true, correct and complete according to the records of this office and to the best of my knowledge and belief.

John O. Farmer  
 Name and title of representative of company  
 President

Subscribed and sworn to before me this 14th day of June, 1963

My Commission expires 2/15/67  
Helen Carlson  
 Notary Public.

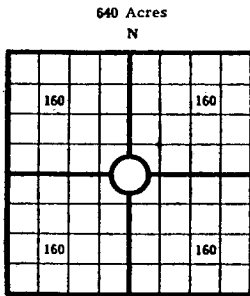

COUNTY Graham, SEC. 34, TWP. 9S, RGE. 25W  
 COMPANY OPERATING John O. Farmer, Inc.  
 OFFICE ADDRESS P.O. Box 352, Russell, Ks.  
 DRILLING STARTED 5/31, 1963, DRILLING FINISHED 6/8, 1963  
 DATE OF FIRST PRODUCTION \_\_\_\_\_ COMPLETED \_\_\_\_\_  
 WELL LOCATED C  $\frac{1}{4}$  SW  $\frac{1}{4}$  NW  $\frac{1}{4}$  \_\_\_\_\_, North of South  
 Line and \_\_\_\_\_ ft. East of West Line of Quarter Section  
 Elevation (Relative to sea level) DERRICK FLOOR 2527 GROUND, 2522  
 CHARACTER OF WELL (Oil, gas or dryhole) oil

OIL OR GAS SANDS OR ZONES

Name	From	To	Name	From	To
1			4		
2			5		
3			6		

Perforating Record if Any

Shot Record

Formation	From	To	No. of Shots	Formation	From	To	Size of Shot

CASING RECORD

Amount Set						Amount Pulled				Packer Record	
Size	Wt.	Thds.	Make	Ft.	In.	Ft.	In.	Size	Length	Depth Set	Make
8 5/8"				160							

Liner Record: Amount \_\_\_\_\_ Kind \_\_\_\_\_ Top \_\_\_\_\_ Bottom \_\_\_\_\_

CEMENTING AND MUDDING

Size	Amount Set		Sacks Cement	Chemical		Method of Cementing	Amount	Mudding Method	Results (See Note)
	Ft.	In.		Gal.	Make				
8 5/8"	160		100						

Note: What method was used to protect sands if outer strings were pulled? \_\_\_\_\_

NOTE: Were bottom hole plugs used? \_\_\_\_\_ If so, state kind, depth set and results obtained \_\_\_\_\_

TOOLS USED

Rotary Tools were used from 0 feet to T.D. Cable tools were used from \_\_\_\_\_ feet to \_\_\_\_\_ feet, and from \_\_\_\_\_ feet to \_\_\_\_\_ feet, and from \_\_\_\_\_ feet to \_\_\_\_\_ feet to \_\_\_\_\_

Type Rig Rotary

INITIAL PRODUCTION TEST

Describe initial test: whether by flow through tubing or casing or by pumping \_\_\_\_\_

Amount of Oil Production \_\_\_\_\_ bbls. Size of choke, if any \_\_\_\_\_ Length of test \_\_\_\_\_ Water

Production \_\_\_\_\_ bbls. Gravity of oil \_\_\_\_\_ Type of Pump if pump is used, describe \_\_\_\_\_

15-065-01645-0000  
 SEC 34 TWP 9S RGE 25W  
 #1 COUNTY Graham  
 FARM NAME - ROME