

15-065-20654-0000

KANSAS DRILLERS LOG

S. 33 T. 9S R. 24 ^W/₄
 Loc. C NW/4
 County Graham

API No. 15 — County _____ Number _____

Operator
Delta Western Company & George A. Reed

Address
806 First National Center, Oklahoma City, Okla.

Well No. 4 Lease Name Critchfield

Footage Location
660 feet from (N) XS line 660 feet from (E) X(W) line

Principal Contractor C-G DRILLING CO. Geologist George A. Reed

Spud Date February 21, 1974 Total Depth 4125 P.B.T.D. _____

Date Completed March 5, 1974 Oil Purchaser _____

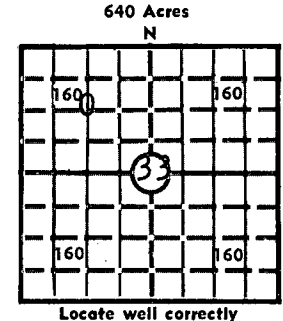

Locate well correctly
 Elev.: Gr. _____
 DF _____ KB 2527

CASING RECORD

Report of all strings set — surface, intermediate, production, etc.

Purpose of string	Size hole drilled	Size casing set (in O.D.)	Weight lbs/ft.	Setting depth	Type cement	Sacks	Type and percent additives
Surface	12 1/4"	8 5/8"	28#	299.35'	Common	150	2% Ge1 3% C C

LINER RECORD

PERFORATION RECORD

Top, ft.	Bottom, ft.	Sacks cement	Shots per ft.	Size & type	Depth interval

TUBING RECORD

Size	Setting depth	Packer set at

ACID, FRACTURE, SHOT, CEMENT SQUEEZE RECORD

Amount and kind of material used	Depth interval treated

RECEIVED
 STATE CORPORATION COMMISSION
 3-15-74
 MAR 15 1974
 CONSERVATION DIVISION
 Wichita, Kansas

INITIAL PRODUCTION

Date of first production _____ Producing method (flowing, pumping, gas lift, etc.) _____

RATE OF PRODUCTION PER 24 HOURS	Oil	Gas	Water	Gas-oil ratio
	bbls.	MCF	bbls.	CFPB

Disposition of gas (vented, used on lease or sold) _____ Producing interval(s) _____

INSTRUCTIONS: As provided in KCC Rule 82-2-125, within 90 days after completion of a well, one completed copy of this Drillers Log shall be transmitted to the State Geological Survey of Kansas, 4150 Monroe Street, Wichita, Kansas 67209. Copies of this form are available from the Conservation Division, State Corporation Commission, 3830 So. Meridian (P.O. Box 17027), Wichita, Kansas 66217. Phone AC 316-522-2206. If confidential custody is desired, please note Rule 82-2-125. Drillers Logs will be on open file in the Oil and Gas Division, State Geological Survey of Kansas, Lawrence, Kansas 66044.

Operator **Delta Western Company & George A. Reed** DESIGNATE TYPE OF COMP.: OIL, GAS, DRY-HOLE, SWDW, ETC.:

Well No. **4** Lease Name **Critchfield** Dry Hole

s **33 T 9 S R 24 X** W

WELL LOG

Show all important zones of porosity and contents thereof; cored intervals, and all drill-stem tests, including depth interval tested, cushion used, time tool open, flowing and shut-in pressures, and recoveries.

SHOW GEOLOGICAL MARKERS, LOGS RUN, OR OTHER DESCRIPTIVE INFORMATION.

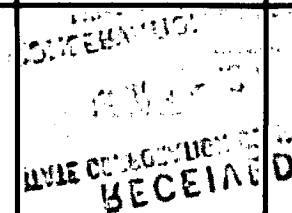
FORMATION DESCRIPTION, CONTENTS, ETC.	TOP	BOTTOM	NAME	DEPTH	
Shale	0	1025			
Sand	1025	1055			
Shale & sand	1055	1735			
Sand	1735	1930			
Red Bed & Shale	1930	2182			
Anhydrite	2182	2224			
Shale	2224	2240			
Shale & shells	2240	2490			
Lime & shale	2490	2580			
Shale	2580	2800			
Lime & shale	2800	3932			
Lime	3932	4125			
RTD		4125			
<p>DST #1 4024'-4055' Open 20 SI 20 Open 20 SI 20 Weak blow - recovered 10' mud IBHP 0 FBHP 0 IFP 0 FFP 0 DST #2 3989'-4125' Open 10 SI 20 Op 40 SI 20 Rec 10' Mud IBHP 211# FBHP 137# IFP 95# FFP 105# DST #3 (SP) 3880'-3915' Open 1 hr 15 min SI 45 Rec 800' Salt Water FBHP 466 IFP 68 FFP DST #4 (SP) 3815'-3880' Open 1 hr 45 min SI 45 min Rec 750' Salt Water DST #5 3740'-3788' Open 1 1/2 hr SI 1 hr Rec 1000' muddy water IFP FFP 929 FBHP 1259</p>					

USE ADDITIONAL SHEETS, IF NECESSARY, TO COMPLETE WELL RECORD.

Date Received _____

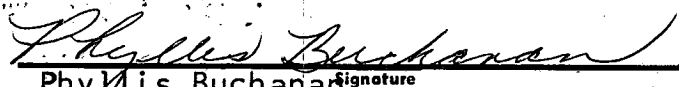
 Phyllis Buchanan Signature
 Office Manager/C-G DRILLING CO.
Title
 March 7, 1974
Date