

CARD MUST BE TYPED

NOTICE OF INTENTION TO DRILL

CARD MUST BE SIGNED

(see rules on reverse side)

Starting Date: 7-15-85 month day year

API Number 15- 051-24,274-00-00

OPERATOR: License # 7960

NE-NE-SE (location) Sec 22 Twp 11 S, Rge 20 East West

Name Circle S Oil Company

Address RR, Box 71

City/State/Zip Zurich, Kansas 67676

Contact Person Edna M. Schonthaler

Phone 913-737-5965

2290 Ft North from Southeast Corner of Section

395 Ft West from Southeast Corner of Section

(Note: Locate well on Section Plat on reverse side)

CONTRACTOR: License # 5302

Nearest lease or unit boundary line 350 feet

Name Red Tiger Drilling Co.

County Ellis

City/State Wichita, Kansas 67202

Lease Name Fenton Well# 1

Well Drilled For: Well Class: Type Equipment:

Domestic well within 330 feet: yes no

Oil Swd Infield Mud Rotary

Municipal well within one mile: yes no

Gas Inj Pool Ext Air Rotary

Depth to Bottom of fresh water 100 feet

OWWO Expl Wildcat Cable

Lowest usable water formation Dakota

If OWWO: old well info as follows:

Depth to Bottom of usable water 900 feet

Operator

Surface pipe by Alternate: 1 2

Well Name

Surface pipe to be set 200 feet

Comp Date Old Total Depth

Conductor pipe if any required feet

Projected Total Depth feet

Ground surface elevation NA feet MSL

Projected Formation at TD

This Authorization Expires 1-9-86

Expected Producing Formations

Approved By 7-9-85

I certify that we will comply with K.S.A. 55-101, et seq., plus eventually plugging hole to K.C.C. specifications.

Date 7/8/85 Signature of Operator or Agent

Edna M. Schonthaler Operator

Must be filed with the K.C.C. five (5) days prior to commencing well
This card void if drilling not started within six (6) months of date received by K.C.C.

RECEIVED
STATE CORPORATION COMMISSION

A Regular Section of Land

1 Mile = 5,280 FT.

CONSERVATION DIVISION

Wichita, Kansas

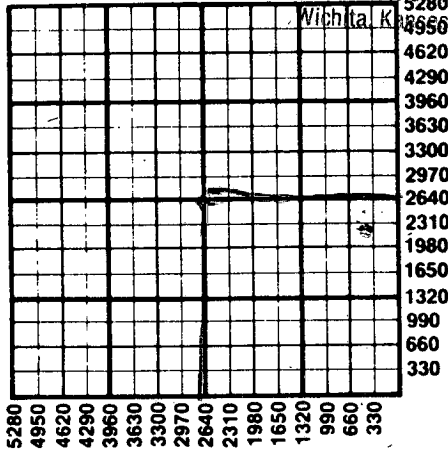

Important procedures to follow :

1. Notify District office before setting surface casing.
2. Set surface casing by circulating cement to the top.
3. File completion forms ACO-1 with K.C.C. within 90 days of well completion, following instructions on ACO-1, side 1, and including copies of wireline logs.
4. Notify District office 48 hours prior to old well workover or re-entry.
5. Prior to plugging, prepare a plugging plan, then obtain agreement from the appropriate district office for an approved plugging plan.
6. Submit plugging report (CP-4) to K.C.C. after plugging is completed.
7. Obtain an approved injection docket number before disposing of salt water.
8. Notify K.C.C. within 10 days when injection commences or terminates.
9. If an alternate 2 completion, cement in the production pipe from below any usable water to surface within 120 days of spud date.

State Corporation Commission of Kansas
Conservation Division
200 Colorado Derby Building
Wichita, Kansas 67202
(316) 263-3238