

**KANSAS CORPORATION COMMISSION
OIL & GAS CONSERVATION DIVISION
WELL COMPLETION FORM
WELL HISTORY - DESCRIPTION OF WELL & LEASE**

Form ACO-1
September 1999
Form Must Be Typed

ORIGINAL

Operator: License # 33608
 Name: W. D. Short Oil Co., LLC
 Address: P. O. Box 729
 City/State/Zip: Oxford, Kansas 67119
 Purchaser: Sem Crude
 Operator Contact Person: William D.(Don) Short, Jr.
 Phone: (620) 455-3576
 Contractor: Name: Berentz Drilling Co., Inc.
 License: 5892
 Wellsite Geologist: Joe Baker
 Designate Type of Completion:
 New Well Re-Entry Workover
 Oil SWD SLOW Temp. Abd.
 Gas ENHR SIGW
 Dry Other (Core, WSW, Expl., Cathodic, etc)
 If Workover/Re-entry: Old Well Info as follows:
 Operator: _____
 Well Name: _____
 Original Comp. Date: _____ Original Total Depth: _____
 Deepening Re-perf. Conv. to Enhr./SWD
 Plug Back _____ Plug Back Total Depth _____
 Commingled Docket No. _____
 Dual Completion Docket No. _____
 Other (SWD or Enhr.?) Docket No. _____

<u>10-28-06</u>	<u>11-05-06</u>	<u>2-13-2007</u>
Spud Date or Recompletion Date	Date Reached TD	Completion Date or Recompletion Date

API No. 15 - 035-24261-0000
 County: Cowley
100W C E/2 NE Sec. 20 Twp. 33 S. R. 3 East West
1300 feet from S / (N) (circle one) Line of Section
730 feet from (E) W (circle one) Line of Section
 Footages Calculated from Nearest Outside Section Corner:
 (circle one) (NE) SE NW SW
 Lease Name: M. Short Well #: 3
 Field Name: Rainbow Bend
 Producing Formation: Bartlesville
 Elevation: Ground: 1116' Kelly Bushing: _____
 Total Depth: 4000' Plug Back Total Depth: _____
 Amount of Surface Pipe Set and Cemented at 330 Feet
 Multiple Stage Cementing Collar Used? Yes No
 If yes, show depth set _____ Feet
 If Alternate II completion, cement circulated from _____
 feet depth to _____ sx cmt.
AKI-KCC-Dlg

Drilling Fluid Management Plan
 (Data must be collected from the Reserve Pit)
 Chloride content _____ ppm Fluid volume 500 bbls
 Dewatering method used Fluids hauled from reserve pit
 Location of fluid disposal if hauled offsite: _____
 Operator Name: _____
 Lease Name: _____ License No.: _____
 Quarter _____ Sec. _____ Twp. _____ S. R. _____ East West
 County: _____ Docket No.: _____

INSTRUCTIONS: An original and two copies of this form shall be filed with the Kansas Corporation Commission, 130 S. Market - Room 2078, Wichita, Kansas 67202, within 120 days of the spud date, recompletion, workover or conversion of a well. Rule 82-3-130, 82-3-106 and 82-3-107 apply. Information of side two of this form will be held confidential for a period of 12 months if requested in writing and submitted with the form (see rule 82-3-107 for confidentiality in excess of 12 months). One copy of all wireline logs and geologist well report shall be attached with this form. ALL CEMENTING TICKETS MUST BE ATTACHED. Submit CP-4 form with all plugged wells. Submit CP-111 form with all temporarily abandoned wells.

All requirements of the statutes, rules and regulations promulgated to regulate the oil and gas industry have been fully complied with and the statements herein are complete and correct to the best of my knowledge.

Signature: [Handwritten Signature]
 Title: Resident Agent Date: FEB 13th 2007
 Subscribed and sworn to before me this 13th day of February
20 07
 Notary Public: [Handwritten Signature]
 Date Commission Expires: 3-30-09

DENESE A. WILSON
 Notary Public - State of Kansas
 My Appt. Expires 3-30-09

KCC Office Use ONLY

Letter of Confidentiality Received
 If Denied, Yes Date: _____
 Wireline Log Received
 Geologist Report Received
 UIC Distribution

RECEIVED
FEB 20 2007

KCC WICHITA

Operator Name: W. D. Short Oil Co., LLC Lease Name: M. Short Well #: 3
 Sec. 20 Twp. 33 S. R. 3 East West County: Cowley

INSTRUCTIONS: Show important tops and base of formations penetrated. Detail all cores. Report all final copies of drill stems tests giving interval tested, time tool open and closed, flowing and shut-in pressures, whether shut-in pressure reached static level, hydrostatic pressures, bottom hole temperature, fluid recovery, and flow rates if gas to surface test, along with final chart(s). Attach extra sheet if more space is needed. Attach copy of all Electric Wireline Logs surveyed. Attach final geological well site report.

Drill Stem Tests Taken <input type="checkbox"/> Yes <input checked="" type="checkbox"/> No <i>(Attach Additional Sheets)</i> Samples Sent to Geological Survey <input checked="" type="checkbox"/> Yes <input type="checkbox"/> No Cores Taken <input type="checkbox"/> Yes <input checked="" type="checkbox"/> No Electric Log Run <input checked="" type="checkbox"/> Yes <input type="checkbox"/> No <i>(Submit Copy)</i> List All E. Logs Run:	<input type="checkbox"/> Log Formation (Top), Depth and Datum <input checked="" type="checkbox"/> Sample Name Top Datum Arbuckle 3600'
--	--

CASING RECORD <input type="checkbox"/> New <input checked="" type="checkbox"/> Used							
Report all strings set-conductor, surface, intermediate, production, etc.							
Purpose of String	Size Hole Drilled	Size Casing Set (In O.D.)	Weight Lbs. / Ft.	Setting Depth	Type of Cement	# Sacks Used	Type and Percent Additives
Surface	13-1/2"	10-3/4"	49.5	330'	Class "A"	260	3% Calcium 2% Gel
Production	8-3/4"	7"	32	4000'	60/40 POZ MIX	250	4% Gel

ADDITIONAL CEMENTING / SQUEEZE RECORD				
Purpose:	Depth Top Bottom	Type of Cement	#Sacks Used	Type and Percent Additives
<input type="checkbox"/> Perforate				
<input checked="" type="checkbox"/> Protect Casing	325-2460	60/40 Poz Mix	250	6% Gel
<input type="checkbox"/> Plug Back TD				
<input type="checkbox"/> Plug Off Zone	325-0	60/40 Poz Mix	125	2% Gel

Shots Per Foot	PERFORATION RECORD - Bridge Plugs Set/Type Specify Footage of Each Interval Perforated	Acid, Fracture, Shot, Cement Squeeze Record (Amount and Kind of Material Used)	Depth
4 Shots/Ft.	3664-84		
4 Shots/Ft.	3750-3804		
4 Shots/Ft.	3964-68		
4 Shots/Ft.	3974-78		

TUBING RECORD	Size	Set At	Packer At	Liner Run <input type="checkbox"/> Yes <input type="checkbox"/> No
---------------	------	--------	-----------	--

Date of First, Resumerd Production, SWD or Enhr. SWD-Pending Application Approval	Producing Method <input type="checkbox"/> Flowing <input type="checkbox"/> Pumping <input type="checkbox"/> Gas Lift <input type="checkbox"/> Other (Explain)
---	---

Estimated Production Per 24 Hours	Oil Bbls.	Gas Mcf	Water Bbls.	Gas-Oil Ratio	Gravity
-----------------------------------	-----------	---------	-------------	---------------	---------

Disposition of Gas <input type="checkbox"/> Vented <input type="checkbox"/> Sold <input type="checkbox"/> Used on Lease <i>(If vented, Submit ACO-18.)</i>	METHOD OF COMPLETION <input type="checkbox"/> Open Hole <input type="checkbox"/> Perf. <input type="checkbox"/> Dually Comp. <input type="checkbox"/> Commingled <input type="checkbox"/> Other (Specify)	Production Interval
---	---	---------------------

RECEIVED
 FEB 20 2007
 KCC WICHITA

ROBERT E. MOSER, R.L.S.

Oil Field Surveying

335 N. Mission Road • Wichita, Kansas 67206
(316) 683-2853

23 October 2006

W.D. Short oil Co., LLC
P.O. Box 729
Oxford, KS 67119

Surveying services ($\frac{1}{2}$ day), mileage (80),
materials and drafting to STAKE/ELEVATION/
& VERIFY OPER'S. LOCATION of below listed
well location in Cowley County, KS:

20-33s-03e requested 100' W of C E/2 NE
(found oper's. stake & digging
pits 100' W of old hole, and
approx. 1300' FNL - 730' FEL ((E.L.
of section being an indistinct N-S
line without digging up corner stones)),
causing location of old hole to be ???.

#A-3 Nelson

Elevation - 1116.0' gr. @ stk.

Work requested by Mr. D. Walters (ph 10-20-06).

Fee - \$175.00

Please Pay From This Invoice. Thank You.

R. E. Moser

R.E. Moser, R.L.S. #329

RECEIVED
KANSAS CORPORATION COMMISSION
DEC 6 2006



ROBERT E. MOSER, R.L.S.

Oil Field Surveying

335 N. Mission Road • Wichita, Kansas 67206
(316) 683-2853



1311023062

INVOICE NO.

W.D. SHORT OIL CO., LLC

OPERATOR

A-3

Nelson

NO.

FARM

Cowley (KS) 20 33s 03e

1300' FNL - 730' FEL (100' W of old well)

COUNTY

S T R

LOCATION

ELEVATION: 1116.0' gr.

W.D. Short Oil Co., LLC
Box 729
Oxford, KS 67119

RECEIVED
KANSAS CORPORATION COMMISSION
DEC 6 2006

AUTHORIZED BY: Mr. D. Walters (Berentz Drlg.) (ph 10/20/06)

SCALE: 1" = 1000'

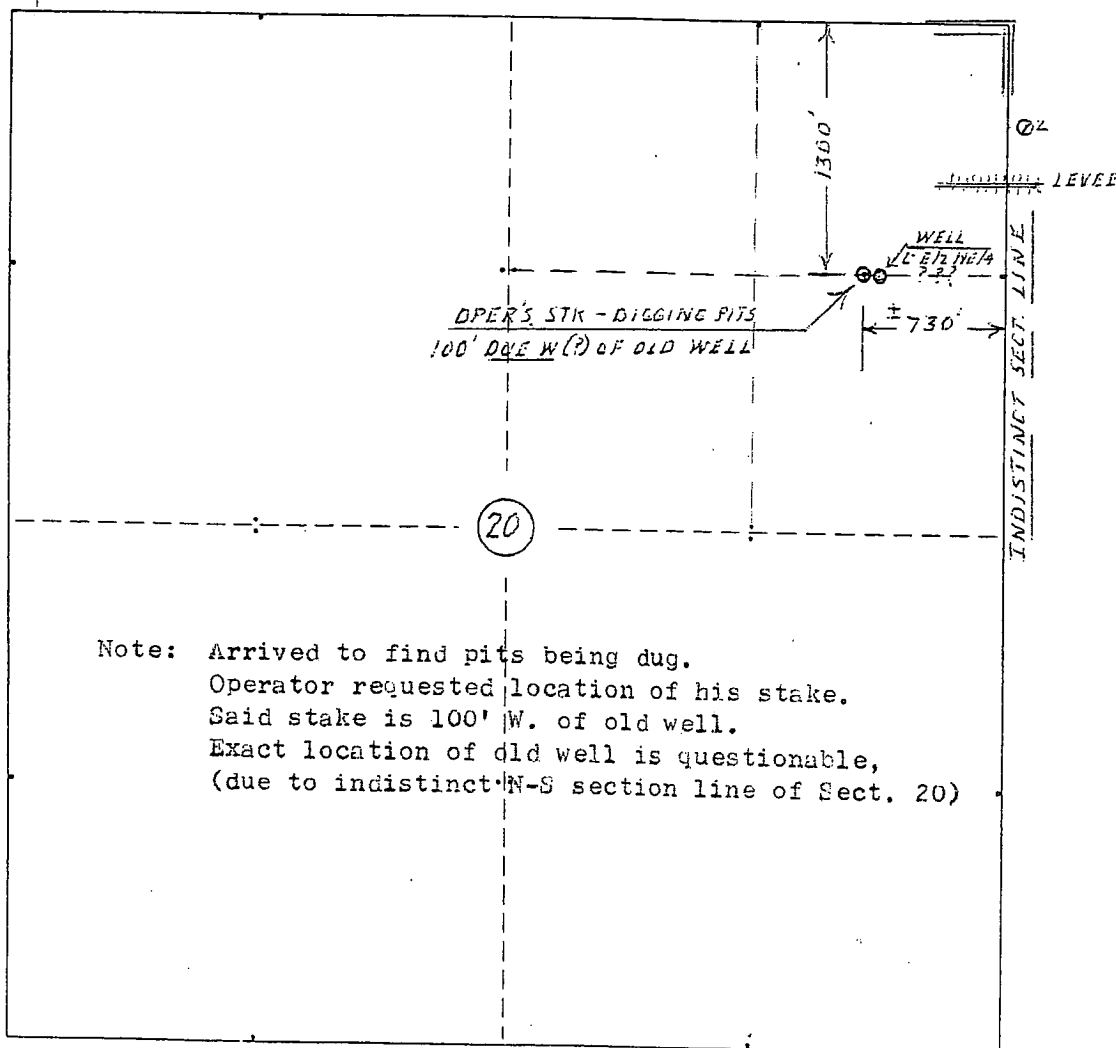

Note: Arrived to find pits being dug.
Operator requested location of his stake.
Said stake is 100' W. of old well.
Exact location of old well is questionable,
(due to indistinct N-S section line of Sect. 20)

OK-DON
S+S LLC
M.SHORT #3

Date: 23 October 2006
R. E. Moser

Surveyor: R. E. Moser, R.L.S. #329

CONSOLIDATED
OIL WELL
SERVICES, LLC

REMITTO
 Consolidated Oil Well Services,
 Dept. 1228
 Denver, CO 80256

MAIN OFFICE
 P.O. Box 884
 Chanute, KS 66720
 620/431-9210 • 1-800/467-8676
 FAX 620/431-0012

INVOICE

Invoice # 211694

Invoice Date: 01/30/2007 Terms: Page 1

W.D. SHORT OIL CO LLC
 P.O. BOX 729
 OXFORD KS 67115
 () -

M. SHORT #3
 16814
 01-29-07

Part Number	Description	Qty	Unit Price	Total
1131	60/40 POZ MIX	125.00	9.8000	1225.00
1118A	S-5 GEL/ BENTONITE (50#)	215.00	.1500	32.25

Description	Hours	Unit Price	Total
445 CEMENT PUMP (SURFACE)	1.00	650.00	650.00
445 EQUIPMENT MILEAGE (ONE WAY)	80.00	3.30	264.00
479 TON MILEAGE DELIVERY	429.60	1.10	472.56

RECEIVED
 FEB 20 2007
 KCC WICHITA

OK-DON
 SAS LLC
 M.Short #3

Parts:	1257.25	Freight:	.00	Tax:	72.92	AR	2716.73
Labor:	.00	Misc:	.00	Total:	2716.73		
Sublt:	.00	Supplies:	.00	Change:	.00		

Signed _____ Date _____

BARTLESVILLE, OK 278 CR 2706 74003 918/338-0808
 EUREKA, KS 820 E. 7th 67045 620/583-7664
 OTTAWA, KS 2631 So. Eisenhower Ave. 66057 785/242-4044
 GILLETTE, WY 300 Enterprise Avenue 82716 307/686-4914
 THAYER, KS 8655 Dorn Road 66776 620/839-5269
 WORLAND, WY 837 Hwy US 16 E 82401 307/347-4577

CONSOLIDATED OIL WELL SERVICES, LLC
 P.O. BOX 884, CHANUTE, KS 66720
 620-431-9210 OR 800-467-8676

TICKET NUMBER 16814
 LOCATION EUREKA
 FOREMAN KEVIN MCCOY

TREATMENT REPORT & FIELD TICKET
 CEMENT

DATE	CUSTOMER #	WELL NAME & NUMBER	SECTION	TOWNSHIP	RANGE	COUNTY
1-29-07	1816	M. Short #3	20	335	3E	Combs
CUSTOMER W. D. Short Oil Co., LLC			Co. Tools			
MAILING ADDRESS P.O. Box 729						
CITY	STATE	ZIP CODE	TRUCK #	DRIVER	TRUCK #	DRIVER
Oxford	Ks	67119	445	Justin		
			479	Jeff		

JOB TYPE Top outside HOLE SIZE 10 3/4 casing HOLE DEPTH _____ CASING SIZE & WEIGHT 7"
 CASING DEPTH _____ DRILL PIPE _____ TUBING 1" OTHER _____
 SLURRY WEIGHT _____ SLURRY VOL _____ WATER gal/sk _____ CEMENT LEFT in CASING _____
 DISPLACEMENT _____ DISPLACEMENT PSI _____ MIX PSI _____ RATE _____

REMARKS: Safety Meeting: RAN 1" Tubing down Annulus of 7" casing, Tag Cement @ 300', BREAK Circulation w/ Fresh water, MIXED 110 SKS 60/40 Pozmix Cement w/ 2% GEL. Good Cement to Surface. Pull 1" Tubing. Job Complete.

Note: Fill Drilling Rig Rat Hole w/ 15 SKS Cement.

ACCOUNT CODE	QUANTITY or UNITS	DESCRIPTION of SERVICES or PRODUCT	UNIT PRICE	TOTAL
5401S	1	PUMP CHARGE	650.00	650.00
5406	80	MILEAGE	3.30	264.00
1131	125 SKS	60/40 Pozmix Cement	9.80	1225.00
1118A	215 "	Gel 2%	.15 "	32.25
5407	5.37 TONS	80 miles BUCK TRUCK	1.10	472.56
			Sub Total	2643.81
			SALES TAX	72.92
			ESTIMATED TOTAL	2716.73

THANK YOU 211694 5.8%

AUTHORIZATION witnessed By Mike User TITLE Co-Rep. DATE RECEIVED

FEB 20 2007
 KCC WICHITA



CONSOLIDATED
OIL WELL
SERVICES, INC.
 AN INFINITY COMPANY

REMIT TO
 Consolidated Oil Well Services, Inc.
 Dept. 1228
 Denver, CO 80256

MAIN OFFICE
 P.O. Box 884
 Chanute, KS 66720
 620/431-9210 • 1-800/467-8676
 FAX 620/431-0012

INVOICE

Invoice # 210158

Invoice Date: 10/31/2006 Terms: Page 1

W.D. SHORT OIL CO LLC
 P.O. BOX 729
 OXFORD KS 67115
 () -

M. SHORT #3
 16457
 10-27-06

Part Number	Description	Qty	Unit Price	Total
1104S	CLASS "A" CEMENT (SALE)	260.00	11.2500	2925.00
1102	CALCIUM CHLORIDE (50#)	730.00	.6400	467.20
1118A	S-5 GEL/ BENTONITE (50#)	490.00	.1400	68.60
1107	FLO-SEAL (25#)	65.00	1.8000	117.00
Description		Hours	Unit Price	Total
439	TON MILEAGE DELIVERY	977.60	1.05	1026.48
463	CEMENT PUMP (SURFACE)	1.00	620.00	620.00
463	EQUIPMENT MILEAGE (ONE WAY)	80.00	3.15	252.00

OK-DON
 S4SLLC

Parts:	3577.80	Freight:	.00	Tax:	207.52	AR	5683.80
Labor:	.00	Misc:	.00	Total:	5683.80		
Sublt:	.00	Supplies:	.00	Change:	.00		

RECEIVED
 FEB 20 2007

Signed _____ Date **KCC WICHITA**

BARTLESVILLE, OK
 P.O. Box 1453 74005
 918/338-0808

EUREKA, Ks
 820 E. 7th 67045
 620/583-7664

OTTAWA, Ks
 2631 So. Eisenhower Ave. 66067
 785/242-4044

GILLETTE, WY
 300 Enterprise Avenue 82716
 307/686-4914

THAYER, Ks
 8655 Dorn Road 66776
 620/839-5269

CONSOLIDATED OIL WELL SERVICES, INC.
 P.O. BOX 884, CHANUTE, KS 66720
 620-431-9210 OR 800-467-8676

TICKET NUMBER 16457
 LOCATION EDGEMO
 FOREMAN RICK LEONARD

TREATMENT REPORT & FIELD TICKET
 CEMENT

DATE	CUSTOMER #	WELL NAME & NUMBER	SECTION	TOWNSHIP	RANGE	COUNTY
10-27-06	7876	M Short #3				Cowley
CUSTOMER W. D. Short Oil Co. LLC		Oreanz Drilling				
MAILING ADDRESS P.O. Box 729						
CITY Oxford	STATE KS					
TRUCK #	DRIVER	TRUCK #	DRIVER			
468	Kyle					
439	Jarrod					

JOB TYPE surface HOLE SIZE 13 3/4" HOLE DEPTH 330' CASING SIZE & WEIGHT 10 3/4" used
 CASING DEPTH 323' DRILL PIPE _____ TUBING _____ OTHER _____
 SLURRY WEIGHT 15* SLURRY VOL _____ WATER gal/sk _____ CEMENT LEFT in CASING 30'
 DISPLACEMENT 28 1/4 bbl DISPLACEMENT PSI _____ MIX PSI _____ RATE _____

REMARKS: Safety meeting. Rig up to 10 3/4" casing. Break circulation w/ 10 bbl fresh water. Pump 5 bbl dye water. Mixed 260 sks regular cement w/ 3% CaCl2, 2% gel, 1/4" floccle per/sk. Displace w/ 28 1/4 bbl fresh water. shut casing in. Good cement returns to surface. Job complete. Rig down.

"Thank You"

ACCOUNT CODE	QUANTITY or UNITS	DESCRIPTION of SERVICES or PRODUCT	UNIT PRICE	TOTAL
54015	1	PUMP CHARGE	620.00	620.00
5406	80	MILEAGE	3.15	252.00
11045	260 sks	Class "A" cement	11.25	2925.00
1102	730 #	CaCl2 3%	.64	467.20
1118A	490 #	Gel 2%	.14	68.60
1107	65 #	Floccle 1/4" per/sk	1.80	117.00
5407A	12.22	Ton-mileage Buick Tax	1.05	1026.48
			RECEIVED	
			FEB 20 2007	
			KCC WICHITA	
			subtotal	5476.28
			SALES TAX	201.52
			ESTIMATED TOTAL	5683.80

210158

AUTHORIZATION witnessed by Co. Rep. TITLE _____ DATE _____



CONSOLIDATED
OIL WELL
SERVICES, INC.
 AN INFINITY COMPANY

REMIT TO
 Consolidated Oil Well Services, Inc.
 Dept. 1228
 Denver, CO 80256

MAIN OFFICE
 P.O. Box 884
 Chanute, KS 66720
 620/431-9210 • 1-800/467-8676
 FAX 620/431-0012

INVOICE

Invoice # 210408

Invoice Date: 11/10/2006 Terms:

Page 1

W.D. SHORT OIL CO LLC
 P.O. BOX 729
 OXFORD KS 67115
 () -

M. SHORT #3
 16521
 11-05-06

Part Number	Description	Qty	Unit Price	Total
1131	60/40 POZ MIX	250.00	9.3500	2337.50
1118A	S-5 GEL/ BENTONITE (50#)	850.00	.1400	119.00
1123	CITY WATER	6000.00	.0128	76.80
4409	7" RUBBER PLUG(TOP)	1.00	70.0000	70.00
4131	CENTRALIZER 7"	2.00	50.0000	100.00
4105	CEMENT BASKET 7 5/8"	2.00	280.0000	560.00
4163	FLOAT SHOE 7" W/FLAPPER	1.00	344.0000	344.00

Description	Hours	Unit Price	Total
T-63 WATER TRANSPORT (CEMENT)	10.00	98.00	980.00
439 TON MILEAGE DELIVERY	860.00	1.05	903.00
445 CEMENT PUMP	1.00	800.00	800.00
445 EQUIPMENT MILEAGE (ONE WAY)	80.00	3.15	252.00
PERDI CREW MOBILIZATION	1.00	1200.00	1200.00

OK-DON
SAS/LC

Parts:	3607.30	Freight:	.00	Tax:	209.22	AR	7951.52
Labor:	.00	Misc:	.00	Total:	7951.52		
Sublt:	.00	Supplies:	.00	Change:	.00		

RECEIVED

FEB 20 2007

Signed _____

Date _____

KCC WICHITA

BARTLESVILLE, OK
 P.O. Box 1453 74005
 918/338-0808

EUREKA, Ks
 820 E. 7th 67045
 620/583-7664

OTTAWA, Ks
 2631 So. Eisenhower Ave. 66067
 785/242-4044

GILLETTE, WY
 300 Enterprise Avenue 82716
 307/686-4914

THAYER, Ks
 8655 Dorn Road 66776
 620/839-5269

CONSOLIDATED OIL WELL SERVICES, INC.
 P.O. BOX 884, CHANUTE, KS 66720
 620-431-9210 OR 800-467-8676

TICKET NUMBER 16521
 LOCATION EUREKA
 FOREMAN Kevin McCoy

TREATMENT REPORT & FIELD TICKET
 CEMENT

DATE	CUSTOMER #	WELL NAME & NUMBER	SECTION	TOWNSHIP	RANGE	COUNTY
11-5-06	7816	M. SHORT #3	20	33S	3E	Cowley
CUSTOMER W.D. Short Oil Co., LLC			Bearentz			
MAILING ADDRESS P.O. Box 729			DRIG. Co.			
CITY OXFORD	STATE KS	ZIP CODE 67119	TRUCK # 445	DRIVER Justin	TRUCK #	DRIVER
			439	JERRID		
			452 T63	JIM		

JOB TYPE Longstring HOLE SIZE 8 3/4" & 7 1/8" HOLE DEPTH 4000' K.B. CASING SIZE & WEIGHT 7" 26" used
 CASING DEPTH 3994' KB DRILL PIPE _____ TUBING _____ OTHER _____
 SLURRY WEIGHT 13.8* SLURRY VOL 62 BBL WATER gal/sk 6.7 CEMENT LEFT in CASING 150'
 DISPLACEMENT 128 BBL DISPLACEMENT PSI 900 PSI 500 Shut in RATE _____

REMARKS: Safety Meeting: Note: While Running LAST JT OF 7" CASING PARTED. DROPPED ~ 3680' CASING DOWN THE HOLE. MADE & WELDED 8 3/8 OVERSHOT ON 7" CASING. RAN 7" CASING. SCREW ONTO 7" CASING. (HOOK LOAD BEFORE SCREWING INTO 7" WAS 40,000*). PULL 20,000 OVER HOOK LOAD. (7" WENT TO T.D. OF WELL BORE = 3994' KB) RIG UP TO 7". PRESSURE 7" TO 600 PSI. NO DECREASE IN PRESSURE. RIG UP LOG-TECH. LOCATE BOTTOM 18 COLLARS. SHOT 8 HOLE @ 3590' - 91'. RIG UP TO CEMENT. BREAK CIRCULATION w/ 15 BBL FRESH WATER. MIXED 250 SKS 60/40 POZMIX CEMENT w/ 4% GEL @ 13.8* PER/GAL, WASH OUT PUMP & LINES. SHUT DOWN. RELEASE PLUG. DISPLACE w/ 128 BBL FRESH WATER. FINAL PUMPING PRESSURE 900 PSI. SHUT IN @ 500 PSI. STOP PLUG @ 3444' BY WIRE LINE MEASUREMENT. GOOD CIRCULATION WHILE CEMENTING. JOB COMPLETE. RIG DOWN.

ACCOUNT CODE	QUANTITY or UNITS	DESCRIPTION of SERVICES or PRODUCT	UNIT PRICE	TOTAL
5401	1	PUMP CHARGE	800.00	800.00
5406	80	MILEAGE	3.15	252.00
1131	250 SKS	60/40 Pozmix Cement	9.35	2337.50
1118 A	850 "	Gel 4%	.14 *	119.00
5407 A	10.75 TONS	80 miles BULK TRUCK	1.05	903.00
5501 C	10 HRS	WATER TRANSPORT	98.00	980.00
1123	6000 GALS	CITY WATER	12.80 ^{PER 1000}	76.80
4409	1	7" Top Rubber Plug	70.00	70.00
4131	2	7" x 8 3/4" CENTRALIZERS	50.00	100.00
4105	2	7" Cement Baskets	280.00	560.00
4163	1	7" AFU FLOAT shoe	344.00	344.00
5410	3 PERSONNEL	CROW Mobilization	KCC WICHITA	1200.00
			Sub Total	7742.30
		THANK YOU	5.8%	SALES TAX
				ESTIMATED TOTAL
				7951.52

AUTHORIZATION Witnessed By Mike User TITLE Co. Rep. DATE _____

210408

325-2460



CONSOLIDATED
OIL WELL
SERVICES, INC.
AN INFINITY COMPANY

REMIT TO
Consolidated Oil Well Services, Inc.
Dept. 1228
Denver, CO 80256

MAIN OFFICE
P.O. Box 884
Chanute, KS 66720
620/431-9210 • 1-800/467-8676
FAX 620/431-0012

INVOICE

Invoice # 210409

Invoice Date: 11/10/2006 Terms:

Page 1

W.D. SHORT OIL CO LLC
P.O. BOX 729
OXFORD KS 67115
() -

M.SHORT #3
16524
11-07-06

Part Number	Description	Qty	Unit Price	Total
1131	60/40 POZ MIX	250.00	9.3500	2337.50
1118A	S-5 GEL/ BENTONITE (50#)	1300.00	.1400	182.00
1131	60/40 POZ MIX	210.00	9.3500	1963.50
1118A	S-5 GEL/ BENTONITE (50#)	720.00	.1400	100.80
1102	CALCIUM CHLORIDE (50#)	270.00	.6400	172.80
1123	CITY WATER	5500.00	.0128	70.40
4409	7" RUBBER PLUG(TOP)	1.00	70.0000	70.00

Description	Hours	Unit Price	Total
T-63 WATER TRANSPORT (CEMENT)	6.00	98.00	588.00
439 TON MILEAGE DELIVERY	791.20	1.05	830.76
445 CEMENT PUMP	1.00	800.00	800.00
445 EQUIPMENT MILEAGE (ONE WAY)	80.00	3.15	252.00
502 TON MILEAGE DELIVERY	791.20	1.05	830.76

OK-DON
M.SHORT#3
S&S LLC

Parts:	4897.00	Freight:	.00	Tax:	284.03	AR	8482.55
Labor:	.00	Misc:	.00	Total:	8482.55		
Sublt:	.00	Supplies:	.00	Change:	.00		

RECEIVED

FEB 20 2007

Signed _____

Date KCC WICHITA

BARTLESVILLE, OK
P.O. Box 1453 74005
918/338-0808

EUREKA, KS
820 E. 7th 67045
620/583-7664

OTTAWA, KS
2631 So. Eisenhower Ave. 66067
785/242-4044

GILLETTE, WY
300 Enterprise Avenue 82716
307/686-4914

THAYER, KS
8655 Dorn Road 66776
620/839-5269

CONSOLIDATED OIL WELL SERVICES, INC.
 P.O. BOX 884, CHANUTE, KS 66720
 620-431-9210 OR 800-467-8676

TICKET NUMBER 16524
 LOCATION EUREKA
 FOREMAN Kevin McCoy

TREATMENT REPORT & FIELD TICKET
 CEMENT

DATE	CUSTOMER #	WELL NAME & NUMBER	SECTION	TOWNSHIP	RANGE	COUNTY
11-7-06	1816	M. Short #3	20	33S	3E	Cowley
CUSTOMER W.D. Short Oil Co., LLC			Brentz Drig.			
MAILING ADDRESS P.O. Box 729			TRUCK #	DRIVER	TRUCK #	DRIVER
CITY OXFORD			445	Justin		
STATE KS			439	Jerrid		
ZIP CODE 67119			502	John		
			452 763	Jim		

JOB TYPE Squeeze HOLE SIZE 8 3/4 HOLE DEPTH _____ CASING SIZE & WEIGHT 7"
 CASING DEPTH _____ DRILL PIPE _____ TUBING _____ OTHER _____
 SLURRY WEIGHT 13[#]-14[#] SLURRY VOL 120 BBL WATER gal/sk 7^o-8^o CEMENT LEFT in CASING _____
 DISPLACEMENT 89 BBL DISPLACEMENT PSI 1400 PSI 800 Shut in. RATE _____

REMARKS: Safety Meeting: Rig up Log-Tech. log Top of Cement @ 2500'. Perforate 4 Squeeze Holes @ 2440'-41'. Rig up 7" Cement Head. (Casing full of fresh water) Break Circulation w/ 10 BBL fresh @ 5 AM, 500 PSI, w/ Good Fluid Returns to Surface. Mixed 250 SKS 60/40 Pozmix Cement w/ 6% Gel @ 13[#] per/gal yield 1.55. Tail in w/ 210 SKS 60/40 Pozmix Cement w/ 4% Gel, 1 1/2% Cacle @ 14[#] per/gal, yield 1.40. Shut down. wash out Pump & Lines. Release Plug. Displace w/ 89 BBL fresh water. Final Pumping Pressure 1400 PSI @ 1 1/2 BARR. I.S.D.P. 800 PSI. Shut in @ 800 PSI. Ran wire line stopped Plug @ 2371' = 9' Above G.L. No Cement to Surface. Job Complete. Rig down. Good Circulation @ ALL times while Cementing.

ACCOUNT CODE	QUANTITY or UNITS	DESCRIPTION of SERVICES or PRODUCT	UNIT PRICE	TOTAL
5401	1	PUMP CHARGE	800.00	800.00
5406	80	MILEAGE	3.15	252.00
1131	250 SKS	60/40 Pozmix Cement } Lead	9.35	2337.50
1118 A	1300 [#]	Gel 6% } Cement	.14 [#]	182.00
1131	210 SKS	60/40 Pozmix Cement } Tail	9.35	1963.50
1118 A	720 [#]	Gel 4% } Cement	.14 [#]	100.80
1102	270 [#]	Cacle 1 1/2 %	.64 [#]	172.80
5407 A	19.78 tons	80 miles Bulk Trucks	1.05	1661.52
5501 C	6 HRS	Water Transport	98.00	588.00
1123	5,500 GALS	City water	12.80 ^{Per 1000}	70.40
4409	1	7" Top Rubber Plug	70.00	70.00
RECEIVED FEB 20 2007 KCC WICHITA				
			Sub Total	8,198.52
			SALES TAX 5.8%	284.03
			ESTIMATED TOTAL	8,482.55

THANK YOU 810409
 AUTHORIZATION witnessed by Mike user TITLE Co. Rep. DATE _____