

FOR KCC USE:

AMENDED\*\*\*\*

FORM C-1 7/91

15-051-25007-00-00

FORM MUST BE TYPED

State of Kansas

FORM MUST BE SIGNED

EFFECTIVE DATE: 7-21-99

DISTRICT # 4

NOTICE OF INTENTION TO DRILL

ALL BLANKS MUST BE FILLED

SGA? X Yes... No

Must be approved by the K.C.C. five (5) days prior to commencing well.

Expected Spud Date July 28 1999
month day year

Spot East
NW - NW - NE. Sec 19. Twp 11S S, Rg 19. X West

OPERATOR: License # 32034
Name: Hal C. Porter
Address: 10004 West 20th Street North
City/State/Zip: Wichita KS 67212
Contact Person: Hal C. Porter
Phone: 316-773-3808

100 feet from South / North line of Section
2325 feet from East / West line of Section
IS SECTION REGULAR X IRREGULAR?

(NOTE: Locate well on the Section Plat on Reverse Side)

CONTRACTOR: License # 30606
Name: Murfin Drilling Company, Inc.

County: ELLIS

Lease Name: HOLLAND UNIT Well #: 19-1

Field Name: WILDCAT

Is this a Prorated/Spaced Field? yes X no

Target Formation(s): ARBUCKLE

Nearest lease or unit boundary: 330.49 FEET

Ground Surface Elevation: feet MSL

Water well within one-quarter mile: yes X no

Public water supply well within one mile: yes X no

Depth to bottom of fresh water: 180 feet

Depth to bottom of usable water: 700 feet

\*Surface Pipe by Alternate: X 1 2

Length of Surface Pipe Planned to be set: 1320 feet

Length of Conductor pipe required: 0

Projected Total Depth: 3800

Formation at Total Depth: ARBUCKLE

Water Source for Drilling Operations:

well farm pond X other

Will Cores Be Taken?: yes X no

If yes, proposed zone:

Well Drilled For: Well Class: Type Equipment:

- X Oil Enh Rec Infield X Mud Rotary
Gas Storage X Pool Ext Air Rotary
OWWO Disposal Wildcat Cable
Seismic: # of Holes Other
Other

If OWWO: old well information as follows:

Operator:
Well Name:
Comp. Date: Old Total Depth

Directional, Deviated or Horizontal wellbore? yes no

If yes, true vertical depth:

Bottom Hole Location:

\* WAS: ALT 2, MIN SURFACE CASING 200'.
IS: ALT 1, MIN SURFACE CASING 720'.

AFFIDAVIT

The undersigned hereby affirms that the drilling, completion and eventual plugging of this well will comply with K.S.A. 55-101, et. seq.

It is agreed that the following minimum requirements will be met:

- 1. Notify the appropriate district office prior to spudding of well;
2. A copy of the approved notice of intent to drill shall be posted on each drilling rig;
3. The minimum amount of surface pipe as specified below shall be set by circulating cement to the top; in all cases surface pipe shall be set through all unconsolidated materials plus a minimum of 20 feet into the underlying formation;
4. If the well is dry hole, an agreement between the operator and the district office on plug length and placement is necessary prior to plugging;
5. The appropriate district office will be notified before well is either plugged or production casing is cemented in;
6. IF AN ALTERNATE II COMPLETION, PRODUCTION PIPE SHALL BE CEMENTED FROM BELOW ANY USABLE WATER TO SURFACE WITHIN 120 DAYS OF SPUD DATE. IN ALL CASES, NOTIFY DISTRICT OFFICE PRIOR TO ANY CEMENTING.

I hereby certify that the statements made herein are true and to the best of my knowledge and belief.

Date: 7/29/99 Signature of Operator or Agent: Hal Porter Title: Operator

FOR KCC USE:
API # 15- 051-25007 0000
Conductor pipe required NONE feet
Minimum surface pipe required 720 feet per Alt 1 2
Approved by: CR 7-30-99 JL / DR 16 7-16-99 DPW
This authorization expires: 1-16-2000
(This authorization void if drilling not started within 6 months of effective date.)
Spud date: Agent:

REMEMBER TO:

- File Drill Pit Application (form CDP-1) with Intent to Drill;
- File Completion Form ACO-1 within 120 days of spud date;
- File acreage attribution plat according to field proration orders;
- Notify appropriate district office 48 hours prior to workover or re-entry;
- Submit plugging report (CP-4) after plugging is completed;
- Obtain written approval before disposing or injecting salt water.

Mail to: KCC - Conservation Division, 130 S. Market - Room 2078, Wichita, Kansas 67202.

1999 JUL 30 A 11:42
RECEIVED
KANSAS CORP COMM
7-30-1999

# HAL C. POETER HOLLAND UNIT 40. ACRES

Township 11S Range 19W County ELLIS State KS

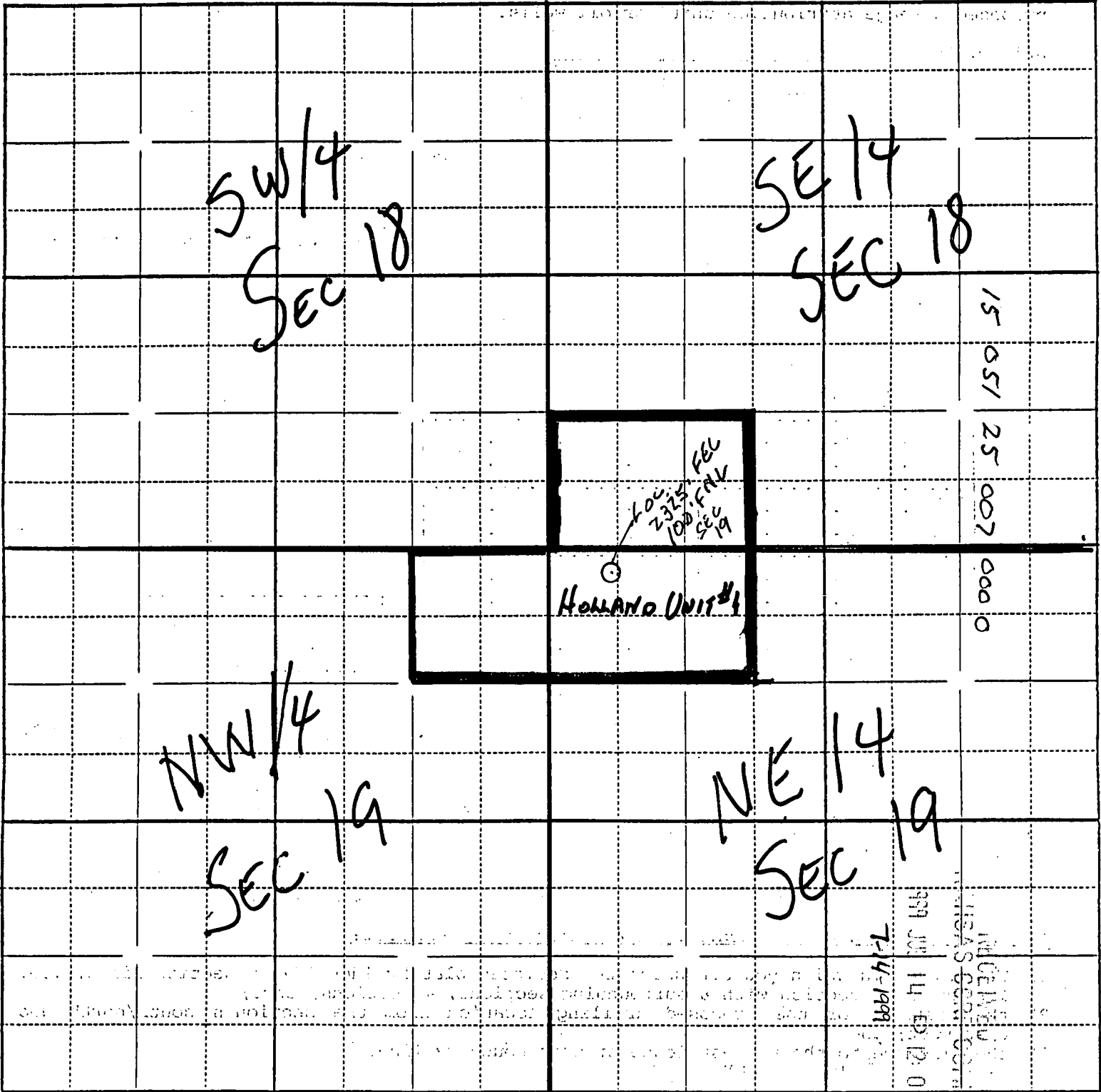

HAL C. PORTER 15-051-25007-00-00

HOLLAND UNIT No. 19-1

100' FNL #2325 FEL SECTION 19, 11S, 19W ELLIS COUNTY KS

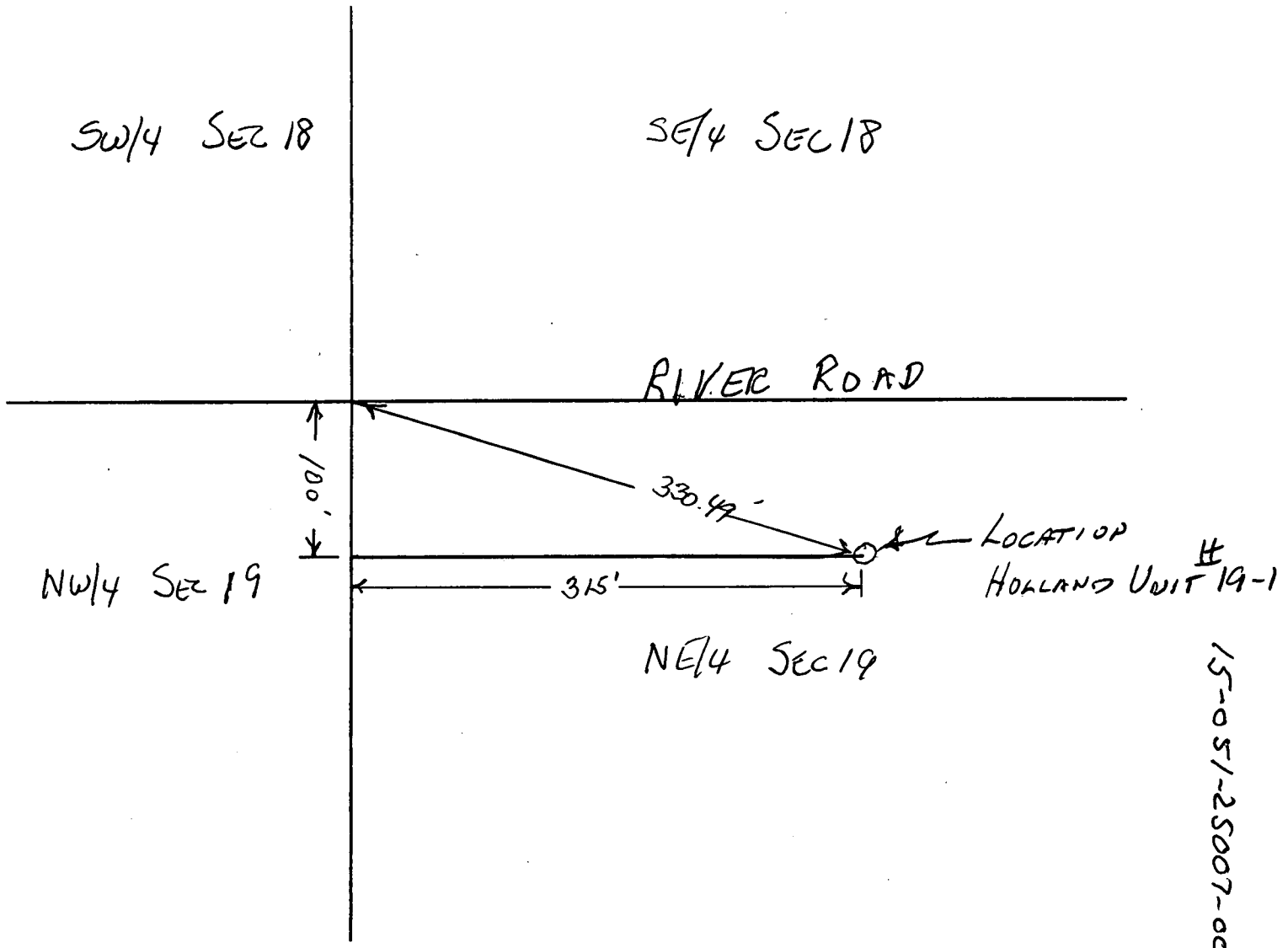

15-051-25007-0000

RECEIVED  
KANSAS COM. CO. #  
1999 JUL 14 12:01  
7-30-1999