

15-179-21048-0000

FOR KCC USE:

CORRECTION

FORM C-1 7/91

EFFECTIVE DATE: 9-9-92

State of Kansas

*COR

FORM MUST BE TYPED

FORM MUST BE SIGNED

ALL BLANKS MUST BE FILLED

DISTRICT # 4

NOTICE OF INTENTION TO DRILL

Must be approved by the K.C.C. five (5) days prior to commencing well

Expected Spud Date: September 2, 1992

C 8/2 NE NE Sec 23 Twp 9 S, Rg 26 East West

OPERATOR: License # 9482
Name: NATIONAL PETROLEUM RESERVES, INC.
Address: 250 N. Rock Rd., Ste. 340
City/State/Zip: Wichita, KS, 67206
Contact Person: Ted C. Bredehaft
Phone: (316) 681-3515

4290 feet from South / North line of Section
660 feet from East / West line of Section
IS SECTION X REGULAR IRREGULAR

(NOTE: Locate well on the Section Plat on Reverse Side)

County: Sheridan
Lease Name: Pfeifer Well #: 5
Field Name: Epler

CONTRACTOR: License #:
Name: Emphasis Oil Operations

Is this a Prorated/Spaced Field? yes X no
Target Formation(s): Anhydrite

Well Drilled For: Well Class: Type Equipment:
Oil Enh Rec X Infield X Mud Rotary
Gas Storage Pool Ext Air Rotary
OAWO XX Disposal Wildcat Cable
Seismic: # of Holes Other

Nearest lease or unit boundary: 660
Ground Surface Elevation: 2651 feet MSL
Water well within one-quarter mile: yes X no

If OAWO: old well information as follows:
Operator:
Well Name:
Comp. Date: Old Total Depth

Public water supply well within one mile: yes X no
Depth to bottom of fresh water: 230'
Depth to bottom of usable water: 1410'

Directional, Deviated or Horizontal wellbore? yes no
If yes, true vertical depth:
Bottom Hole Location:

* Surface Pipe by Alternate: 1 XX 2
* Length of Surface Pipe Planned to be set: 250'

The undersigned hereby affirms that the drilling, completion and eventual plugging of this well will comply with K.S.A. 55-101, et. seq.
It is agreed that the following minimum requirements will be met:

Length of Conductor pipe required:
Projected Total Depth: 2400'
Formation at Total Depth: Anhydrite

was alt I 1460' S.C.

AFFIDAVIT

IS alt II 250' S.C.

The undersigned hereby affirms that the drilling, completion and eventual plugging of this well will comply with K.S.A. 55-101, et. seq.
It is agreed that the following minimum requirements will be met:

- 1. Notify the appropriate district office prior to spudding of well;
2. A copy of the approved notice of intent to drill shall be posted on each drilling rig;
3. The minimum amount of surface pipe as specified below shall be set by circulating cement to the top; in all cases surface pipe shall be set through all unconsolidated materials plus a minimum of 20 feet into the underlying formation;
4. If the well is dry hole, an agreement between the operator and the district office on plug length and placement is necessary prior to plugging;
5. The appropriate district office will be notified before well is either plugged or production casing is cemented in;
6. IF AN ALTERNATE II COMPLETION, PRODUCTION PIPE SHALL BE CEMENTED FROM BELOW ANY USABLE WATER TO SURFACE WITHIN 120 DAYS OF SPUD DATE. IN ALL CASES, NOTIFY DISTRICT OFFICE PRIOR TO ANY CEMENTING.

I hereby certify that the statements made herein are true and to the best of my knowledge and belief.

Date: 9/18/92 Signature of Operator or Agent Title: President

FOR KCC USE:
API # 15- 179-21,048
Conductor pipe required None feet
Minimum surface pipe required 250' feet per Alt. X(2)
Approved by: CB 9-3-92
This authorization expires: 3-3-93
(This authorization void if drilling not started within 6 months of effective date.)
Spud date: Agent:

cor 9/22/92
CB

RECEIVED
STATE CORPORATION COMMISSION
9-22-92
SEP 22 1992

CONSERVATION DIVISION
Wichita, Kansas

REMEMBER TO:

- File Drill Pit Application (form CDP-1) with Intent to Drill;
- File Completion Form ACO-1 within 120 days of spud date;
- File acreage attribution plat according to field proration orders;
- Notify appropriate district office 48 hours prior to workover or re-entry;
- Submit plugging report (CP-4) after plugging is completed;
- Obtain written approval before disposing or injecting salt water.

Mail to: Conservation Division, 200 Colorado Derby Building, 202 W. First St., Wichita, Kansas 67202-1286.

IN ALL CASES PLOT THE INTENDED WELL ON THE PLAT BELOW

PLAT OF ACREAGE ATTRIBUTABLE TO A WELL IN A PRORATED OR SPACED FIELD

If the intended well is in a prorated or spaced field, please fully complete this side of the form. If the intended well is in a prorated or spaced field complete the plat below showing that the well will be properly located in relationship to other wells producing from the common source of supply. Please show all the wells within 1 mile of the boundaries of the proposed acreage attribution unit for gas wells and within 1/2 mile of the boundaries of the proposed acreage attribution unit for oil wells.

API NO. 15- _____
 OPERATOR National Petroleum Reserves, Inc. LOCATION OF WELL: COUNTY Sheridan
 LEASE Pfeifer _____ 4290 feet from south/~~north~~ line of section
 WELL NUMBER #5 _____ 660 feet from east/~~west~~ line of section
 FIELD Epler _____ SECTION 23 TWP 9S RG 26W

NUMBER OF ACRES ATTRIBUTABLE TO WELL _____ IS SECTION _____ REGULAR or _____ IRREGULAR
 QTR/QTR/QTR OF ACREAGE _____ - _____ - _____ **IF SECTION IS IRREGULAR, LOCATE WELL FROM NEAREST CORNER BOUNDARY.**

Section corner used: _____ NE _____ NW _____ SE _____ SW
PLAT

(Show location of the well and shade attributable acreage for prorated or spaced wells.)
 (Show footage to the nearest lease or unit boundary line.)

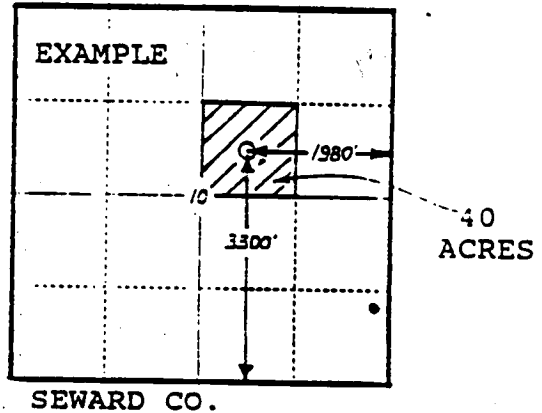
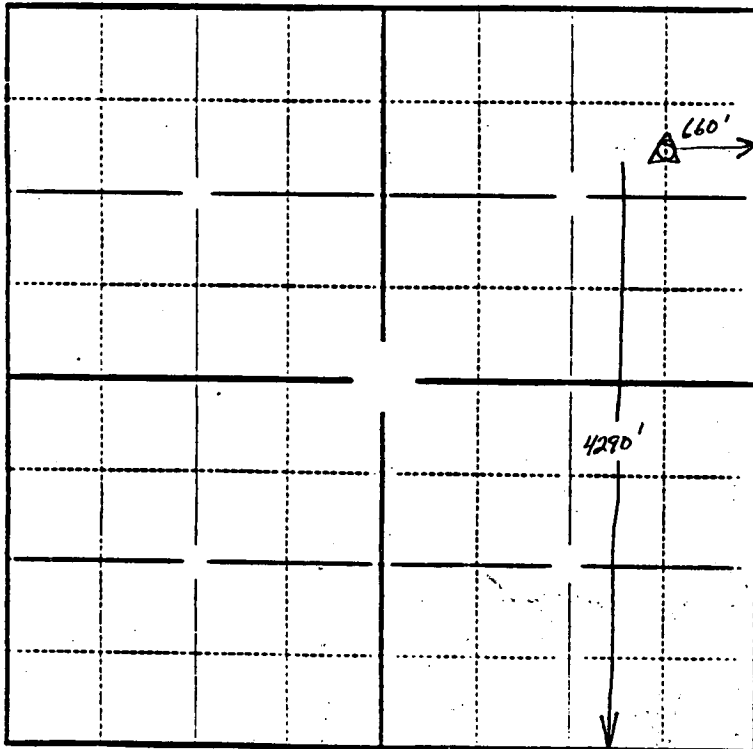

In plotting the proposed location of the well, you must show:

- 1) The manner in which you are using the depicted plat by identifying section lines, i.e. 1 section, 1 section with 8 surrounding sections, 4 sections, etc.;
- 2) the distance of the proposed drilling location from the section's south/north and east/west lines; and
- 3) the distance to the nearest lease or unit boundary line.