

* Amended

STATE CORPORATION COMMISSION OF KANSAS
OIL & GAS CONSERVATION DIVISION

WELL COMPLETION OR RECOMPLETION FORM
ACO-1 WELL HISTORY

DESCRIPTION OF WELL AND LEASE

Operator: License # 7875
Name STRATA ENERGY RESOURCES CORPORATION
Address 4101 BIRCH ST., SUITE 130
City/State/Zip NEWPORT BEACH, CA 92660

Purchaser TEXACO TRADING AND TRANSPORTATION

Operator Contact Person RAYMOND A. DIAZ
Phone (714) 261-8181

Contractor: License # 4083
Name WESTERN KANSAS DRILLING

Wellsite Geologist BETH FUHR
Phone (316) 263-2243

- Designate Type of Completion
- New Well
 - Re-Entry
 - Workover
 - Oil
 - Gas
 - Dry
 - SWD
 - Inj
 - Other (Core, Water Supply etc.)
 - Temp Abd
 - Delayed Comp.

If OWNO: old well info as follows:
Operator
Well Name
Comp. Date Old Total Depth

WELL HISTORY

Drilling Method:
 Mud Rotary Air Rotary Cable

Spud Date: 09/21/88 Date Reached TD: 09/28/88 Completion Date: 10/25/88

Total Depth: 3951' PBDT: NONE

Amount of Surface Pipe Set and Cemented at 250 feet
Multiple Stage Cementing Collar Used? Yes No
If yes, show depth set _____ feet

If alternate 2 completion, cement circulated from 3951' surface 300' 450' SX cmt
7-5-89

API NO. 15-195-21,998-00-00
County TREGO
C. NW NE Sec. 27 Twp. 11S Rge. 22 East West

4620 Ft North from Southeast Corner of Section
1980 Ft West from Southeast Corner of Section
(Note: Locate well in section plat below)

Lease Name SCHUBERT B Well # 2
Field Name GAGELMAN Shaw Creek

Producing Formation MARMATON

Elevation: Ground 2246' KB 2251'
Section Plat

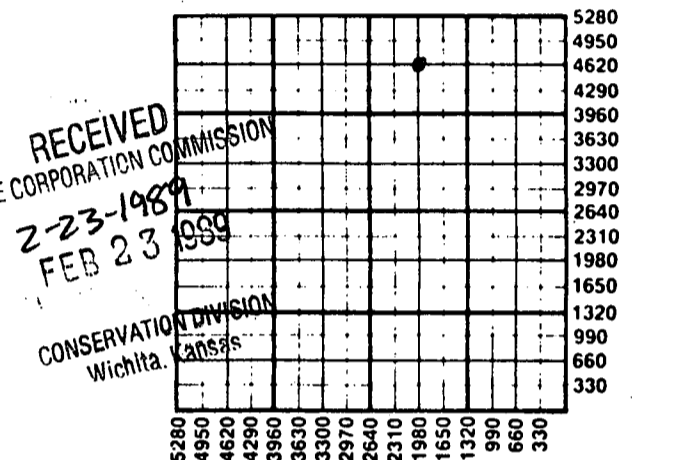

WATER SUPPLY INFORMATION
Disposition of Produced Water: Disposal Repressuring
Docket #

Questions on this portion of the ACO-1 call:
Water Resources Board (913) 296-3717

Source of Water:
Division of Water Resources Permit #

- Groundwater (Well) _____ Ft North from Southeast Corner _____ Ft West from Southeast Corner Sec Twp Rge East West
- Surface Water (Stream, pond etc) _____ Ft North from Southeast Corner _____ Ft West from Southeast Corner Sec Twp Rge East West
- Other (explain) Farmers pond less than 15' acre (purchased from city, R.W.D. #)

INSTRUCTIONS: This form shall be completed in duplicate and filed with the Kansas Corporation Commission, 200 Colorado Derby Building, Wichita, Kansas 67202, within 90 days after completion or recompletion of any well. Rule 82-3-130 and 82-3-107 apply.
Information on side two of this form will be held confidential for a period of 12 months if requested in writing and submitted with the form. See rule 82-3-107 for confidentiality in excess of 12 months.
One copy of all wireline logs and drillers time log shall be attached with this form. Submit CP-4 form with all plugged wells. Submit CP-111 form with all temporarily abandoned wells.

All requirements of the statutes, rules and regulations promulgated to regulate the oil and gas industry have been fully complied with and the statements herein are complete and correct to the best of my knowledge.

Signature _____
Title PRESIDENT Date 02/17/89

Subscribed and sworn to before me this 17th day of February 1989.
Notary Public Connie R. Wagers

Date Commission Expires _____



K.C.C. OFFICE USE ONLY

- Letter of Confidentiality Attached
- Wireline Log Received
- Drillers Timelog Received

Distribution

- KCC
- KGS
- SWD/Rep
- Plug
- NGPA
- Other (Specify)

2-23-89

Sec. 27 Twp. 11, Rge. 22

SIDE TWO

Operator Name STRATA ENERGY RESOURCES CORP. Lease Name..... SCHUBERT B Well #..... 2

Sec..... 27 Twp..... 115 Rge..... 22 East West County..... TREGO

WELL LOG

INSTRUCTIONS: Show important tops and base of formations penetrated. Detail all cores. Report all drill stem tests giving interval tested, time tool open and closed, flowing and shut-in pressures, whether shut-in pressure reached static level, hydrostatic pressures, bottom hole temperature, fluid recovery, and flow rates if gas to surface during test. Attach extra sheet if more space is needed. Attach copy of log.

Drill Stem Tests Taken Yes No
 Samples Sent to Geological Survey Yes No
 Cores Taken Yes No

Formation Description
 Log Sample

* DST #1 - 30-30- open 10", blow diédé, flushed tool, no help. Recovered: 40' mud, no show
 IFP 58-58# FFP 68-68#
 ISIP 1116# FSIP NA
 HYP 2050-2030# - 3705 - 3765

DST #2 - 30-45-60-60
 Recovered: 30' SOCM (5% oil)
 IFP 29-29# FFP 58-58#
 ISIP 990# FSIP 866#
 HYP 2198-2179

Name	Top	Bottom
ANDYDRITE	1707'	1751'
TOPEKA	3283'	3494'
HEEBNER	3494'	3518'
TORONTO	3518'	3534'
LANSING	3534'	3772'
BASE KC	3772'	3852'
MARMATON	3852'	3951'

3858 - 3890

CASING RECORD <input type="checkbox"/> New <input checked="" type="checkbox"/> Used							
Report all strings set-conductor, surface, intermediate, production, etc.							
Purpose of String	Size Hole Drilled	Size Casing Set (in O.D.)	Weight Lbs/Ft.	Setting Depth	Type of Cement	#Sacks Used	Type and Percent Additives
SURFACE.....	12 1/4	8.5/8"	24#	250'	60-40PO2	180	20% GEL
PRODUCTION.....	7.7/8	4.1/2"	10.5%	3950'	COMMON	150	10% salt w/ Flocele/sk
PERFORATION RECORD				Acid, Fracture, Shot, Cement Squeeze Record			
Shots Per Foot	Specify Footage of Each Interval Perforated			Amount and Kind of Material Used			Depth
2	3856' - 3866'			1500 Gal 15% DSFE acid w/ 15#/Ferchek, 6 gal LO-Surf, 1 1/2 gal inhibitor & Perf-Pac balls			
	Frac: 975 bbls of 2% KCL wtr. 6700# KCL, 1,100# WG-18, 12 gal Adomall, 36 gal CL-19, 36# GBW-3, 55 gal Lo-Surf 259, 160# Ferchek, 40 gal Super Sand Set			20 gal Super Sand Set			
TUBING RECORD		Size	Set At	Packer at	Liner Run	<input type="checkbox"/> Yes <input checked="" type="checkbox"/> No	
		2 3/8#	3955				
Date of First Production		Producing Method					
12/17/88		<input type="checkbox"/> Flowing <input checked="" type="checkbox"/> Pumping <input type="checkbox"/> Gas Lift <input type="checkbox"/> Other (explain).....					
Estimated Production Per 24 Hours	Oil	Gas	Water	Gas-Oil Ratio	Gravity		
	10	0	10	0	34°		
	Bbls	MCF	Bbls	CFPB			

METHOD OF COMPLETION

Production Interval

Disposition of gas: Vented Open Hole Perforation
 Solid Other (Specify) 3856'
 Used on Lease Dually Completed 3866'
 Circulated Commingled

15-195-21998-00-00

Phone 913-483-2627, Russell, Kansas

Phone Plainville 913-434-2812

Phone 316-793-5861, Great Bend, Kansas

Phone Ness City 913-798-3843

ALLIED CEMENTING CO., INC. N° 4210

Home Office P. O. Box 31

Russell, Kansas 67665

9-21-88

Date	9-22-88	Sec.	27	Twp.	11	Range	22	Called Out	8:00 PM	On Location	10:30 PM	Job Start	2:30 AM	Finish	3:00 AM
Lease	Schubert			Well No.	"B" #2			Location	092112h5N1W1N 3/4 E Trego				County	KANSAS	
Contractor	Western Kansas Drilling R. 9 2							Owner	SAME						
Type Job	Surface							To Allied Cementing Co., Inc. You are hereby requested to rent cementing equipment and furnish cementer and helper to assist owner or contractor to do work as listed.							
Hole Size	12 1/4"		T.D.	285'			Charge To	STRATA Energy Resources							
Csg.	8 3/4"		Depth	275'			Street	4101 Birch St # 130							
Tbg. Size			Depth				City	Newport Beach				State	CALIF 92629		
Drill Pipe			Depth				The above was done to satisfaction and supervision of owner agent or contractor								
Tool			Depth				Purchase Order No.								
Cement Left in Csg.	15'		Shoe Joint				X	Melvin P. Long							
Press Max.			Minimum				CEMENT								
Meas Line			Displace	✓			Amount Ordered	185 sks 60/40 per 37cc 276cc							
Perf.							Consisting of								

EQUIPMENT

#153 No.	Cementer	M Kaukman
Pumptrk	Helper	Dave F.
No.	Cementer	
Pumptrk	Helper	
#160	Driver	SCOTT R.
Bulktrk	Driver	

DEPTH of Job		
Reference:		
#	Pump Tax	360.00
	1-8 3/4" Plug	40.00
	1.00 Per Mile	34.00
	Sub Total	
	Tax	
	Total	434.00

Remarks:

Cement Circulated

Common	105 sks @ 5.00	525.00
Poz. Mix	70 sks @ 2.25	157.50
Gel.	35 sks @ 6.75	236.25
Chloride	55 sks @ 2.00	110.00
Quickset		
	Sales Tax	
Handling	@ 90¢	157.50
Mileage	3¢/sk/mile	178.50
	Sub Total	
	Total	1138.75

Floating Equipment

Shank

RECEIVED
STATE CORPORATION COMMISSION
6-30-1989
JUN 30 1989

CONSERVATION DIVISION
Wichita, Kansas

15-195-21998-00-00

Phone 913-483-2627, Russell, Kansas
 Phone 316-793-5861, Great Bend, Kansas

Phone Plainville 913-434-2812
 Phone Ness City 913-798-3843

ALLIED CEMENTING CO., INC. No 5398

Home Office P. O. Box 31

Russell, Kansas 67665

New

Date	Sec.	Twp.	Range	Called Out	On Location	Job Start	Finish
9-28-88	27	11	22			6:30 PM	8:00 PM
Leads	Well No. B-2			Location	County	State	
Strata-Schubert				Ogallah 5N2W		Trego	K
Contractor				Owner			
Western Kc Drilg				To Allied Cementing Co., Inc.			
Type Job				You are hereby requested to rent cementing equipment and furnish			
Production String				cement and helper to assist owner or contractor to do work as listed.			
Hole Size	T.D.		Charge To				
7 7/8	39513943		Strata Resources				
Csg.	Depth		Street				
4 1/2	2942		4101 Birch ST #130				
Tbg. Size	Depth		City				
			Newport Beach				
Drill Pipe	Depth		State				
			CALIF 92629				
Tool	Depth		The above was done to satisfaction and supervision of owner agent or				
			contractor				
Cement Left in Csg.	Shoe Joint		Purchase Order No.				
	40		X Robert A. Williams 1/16 floored per sk				
Press Max.	Minimum		CEMENT 150 com 10% salt				
Meas Line	Displace		Amount Ordered				
			300 ATL 1/2 lb floored per sk				
Perf.	EQUIPMENT						

No.	Cementer	Helper
Pumptrk 153	Dave	Mike
No.	Cementer	Helper
Pumptrk 95	Laurance	Lon
No.	Driver	Driver
Bulktrk 1		
Bulktrk		

DEPTH of Job	Reference:	Amount
	Pump trk. chg	838.00
	1.00 per mile	34.00
	4 1/2 Rubber Plug	31.00
	Sub Total	
	Tax	
	Total	903.00

Remarks: Float Held
 Plug Rat hole w/ 15sk
 Cement Cir

Consisting of	Common	150 SK @ 5.00	750.00
	Poz. Mix SALT	15 SK @ 4.75	71.25
	Gel.		
	Chloride		
	Quickset Flo Seal	188 Pounds @ 1.60	300.80
	ATL	300 SK @ 5.25	1,575.00
	Handling	.90 per SK	405.00
	Mileage	.30 per mile	459.00
	Sub Total		
	Total		3561.05
Floating Equipment	5 Centrifizers	41.00	205.00
	1 Guide Shoe		104.00
	1 AFU Insert		161.00
	1 Basket		108.00
			578.00

RECEIVED 578.00
 STATE CORPORATION COMMISSION
 6-30-1989
 JUN 30 1989

CONSERVATION DIVISION
 Wichita, Kansas

15-195-21998-00-00

Phone 913-483-2627, Russell, Kansas
 Phone 316-793-5861, Great Bend, Kansas

Phone Plainville 913-434-2812
 Phone Ness City 913-798-3843

ALLIED CEMENTING CO., INC. N° 4259

Home Office P. O. Box 31

Russell, Kansas 67665

New

Date <i>10-19-88</i>	Sec. <i>15</i>	Twp. <i>195</i>	Range <i>21</i>	Called Out	On Location	Job Start <i>10:00 AM</i>	Finish <i>12:00 AM</i>
Lease <i>Strata-Schubert</i> Well No. <i>B-2</i>			Location <i>Ogallah 5N 1W</i>		County <i>Trego</i>	State <i>KI</i>	
Contractor <i>5 Star Well Service</i>				Owner			

Type Job <i>Circulate</i>	
Hole Size	T.D.
Csg. <i>4 1/2</i>	Depth
Tbg. Size <i>2"</i>	Depth
Drill Pipe	Depth
Tool	Depth
Cement Left in Csg.	Shoe Joint
Press Max.	Minimum
Meas Line	Displace
Perf.	

To Allied Cementing Co., Inc.
 You are hereby requested to rent cementing equipment and furnish cementer and helper to assist owner or contractor to do work as listed.

Charge To *Strata Energy Resources*
 Street *4101 Birch St #130*
 City *REPORT BEACH* State *CALIF 92629*
 The above was done to satisfaction and supervision of owner agent or contractor

Purchase Order No.
 X *Robert A. Wahlman*
CEMENT

EQUIPMENT

No.	Cementer	<i>Dave</i>
Pumptrk <i>153</i>	Helper	<i>Clm</i>
No.	Cementer	
Pumptrk	Helper	
	Driver	
Bulktrk		
Bulktrk	Driver	

Amount Ordered

Consisting of

Common	
Poz. Mix	
Gel.	
Chloride	
Quickset	

DEPTH of Job

Reference:	<i>Pump trk chg</i>	<i>450.00</i>
	<i>100 Per mile</i>	<i>32.00</i>
	Sub Total	
	Tax	
	Total	<i>482.00</i>

Handling

Mileage

Sales Tax

Sub Total

Total

Remarks:

Floating Equipment

RECEIVED
 STATE CORPORATE COMMISSION
 6-30-1989
 JUL 3 1989
 CONSERVATION DIVISION
 Wichita, Kansas